

Submit 1 Copy To Appropriate District Office
District I - (575) 393-6161
1625 N. French Dr., Hobbs, NM 88240
District II - (575) 748-1283
811 S. First St., Artesia, NM 88210
District III - (505) 334-6178
1000 Rio Brazos Rd., Aztec, NM 87410
District IV - (505) 476-3460
1220 S. St. Francis Dr., Santa Fe, NM 87505

State of New Mexico
Energy, Minerals and Natural Resources

Form C-103
Revised July 18, 2013

OIL CONSERVATION DIVISION
1220 South St. Francis Dr.
Santa Fe, NM 87505

WELL API NO. 30-039-20041
5. Indicate Type of Lease STATE <input type="checkbox"/> FEE <input type="checkbox"/>
6. State Oil & Gas Lease No. Federal - NMSF-079522A
7. Lease Name or Unit Agreement Name San Juan 28-5 Unit
8. Well Number 74
9. OGRID Number 372171
10. Pool name or Wildcat Blanco Mesa Verde / Basin Dakota

SUNDRY NOTICES AND REPORTS ON WELLS
(DO NOT USE THIS FORM FOR PROPOSALS TO DRILL OR TO DEEPEN OR PLUG BACK TO A DIFFERENT RESERVOIR. USE "APPLICATION FOR PERMIT" (FORM C-101) FOR SUCH PROPOSALS.)

1. Type of Well: Oil Well ☐ Gas Well ☒ Other

2. Name of Operator
Hilcorp Energy Company

3. Address of Operator
PO Box 4700, Farmington NM 87499

4. Well Location
Unit Letter N : 1650 feet from the South line and 1695 feet from the West line
Section 36 Township 28N Range 5W NMPM Rio Arriba County

11. Elevation (Show whether DR, RKB, RT, GR, etc.)
7355' GR

12. Check Appropriate Box to Indicate Nature of Notice, Report or Other Data

NOTICE OF INTENTION TO:

PERFORM REMEDIAL WORK ☐ PLUG AND ABANDON ☐
TEMPORARILY ABANDON ☐ CHANGE PLANS ☐
PULL OR ALTER CASING ☐ MULTIPLE COMPL ☐
DOWNHOLE COMMINGLE ☒
CLOSED-LOOP SYSTEM ☐
OTHER: ☐

SUBSEQUENT REPORT OF:

REMEDIAL WORK ☐ ALTERING CASING ☐
COMMENCE DRILLING OPNS. ☐ P AND A ☐
CASING/CEMENT JOB ☐
OTHER: ☐

13. Describe proposed or completed operations. (Clearly state all pertinent details, and give pertinent dates, including estimated date of starting any proposed work). SEE RULE 19.15.7.14 NMAC. For Multiple Completions: Attach wellbore diagram of proposed completion or recompletion.

It is intended to recomplete the subject well in the Blanco Mesaverde (pool 72319) and downhole commingle with the existing Dakota (pool 71599). The production will be commingled per Oil Conservation Division Order Number 11363. Allocation and methodology will be provided after the well is completed. Commingling will not reduce the value of the production. The Bureau of Land Management has been notified in writing of this application.

Proposed perforations are: MV: 6500' - 5808'; DK: 8608' - 8414'. These perforations are in TMD.

As referenced in Order # R- 10695 interest owners were not re-notified.

DHC #41038AZ

Spud Date:

Rig Release Date:

NMOC

MAY 03 2018

DISTRICT III

I hereby certify that the information above is true and complete to the best of my knowledge and belief.

SIGNATURE Etta Trujillo TITLE Operations/Regulatory Technician - Sr. DATE 5/1/2018

Type or print name Etta Trujillo E-mail address: ettrujillo@hilcorp.com PHONE: 505-324-5161

For State Use Only

APPROVED BY: [Signature] TITLE GEOLOGIST DISTRICT #3 DATE 4/17/2018

Conditions of Approval (if any):

fy

District I

1625 N. French Dr., Hobbs, NM 88240
Phone:(575) 393-6161 Fax:(575) 393-0720

District II

811 S. First St., Artesia, NM 88210
Phone:(575) 748-1283 Fax:(575) 748-9720

District III

1000 Rio Brazos Rd., Aztec, NM 87410
Phone:(505) 334-6178 Fax:(505) 334-6170

District IV

1220 S. St Francis Dr., Santa Fe, NM 87505
Phone:(505) 476-3470 Fax:(505) 476-3462

State of New Mexico
Energy, Minerals and Natural
Resources
Oil Conservation Division
1220 S. St Francis Dr.
Santa Fe, NM 87505

Form C-102

August 1, 2011

Permit 250862

WELL LOCATION AND ACREAGE DEDICATION PLAT

1. API Number 30-039-20041	2. Pool Code 72319	3. Pool Name BLANCO-MESAVERDE (PRORATED GAS)
4. Property Code 318708	5. Property Name SAN JUAN 28 5 UNIT	6. Well No. 074
7. OGRID No. 372171	8. Operator Name HILCORP ENERGY COMPANY	9. Elevation 7355

10. Surface Location

UL - Lot N	Section 36	Township 28N	Range 05W	Lot Idn	Feet From 1650	N/S Line S	Feet From 1695	E/W Line W	County RIO ARRIBA
---------------	---------------	-----------------	--------------	---------	-------------------	---------------	-------------------	---------------	----------------------

11. Bottom Hole Location If Different From Surface

UL - Lot	Section	Township	Range	Lot Idn	Feet From	N/S Line	Feet From	E/W Line	County
12. Dedicated Acres 411.57 S/2	13. Joint or Infill	14. Consolidation Code	15. Order No.						

NO ALLOWABLE WILL BE ASSIGNED TO THIS COMPLETION UNTIL ALL INTERESTS HAVE BEEN CONSOLIDATED OR A NON-STANDARD UNIT HAS BEEN APPROVED BY THE DIVISION

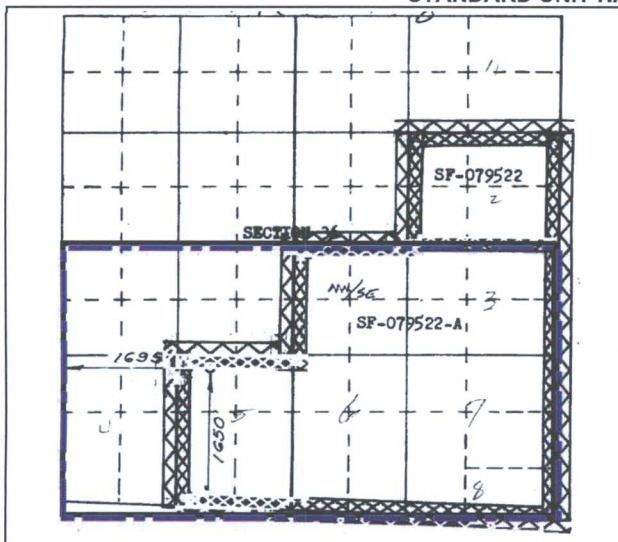
**OPERATOR CERTIFICATION**

I hereby certify that the information contained herein is true and complete to the best of my knowledge and belief, and that this organization either owns a working interest or unleased mineral interest in the land including the proposed bottom hole location(s) or has a right to drill this well at this location pursuant to a contract with an owner of such a mineral or working interest, or to a voluntary pooling agreement or a compulsory pooling order heretofore entered by the division.

E-Signed By: *Etta Trujillo*
Title: Operations/Regulatory Tech Sr
Date: 04/09/2018

SURVEYOR CERTIFICATION

I hereby certify that the well location shown on this plat was plotted from field notes of actual surveys made by me or under my supervision, and that the same is true and correct to the best of my belief.

Surveyed By: David Kilven
Date of Survey: 5/19/1960
Certificate Number: 1760