

UNITED STATES
DEPARTMENT OF THE INTERIOR
BUREAU OF LAND MANAGEMENT

FORM APPROVED
OMB No. 1004-0137
Expires: July 31, 2010

RECEIVED
NOV 13 2013
Bureau of Land Management
Albuquerque Field Office

SUNDRY NOTICES AND REPORTS ON WELLS
Do not use this form for proposals to drill or to re-enter an abandoned well. Use Form 3160-3 (APD) for such proposals.

SUBMIT IN TRIPLICATE - Other instructions on page 2.

1. Type of Well <input type="checkbox"/> Oil Well <input checked="" type="checkbox"/> Gas Well <input type="checkbox"/> Other		5. Lease Serial No. NMSF0790506
2. Name of Operator Hilcorp Energy Company		6. If Indian, Allottee or Tribe Name
3a. Address 382 Road 3100, Aztec, NM 87410		7. If Unit of CA/Agreement, Name and/or No.
3b. Phone No. (include area code) 505-599-3400		8. Well Name and No. San Juan 28-6 Unit 155
4. Location of Well (Footage, Sec., T., R., M., or Survey Description) Surface Unit L (NWSW) 1550' FSL & 1190' FWL, Sec. 28, T28N, R06W		9. API Well No. 30-039-20397
		10. Field and Pool or Exploratory Area Blanco Mesaverde/Basin Dakota
		11. Country or Parish, State Rio Arriba New Mexico

12. CHECK THE APPROPRIATE BOX(ES) TO INDICATE NATURE OF NOTICE, REPORT OR OTHER DATA

TYPE OF SUBMISSION	TYPE OF ACTION			
<input checked="" type="checkbox"/> Notice of Intent	<input type="checkbox"/> Acidize	<input type="checkbox"/> Deepen	<input type="checkbox"/> Production (Start/Resume)	<input type="checkbox"/> Water Shut-Off
<input type="checkbox"/> Subsequent Report	<input type="checkbox"/> Alter Casing	<input type="checkbox"/> Fracture Treat	<input type="checkbox"/> Reclamation	<input type="checkbox"/> Well Integrity
<input type="checkbox"/> Final Abandonment Notice	<input type="checkbox"/> Casing Repair	<input type="checkbox"/> New Construction	<input checked="" type="checkbox"/> Recomplete	<input type="checkbox"/> Other
	<input type="checkbox"/> Change Plans	<input type="checkbox"/> Plug and Abandon	<input type="checkbox"/> Temporarily Abandon	
	<input type="checkbox"/> Convert to Injection	<input type="checkbox"/> Plug Back	<input type="checkbox"/> Water Disposal	

13. Describe Proposed or Completed Operation: Clearly state all pertinent details, including estimated starting date of any proposed work and approximate duration thereof. If the proposal is to deepen directionally or recompleate horizontally, give subsurface locations and measured and true vertical depths of all pertinent markers and zones. Attach the bond under which the work will be performed or provide the Bond No. on file with BLM/BIA. Required subsequent reports must be filed within 30 days following completion of the involved operations. If the operation results in a multiple completion or recompleation in a new interval, a Form 3160-4 must be filed once Testing has been completed. Final Abandonment Notices must be filed only after all requirements, including reclamation, have been completed and the operator has determined that the site is ready for final inspection.)

Hilcorp Energy Company plans to recompleate the subject well in the Mesaverde formation and downhole commingle with the existing Dakota. Attached is the MV C102, recompleate procedure & wellbore schematic. The DHC application will be submitted and approved prior to commingling. A closed loop system will be utilized. Interim reclamation will be performed after surface disturbing activities.

HOLD C104 FOR Density exception

****Please note: MV is pending approval of well density hearing****

BLM'S APPROVAL OR ACCEPTANCE OF THIS ACTION DOES NOT RELIEVE THE LESSEE AND OPERATOR FROM OBTAINING ANY OTHER AUTHORIZATION REQUIRED FOR OPERATIONS ON FEDERAL AND INDIAN LANDS

14. I hereby certify that the foregoing is true and correct. Name (Printed/Typed) Tammy Jones		Title Operations/Regulatory Technician - Sr.
Signature <i>Tammy Jones</i>		Date 11/12/2018

THIS SPACE FOR FEDERAL OR STATE OFFICE USE

Approved by <i>[Signature]</i>	Title PE	Date 12/17/18
Conditions of approval, if any, are attached. Approval of this notice does not warrant or certify that the applicant holds legal or equitable title to those rights in the subject lease which would entitle the applicant to conduct operations thereon.	Office FTO	

Title 18 U.S.C. Section 1001 and Title 43 U.S.C. Section 1212, make it a crime for any person knowingly and willfully to make to any department or agency of the United States any false, fictitious or fraudulent statements or representations as to any matter within its jurisdiction.

(Instruction on page 2)

See Revision

District I

1625 N. French Dr., Hobbs, NM 88240
Phone:(575) 393-6161 Fax:(575) 393-0720

District II

811 S. First St., Artesia, NM 88210
Phone:(575) 748-1283 Fax:(575) 748-9720

District III

1000 Rio Brazos Rd., Aztec, NM 87410
Phone:(505) 334-6178 Fax:(505) 334-6170

District IV

1220 S. St Francis Dr., Santa Fe, NM 87505
Phone:(505) 476-3470 Fax:(505) 476-3462

State of New Mexico
Energy, Minerals and Natural
Resources
Oil Conservation Division
1220 S. St Francis Dr.
Santa Fe, NM 87505

Form C-102
August 1, 2011

Permit 259692

WELL LOCATION AND ACREAGE DEDICATION PLAT

1. API Number 30-039-20397	2. Pool Code 72319	3. Pool Name BLANCO-MESAVERDE (PRORATED GAS)
4. Property Code 318710	5. Property Name SAN JUAN 28 6 UNIT	6. Well No. 155
7. OGRID No. 372171	8. Operator Name HILCORP ENERGY COMPANY	9. Elevation 6605

10. Surface Location

UL - Lot L	Section 28	Township 28N	Range 06W	Lot Idn	Feet From 1550	N/S Line S	Feet From 1190	E/W Line W	County RIO ARRIBA
---------------	---------------	-----------------	--------------	---------	-------------------	---------------	-------------------	---------------	----------------------

11. Bottom Hole Location If Different From Surface

UL - Lot	Section	Township	Range	Lot Idn	Feet From	N/S Line	Feet From	E/W Line	County
12. Dedicated Acres 320.00	13. Joint or Infill	14. Consolidation Code	15. Order No.						

NO ALLOWABLE WILL BE ASSIGNED TO THIS COMPLETION UNTIL ALL INTERESTS HAVE BEEN CONSOLIDATED OR A NON-STANDARD UNIT HAS BEEN APPROVED BY THE DIVISION

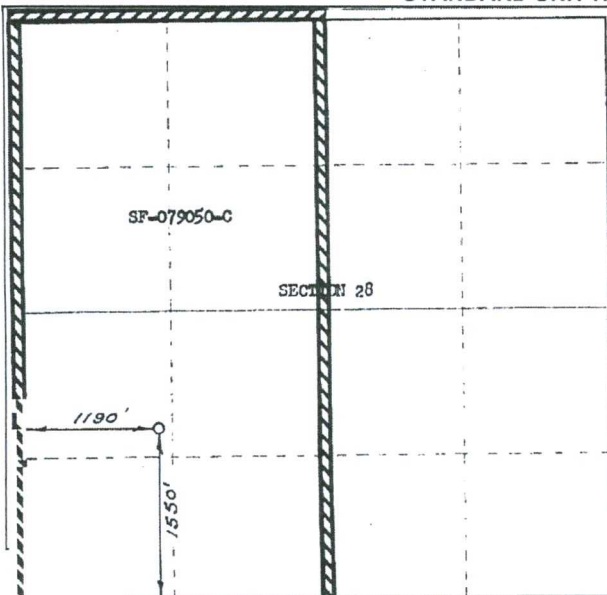

OPERATOR CERTIFICATION

I hereby certify that the information contained herein is true and complete to the best of my knowledge and belief, and that this organization either owns a working interest or unleased mineral interest in the land including the proposed bottom hole location(s) or has a right to drill this well at this location pursuant to a contract with an owner of such a mineral or working interest, or to a voluntary pooling agreement or a compulsory pooling order heretofore entered by the division.

E-Signed By: *Tammy Jones*
Title: Operations/Regulatory Technician - Sr.
Date: 11/12/2018

SURVEYOR CERTIFICATION

I hereby certify that the well location shown on this plat was plotted from field notes of actual surveys made by me or under my supervision, and that the same is true and correct to the best of my belief.

Surveyed By: David Kilven
Date of Survey: 3/11/1971
Certificate Number: 1760



HILCORP ENERGY COMPANY
San Juan 28-6 Unit 155
MESA VERDE RECOMPLETION SUNDRY

JOB PROCEDURES

1. MIRU service rig and associated equipment; test BOP.
2. TOOH with 2 3/8" tubing set at 7,807'.
3. Set a 4-1/2" cast iron bridge plug at +/- 6,100' to isolate the **Dakota**.
4. Pressure test the casing.
5. N/D BOP, N/U frac stack and test frac stack to frac pressure.
6. Perforate and frac the **Mesa Verde** (Top Perforation @ 4,934'; Bottom Perforation @ 6,050').
7. Nipple down frac stack, nipple up BOP and test.
8. TIH with a mill and drill out top isolation plug and **Mesa Verde** frac plugs.
9. Clean out to **Dakota** isolation plug.
10. Drill out **Dakota** isolation plug and cleanout to PBTD of 7,895'. TOOH.
11. TIH and land production tubing.



HILCORP ENERGY COMPANY
San Juan 28-6 Unit 155
MESA VERDE RECOMPLETION SUNDRY

San Juan 28-6 Unit 155 - CURRENT WELLBORE SCHEMATIC



Current Schematic - Version 3

Well Name: **SAN JUAN 28-6 UNIT #155**

API / UWI 3003920397	Surface Legal Location 028-028N-006W-L	Field Name BASIN DAKOTA (PRORATED GAS)	Route 1302	State/Province NEW MEXICO	Well Configuration Type
Ground Elevation (ft) 6,605.00	Original KB RT Elevation (ft) 6,616.00	KB-Ground Distance (ft) 11.00	KB-Casing Flange Distance (ft)	KB-Tubing Hanger Distance (ft)	

Original Hole, 11/12/2018 9:59:46 AM

