

District I
1625 N. French Dr., Hobbs, NM 88240
District II
1301 W. Grand Avenue, Artesia, NM 88210
District III
1000 Rio Brazos Road, Aztec, NM 87410
District IV
1220 S. St. Francis Dr., Santa Fe, NM 87505

State of New Mexico
Energy Minerals and Natural Resources

Form C-101
May 27, 2004

Oil Conservation Division
1220 South St. Francis Dr.
Santa Fe, NM 87505

Submit to appropriate District Office

AMENDED REPORT

APPLICATION FOR PERMIT TO DRILL, RE-ENTER, DEEPEN, PLUGBACK, OR ADD A ZONE

¹ Operator Name and Address Devon Energy Production Company, L.P. PO Box 6459 Navajo Dam, NM 87419		² OGRID Number 6137
³ Property Code 19641	⁵ Property Name Northeast Blanco Unit	⁴ API Number 30-039-29880
⁹ Proposed Pool 1 Basin Fruitland Coal		⁶ Well No. 429A
⁹ Proposed Pool 1		¹⁰ Proposed Pool 2

⁷ Surface Location

UL or lot no.	Section	Township	Range	Lot Idn	Feet from the	North/South line	Feet from the	East/West line	County
O	8	30N	7W		675'	South	2,235'	East	Rio Arriba

⁸ Proposed Bottom Hole Location If Different From Surface

UL or lot no.	Section	Township	Range	Lot Idn	Feet from the	North/South line	Feet from the	East/West line	County
C	17	30N	7W		700'	North	1,945'	West	Rio Arriba

Additional Well Information

¹¹ Work Type Code N	¹² Well Type Code G	¹³ Cable/Rotary Rotary	¹⁴ Lease Type Code Fee	¹⁵ Ground Level Elevation 6,138'
¹⁶ Multiple N	¹⁷ Proposed Depth 4,001'	¹⁸ Formation Fruitland Coal	¹⁹ Contractor	²⁰ Spud Date Unknown
Depth to Groundwater >100'		Distance from nearest fresh water well >1,000'		Distance from nearest surface water >1,000'
Pit: Liner: Synthetic <input checked="" type="checkbox"/> 12_mils thick Clay <input type="checkbox"/>		Pit Volume: ___ bbs		Drilling Method:
Closed-Loop System <input type="checkbox"/>		Fresh Water <input checked="" type="checkbox"/> Brine <input type="checkbox"/> Diesel/Oil-based <input type="checkbox"/> Gas/Air <input checked="" type="checkbox"/>		

²¹ Proposed Casing and Cement Program

Hole Size	Casing Size	Casing weight/foot	Setting Depth	Sacks of Cement	Estimated TOC
12 1/4"	9 5/8"	32#	0-285'	200	Surface
8 3/4"	7"	23#	0-3,425'	575	Surface
6 1/4"	4 1/2"	11.6#	0-TD	700	Surface

²² Describe the proposed program. If this application is to DEEPEN or PLUG BACK, give the data on the present productive zone and proposed new productive zone. Describe the blowout prevention program, if any. Use additional sheets if necessary.

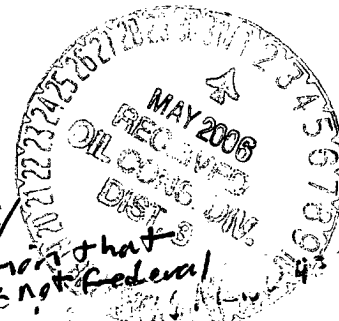

HOLD C184 FOR Directional Survey and BLM confirmation that surveyed BHL is not Federal

²³ I hereby certify that the information given above is true and complete to the best of my knowledge and belief. I further certify that the drilling pit will be constructed according to NMOCD guidelines <input checked="" type="checkbox"/> , a general permit <input type="checkbox"/> , or an (attached) alternative OCB approved plan <input type="checkbox"/> .	OIL CONSERVATION DIVISION	
	Approved by:	<i>[Signature]</i>
Printed name: Melisa Zimmerman	Title: DEPUTY OIL & GAS INSPECTOR, DIST. 43	
Title: Senior Operations Technician	Approval Date: 05/18/06	Expiration Date: MAY 18 2007
E-mail Address: Melisa.zimmerman@dvn.com		
Date: 4-27-06	Phone: 505-632-0244	Conditions of Approval Attached <input type="checkbox"/>

3

This shows as Fed on
Ongard and mixed
on the BLM's system
- We need to see where
the Directional survey
puts the BHL and check
that with the BLM.

S ~~A~~

District I
 PO Box 1980, Hobbs NM 88241-1980
 District II
 PO Drawer KK, Artesia, NM 87211-0719
 District III
 1000 Rio Brazos Rd., Aztec, NM 87410
 District IV
 PO Box 2088, Santa Fe, NM 87504-2088

State of New Mexico
 Energy, Minerals & Natural Resources Department

OIL CONSERVATION DIVISION
 PO Box 2088
 Santa Fe, NM 87504-2088

Form C-102
 Revised February 21, 1994
 Instructions on back
 Submit to Appropriate District Office
 State Lease - 4 Copies
 Fee Lease - 3 Copies

AMENDED REPORT

WELL LOCATION AND ACREAGE DEDICATION PLAT

1 API Number 30-039-29886		2 Pool Code 76629		3 Pool Name Basin Frontland Coal	
4 Property Code 19641		5 Property Name NEBU			6 Well Number # 429A
7 OGRID No. 6137		8 Operator Name Devon Energy Production Company, L.P.			9 Elevation 6138

10 Surface Location

UL or Lot No.	Section	Township	Range	Lot Idn	Feet from the	North/South line	Feet from the	East/West line	County
O	8	30 N	7 W		675	SOUTH	2235	EAST	Rio Arriba

11 Bottom Hole Location If Different From Surface

7 UL or lot no.	Section	Township	Range	Lot Idn	Feet from the	North/South line	Feet from the	East/West line	County
C	17	30 N	7 W	1	700	NORTH	1945	WEST	Rio Arriba

12 Dedicated Acres 320-N/A	13 Joint or Infill	14 Consolidation Code	15 Order No.
-------------------------------	--------------------	-----------------------	--------------

NO ALLOWABLE WILL BE ASSIGNED TO THIS COMPLETION UNTIL ALL INTERESTS HAVE BEEN CONSOLIDATED OR A NON-STANDARD UNIT HAS BEEN APPROVED BY THE DIVISION

16

Section 8
Section 17

Bottom Hole Location
700' F/NL 1945' F/WL

Azimuth - 218°56' 1765'

675'

2235'

5289(R)

2640(R)

2640(R)

17 OPERATOR CERTIFICATION

I hereby certify that the information contained herein is true and complete to the best of my knowledge and belief.

Signature

Printed Name
 Melissa Tommerman

Title
 Sr. Operations Technician

Date
 April 27, 2006

18 SURVEYOR CERTIFICATION

I hereby certify that the well location shown on this plat was plotted from field notes of actual surveys made by me or under my supervision, and that the same is true and correct to the best of my belief.

September 23, 2004

Date of Survey

Signature and Seal of Professional Surveyor

7016
 Certificate Number

17

(R) - GLO Record

Submit 3 Copies To Appropriate District Office
 District I
 1625 N. French Dr., Hobbs, NM 88240
 District II
 1301 W. Grand Ave., Artesia, NM 88210
 District III
 1000 Rio Brazos Rd., Aztec, NM 87410
 District IV
 1220 S. St. Francis Dr., Santa Fe, NM 87505

State of New Mexico
 Energy, Minerals and Natural Resources

Form C-103
 March 4, 2004

OIL CONSERVATION DIVISION
 1220 South St. Francis Dr.
 Santa Fe, NM 87505

WELL API NO. 30-039-29886
5. Indicate Type of Lease STATE <input type="checkbox"/> FEE <input checked="" type="checkbox"/>
6. State Oil & Gas Lease No.

SUNDRY NOTICES AND REPORTS ON WELLS (DO NOT USE THIS FORM FOR PROPOSALS TO DRILL OR TO DEEPEN OR PLUG BACK TO A DIFFERENT RESERVOIR. USE "APPLICATION FOR PERMIT" (FORM C-101) FOR SUCH PROPOSALS.)		7. Lease Name or Unit Agreement Name NORTHEAST BLANCO UNIT
1. Type of Well: Oil Well <input type="checkbox"/> Gas Well <input checked="" type="checkbox"/> Other	2. Name of Operator Devon Energy Production Company, L.P.	8. Well Number 429A
3. Address of Operator PO Box 6459, Navajo Dam, NM 87419	9. OGRID Number 6137	10. Pool name or Wildcat Basin Fruitland Coal
4. Well Location Unit Letter <u>O</u> : <u>675'</u> feet from the <u>South</u> line and <u>2,235'</u> feet from the <u>East</u> line Section <u>8</u> Township <u>30N</u> Range <u>7W</u> NMPM County - <u>SAN JUAN</u>		
11. Elevation (Show whether DR, RKB, RT, GR, etc.) GR 6,138'		
Pit or Below-grade Tank Application (For pit or below-grade tank closures, a form C-144 must be attached) Pit Location: UL _____ Sect _____ Twp _____ Rng _____ Pit type <u>Drilling</u> Depth to Groundwater <u>>100'</u> Distance from nearest fresh water well <u>>1000'</u> Distance from nearest surface water <u>>1000'</u> Below-grade Tank Location UL _____ Sect _____ Twp _____ Rng _____ ; _____ feet from the _____ line and _____ feet from the _____ line		

12. Check Appropriate Box to Indicate Nature of Notice, Report or Other Data
 NOTICE OF INTENTION TO:

- PERFORM REMEDIAL WORK PLUG AND ABANDON
 TEMPORARILY ABANDON CHANGE PLANS
 PULL OR ALTER CASING MULTIPLE COMPLETION
 OTHER: **CONSTRUCT DRILLING PIT**

SUBSEQUENT REPORT OF:

- REMEDIAL WORK ALTERING CASING
 COMMENCE DRILLING OPNS. PLUG AND ABANDONMENT
 CASING TEST AND CEMENT JOB
 OTHER:

13. Describe proposed or completed operations. (Clearly state all pertinent details, and give pertinent dates, including estimated date of starting any proposed work). SEE RULE 1103. For Multiple Completions: Attach wellbore diagram of proposed completion or recompletion.

14. **Devon Energy will be constructing a lined drilling pit. The closure of said pit will be in accordance with the NMOCD regulations with the cutting of the liner applying to the BLM rules.**

I hereby certify that the information above is true and complete to the best of my knowledge and belief. I further certify that any pit or below-grade tank has been/will be constructed or closed according to NMOCD guidelines , a general permit or an (attached) alternative OCD-approved plan .

SIGNATURE M. Zimmerman TITLE Sr. Operations Technician DATE 4-27-06

Type or print name Melisa Zimmerman E-mail address: Melisa.zimmerman@dvn.com Telephone No. 405-552-7917

(This space for State use)

APPROVED BY [Signature] TITLE DEPUTY OIL & GAS INSPECTOR, DIST. IV DATE MAY 18 2006

Conditions of approval, if any:

PAD LAYOUT PLAN & PROFILE
DEVON ENERGY PRODUCTION COMPANY, L.P.

Nebu # 429A
 675' F/SL 2235' F/EL
 SEC. 8, T30N, R7W, N.M.P.M.
 RIO ARRIBA COUNTY, NEW MEXICO

Lat: 36°49'18"
 Long: 107°35'35"

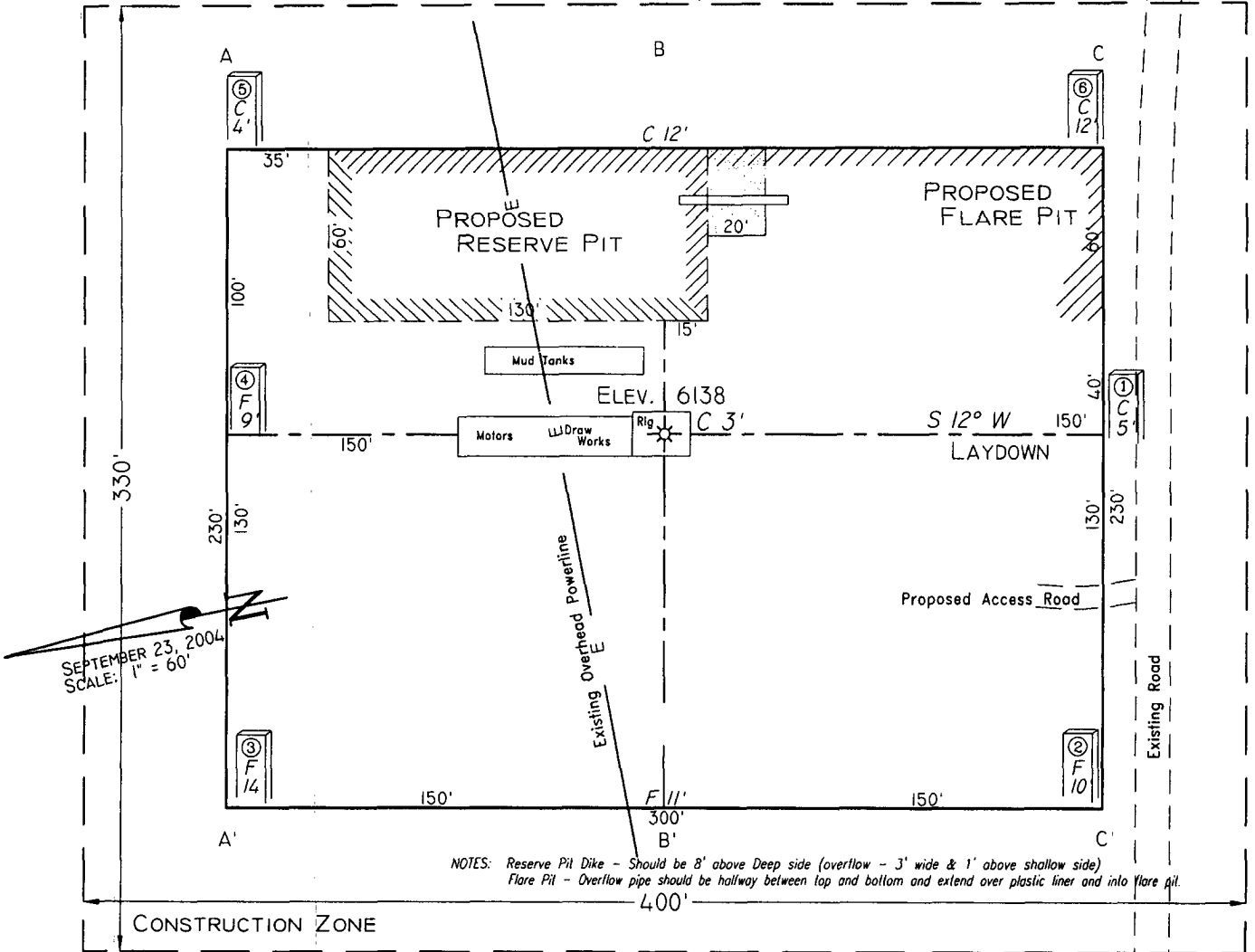

NOTES: Reserve Pit Dike - Should be 8' above Deep side (overflow - 3' wide & 1' above shallow side)
 Flare Pit - Overflow pipe should be halfway between top and bottom and extend over plastic liner and into flare pit.

Area of Construction Zone - 330'x400' or 3.03 acres, more or less.

SCALE: 1"=60'-HORIZ.
 1"=40'-VERT.

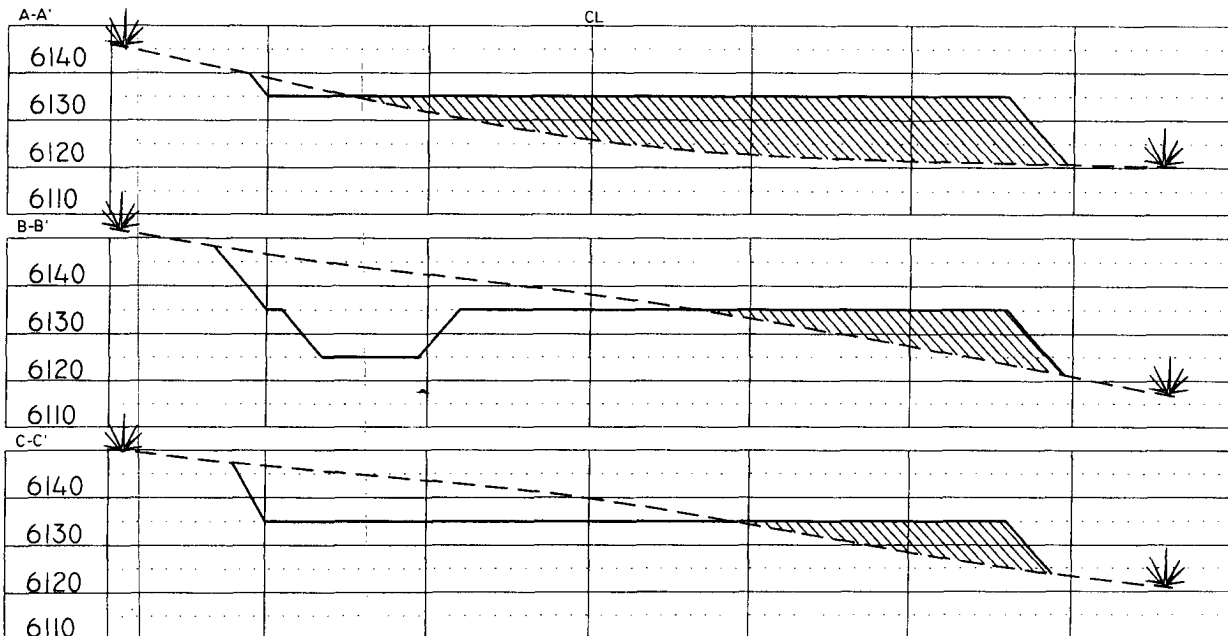

NOTE: Contractor should call One-Call for location of any marked or unmarked buried pipelines or cables on well pad and/or access road at least two (2) working days prior to construction.

Cuts and fills shown are approximate - final finished elevation is to be adjusted so earthwork will balance. Corner stakes are approximate and do not include additional areas needed for sideslopes and drainages. Final Pad Dimensions are to be verified by Contractor.

VANN SURVEYS
 P. O. Box 1306
 Farmington, NM

**NEBU 429A
Unit C 17-30N-7W
Rio Arriba Co., NM**

DRILLING PLAN

1. ESTIMATED TOPS OF IMPORTANT GEOLOGIC MARKERS & ANTICIPATED WATER, OIL, GAS OR MINERAL FORMATIONS:

Formation	TVD (ft)	TMD (ft)	Hydrocarbon/Water Bearing Zones
San Jose	Surface	Surface	
Ojo Alamo	2055	2721	Aquifer
Kirtland	2235	2936	
Fruitland	2695	3425	Gas
Fruitland 1 st Coal	2885	3616	Gas
Pictured Cliffs	3170	3901	Gas
PTD	3270	4001	

All shows of fresh water and minerals will be adequately protected and reported. A 100' sump will be drilled into the Picture cliffs. A mud logger will be on location collecting samples and measuring gas levels. Should the Picture Cliffs interval appear to be productive the sump will be filled with cuttings and abandoned

2. PRESSURE CONTROL EQUIPMENT:

All well control equipment shall be in accordance with Onshore Order #2 for 2M systems.

The minimum specifications for pressure control equipment that will be provided are included on the attached schematic diagram, which shows the size, and pressure ratings.

- 2000# BOP With Pipe Rams and 2000# BOP With Blind Rams

Auxiliary equipment to be used:

- Upper kelly cock with handle available.

The manifold includes appropriate valves and adjustable chokes. The kill line will have one check valve. Ram type preventers will be pressure tested to full working pressure (utilizing a test plug) or 70% of the internal yield pressure (without a test plug) at:

- Initial installation
- Whenever any seal subject to test pressure is broken
- Following related repairs
- At 30 day intervals

Pipe and blind rams shall be activated each trip.

A BOPE pit level drill will be conducted weekly for each drilling crew.
All tests and drills will be recorded in the drilling log.

The accumulator will have sufficient capacity to close all rams and retain 200 psi above pre-charge pressure without the use of closing unit pumps.

Master controls will be at the accumulator. Anticipated bottom hole pressure is 1000 psi.

3. CASING & CEMENTING PROGRAM:

A. The proposed casing program will be as follows:

TVD	TMD	Hole Size	Size	Grade	Weight	Thread	Condition
0-285	0-285	12-1/4"	9-5/8"	H-40	32#	STC	New
0-2695	0-3425	8-3/4"	7"	J-55	23#	LTC	New
0- TD	0- TD	6-1/4"	5-1/2"*	J-55	15.5 #	LTC	New

The 9-5/8" surface pipe will be tested to 750 psi. All casing strings below the surface shoe shall be pressure tested to 0.22 psi/ft. of casing string length or 1500 psi, whichever is greater, but not to exceed 70% minimum internal yield.

Surface: The bottom three joints of the surface casing will have a minimum of one centralizer per joint and one centralizer every joint thereafter (Total 5 centralizers estimated)

7" Casing: The bottom three joints of the 7" casing will have a minimum of one centralizer per joint and one centralizer every fifth joint thereafter to above Ojo Alamo with turbolizers below and throughout the Ojo Alamo. (Total 12 centralizers, 3 turbolizers estimated).

B. The proposed cementing program will be as follows:

Surface String: 9-5/8" Surface cemented in a 12-1/4" hole at 285'.
32.3# H-40 ST&C 8 Rnd
Saw tooth guide shoe
Cemented with 200 sacks Class B mixed at 15.6 ppg w/.25 pps Celloflake, 2% calcium chloride. Yeild 1.19 ft3/sx. *
Cement designed to circulate to surface.

*** Minor variations possible due to existing hole conditions**

Production String: 7" Production casing cemented in an 8-3/4" hole
23# J-55 LT&C 8 Rnd
Float collar

Joint
 Float Shoe
 Cement with
Lead: 500 sacks Class B 50/50 POZ, 3% gel, 5# gilsonite, ¼"# Flocele, .1% CFR 3, .2% Halad 344, yield 1.47 ft3/sx.
Tail: 25 sx Class 'B'. 1.18 ft3/sx. *
 Cement designed to circulate to surface.
 Pending hole conditions, cement baskets may be installed above TD

** Minor variations possible due to existing hole conditions.*

Liner: 5-1/2" liner*
 15.5# J-55 LT&C 8 Rnd
 Shoe
 Not Cemented

* May not be run pending hole conditions.
 If well does not respond to proposed to completion, the 5 ½ " liner will be cemented using 300 sacks class B 50/50 POZ, 3% gel, 5# gilsonite, ¼"# Flocele, .1% CFR 3, .2% Halad 344, yield 1.47 ft3/sx. **

*** Minor variations possible due to existing hole conditions*

4. DRILLING FLUIDS PROGRAM:

TVD	TMD	Type	Weight (ppg)	Viscosity	pH	Water Loss	Remarks
0-285	0-285	Spud	8.4-9.0	29-70	8.0	NC	FW gel,
285-2695	285-3425	LSND	8.4-9.0	29-70	8.0	10-12	LCM as needed
2695 - TD	3425 - TD	Air					Foam as needed

NC = no control

Sufficient quantities of mud material will be maintained on site or be readily accessible for the purpose of assuring well control. SPR will be recorded on daily drilling report after mudding up. Visual mud monitoring will be conducted during operations.

5. EVALUATION PROGRAM:

Wireline Logs: None

Mud Logs: mud logging in Fruitland Coal.

Well Control Equipment 2,000 psi Configuration

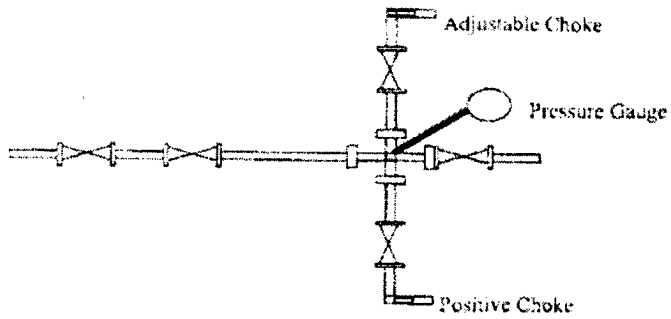
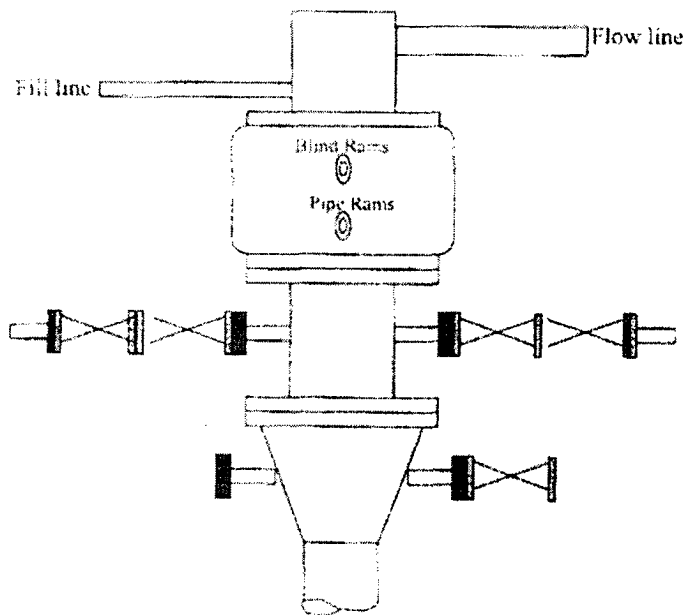

All well control equipment designed to meet or exceed the Onshore Oil and Gas Order No. 2, BLM 43 CFR 3160 requirements for 2M systems.

Survey: Deviation surveys will be taken every 500' from 0-TD of 8 3/4" hole or first succeeding bit change.

Cores: None anticipated.

DST's: None anticipated.

6. ABNORMAL CONDITIONS:

The Fruitland Coal will be encountered in the 8 3/4" hole. Estimated formation pressure is 300 psi. No other abnormal pressures and/or temperatures are expected. No hydrogen sulfide should be present.

7. OTHER INFORMATION:

The anticipated starting date and duration of the operation will be as follows:

Starting Date:	Upon Approval
Duration:	20 days

If the well is completed as a dry hole or as a producer, Well Completion or Recompletion Report and Log (Form 3160-4) will be submitted within 30 days after completion of the well or after completion of operations being performed, in accordance with 43 CFR 3160. Copies of all logs, core descriptions, core analyses, well test data, geologic summaries, sample descriptions, daily drilling reports, daily completion reports, and all other surveys or data obtained and compiled during the drilling, completion, and/or workover operations, will be submitted directly to the Authorized Officer or filed with Form 3160-4.

Company: Devon Energy
Lease/Well: NEBU 429 A
Location: Rio Arriba Cnty Sec. 8-30N-7W
State/Country: NM

