

UNITED STATES
DEPARTMENT OF THE INTERIOR
BUREAU OF LAND MANAGEMENT

FORM APPROVED
OMB No. 1004-0136
Expires November 30, 2000

APPLICATION FOR PERMIT TO DRILL OR REENTER

1a. Type of Work: <input checked="" type="checkbox"/> DRILL <input type="checkbox"/> REENTER		5. Lease Serial No. SF-078999
1b. Type of Well: <input type="checkbox"/> Oil Well <input checked="" type="checkbox"/> Gas Well <input type="checkbox"/> Other <input type="checkbox"/> Single Zone <input checked="" type="checkbox"/> Multiple Zone		6. If Indian, Allottee or Tribe Name
2. Name of Operator CONOCOPHILLIPS COMPANY		7. If Unit or CA Agreement, Name and No.
Contact: VICKI WESTBY E-Mail: Vicki.R.Westby@conocophillips.com		8. Lease Name and Well No. SAN JUAN 31-6 UNIT 218A
3a. Address 4001 PENBROOK ODESSA, TX 79762	3b. Phone No. (include area code) Ph: 915-368-1352	9. API Well No. 30-039-29422
4. Location of Well (Report location clearly and in accordance with any State requirements) At surface B 100' N 1330' E Sec 3 T30N R6W NESE 1704 FCL 503 FEE		10. Field and Pool, or Exploratory BASIN FRUITLAND COAL
At proposed prod. zone 0 1000'S 1430'E Sec 34 T30N R6W NESE 1704 FCL 503 FEE		11. Sec., T., R., M., or Blk. and Survey or Area 3 Sec 34 T30N R6W Mer NMP
14. Distance in miles and direction from nearest town or post office*		12. County or Parish RIO ARRIBA
15. Distance from proposed location to nearest property or lease line, ft. (Also to nearest drig. unit line, if any)		13. State NM
16. No. of Acres in Lease 2560.00		17. Spacing Unit dedicated to this well 320 F/2 Sec 34 T31N R6W
18. Distance from proposed location to nearest well, drilling, completed, applied for, on this lease, ft.		20. BLM/BIA Bond No. on file
19. Proposed Depth 3398 MD		21. Elevations (Show whether DF, KB, RT, GL, etc.) GL 6443
22. Approximate date work will start		23. Estimated duration

24. Attachments

The following, completed in accordance with the requirements of Onshore Oil and Gas Order No. 1, shall be attached to this form:

- | | |
|---|--|
| 1. Well plat certified by a registered surveyor. | 4. Bond to cover the operations unless covered by an existing bond on file (see Item 20 above). |
| 2. A Drilling Plan. | 5. Operator certification |
| 3. A Surface Use Plan (if the location is on National Forest System Lands, the SUPO shall be filed with the appropriate Forest Service Office). | 6. Such other site specific information and/or plans as may be required by the authorized officer. |

25. Signature (Electronic Submission)	Name (Printed/Typed) VICKI WESTBY Ph: 915-368-1352	Date 01/26/2005
Title AGENT		
Approved by (Signature) <i>[Signature]</i>	Name (Printed/Typed)	Date 5/15/06
Title APM	Office FFO	

Application approval does not warrant or certify the applicant holds legal or equitable title to those rights in the subject lease which would entitle the applicant to conduct operations thereon.
Conditions of approval, if any, are attached.

Title 18 U.S.C. Section 1001 and Title 43 U.S.C. Section 1212, make it a crime for any person knowingly and willfully to make to any department or agency of the United States any false, fictitious or fraudulent statements or representations as to any matter within its jurisdiction.

Additional Operator Remarks (see next page)

HOLD G104 FOR directional survey

Electronic Submission #53427 verified by the BLM Well Information System
For CONOCOPHILLIPS COMPANY, sent to the Farmington

This action is subject to technical and procedural review pursuant to 43 CFR 3165.3 and 43 CFR 3165.4

This action is subject to technical and procedural review pursuant to 43 CFR 3165.3 and appeal pursuant to 43 CFR 3165.4

DRILLING OPERATIONS AUTHORIZED ARE SUBJECT TO COMPLIANCE WITH ATTACHED "GENERAL REQUIREMENTS".

**** OPERATOR-SUBMITTED ** OPERATOR-SUBMITTED ** OPERATOR-SUBMITTED ****

NMOCD

5

2006 MAY 11 PM 10 11

RECEIVED
070 FARMINGTON NM

State of New Mexico
Energy, Minerals & Natural Resources Department
OIL CONSERVATION DIVISION
1220 South St. Francis Dr.
Santa Fe, NM 87505

District I
1625 N. French Dr., Hobbs, NM 88240
District II
1301 W. Grand Avenue, Artesia, NM 88210
District III
1000 Rio Brazos Rd., Aztec, NM 87410
District IV
1220 S. St. Francis Dr., Santa Fe, NM 87505

Form C-102
Revised June 10, 2003
Submit to Appropriate District Office
State Lease - 4 Copies
Fee Lease - 3 Copies
 AMENDED REPORT

WELL LOCATION AND ACREAGE DEDICATION PLAT

*API Number 30-039-29422		*Pool Code 71629		*Pool Name BASIN FRUITLAND COAL (GAS)			
*Property Code 31328		*Property Name SAN JUAN 31-6 UNIT				*Well Number 218A	
*OCRID No. 217817		*Operator Name CONOCOPHILLIPS COMPANY				*Elevation 6443	
*Surface Location							
UL or lot no. B	Section 3	Township 30N	Range 06W	Lot Idn 100	Feet from the North/South line NORTH	Feet from the East/West line 1330	County RIO ARRIBA
*Bottom Hole Location if Different From Surface							
UL or lot no. 0	Section 34	Township 31N	Range 06W	Lot Idn 1000	Feet from the North/South line SOUTH	Feet from the East/West line 1430	County RIO ARRIBA
*Dedicated Acres E/2 320.0		*Joint or Infill		*Consolidation Code		*Order No.	

NO ALLOWABLE WILL BE ASSIGNED TO THIS COMPLETION UNTIL ALL INTERESTS HAVE BEEN CONSOLIDATED OR A NON-STANDARD UNIT HAS BEEN APPROVED BY THE DIVISION

16

34

LEASE
SF-078999

BHL

Surface

LAT: 36.84856° N
LONG: 107.44517° W
DATUM: NAD27

LAT: 36.50'54.9" N
LONG: 107.26'44.8" W
DATUM: NAD83

3

S89°56'E 5270.76'

17 OPERATOR CERTIFICATION

I hereby certify that the information contained herein is true and complete to the best of my knowledge and belief.

Virgil Chavez

Signature
Virgil Chavez
Printed Name
Projects & Operations Lead
Title and E-mail Address
April 21, 2006
Date

18 SURVEYOR CERTIFICATION

I hereby certify that the well location shown on this plat was plotted from field notes of actual surveys made by me or under my supervision, and that the same is true and correct to the best of my belief.

Date of Survey: 02/24/06
Signature and Seal of Surveyor:

Certificate Number: 1728

Submit 3 Copies To Appropriate District Office
 District I
 1625 N. French Dr., Hobbs, NM 88240
 District II
 1301 W. Grand Ave., Artesia, NM 88210
 District III
 1000 Rio Brazos Rd., Aztec, NM 87410
 District IV
 1220 S. St. Francis Dr., Santa Fe, NM 87505

State of New Mexico
 Energy, Minerals and Natural Resources

Form C-103
 May 27, 2004

OIL CONSERVATION DIVISION
 1220 South St. Francis Dr.
 Santa Fe, NM 87505

WELL API NO. 30-039-29422	
5. Indicate Type of Lease STATE <input type="checkbox"/> FEE <input type="checkbox"/>	
6. State Oil & Gas Lease No.	
7. Lease Name or Unit Agreement Name SAN JUAN 31-6 UNIT	
8. Well Number	218A
9. OGRID Number	217817
10. Pool name or Wildcat Basin Fruitland Coal	

SUNDRY NOTICES AND REPORTS ON WELLS
 (DO NOT USE THIS FORM FOR PROPOSALS TO DRILL OR TO DEEPEN OR PLUG BACK TO A DIFFERENT RESERVOIR. USE 'APPLICATION FOR PERMIT' (FORM C-101) FOR SUCH PROPOSALS.)

1. Type of Well: Oil Well Gas Well Other

2. Name of Operator
ConocoPhillips Company

3. Address of Operator
4001 Penbrook, Odessa, TX 79762

4. Well Location
 Unit Letter **I** ~~100~~ feet from the **North** line and ~~1701~~ feet from the **South** line and ~~362~~ feet from the **East** line
 Section **243** Township **30N** Range **6W** NMPM Rio Arriba County

11. Elevation (Show whether DR, RKB, RT, GR, etc.)
6443 ~~6470~~ GL

Pit or Below-grade Tank Application Closure **> 1000'**

Pit type **DRILL** Depth to Groundwater **> 100'** Distance from nearest fresh water well **> 1 Mile** Distance from nearest surface water **> 200' < 1000'**

Liner Thickness: mil Below-Grade Tank: Volume bbls; Construction Material

12. Check Appropriate Box to Indicate Nature of Notice, Report or Other Data

NOTICE OF INTENTION TO:		SUBSEQUENT REPORT OF:	
PERFORM REMEDIAL WORK <input type="checkbox"/>	PLUG AND ABANDON <input type="checkbox"/>	REMEDIAL WORK <input type="checkbox"/>	ALTERING CASING <input type="checkbox"/>
TEMPORARILY ABANDON <input type="checkbox"/>	CHANGE PLANS <input type="checkbox"/>	COMMENCE DRILLING OPNS. <input type="checkbox"/>	P AND A <input type="checkbox"/>
PULL OR ALTER CASING <input type="checkbox"/>	MULTIPLE COMPL <input type="checkbox"/>	CASING/CEMENT JOB <input type="checkbox"/>	
OTHER: <input type="checkbox"/>		OTHER: <input type="checkbox"/>	

13. Describe proposed or completed operations. (Clearly state all pertinent details, and give pertinent dates, including estimated date of starting any proposed work). SEE RULE 11.03. For Multiple Completions: Attach wellbore diagram of proposed completion or recompletion.

The pit will be constructed and closed in accordance with Rule 50 and as per the Nov. 1, 2004 Guidelines. See the attached diagram that details the location of the pit in reference to the proposed wellhead. The drill pit will be lined. The drill pit will be closed after the well has been completed. The solids left after the water has been disposed of will be sampled and NMOCD approval will be obtained prior to closure of this pit.

I hereby certify that the information above is true and complete to the best of my knowledge and belief. I further certify that any pit or below-grade tank has been/will be constructed or closed according to NMOCD guidelines , a general permit or an (attached) alternative OCD-approved plan

SIGNATURE Vicki Westby TITLE Staff Agent DATE 1/26/05

Type or print name For State Use Only E-mail address: Telephone No.

APPROVED BY:  TITLE DEPUTY OIL & GAS INSPECTOR, DIST. 20 DATE MAY 17 2006

Conditions of Approval (if any):

CONOCOPHILLIPS COMPANY SAN JUAN 31-6 UNIT #218A
 1701' FSL & 563' FEL, SECTION 34, T31N, R06W, NMPM
 RIO ARRIBA COUNTY, NEW MEXICO ELEVATION: 6470'

LATITUDE: 36.85349° N
 LONGITUDE: 107.44262° W
 DATUM: NAD27

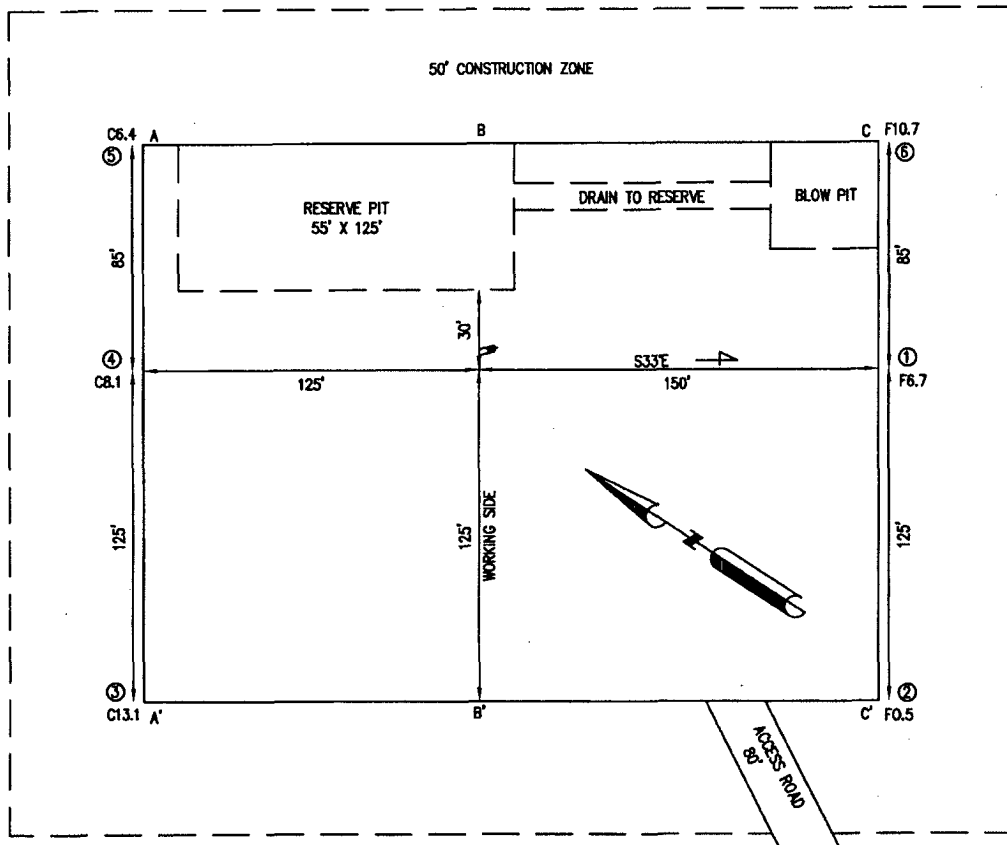

PLAT NOTE:
 SURFACE OWNER
 BLM

A-A'						
6480'						
6470'						
6460'						
6450'						

B-B'						
6480'						
6470'						
6460'						
6450'						

C-C'						
6480'						
6470'						
6460'						
6450'						

PROJECT PROPOSAL - New Drill / Sidetrack

SAN JUAN 31-6 218A

Lease:		AFE #: WAN.CBM.6119		AFE \$:	
Field Name: 31-6		Rig: 320-2419		State: NM County: RIO ARRIBA	
Geoscientist: Wentz, Robert M.		Phone: 832-486-2056		Prod. Engineer: Bergman, Pat W. Phone: (832) 486-2358	
Res. Engineer: Stasney, Janet F.		Phone: +832 486-2359		Proj. Field Lead: Phone:	

Primary Objective (Zones):	
Zone	Zone Name
JCV	BASIN FRUITLAND COAL (GAS)

Location: Surface		Datum Code: NAD 27		Deviated	
Latitude: 36.848560	Longitude: -107.445170	X:	Y:	Section: 3	Range: 6W
Footage X: 1330 FEL	Footage Y: 100 FNL	Elevation: 6443	(FT)	Township: 30N	

Location: Bottom Hole		Datum Code: NAD 27		Deviated	
Latitude: 36.851611	Longitude: -107.445427	X:	Y:	Section: 34	Range: 6W
Footage X: 1430 FEL	Footage Y: 1000 FSL	Elevation:	(FT)	Township: 31N	
Tolerance: 100					

Location Type:	Start Date (Est.):	Completion Date:	Date In Operation:
Formation Data: Assume KB = 6459 Units = FT			

Formation Call & Casing Points	Depth (TVD in Ft)	SS (Ft)	Depletion (Yes/No)	BHP (PSIG)	BHT	Remarks
SAN JOSE	16	6443	<input type="checkbox"/>			
Surface Casing	216	6243	<input type="checkbox"/>			12-1/4 hole. 9 5/8" 32.3 ppf, H-40, STC casing. Circulate cement to surface.
NCMT	1389	5070	<input type="checkbox"/>			
CJAM	2479	3980	<input type="checkbox"/>			Possible water flows.
KRLD	2569	3890	<input type="checkbox"/>			
FRLD	2994	3465	<input type="checkbox"/>			Possible gas.
Intermediate Casing	3114	3345	<input type="checkbox"/>			8 3/4" Hole. 7", 23 ppf, J-55, LTC Casing, Special Drift to 6.25". Circulate cement to surface.
TOP COAL	3144	3315	<input type="checkbox"/>			
BASE MAIN COAL	3294	3165	<input type="checkbox"/>	300		
Total Depth	3374	3085	<input type="checkbox"/>			6-1/4" hole possibly underreamed to 9.5". Optional Liner: 5.5", 15.5#, J-55 LTC - left uncemented.
PC TONGUE	3404	3055	<input type="checkbox"/>			
BASE LOWEST COAL	3414	3045	<input type="checkbox"/>			
PCCF	3424	3035	<input type="checkbox"/>			

Reference Wells:		
Reference Type	Well Name	Comments
Intermediate	31-6 #218	
Intermediate	31-6 #217	
Intermediate	31-6 #217A	
Intermediate	Rosa Unit #5A	
Intermediate	31-6 #211A	
Intermediate	31-6 #231	
Intermediate	31-6 #204A	

PROJECT PROPOSAL - New Drill / Sidetrack

SAN JUAN 31-6 218A

Logging Program:

Intermediate Logs: Log only if show GR/ILD Triple Combo

TD Logs: Triple Combo Dipmeter RFT Sonic VSP TDT

Additional Information:

Log Type	Stage	From (Ft)	To (Ft)	Tool Type/Name	Remarks
----------	-------	-----------	---------	----------------	---------

Comments: Location/Tops/Logging - Non-prospective lowest coal.

Zones - Drill and complete Fruitland Coal well.
Mud Log from intermediate casing shoe to TD will be obtained.

Drilling Mud Program:

Surface: spud mud

Intermediate: fresh water mud with bentonite and polymer as needed

Below Intermediate: air/mist drilling media with foamer, polymer, & corrosion inhibitor as needed

General/Work Description - Provide funds to drill and complete the Fruitland Coal formation in the San Juan 31-6 #218A, located in the SE 1/4 of Section 34, T31N, R6W, Basin Fruitland Coal Field, Rio Arriba County, New Mexico.

Location revised to a directional well drilled from section 3 to 1000' FSL and 1430' FEL of 31-6 section 34. The well has a BHL hardline = 1310' FSL & 1330' FEL (100' target radius).

The GL elevation = 6443' from survey plat and tops have been edited for a 6459' KB elevation (16' RKB).

Total depth must be above the PCCF formation as "formation tops" indicate.

Mud log from intermediate casing shoe to TD will be obtained.

San Juan 31-6 #218A

TVD - MD Formation Tops

Formation	TVD	MD
San Jose	13	13
Surface Casing	213	213
NCMT	1389	1466.09
OJAM	2479	2732.04
KRLD	2569	2827.46
FRLD	2994	3260.46
Intermediate Casing	3114	3381.00
TOP COAL	3144	3410.52
Base Main Coal	3294	3560.52
Total Depth	3374	3641.00
PC Tongue	3404	3671.00
Base Lowest Coal	3414	3681.00
PCCF	3424	3691.00

HOLE: 13.5 "
 CSG OD: 9.625 "
 CSG ID: 9.001 "
 WGT: 32.3 ppg
 GRADE: H-40
 EXCESS: 125 %
 DEPTH: **235'**

SURFACE:

Option 1
222 sx
 46.2 bbls
 259.5 cuft
 1.17 ft³/sx
 15.8 ppg
 4.973 gal/sx
 Class G Cement
 + 3% S001 Calcium Chloride
 + 0.25 lb/sx D029 Cellophane Flakes

Comp. Strength
 6 hrs 250 psi
 8 hrs 500 psi
 psi

Option 2
214 sx
 46.2 bbls
 259.5 cuft
 1.21 ft³/sx
 15.6 ppg
 5.29 gal/sx
 Standard Cement
 + 3% Calcium Chloride
 + 0.25 lb/sx Flocele

Comp. Strength
 6 hrs 250 psi
 8 hrs 500 psi

HOLE: 8.75 "
 CSG OD: 7 "
 CSG ID: 6.456 "
 WGT: 20 ppg
 GRADE: J-55
 EXCESS: 160 %
 TAIL: **300'**
 DEPTH: **3381'**

INTERMEDIATE LEAD:

Option 1
442 sx
 205.5 bbls
 1153.9 cuft
 2.61 ft³/sx
 11.7 ppg
 15.876 gal/sx
 Class G Cement
 + 0.25 lb/sx D029 Cellophane Flakes
 + 3% D079 Extender
 + 0.20% D046 Antifoam

Comp. Strength
 2:37 50 psi
 40 hrs 500 psi

Option 2
397 sx
 205.5 bbls
 1153.9 cuft
 2.91 ft³/sx
 11.5 ppg
 16.88 gal/sx
 Standard Cement
 + 3% Econolite (Extender)
 + 0.25 lb/sx Flocele
 + 10 lb/sx Gilsomite

Comp. Strength
 12 hrs 306 psi
 24 hrs 433 psi
 48 hrs 531 psi

INTERMEDIATE TAIL:

Option 1
100 sx
 22.6 bbls
 126.9 cuft
 1.27 ft³/sx
 13.5 ppg
 5.182 gal/sx
 50/50 Poz: Class G Cement
 + 0.25 lb/sx D029 Cellophane Flakes
 + 2% S001 Calcium Chloride
 + 2% D020 Bentonite
 + 5.0 lb/sx D024 Gilsomite Extender
 + 0.2% D046 Antifoamer

Comp. Strength
 24 hrs 908 psi
 48 hrs 1950 psi

Option 2
95 sx
 22.6 bbls
 126.9 cuft
 1.33 ft³/sx
 13.5 ppg
 5.36 gal/sx
 50/50 Poz: Standard Cement
 + 2% Bentonite
 + 0.25 lb/sx Flocele
 + 5.0 lb/sx Gilsomite
 + 2% Calcium Chloride

Comp. Strength
 3:50 500 psi
 12 hrs 1281 psi
 24hrs 1950 psi

DEPTH: **3641'**



ConocoPhillips

Field: Rio Arriba County, NM
 Site: San Juan 31-6 No. 218A
 Well: Well #218A
 Wellpath: Original Hole
 Plan: Plan #1

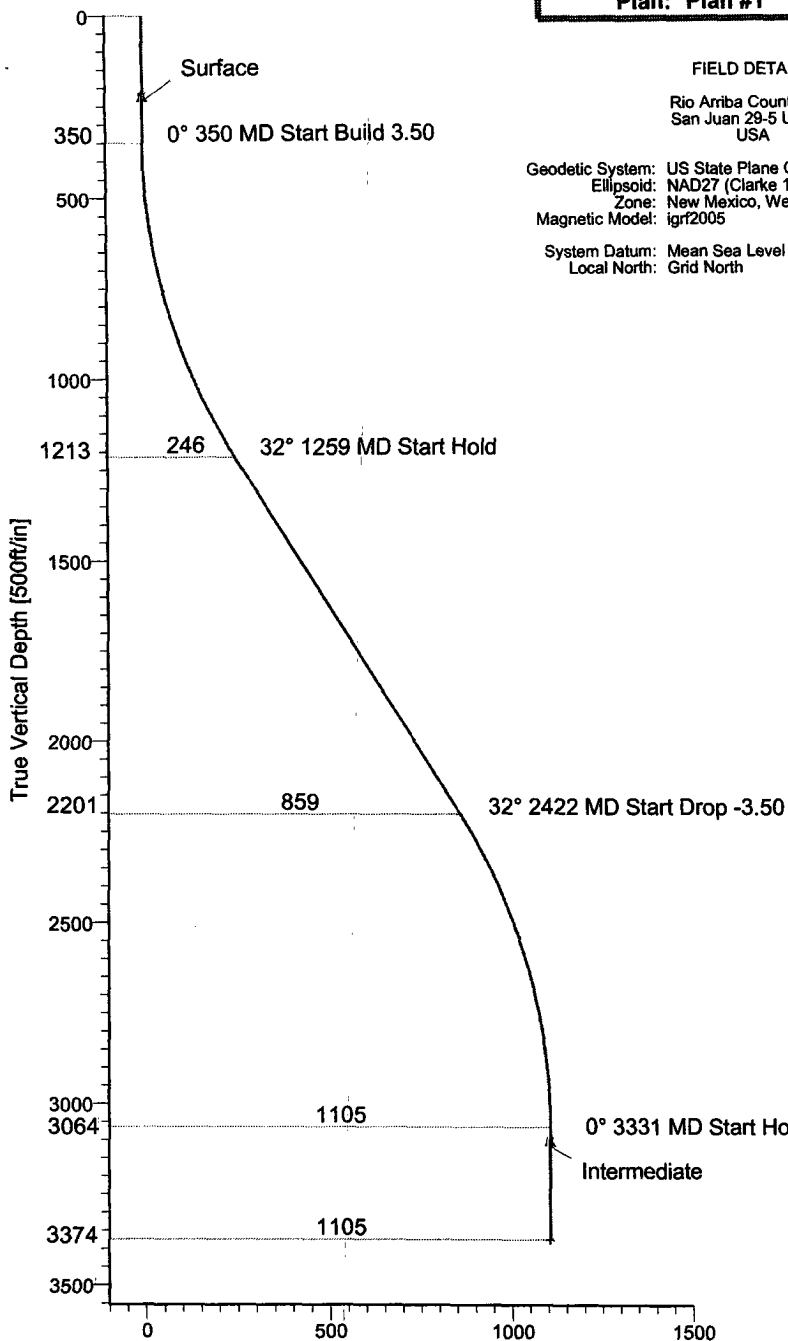

Vertical Section at 354.81° [500ft/in]

FIELD DETAILS

Rio Arriba County, NM
 San Juan 29-5 Unit 5F
 USA
 Geodetic System: US State Plane Coordinate System 1927
 Ellipsoid: NAD27 (Clarke 1866)
 Zone: New Mexico, Western Zone
 Magnetic Model: igrf2005
 System Datum: Mean Sea Level
 Local North: Grid North

SITE DETAILS

San Juan 31-6 No. 218A
 Section 3, T30N, R6W
 Rio Arriba County, NM
 Water Depth: 0.00
 Positional Uncertainty: 0.00
 Convergence: 0.00

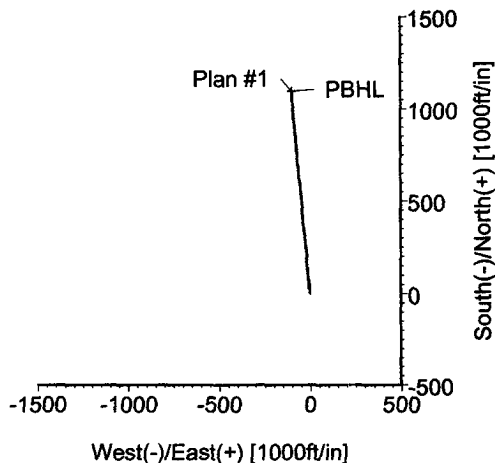

WELLPATH DETAILS

Ref. Datum:	Origin +N/-S	Origin +E/-W	Starting From TVD
Rig: SITE 0.00ft	354.81°	0.00	3374.00

CASING DETAILS

No.	TVD	MD	Name	Size
1	235.00	235.00	Surface	9.625
2	3114.00	3380.52	Intermediate	7.000

TARGET DETAILS

Name	TVD	+N/-S	+E/-W	Shape
PBHL	3374.00	1100.00	-100.00	Point

SECTION DETAILS

Sec	MD	Inc	Azi	TVD	+N/-S	+E/-W	DLeg	TFace	VSec	Target
1	0.00	0.00	354.81	0.00	0.00	0.00	0.00	0.00	0.00	
2	350.00	0.00	354.81	350.00	0.00	0.00	0.00	0.00	0.00	
3	1258.62	31.80	354.81	1212.68	244.75	-22.25	3.50	354.81	245.76	
4	2421.89	31.80	354.81	2201.32	855.25	-77.75	0.00	0.00	858.78	
5	3330.52	0.00	354.81	3064.00	1100.00	-100.00	3.50	180.00	1104.54	
6	3640.52	0.00	354.81	3374.00	1100.00	-100.00	0.00	0.00	1104.54	PBHL

Ryan Energy Technology
 19510 Oil Center Blvd
 Houston, TX 77073
 Ph: 281-443-1414
 Fx: 281-443-1678



Ryan The leader in
 UNDERGROUND INTELLIGENCE™

Plan: Plan #1 (Well #218A/Original Hole)
 Created By: Troy L. Sluice Date: 3/29/2006
 Checked: _____ Date: _____
 Reviewed: _____ Date: _____
 Approved: _____ Date: _____

TOPSET FRUITLAND COAL Wells: (topset casing above coal to prepare for cavitation/DO/UR)

Drilling Mud Program:

Surface: spud mud

Intermediate: fresh water mud with bentonite and polymer as needed

Below Intermediate: air/mist/nitrogen drilling media with foamer, polymer, & corrosion inhibitor as needed

Centralizer Program:

Surface: centralizers placed 10' above the shoe latched over a stop collar and at the top of the 2nd, 3rd, & 4th joints

Intermediate: centralizers placed 10' above the shoe latched over a stop collar and at the top of the 2nd, 4th, 6th, 8th, & 10th joints

Turbolizers placed one per joint from the top of the Ojo Alamo to the top of the Kirtland Shale

Below Intermediate: no centralizers used in air holes. In mud holes centralizers are spaced out appropriately

CASE & FRAC FRUITLAND COAL Wells: (casing set below coal to prepare for frac completion)

Drilling Mud Program:

Surface: spud mud

Production: fresh water mud with bentonite and polymer as needed

Centralizer Program:

Surface: centralizers placed 10' above the shoe latched over a stop collar and at the top of the 2nd, 3rd, & 4th joints

Production: centralizers placed 10' above the shoe latched over a stop collar and at the top of the 2nd, 4th, 6th, 8th, & 10th joints

Turbolizers placed one per joint from the top of the Ojo Alamo to the top of the Kirtland Shale

MESA VERDE Wells:

Drilling Mud Program:

Surface: spud mud

Intermediate: fresh water mud with bentonite and polymer as needed

Below Intermediate: air/mist drilling media with foamer, polymer, & corrosion inhibitor as needed

Centralizer Program:

Surface: centralizers placed 10' above the shoe latched over a stop collar and at the top of the 2nd, 3rd, & 4th joints

Intermediate: centralizers placed 10' above the shoe latched over a stop collar and at the top of the 2nd, 4th, 6th, 8th, & 10th joints

Turbolizers placed one per joint from the top of the Ojo Alamo to the top of the Kirtland Shale

Below Intermediate: no centralizers used in air holes. In mud holes centralizers are spaced out appropriately

DAKOTA Wells:

Drilling Mud Program:

Surface: spud mud

Intermediate: fresh water mud with bentonite and polymer as needed

Below Intermediate: air/mist/nitrogen drilling media with foamer, polymer, & corrosion inhibitor as needed

Centralizer Program:

Surface: centralizers placed 10' above the shoe latched over a stop collar and at the top of the 2nd, 3rd, & 4th joints

Intermediate: centralizers placed 10' above the shoe latched over a stop collar and at the top of the 2nd, 4th, 6th, 8th, & 10th joints

Turbolizers placed one per joint from the top of the Ojo Alamo to the top of the Kirtland Shale

Below Intermediate: no centralizers used in air holes. In mud holes centralizers are spaced out appropriately



ConocoPhillips

Field: Rio Arriba County, NM
 Site: San Juan 31-6 No. 218A
 Well: Well #218A
 Wellpath: Original Hole
 Plan: Plan #1

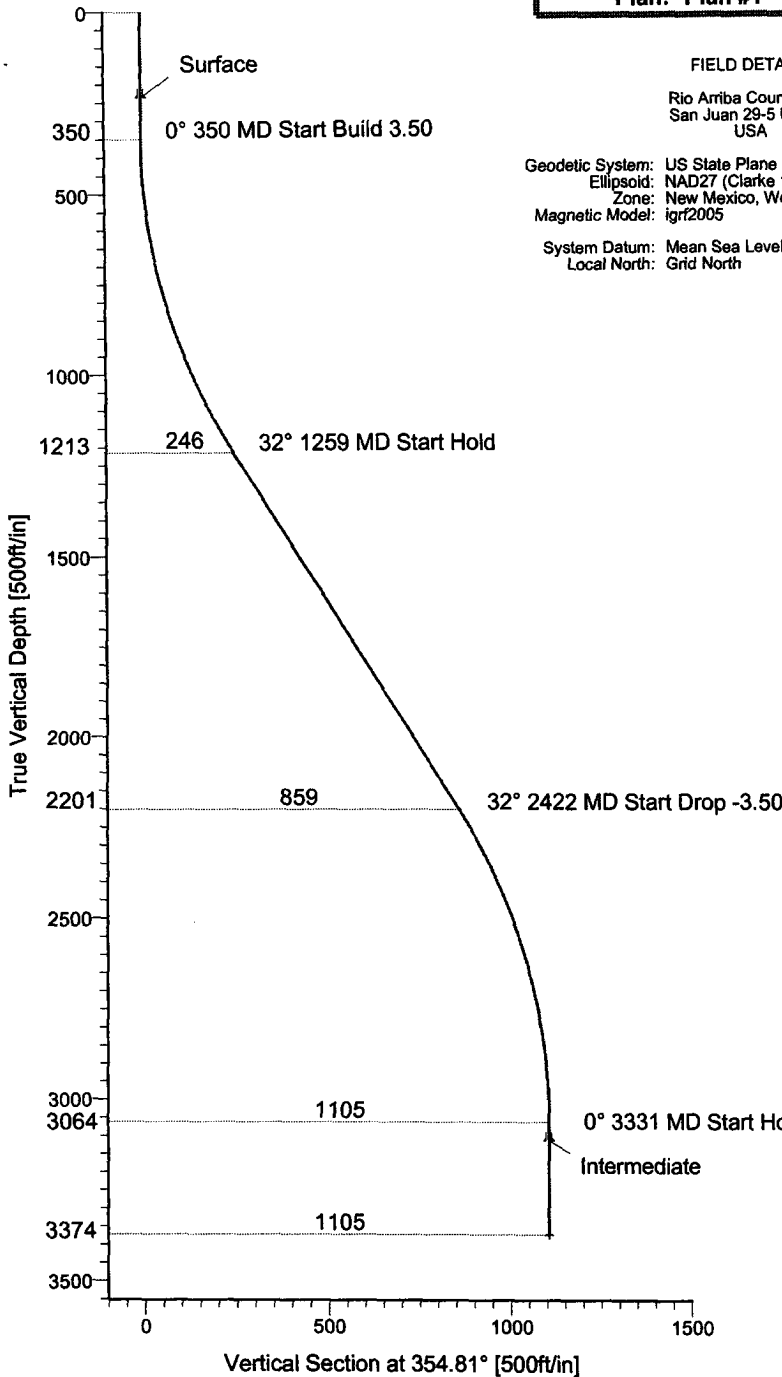

FIELD DETAILS

Rio Arriba County, NM
 San Juan 29-5 Unit 5F
 USA

Geodetic System: US State Plane Coordinate System 1927
 Ellipsoid: NAD27 (Clarke 1866)
 Zone: New Mexico, Western Zone
 Magnetic Model: igr2005

System Datum: Mean Sea Level
 Local North: Grid North

SITE DETAILS

San Juan 31-6 No. 218A
 Section 3, T30N, R6W
 Rio Arriba County, NM

Water Depth: 0.00
 Positional Uncertainty: 0.00
 Convergence: 0.00

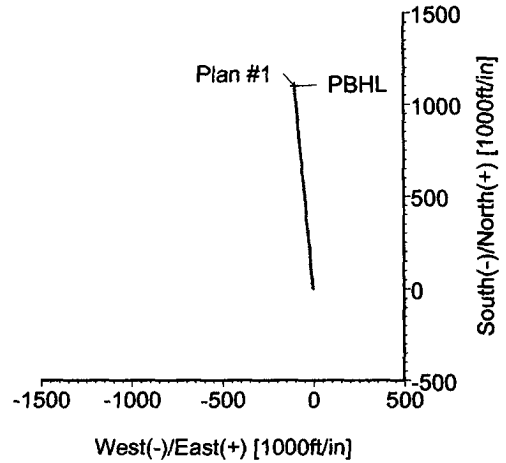

WELLPATH DETAILS

Original Hole

Rig:	SITE	Origin	Origin	Starting
Ref. Datum:		+N/-S	+E/-W	From TVD
		0.00	0.00	3374.00
V.Section Angle				
354.81°				

CASING DETAILS

No.	TVD	MD	Name	Size
1	235.00	235.00	Surface	9.625
2	3114.00	3380.52	Intermediate	7.000

TARGET DETAILS

Name	TVD	+N/-S	+E/-W	Shape
PBHL	3374.00	1100.00	-100.00	Point

SECTION DETAILS

Sec	MD	Inc	Azi	TVD	+N/-S	+E/-W	DLeg	TFace	VSec	Target
1	0.00	0.00	354.81	0.00	0.00	0.00	0.00	0.00	0.00	
2	350.00	0.00	354.81	350.00	0.00	0.00	0.00	0.00	0.00	
3	1258.62	31.80	354.81	1212.68	244.75	-22.25	3.50	354.81	245.76	
4	2421.89	31.80	354.81	2201.32	855.25	-77.75	0.00	0.00	858.78	
5	3330.52	0.00	354.81	3064.00	1100.00	-100.00	3.50	180.00	1104.54	
6	3640.52	0.00	354.81	3374.00	1100.00	-100.00	0.00	0.00	1104.54	PBHL

Ryan Energy Technology
 19510 Oil Center Blvd
 Houston, TX 77073
 Ph: 281-443-1414
 Fx: 281-443-1678



Ryan The leader in
 UNDERGROUND INTELLIGENCE™

Plan: Plan #1 (Well #218A/Original Hole)

Created By: Troy L. Stouts Date: 3/29/2006

Checked: _____ Date: _____

Reviewed: _____ Date: _____

Approved: _____ Date: _____

submitted in lieu of Form 3160-5

UNITED STATES
DEPARTMENT OF THE INTERIOR
BUREAU OF LAND MANAGEMENT

Sundry Notices and Reports on Wells

2006 MAY 11 AM 10 14
RECEIVED
OTO FARMINGTON NM

1. Type of Well
GAS

2. Name of Operator
ConocoPhillips

3. Address & Phone No. of Operator
PO Box 4289, Farmington, NM 87499 (505) 326-9700

4. Location of Well, Footage, Sec., T, R, M
Surface Location - Unit B (NWNE), 100' FNL & 1330' FEL, Sec. 3, T30N, R6W, NMPM
BH Location - Unit O (SWSE), 1000' FSL & 1430' FEL, Sec. 34, T31N, R6W, NMPM

- 5. Lease Number
NMSF-078999
- 6. If Indian, All. or
Tribe Name
- 7. Unit Agreement Name
San Juan 31-6 Unit
- 8. Well Name & Number
#218A
- 9. API Well No.
30-039-29422
- 10. Field and Pool
Basin Fruitland Coal
- 11. County and State
Rio Arriba Co., NM

12. CHECK APPROPRIATE BOX TO INDICATE NATURE OF NOTICE, REPORT, OTHER DATA

Type of Submission	Type of Action		
<input checked="" type="checkbox"/> Notice of Intent	<input type="checkbox"/> Abandonment	<input checked="" type="checkbox"/> Change of Plans	<input checked="" type="checkbox"/> Other - New Ops Plan
<input type="checkbox"/> Subsequent Report	<input type="checkbox"/> Recompletion	<input type="checkbox"/> New Construction	
<input type="checkbox"/> Final Abandonment	<input type="checkbox"/> Plugging	<input type="checkbox"/> Non-Routine Fracturing	
	<input type="checkbox"/> Casing Repair	<input type="checkbox"/> Water Shut off	
	<input type="checkbox"/> Altering Casing	<input type="checkbox"/> Conversion to Injection	

13. Describe Proposed or Completed Operations

ConocoPhillips wishes to change the subject well from a vertical well to a directional well. Please find attached the new C102 (plat) with the new information. Also find the directional drill plan and geological tops for this well. The new TD for this well will be 3424' (TVD).



14. I hereby certify that the foregoing is true and correct.

Signed Patsy Clugston Patsy Clugston Title Sr. Regulatory Specialist Date 5/5/06

(This space for Federal or State Office use)
APPROVED BY Andrea Brunley Title Pet. Eng Date 5/15/06
CONDITION OF APPROVAL, if any:

Title 18 U.S.C. Section 1001, makes it a crime for any person knowingly and willfully to make any department or agency of the United States any false, fictitious or fraudulent statements or representations as to any matter within its jurisdiction.

NMOCD