

District I

1625 N. French Dr., Hobbs, NM 88240

District II

1301 W. Grand Ave., Artesia, NM 88210

District III

1000 Rio Brazos Rd., Aztec, NM 87410

District IV

1220 S. St. Francis Dr., Santa Fe, NM 87505

OIL CONSERVATION DIVISION

1220 South St. Francis Dr.

Santa Fe, NM 87505

WELL API NO.

30-045-33308

5. Indicate Type of Lease

STATE ☐

FEE ☐

6. State Oil & Gas Lease No.

Federal Lease - SF-079351

7. Lease Name or Unit Agreement Name

San Juan 32-8 Unit

8. Well Number

#206A

9. OGRID Number

217817

10. Pool name or Wildcat

Basin Fruitland Coal

SUNDRY NOTICES AND REPORTS ON WELLS  
(DO NOT USE THIS FORM FOR PROPOSALS TO DRILL OR TO DEEPEN OR PLUG BACK TO A DIFFERENT RESERVOIR. USE "APPLICATION FOR PERMIT" (FORM C-101) FOR SUCH PROPOSALS.)

1. Type of Well:

Oil Well ☐

Gas Well ☒

Other

2. Name of Operator

ConocoPhillips Company

3. Address of Operator

3401 E. 30TH STREET, FARMINGTON, NM 87402

4. Well Location

Unit Letter O

: 795

feet from the

South

line and

1475

feet from the

East

line

Section 24

Township

31N

Rng

8W

NMPM

County

San Juan

11. Elevation (Show whether DR, RKB, RT, GR, etc.)

6386' GL

Pit or Below-grade Tank Application

☐ or Closure

Pit type

New Drill

Depth to Groundwater

35'

Distance from nearest fresh water well

<1000'

Distance from nearest surface water

<350'

Pit Liner Thickness:

12

mil

Below-Grade Tank:

Volume

bbbs;

Construction Material

12. Check Appropriate Box to Indicate Nature of Notice, Report or Other Data

NOTICE OF INTENTION TO:

PERFORM REMEDIAL WORK ☐

TEMPORARILY ABANDON ☐

PULL OR ALTER CASING ☐

PLUG AND ABANDON ☐

CHANGE PLANS ☐

MULTIPLE COMPL ☐

SUBSEQUENT REPORT OF:

REMEDIAL WORK ☐

COMMENCE DRILLING OPNS. ☐

CASING/CEMENT JOB ☐

ALTERING CASING ☐

P AND A ☐

OTHER:

REVISED SUNDRY - New Drill

☒

OTHER:

☐

13. Describe proposed or completed operations. (Clearly state all pertinent details, and give pertinent dates, including estimated date of starting any proposed work). SEE RULE 1103. For Multiple Completions: Attach wellbore diagram of proposed completion or recompletion.

Revised Pit Sundry. This wellpad was rotated for safety reasons and therefore we are amending this pit sundry. It replaces the C103 submitted with the APD. The cut & fill diagram are attached and show the direction and distance of the pit in reference to the wellhead. We are constructing Drilling and workover pits as per our General plan on file with the OCD dated June 2005 and we are closing all pits as per the November 1, 2004 Guidelines.



I hereby certify that the information above is true and complete to the best of my knowledge and belief. I further certify that any pit or below-grade tank has been/will be constructed or closed according to NMOCD guidelines ☐, a general permit ☒ or an (attached) alternative OCD-approved plan ☐.

SIGNATURE

Patsy Clugston

TITLE

Sr. Regulatory Analyst

DATE

6/22/2006

Type or print name

Patsy Clugston

E-mail address:

pclugston@br-inc.com

Telephone No.

505-326-9518

For State Use Only

APPROVED BY

Dennis Zeff

TITLE

DEPUTY OIL & GAS INSPECTOR, DIST. 3

DATE

JUN 26 2006

Conditions of Approval (if any):

**CONOCOPHILLIPS COMPANY SAN JUAN 32-8 UNIT #206A**  
**795' FSL & 1475' FEL, SECTION 24, T31N, R8W, NMPM**  
**SAN JUAN COUNTY, NEW MEXICO ELEVATION: 6386'**

EXISTING ROADWAY

PLAT NOTE:

\*SURFACE OWNER\*  
 ConocoPhillips Company

**LATITUDE: 36.87802° N**  
**LONGITUDE: 107.62324° W**  
 DATUM: NAD1983

SOUTH EDGE OF 20' CONSTRUCTION ZONE - PROPERTY LINE

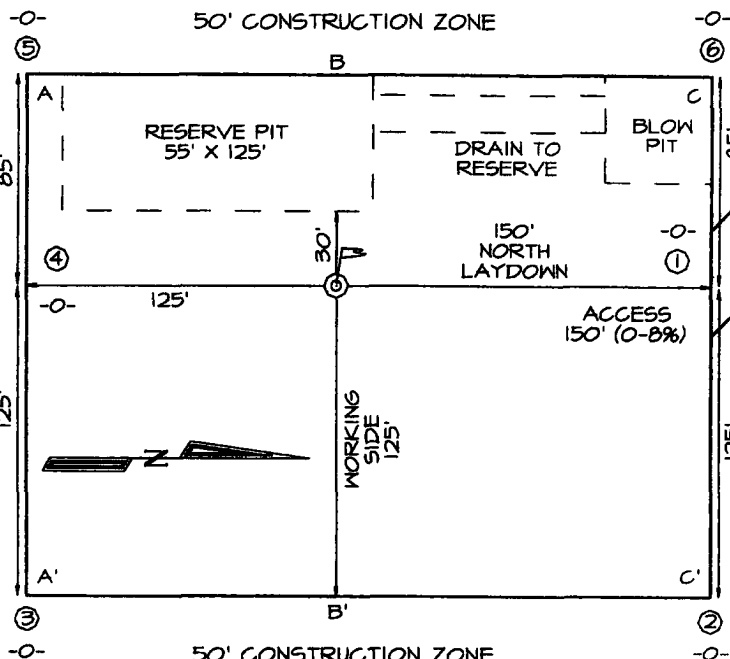

NORTH EDGE 30' CONSTRUCTION ZONE - PROPERTY LINE

OH POWER-LINE (3-WIRE)

OH POWER-LINE (3-WIRE)

A-A'						
6396'						
6386'						
6376'						
B-B'						
6396'						
6386'						
6376'						
C-C'						
6396'						
6386'						
6376'						