

Submit 3 Copies To Appropriate District
Office
District I
1625 N. French Dr., Hobbs, NM 88240
District II
1301 W. Grand Ave., Artesia, NM 88210
District III
1000 Rio Brazos Rd., Aztec, NM 87410
District IV
1220 S. St. Francis Dr., Santa Fe, NM
87505

State of New Mexico
Energy, Minerals and Natural Resources

Form C-103
May 27, 2004

OIL CONSERVATION DIVISION
1220 South St. Francis Dr.
Santa Fe, NM 87505

WELL API NO.
30-039-29258

5. Indicate Type of Lease

STATE ☐ FEE ☐

6. State Oil & Gas Lease No.

7. Lease Name or Unit Agreement Name
HOYT

8. Well Number **#1C**

9. OGRID Number **17352**

10. Pool name or Wildcat
BASIN DK/BLANCO MV

SUNDRY NOTICES AND REPORTS ON WELLS

(DO NOT USE THIS FORM FOR PROPOSALS TO DRILL OR TO DEEPEN OR PLUG BACK TO A DIFFERENT RESERVOIR. USE "APPLICATION FOR PERMIT" (FORM C-101) FOR SUCH PROPOSALS.)

1. Type of Well: Oil Well ☐ Gas Well ☒ Other

2. Name of Operator

PATINA SAN JUAN, INC.

3. Address of Operator

5802 US HIGHWAY 64, FARMINGTON, NM 87401

4. Well Location

Unit Letter **G**: **2490** feet from the **NORTH** line and **2320** feet from the **EAST** line
Section **5** Township **26N** Range **4W** **NMPM** **RIO ARriba** County

11. Elevation (Show whether DR, RKB, RT, GR, etc.)
7341'GR

Pit or Below-grade Tank Application ☒ or Closure ☐

Pit type reserve Depth to Groundwater >100' Distance from nearest fresh water well >1000' Distance from nearest surface water >1000'

Pit Liner Thickness: 12 mil Below-Grade Tank: Volume bbls; Construction Material reinforced polyethylene plastic

12. Check Appropriate Box to Indicate Nature of Notice, Report or Other Data

NOTICE OF INTENTION TO:

PERFORM REMEDIAL WORK ☐ PLUG AND ABANDON ☐
TEMPORARILY ABANDON ☐ CHANGE PLANS ☐
PULL OR ALTER CASING ☐ MULTIPLE COMPL ☐

SUBSEQUENT REPORT OF:

REMEDIAL WORK ☐ ALTERING CASING ☐
COMMENCE DRILLING OPNS. ☐ P AND A ☐
CASING/CEMENT JOB ☐

OTHER: **PIT PERMIT APPLICATION** ☒

OTHER: ☐

13. Describe proposed or completed operations. (Clearly state all pertinent details, and give pertinent dates, including estimated date of starting any proposed work). SEE RULE 1103. For Multiple Completions: Attach wellbore diagram of proposed completion or recompletion.

DRILLING PIT APPLICATION

PROPOSED: LINED DRILLING PIT WITH UNLINED VENT/FLARE/BLOW PIT FOR THE DRILLING OF A NATURAL GAS WELL.

SEE ATTACHED CROSS SECTION AND DRILLING PAD WITH PIT DIAGRAM.



I hereby certify that the information above is true and complete to the best of my knowledge and belief. I further certify that any pit or below-grade tank has been/will be constructed or closed according to NMOCD guidelines ☒, a general permit ☐ or an (attached) alternative OCD-approved plan ☐.

SIGNATURE [Signature] TITLE **REGULATORY COMPLIANCE** DATE **09/15/2006**

Type or print name
For State Use Only

E-mail address:

Telephone No.

APPROVED BY: [Signature] TITLE **DEPUTY OIL & GAS INSPECTOR, DIST. 6** DATE **SEP 20 2006**
Conditions of Approval (if any):

DISTRICT I
1825 N. French Dr., Hobbs, N.M. 88240

DISTRICT II
1301 W. Grand Avenue, Artesia, N.M. 88210

DISTRICT III
1000 Rio Brazos Rd., Aztec, N.M. 87410

DISTRICT IV
2040 S. St. Francis Dr., Santa Fe, NM 87505

State of New Mexico
Energy, Minerals & Natural Resources Department

Form C-102
Revised October 12, 2005

Submit to Appropriate District Office
State Lease - 4 Copies
Fee Lease - 3 Copies

OIL CONSERVATION DIVISION

1220 South St. Francis Dr.
Santa Fe, NM 87505

AMENDED REPORT

WELL LOCATION AND ACREAGE DEDICATION PLAT

*API Number 30-039-29258		*Pool Code	*Pool Name
*Property Code	*Property Name HOYT		*Well Number #1C
*OGRID No.	*Operator Name PATINA SAN JUAN		*Elevation 7341'

¹⁰ Surface Location

UL or lot no.	Section	Township	Range	Lot Idn	Feet from the	North/South line	Feet from the	East/West line	County
G	5	26-N	4-W		2490'	NORTH	2320'	EAST	RIO ARRIBA

¹¹ Bottom Hole Location If Different From Surface

UL or lot no.	Section	Township	Range	Lot Idn	Feet from the	North/South line	Feet from the	East/West line	County
*Dedicated Acres		*Joint or Infill		*Consolidation Code		*Order No.			

No allowable will be assigned to this completion until all interests have been consolidated or a non-standard unit has been approved by the division.

WEST

5280.00' (GLO)

CALC. COR BY SGL PROP.		S 89°45'34" W		5156.26' (CALC.)		FND. 3 1/4" BLM 1972 BRASS CAP		¹⁷ OPERATOR CERTIFICATION I hereby certify that the information contained herein is true and complete to the best of my knowledge and belief, and that this organization either owns a working interest or unleased mineral interest in the land including the proposed bottom hole location or has a right to drill this well at this location pursuant to a contract with an owner of such a mineral or working interest, or to a voluntary pooling agreement or a compulsory pooling order heretofore entered by the division. Signature: <u>JEAN M. MUSE</u> Printed Name: <u>JEAN M. MUSE</u>	
LOT 4 41.79	LOT 3 41.73	LOT 2 41.68	LOT 1 41.62	2490'		5332.80' (GLO) 5329.18' (CALC.)			
				2320'					
				LAT: 36.51599 N (NAD 83) LONG: 107.23214 W (NAD 83)				¹⁸ SURVEYOR CERTIFICATION I hereby certify that the well location shown on this plat was plotted from field notes of actual surveys made by me or under my supervision, and that the same is true and correct to the best of my belief. Date: <u>SEP 2008</u> Signature: <u>JOHNA VUKONJAC</u> Registered Professional Surveyor 14831 Certificate Number: <u>14831</u>	
				SOUTH S 01°19'39" E					

2490' FNL, 2320' FEL
LOCATED IN THE SE/4 NE/4 OF
SECTION 5 T26N, R4W, N.M.P.M.,
RIO ARRIBA, NEW MEXICO
ELEVATION: 7341', NAVD 88

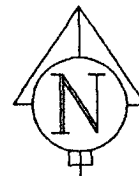
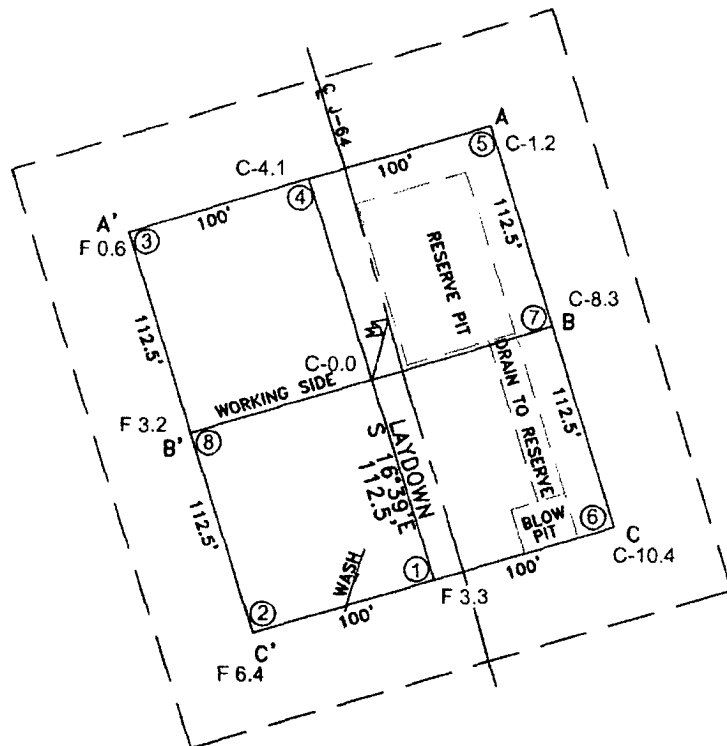

LATITUDE: 36.51599 N
LONGITUDE: 107.27314 W
DATUM: NAD 83

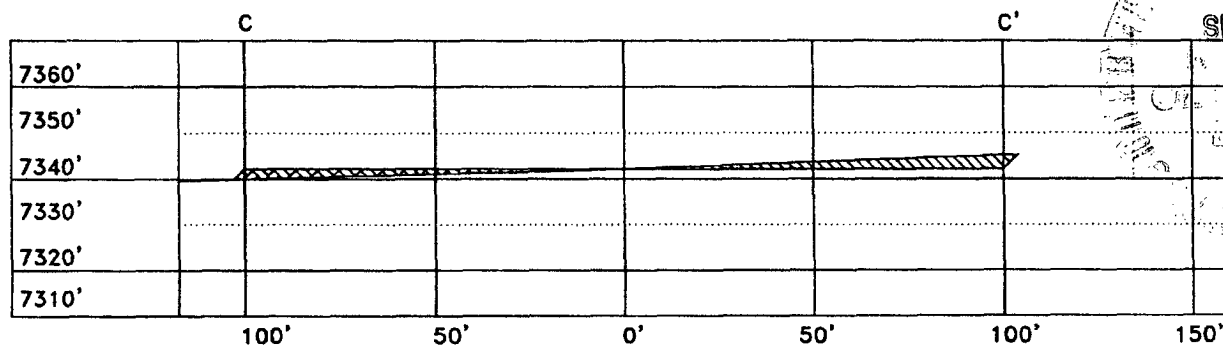
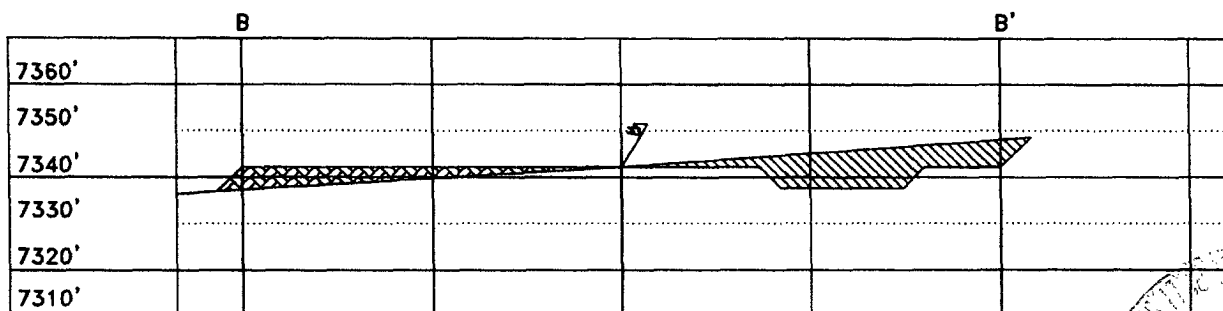
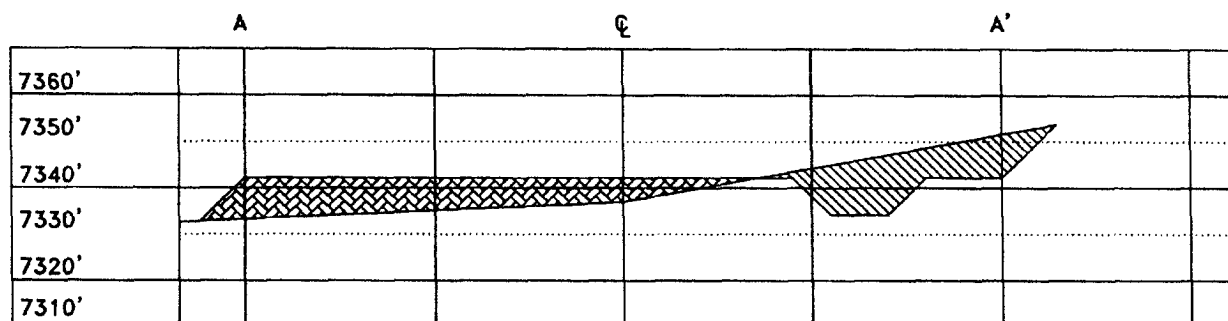

HORIZ. SCALE 1"=50'
VERT. SCALE 1"=30'



A Native American Owned Company

101 Fauver Lane, Bloomfield, New Mexico 87413
Phone/Fax: (505) 632-8906 Cell No: (505) 793-5325

SEP 2006