

District II  
1625 N. French Dr., Hobbs, NM 88240

District III  
1301 W. Grand Ave., Artesia, NM 88210

District IV  
1000 Rio Brazos Rd., Aztec, NM 87410

District V  
1220 S. St. Francis Dr., Santa Fe, NM 87505

**OIL CONSERVATION DIVISION**  
1220 South St. Francis Dr.  
Santa Fe, NM 87505

WELL API NO.	30-045-34151
5. Indicate Type of Lease	STATE <input checked="" type="checkbox"/> FEE <input type="checkbox"/>
6. State Oil & Gas Lease No.	E-1451-3
7. Lease Name or Unit Agreement Name	State N
8. Well Number	#1F
9. OGRID Number	217817
10. Pool name or Wildcat	Basin DK/Blanco MV
11. Elevation (Show whether DR, RKB, RT, GR, etc.) 5885'	
Pit or Below-grade Tank Application <input type="checkbox"/> or Closure <input type="checkbox"/>	
Pit type New Drill <input checked="" type="checkbox"/> Depth to Groundwater >100' Distance from nearest fresh water well >1000' Distance from nearest surface water >1000'	
Pit Liner Thickness: 12 mil Below-Grade Tank: Volume bbls; Construction Material	

**SUNDRY NOTICES AND REPORTS ON WELLS**  
(DO NOT USE THIS FORM FOR PROPOSALS TO DRILL OR TO DEEPEN OR PLUG BACK TO A DIFFERENT RESERVOIR. USE "APPLICATION FOR PERMIT" (FORM C-101) FOR SUCH PROPOSALS.)

1. Type of Well:  
Oil Well ☐ Gas Well ☒ Other

2. Name of Operator  
ConocoPhillips

3. Address of Operator  
3401 E. 30TH STREET, FARMINGTON, NM 87402

4. Well Location  
Unit Letter K : 2145' feet from the South line and 1470' feet from the West line  
Section 32 Township 29N Rng 9W NMPM County San Juan

Pit or Below-grade Tank Application ☐ or Closure ☐

Pit type New Drill ☒ Depth to Groundwater >100' Distance from nearest fresh water well >1000' Distance from nearest surface water >1000'

Pit Liner Thickness: 12 mil Below-Grade Tank: Volume bbls; Construction Material

**12. Check Appropriate Box to Indicate Nature of Notice, Report or Other Data**

**NOTICE OF INTENTION TO:**

PERFORM REMEDIAL WORK ☐ PLUG AND ABANDON ☐  
TEMPORARILY ABANDON ☐ CHANGE PLANS ☐  
PULL OR ALTER CASING ☐ MULTIPLE COMPL ☐

OTHER: New Drill ☒

**SUBSEQUENT REPORT OF:**

REMEDIAL WORK ☐ ALTERING CASING ☐  
COMMENCE DRILLING OPNS. ☐ P AND A ☐  
CASING/CEMENT JOB ☐

OTHER: ☐

13. Describe proposed or completed operations. (Clearly state all pertinent details, and give pertinent dates, including estimated date of starting any proposed work). SEE RULE 1103. For Multiple Completions: Attach wellbore diagram of proposed completion or recompletion.

RCVD FEB8'07  
OIL CONS. DIV.  
DIST. 3

New Drill, Lined:

ConocoPhillips proposes to construct a new drilling pit and an associated vent/flame pit. Based on Burlington's interpretation of the Ecosphere's risk ranking criteria, the new drilling pit will be a lined pit as detailed in Burlington's Revised Drilling / Workover Pit Construction / Operation Procedures dated November 11, 2004 on file at the NMOCD office. A portion of the vent/flame pit will be designed to manage fluids and that portion will be lined as per the risk ranking criteria. Burlington Resources anticipates closing these pits according to the Drilling / Workover Pit Closure Procedure dated August 2, 2004 on file at the NMOCD office.

I hereby certify that the information above is true and complete to the best of my knowledge and belief. I further certify that any pit or below-grade tank has been/will be constructed or closed according to NMOCD guidelines ☐, a general permit ☒ or an (attached) alternative OCD-approved plan ☐.

SIGNATURE Rhonda Rogers TITLE Regulatory Technician DATE 2-7-07

Type or print name Rhonda Rogers E-mail address: rogerr@conocophillips.com Telephone No. 505-599-4018

For State Use Only

APPROVED BY [Signature] TITLE DEPUTY OIL & GAS INSPECTOR, DIST. 3 DATE FEB 08 2007

Conditions of Approval (if any):

LATITUDE: 36.68134°N  
 LONGITUDE: 107.80886°W  
 DATUM: NAD 83

# CONOCO PHILLIPS, COMPANY

STATE N #1F

2145' FSL & 1470' FWL

LOCATED IN THE NE/4 SW/4 OF  
 SECTION 32, T29N, R9W, N.M.P.M.,  
 SAN JUAN COUNTY, NEW MEXICO  
 GROUND ELEVATION: 5885, NAVD 88  
 FINISHED PAD ELEVATION: 5885.1, NAVD 88

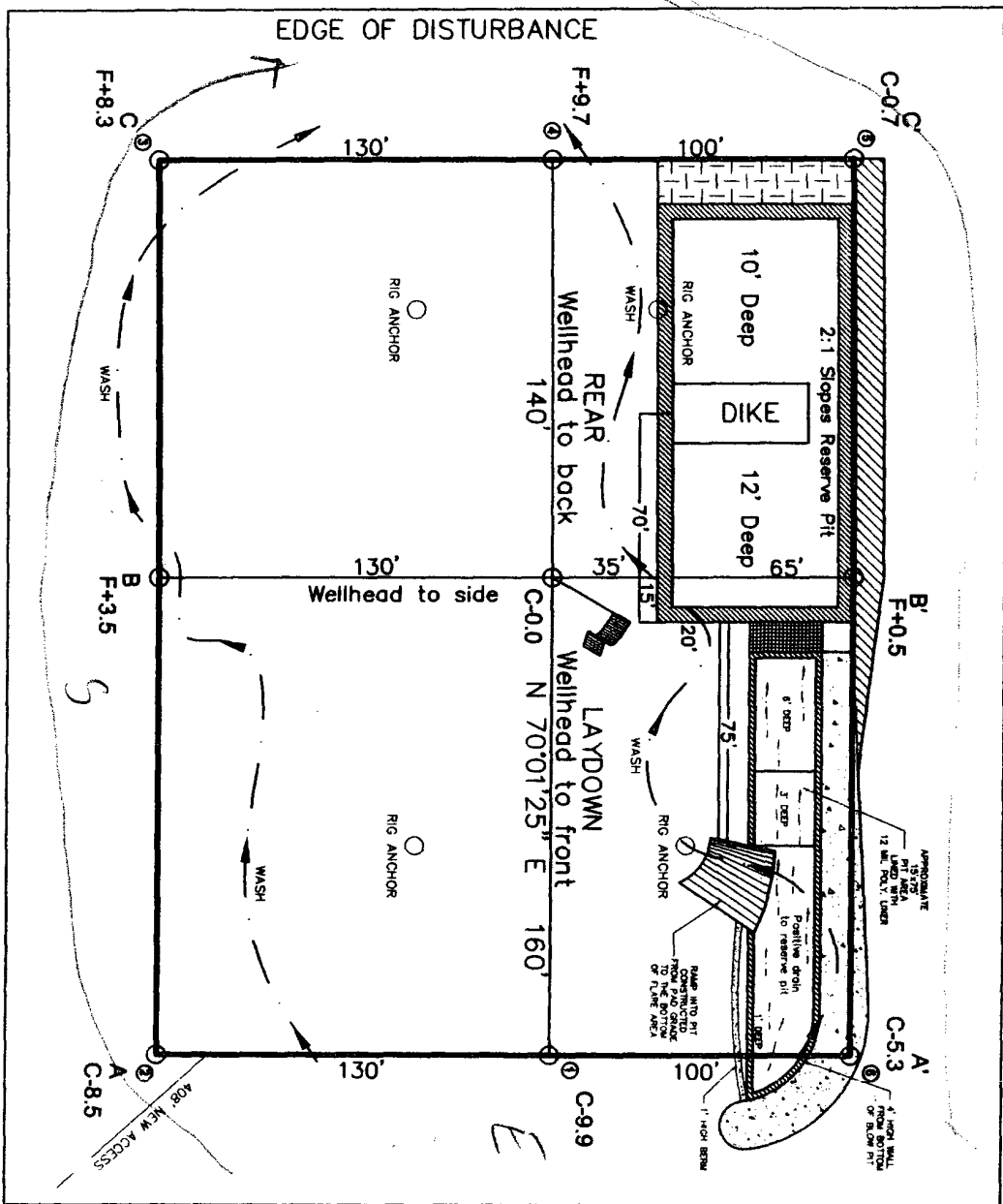
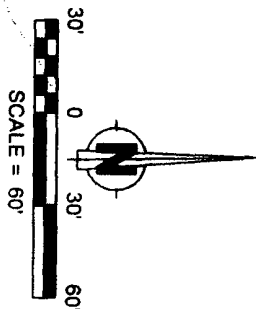

330' x 400' = 3.03 ACRES OF DISTURBANCE  
 SCALE: 1" = 60'  
 JOB No.: COPC027  
 DATE: 08/1/06

NOTE:  
 RESERVE PIT DIKE: TO BE 8' ABOVE DEEP SIDE (OVERFLOW - 3' WIDE AND 1' ABOVE SHALLOW SIDE).  
 RUSSELL SURVEYING, INC. IS NOT LIABLE FOR UNDERGROUND UTILITIES OR PIPELINES.  
 CONTRACTOR SHOULD CALL ONE-CALL FOR LOCATION OF ANY MARKED OR UNMARKED, BURIED PIPELINES OR  
 CABLES ON WELL PAD, IN CONSTRUCTION ZONE AND/OR ACCESS ROAD AT LEAST TWO (2) WORKING DAYS PRIOR  
 TO CONSTRUCTION.

**Russell Surveying**  
 1409 W. Aztec Blvd. #5  
 Aztec, New Mexico 87410  
 (505) 334-8637

**CONOCO PHILLIPS, COMPANY**  
STATE N #1F  
2145' FSL & 1470' FWL  
LOCATED IN THE NE/4 SW/4 OF  
SECTION 32, T29N, R9W, N.M.P.M.,  
SAN JUAN COUNTY, NEW MEXICO  
GROUND ELEVATION: 5885', NAVD 88  
FINISHED PAD ELEVATION: 5885.1', NAVD 88

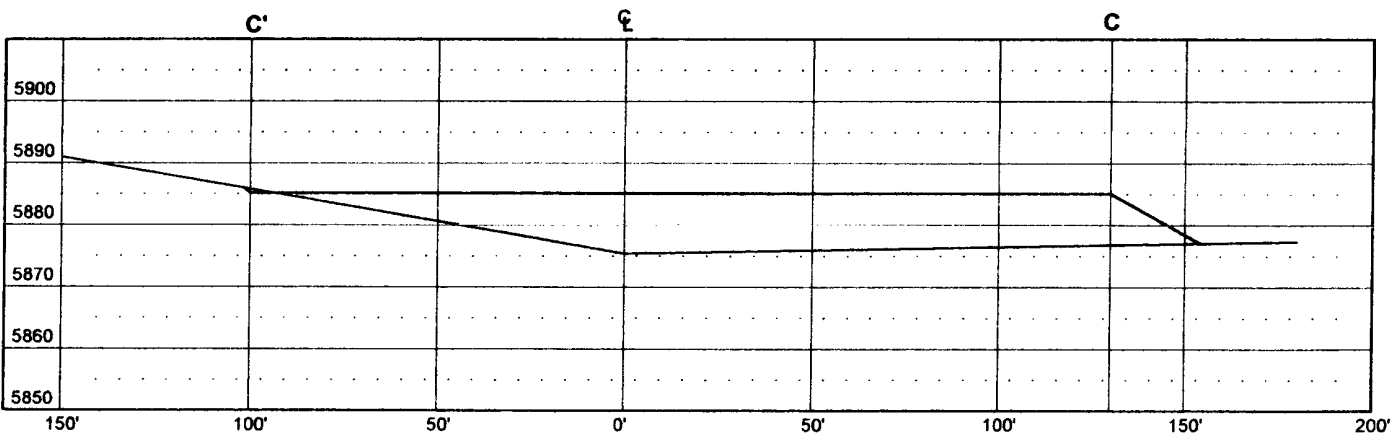

**VERT. SCALE: 1" = 30'**  
**HORZ. SCALE: 1" = 50'**  
**JOB No.: COPC027**  
**DATE: 08/11/06**

 **Russell Surveying**  
1409 W. Aztec Blvd. #5  
Aztec, New Mexico 87410  
(505) 334-8637