

UNITED STATES  
DEPARTMENT OF THE INTERIOR  
BUREAU OF LAND MANAGEMENT

APPLICATION FOR PERMIT TO DRILL, DEEPEN, OR PLUG BACK

|   |  |  |
|---|--|--|
| 1a. Type of Work<br>DRILL   | 207 MAY 29 PM 3:37<br>RECEIVED<br>BLM<br>210 FARMINGTON NM | 5. Lease Number<br>USA SF-078097<br>Unit Reporting Number  |
| 1b. Type of Well<br>GAS   |  | 6. If Indian, All. or Tribe  |
| 2. Operator<br><b>BURLINGTON</b><br>RESOURCES Oil & Gas Company, LP   |  | 7. Unit Agreement Name   |
| 3. Address & Phone No. of Operator<br>PO Box 4289, Farmington, NM 87499<br>(505) 326-9700                             |  | 8. Farm or Lease Name<br>Heaton Com<br>9. Well Number<br>#100  |
| 4. Location of Well<br>Unit G (SWNE), 1880' FNL & 1490' FEL<br><br>Latitude 36° 51.4572 N<br>Longitude 108° 00.5745 W |  | 10. Field, Pool, Wildcat<br>Basin FC/WC:31N11W32E FS<br><br>11. Sec., Twn, Rge, Mer. (NMPM)<br>G Sec. 32, T31N, R11W<br><br>API # 30-045-34336 |
| 14. Distance in Miles from Nearest Town<br>2.6 mile/Aztec   | 12. County<br>San Juan                                     | 13. State<br>NM  |
| 15. Distance from Proposed Location to Nearest Property or Lease Line<br>760'   |  |  |
| 16. Acres in Lease  | 17. Acres Assigned to Well<br>FC-320 (N/2) FS-160 (NE/4)   |  |
| 18. Distance from Proposed Location to Nearest Well, Drlg, Compl, or Applied for on this Lease                        |  |  |
| 19. Proposed Depth<br>2554'   | 20. Rotary or Cable Tools<br>Rotary                        |  |
| 21. Elevations (DF, FT, GR, Etc.)<br>5855' GL   | 22. Approx. Date Work will Start                           |  |
| 23. Proposed Casing and Cementing Program<br>See Operations Plan attached   |  | RCUD JUL 10'07<br>OIL CONS. DIV.<br>DIST. 3  |
| 24. Authorized by: <u>Kandis Roland</u><br>Kandis Roland (Regulatory Technician)                                      | <u>5/29/07</u><br>Date                                     |  |

PERMIT NO. \_\_\_\_\_ APPROVAL DATE \_\_\_\_\_  
APPROVED BY [Signature] TITLE AFM DATE 7/6/07

Archaeological Report attached

Threatened and Endangered Species Report attached

NOTE: This format is issued in lieu of U.S. BLM Form 3160-3

Title 18 U.S.C. Section 1001, makes it a crime for any person knowingly and willfully to make to any department or agency of the United States any false, fictitious or fraudulent statements or presentations as to any matter within its jurisdiction.

Example Master Plan Type 2

NOTIFY AZTEC OCC 24 HRS.  
PRIOR TO CASING & CEMENT

NMOCD

7-17-07  
BH

DISTRICT I  
1625 N. French Dr., Hobbs, N.M. 88240

DISTRICT II  
1301 West Grand Avenue, Artesia, N.M. 88210

DISTRICT III  
1000 Rio Brazos Rd., Aztec, N.M. 87410

DISTRICT IV  
1220 S. St. Francis Dr., Santa Fe, NM 87505

State of New Mexico  
Energy, Minerals & Natural Resources Department

OIL CONSERVATION DIVISION

1220 South St. Francis Dr.  
Santa Fe, NM 87505

Form C-102  
Revised October 12, 2005

Submit to Appropriate District Office  
State Lease - 4 Copies  
Fee Lease - 3 Copies

2007 MAY 29  
RECEIVED  
AMENDED REPORT

WELL LOCATION AND ACREAGE DEDICATION PLAT

|  |  |  |
|--|--|--|
| <sup>1</sup> API Number<br>30-045- 34336 | <sup>2</sup> Pool Code<br>71629/ 97624                             | <sup>3</sup> Pool Name<br>Basin Fruitland Coal/WC:31N11W32E Fruitland Sand |
| <sup>4</sup> Property Code<br>36347      | <sup>5</sup> Property Name<br>HEATON COM                           | <sup>6</sup> Well Number<br>100  |
| <sup>7</sup> OGHD No.<br>14538           | <sup>8</sup> Operator Name<br>BURLINGTON RESOURCES OIL AND GAS, LP | <sup>9</sup> Elevation<br>5855'  |

<sup>10</sup> Surface Location

| UL or lot no. | Section | Township | Range | Lot Idn | Feet from the | North/South line | Feet from the | East/West line | County   |
|---------------|---------|----------|-------|---------|---------------|------------------|---------------|----------------|----------|
| G             | 32      | 31-N     | 11-W  |         | 1880'         | NORTH            | 1490'         | EAST           | SAN JUAN |

<sup>11</sup> Bottom Hole Location If Different From Surface

| UL or lot no.   | Section | Township | Range                         | Lot Idn | Feet from the                    | North/South line | Feet from the           | East/West line | County |
|---|---------|----------|-------------------------------|---------|----------------------------------|------------------|-------------------------|----------------|--------|
| G   |         |          |                               |         |                                  |                  |                         |                |        |
| <sup>12</sup> Dedicated Acres<br>160 NE/4 FS<br>320.00 N/2 FC |         |          | <sup>13</sup> Joint or Infill |         | <sup>14</sup> Consolidation Code |                  | <sup>15</sup> Order No. |                |        |

NO ALLOWABLE WILL BE ASSIGNED TO THIS COMPLETION UNTIL ALL INTERESTS HAVE BEEN CONSOLIDATED  
OR A NON-STANDARD UNIT HAS BEEN APPROVED BY THE DIVISION

|  |  |   |  |
|--|--|---|--|
|  |  | <b>17 OPERATOR CERTIFICATION</b><br>I hereby certify that the information contained herein is true and complete to the best of my knowledge and belief, and that this organization either owns a working interest or unleased mineral interest in the land including the proposed bottom hole location or has a right to drill this well at this location pursuant to a contract with an owner of such a mineral or a working interest, or to a voluntary pooling agreement or a compulsory pooling order heretofore entered by the division.<br><br>Signature: <u>Rhonda Rogers</u><br>Printed Name: Rhonda Rogers |  |
|  |  | <b>18 SURVEYOR CERTIFICATION</b><br>I hereby certify that the well location shown on this plat was plotted from field notes of actual surveys made by me or under my supervision, and that the same is true and correct to the best of my belief.<br><br>Date of Survey: <u>2-23-2007</u><br>Signature and Seal of Professional Surveyor: <u>Calvin A. Russell</u><br>Certificate Number: 15703   |  |
| LAT: 36°51.4572' N.<br>LONG: 108°00.5745' W.<br>NAD 1927<br><br>LAT: 38.857823' N.<br>LONG: 108.010199' W.<br>NAD 1983 |  |   |  |

District I

Energy, Minerals and Natural Resources

May 27, 2004

1625 N. French Dr., Hobbs, NM 88240

District II

1301 W. Grand Ave., Artesia, NM 88210

District III

1000 Rio Brazos Rd., Aztec, NM 87410

District IV

1220 S. St. Francis Dr., Santa Fe, NM 87505

**OIL CONSERVATION DIVISION**

1220 South St. Francis Dr.  
Santa Fe, NM 87505

|  |   |
|--|---|
| WELL API NO.   | 30-045- <b>34336</b>  |
| 5. Indicate Type of Lease  | STATE <input type="checkbox"/> FEE <input type="checkbox"/>         |
| 6. State Oil & Gas Lease No.   | Federal-USA SF-078097   |
| 7. Lease Name or Unit Agreement Name   | Heaton Com  |
| 8. Well Number   | #100  |
| 9. OGRID Number  | 14538   |
| 10. Pool name or Wildcat   | Basin FC/WC:31N11W32G FS  |
| 11. Elevation (Show whether DR, RKB, RT, GR, etc.)<br>5855'                                      |   |
| Pit or Below-grade Tank Application <input type="checkbox"/> or Closure <input type="checkbox"/> |   |
| Pit type <u>New Drill</u>  | Depth to Groundwater <u>&gt;100</u>                                 |
| Distance from nearest fresh water well <u>&gt;1000</u>   | Distance from nearest surface water <u>&lt;1000</u>                 |
| Pit Liner Thickness: <u>N/A</u> mil  | Below-Grade Tank: <u>Volume</u> bbls; Construction Material <u></u> |

SUNDRY NOTICES AND REPORTS ON WELLS  
(DO NOT USE THIS FORM FOR PROPOSALS TO DRILL OR TO DEEPEN OR PLUG BACK TO A DIFFERENT RESERVOIR USE "APPLICATION FOR PERMIT" (FORM C-101) FOR SUCH PROPOSALS)

1. Type of Well:  
Oil Well ☐ Gas Well ☒ Other

2. Name of Operator  
BURLINGTON RESOURCES OIL & GAS COMPANY LP

3. Address of Operator  
3401 E. 30TH STREET, FARMINGTON, NM 87402

4. Well Location  
Unit Letter G : 1880' feet from the North line and 1490' feet from the East line  
Section 32 Township 31N Rng 11W NMPM County San Juan

11. Elevation (Show whether DR, RKB, RT, GR, etc.)  
5855'

Pit or Below-grade Tank Application ☐ or Closure ☐

Pit type New Drill Depth to Groundwater >100

Distance from nearest fresh water well >1000 Distance from nearest surface water <1000

Pit Liner Thickness: N/A mil Below-Grade Tank: Volume bbls; Construction Material

**12. Check Appropriate Box to Indicate Nature of Notice, Report or Other Data**

**NOTICE OF INTENTION TO:**

PERFORM REMEDIAL WORK ☐ PLUG AND ABANDON ☐  
TEMPORARILY ABANDON ☐ CHANGE PLANS ☐  
PULL OR ALTER CASING ☐ MULTIPLE COMPL ☐

OTHER: New Drill ☒

**SUBSEQUENT REPORT OF:**

REMEDIAL WORK ☐ ALTERING CASING ☐  
COMMENCE DRILLING OPNS. ☐ P AND A ☐  
CASING/CEMENT JOB ☐

OTHER: ☐

13. Describe proposed or completed operations. (Clearly state all pertinent details, and give pertinent dates, including estimated date of starting any proposed work). SEE RULE 1103. For Multiple Completions: Attach wellbore diagram of proposed completion or recompletion.

New Drill, Unlined:

Burlington Resources proposes to construct a new drilling pit, an associated vent/flare pit and a pre-set mud pit (if required). Based on Burlington's interpretation of the Ecosphere's risk ranking criteria, the new drilling pit, vent/flare pit and pre-set mud pit will be unlined pits as detailed in Burlington's Revised Drilling / Workover Pit Construction / Operation Procedures dated November 11, 2004 on file at the NMOCD office. A portion of the vent/flare pit will be designed to manage fluids, and that portion will be unlined, as per the risk ranking criteria. Burlington Resources anticipates closing these pits according to the Drilling / Workover Pit Closure Procedure dated August 2, 2004 on file at the NMOCD office.

I hereby certify that the information above is true and complete to the best of my knowledge and belief. I further certify that any pit or below-grade tank has been/will be constructed or closed according to NMOCD guidelines ☐, a general permit ☒ or an (attached) alternative OCD-approved plan ☐.

SIGNATURE Kandis Roland TITLE Regulatory Technician DATE 5/25/07

Type or print name Kandis Roland E-mail address: urnskr@conocophillips.com Telephone No. 505-599-4018  
**For State Use Only**

APPROVED BY [Signature] TITLE Deputy Oil & Gas Inspector, District #3 DATE JUL 17 2007

Conditions of Approval (if any):

**BURLINGTON RESOURCES OIL & GAS COMPANY LP**  
**HEATON COM 100, 1880' FNL & 1490' FEL**  
**SECTION 32, T-31-N, R-11-W, NMPM, SAN JUAN COUNTY, NM**  
**GROUND ELEVATION: 5855', DATE: FEBRUARY 20, 2007**

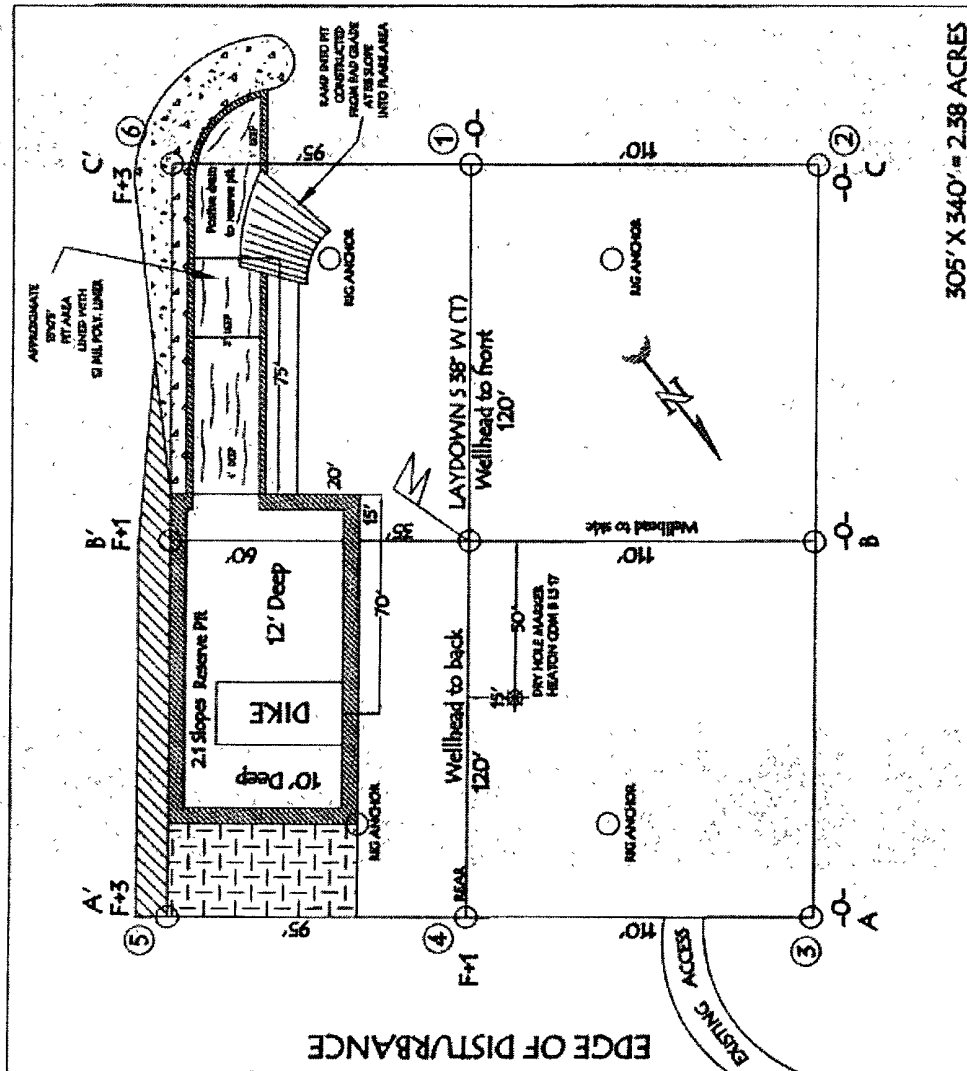

LATITUDE: 36° 51.452' N LONGITUDE: 108° 00.5745' W NAD27

NOTE: VECTOR SURVEYS IS NOT LIABLE FOR UNDERGROUND UTILITIES OR PIPELINES.  
 CONTRACTOR SHOULD CALL ONE-CALL FOR LOCATION OF ANY MARKED OR UNMARKED BURIED  
 PIPELINES OR CABLES ON WELL PAD AND OR ACCESS ROAD AT LEAST TWO (2) WORKING DAYS PRIOR TO CONSTRUCTION.

BURLINGTON RESOURCES OIL & GAS COMPANY LP  
 HEATON COM 100, 1880' FNL & 1490' FEL  
 SECTION 32, T-31- N, R-11-W, NMPM, SAN JUAN COUNTY, NM  
 GROUND ELEVATION: 5855', DATE: FEBRUARY 20, 2007

ELEV. A'-A

C/L

|      |  |  |  |  |  |  |
|------|--|--|--|--|--|--|
| 5875 |  |  |  |  |  |  |
| 5865 |  |  |  |  |  |  |
| 5855 |  |  |  |  |  |  |
| 5845 |  |  |  |  |  |  |

ELEV. B'-B

C/L

|      |  |  |  |  |  |  |
|------|--|--|--|--|--|--|
| 5875 |  |  |  |  |  |  |
| 5865 |  |  |  |  |  |  |
| 5855 |  |  |  |  |  |  |
| 5845 |  |  |  |  |  |  |

ELEV. C'-C

C/L

|      |  |  |  |  |  |  |
|------|--|--|--|--|--|--|
| 5875 |  |  |  |  |  |  |
| 5865 |  |  |  |  |  |  |
| 5855 |  |  |  |  |  |  |
| 5845 |  |  |  |  |  |  |

NOTE: VECTOR SURVEYS IS NOT LIABLE FOR UNDERGROUND UTILITIES OR PIPELINES.  
 CONTRACTOR SHOULD CALL ONE-CALL FOR LOCATION OF ANY MARKED OR UNMARKED BURIED  
 PIPELINES OR CABLES ON WELL PAD AND OR ACCESS ROAD AT LEAST TWO (2) WORKING DAYS PRIOR TO CONSTRUCTION.

# PROJECT PROPOSAL - New Drill / Sidetrack

San Juan Business Unit

HEATON COM 100

DEVELOPMENT

|  |                        |                           |                          |                      |                    |
|--|------------------------|---------------------------|--------------------------|----------------------|--------------------|
| Lease:   |                        | AFE #: WAN.CDR.7082       |                          | AFE \$:              |                    |
| Field Name: hBR_SAN JUAN   |                        | Rig: Aztec Rig 580        |                          | State: NM            | County: SAN JUAN   |
| Geologist:   |                        | Phone:                    | Geophysicist:            |                      | Phone:             |
| Geoscientist: Clark, Dave D  |                        | Phone: 505-326-9762       | Prod. Engineer:          |                      | Phone:             |
| Res. Engineer: Schlabaugh, Jim L   |                        | Phone: 505-326-9788       | Proj. Field Lead:        |                      | Phone:             |
| <b>Primary Objective (Zones):</b>  |                        |                           |                          |                      |                    |
| <b>Zone</b>  | <b>Zone Name</b>       |                           |                          |                      |                    |
| 2035   | FRUITLAND COAL         |                           |                          |                      |                    |
| RCO087   | FRUITLAND SAND(RCO087) |                           |                          |                      |                    |
|  |                        |                           |                          |                      |                    |
| <b>Location:</b> Surface   |                        | <b>Datum Code:</b> NAD 27 |                          | <b>Straight Hole</b> |                    |
| Latitude: 36.857620  | Longitude: -108.009575 | X: 2131482.97             | Y: 448438.93             | Section: 32          | Range: 011W        |
| Footage X: 1490 FEL  | Footage Y: 1880 FNL    | Elevation: 5855           | (FT)                     | Township: 031N       |                    |
| Tolerance:   |                        |                           |                          |                      |                    |
| Location Type: Year Round  |                        | Start Date (Est.):        |                          | Completion Date:     | Date In Operation: |
| Formation Data: Assume KB = 5867 Units = FT  |                        |                           |                          |                      |                    |
| Formation Call & Casing Points   | Depth (TVD in Ft)      | SS (Ft)                   | Depletion (Yes/No)       | BHP (PSIG)           | BHT                |
| Surface Casing   | 120                    | 5747                      | <input type="checkbox"/> |                      |                    |
| OJO ALAMO  | 878                    | 4989                      | <input type="checkbox"/> |                      |                    |
| KIRTLAND   | 918                    | 4949                      | <input type="checkbox"/> |                      |                    |
| FRUITLAND  | 1969                   | 3898                      | <input type="checkbox"/> | 275                  |                    |
| PICTURED CLIFFS  | 2354                   | 3513                      | <input type="checkbox"/> |                      |                    |
| Total Depth  | 2554                   | 3313                      | <input type="checkbox"/> |                      |                    |
| 8-3/4 hole. 7" 20.0 ppf, J-55, STC casing. Circulate cement to surface. Cement with 50 cuft.<br>Possible water flows.<br>Possible gas.<br>6-1/4" hole. 4 1/2" 10.5 ppf, J-55 STC. Circulate cement to surface. Cement with 392 cuft.             |                        |                           |                          |                      |                    |
| <b>Reference Wells:</b>  |                        |                           |                          |                      |                    |
| Reference Type   | Well Name              |                           | Comments                 |                      |                    |
|  |                        |                           |                          |                      |                    |
| <b>Logging Program:</b>  |                        |                           |                          |                      |                    |
| Intermediate Logs: <input type="checkbox"/> Log only if show <input type="checkbox"/> GR/ILD <input type="checkbox"/> Triple Combo   |                        |                           |                          |                      |                    |
|  |                        |                           |                          |                      |                    |
| TD Logs: <input type="checkbox"/> Triple Combo <input type="checkbox"/> Dipmeter <input type="checkbox"/> RFT <input type="checkbox"/> Sonic <input type="checkbox"/> VSP <input type="checkbox"/> TDT <input checked="" type="checkbox"/> Other |                        |                           |                          |                      |                    |
| GR/CBL   |                        |                           |                          |                      |                    |
| Additional Information:  |                        |                           |                          |                      |                    |
| Log Type   | Stage                  | From (Ft)                 | To (Ft)                  | Tool Type/Name       | Remarks            |
|  |                        |                           |                          |                      |                    |

Comments: Location/Tops/Logging - FCNM031N011W32NE1 AND FSNM031N011W32NE1 Twin abandoned Heaton #17 Dakota well at 1830' FNL & 1470' FEL, else stay 800' from Heaton #9 with preferences of G, H, A, B.

Zones - FCNM031N011W32NE1 and FSNM031N011W32NE1

General/Work Description - BDS STRATEGIC WELL. MAKE SURE COST INCLUDE JET PUMP.  
MAKE SURE COST ARE ALLOCATED AS: FC-97% FS-3%