

UNITED STATES
DEPARTMENT OF THE INTERIOR
BUREAU OF LAND MANAGEMENT

APPLICATION FOR PERMIT TO DRILL, DEEPEN, OR PLUG BACK

2007 JUL -9 PM 3:21

| | | |
|--|---|-----------------|
| 1a. Type of Work DRILL | 5. Lease Number NM-03154 Unit Reporting Number | |
| 1b. Type of Well GAS | 6. If Indian, All. or Tribe | |
| 2. Operator BURLINGTON RESOURCES Oil & Gas Company, LP | 7. Unit Agreement Name | |
| 3. Address & Phone No. of Operator PO Box 4289, Farmington, NM 87499 (505) 326-9700 | 8. Farm or Lease Name Ballard 9. Well Number #13F | |
| 4. Location of Well Unit H (SENE), 1745' FNL & 755' FEL Latitude 36° 29.4324 N Longitude 107° 45.1111 W | 10. Field, Pool, Wildcat Basin Dakota 11. Sec., Twn, Rge, Mer. (NMPM) H Sec. 14, T29N, R9W 26 API # 30-045-34362 | |
| 14. Distance in Miles from Nearest Town 31 mile/Bloomfield | 12. County San Juan | 13. State NM |
| 15. Distance from Proposed Location to Nearest Property or Lease Line 755' | 17. Acres Assigned to Well DK 320 (N/2) | |
| 16. Acres in Lease | 20. Rotary or Cable Tools Rotary | |
| 18. Distance from Proposed Location to Nearest Well, Drlg, Compl, or Applied for on this Lease 210' from Ballard #3 | 22. Approx. Date Work will Start | |
| 19. Proposed Depth 6627' | 23. Proposed Casing and Cementing Program See Operations Plan attached | |
| 21. Elevations (DF, FT, GR, Etc.) 6288' GL | 24. Authorized by: <u>Rhonda Rogers</u> Rhonda Rogers (Regulatory Technician) | |

RCUD AUG 10 '07
OIL CONS. DIV.
DIST. 3

7-9-07
Date

PERMIT NO.

APPROVAL DATE

APPROVED BY

TITLE

DATE

Archaeological Report attached

Threatened and Endangered Species Report attached

NOTE: This format is issued in lieu of U.S. BLM Form 3160-3

Title 18 U.S.C. Section 1001, makes it a crime for any person knowingly and willfully to make to any department or agency of the United States any false, fictitious or fraudulent statements or presentations as to any matter within its jurisdiction.

Example Master Plan Type **34**

Bond Numbers NMB-000015 and NMB-000089

NOTIFY AZTEC OCD 24 HRS.
PRIOR TO CASING & CEMENT

DRILLING OPERATIONS AUTHORIZED ARE
SUBJECT TO COMPLIANCE WITH ATTACHED
"GENERAL REQUIREMENTS".

NMOCD 8-17-07

This action is subject to technical and
procedural review pursuant to 43 CFR 3165.9
and appeal pursuant to 43 CFR 3165.4

District I
1625 N. French Dr., Hobbs, NM 88240

District II
1301 W. Grand Avenue, Artesia, NM 88210

District III
1000 Rio Brazos Rd., Aztec, NM 87410

District IV
1220 S St Francis Dr., Santa Fe, NM 87505

State of New Mexico
Energy, Minerals & Natural Resources Department

Form C-102
Revised October 12, 2005
Instructions on back
Submit to Appropriate District Office
State Lease - 4 Copies
Fee Lease - 3 Copies

OIL CONSERVATION DIVISION
1220 South St. Francis Dr.
Santa Fe, NM 87505

RECEIVED
FEB 13 2007

☐ AMENDED REPORT

WELL LOCATION AND ACREAGE DEDICATION PLAT

| | | | |
|-------------------------------------|--|---------------------|----------------------------|
| *API Number 30-045- 34362 | | *Pool Code 71599 | *Pool Name BASIN DAKOTA |
| *Property Code 6819 | *Property Name BALLARD | | *Well Number 13F |
| *OGRID No. 14538 | *Operator Name BURLINGTON RESOURCES OIL & GAS COMPANY, LP | | *Elevation 6288' |

10 Surface Location

| UL or lot no. | Section | Township | Range | Lot 10 | Feet from the | North/South line | Feet from the | East/West line | County |
|---------------|---------|----------|-------|--------|---------------|------------------|---------------|----------------|----------|
| H | 14 | 26N | 9W | | 1745 | NORTH | 755 | EAST | SAN JUAN |

11 Bottom Hole Location If Different From Surface

| UL or lot no. | Section | Township | Range | Lot 10 | Feet from the | North/South line | Feet from the | East/West line | County |
|---|---------|----------|-------|--------|--------------------|-----------------------|---------------|----------------|--------|
| H | | | | | | | | | |
| 12 Dedicated Acres 320.0 Acres (N/2) | | | | | 13 Joint or Infill | 14 Consolidation Code | 15 Order No. | | |

NO ALLOWABLE WILL BE ASSIGNED TO THIS COMPLETION UNTIL ALL INTERESTS HAVE BEEN CONSOLIDATED
OR A NON-STANDARD UNIT HAS BEEN APPROVED BY THE DIVISION

| | | | |
|---|--|---|--|
| <p>16</p> <p>5198.82'</p> <p>LAT: 36.49055°N LONG: 107.75247°W DATUM: NAD83</p> <p>LAT: 36°29'43.24"N LONG: 107°45'11.11"W DATUM: NAD27</p> <p>LEASE USA NM-03154</p> <p>14</p> <p>5212.68'</p> | | <p>17 OPERATOR CERTIFICATION</p> <p>I hereby certify that the information contained herein is true and complete to the best of my knowledge and belief, and that this organization either owns a working interest or unleased mineral interest in the land including the proposed bottom-hole location or has a right to drill this well at this location pursuant to a contract with an owner of such a mineral or working interest, or to a voluntary pooling agreement or a compulsory pooling order heretofore entered by the division.</p> <p><i>Kandis Roland</i> 5/30/07 Signature Date Kandis Roland Printed Name</p> | |
| <p>5280.00'</p> <p>1745'</p> <p>1845'</p> <p>755'</p> <p>890'</p> <p>5271.42'</p> | | <p>18 SURVEYOR CERTIFICATION</p> <p>I hereby certify that the well location shown on this plat was plotted from field notes of actual surveys made by me or under my supervision, and that the same is true and correct to the best of my belief.</p> <p>Date of Survey: MAY 15, 2007</p> <p>Signature and Seal of Professional Surveyor</p> <p>JASON C. EDWARDS NEW MEXICO REGISTERED PROFESSIONAL SURVEYOR 15269</p> <p><i>JASON C. EDWARDS</i> Certificate Number 15269</p> | |

District I

1625 N. French Dr., Hobbs, NM 88240

District II

1301 W. Grand Ave., Artesia, NM 88210

District III

1000 Rio Brazos Rd., Aztec, NM 87410

District IV

1220 S. St. Francis Dr., Santa Fe, NM 87505

Energy, Minerals and Natural Resources

May 27, 2004

OIL CONSERVATION DIVISION

1220 South St. Francis Dr.

Santa Fe, NM 87505

WELL API NO.

30-045- 34362

5. Indicate Type of Lease

STATE ☐FEE ☐

6. State Oil & Gas Lease No.

Federal Lease # NM-03154

7. Lease Name or Unit Agreement Name

Ballard

8. Well Number

#13F

9. OGRID Number

14538

10. Pool name or Wildcat

Basin Dakota

SUNDRY NOTICES AND REPORTS ON WELLS

(DO NOT USE THIS FORM FOR PROPOSALS TO DRILL OR TO DEEPEN OR PLUG BACK TO A DIFFERENT RESERVOIR. USE "APPLICATION FOR PERMIT" (FORM C-101) FOR SUCH PROPOSALS.)

1. Type of Well:

Oil Well ☐Gas Well ☒

Other

2. Name of Operator

BURLINGTON RESOURCES OIL & GAS COMPANY LP

3. Address of Operator

3401 E. 30TH STREET, FARMINGTON, NM 87402

4. Well Location

Unit Letter H : 1745' feet from the North line and 755' feet from the East line
Section 14 Township 26N Rng 9W NMPM County San Juan

11. Elevation (Show whether DR, RKB, RT, GR, etc.)

6288'

Pit or Below-grade Tank Application

☐ or Closure ☐

Pit type

New Drill

Depth to Groundwater

<100

Distance from nearest fresh water well

>1000

Distance from nearest surface water

>1000

Pit Liner Thickness:

12

mil

Below-Grade Tank:

Volume

bbls;

Construction Material

12. Check Appropriate Box to Indicate Nature of Notice, Report or Other Data

NOTICE OF INTENTION TO:

PERFORM REMEDIAL WORK ☐PLUG AND ABANDON ☐TEMPORARILY ABANDON ☐CHANGE PLANS ☐PULL OR ALTER CASING ☐MULTIPLE COMPL ☐

SUBSEQUENT REPORT OF:

REMEDIAL WORK ☐ALTERING CASING ☐COMMENCE DRILLING OPNS. ☐P AND A ☐CASING/CEMENT JOB ☐

OTHER:

New Drill ☒OTHER: ☐

13. Describe proposed or completed operations. (Clearly state all pertinent details, and give pertinent dates, including estimated date of starting any proposed work). SEE RULE 1103. For Multiple Completions: Attach wellbore diagram of proposed completion or recompletion.

New Drill, Lined:

Burlington Resources proposes to construct a new drilling pit, an associated vent/flare pit and a pre-set mud pit (if required). Based on Burlington's interpretation of the Ecosphere's risk ranking criteria, the new drilling pit and pre-set mud pit will be lined pits as detailed in Burlington's Revised Drilling / Workover Pit Construction / Operation Procedures dated November 11, 2004 on file at the NMOCD office. A portion of the vent/flare pit will be designed to manage fluids and that portion will be lined as per the risk ranking criteria. Burlington Resources anticipates closing these pits according to the Drilling / Workover Pit Closure Procedure dated August 2, 2004 on file at the NMOCD office.

I hereby certify that the information above is true and complete to the best of my knowledge and belief. I further certify that any pit or below-grade tank has been/will be constructed or closed according to NMOCD guidelines ☐, a general permit ☒ or an (attached) alternative OCD-approved plan ☐.

SIGNATURE

TITLE

Regulatory Technician

DATE

7-9-07

Type or print name

Rhonda Rogers

E-mail address:

rogerr@conocophillips.com

Telephone No.

505-599-4018

For State Use Only

APPROVED BY

TITLE

Deputy Oil & Gas Inspector,
District #3

DATE

AUG 23 2007

Conditions of Approval (if any):

~ SURFACE OWNER ~

Bureau of Land Management

LATITUDE: 36°29.4324'N
LONGITUDE: 107°45.1111'W
DATUM: NAD1927



BURLINGTON RESOURCES OIL & GAS COMPANY BALLARD #13F
17445' FNL & 755' FEL, SECTION 14, T26N, R9W, NMPM
SAN JUAN COUNTY, NEW MEXICO ELEVATION: 6288'

EDGE OF TOTAL DISTURBANCE (MARKED WITH STEEL T-POSTS)

AREA OF TOTAL DISTURBANCE
400' X 325' = 2.98 ACRES

EDGE OF TOTAL DISTURBANCE
(MARKED WITH STEEL T-POSTS)

EDGE OF EXISTING WELLPAD

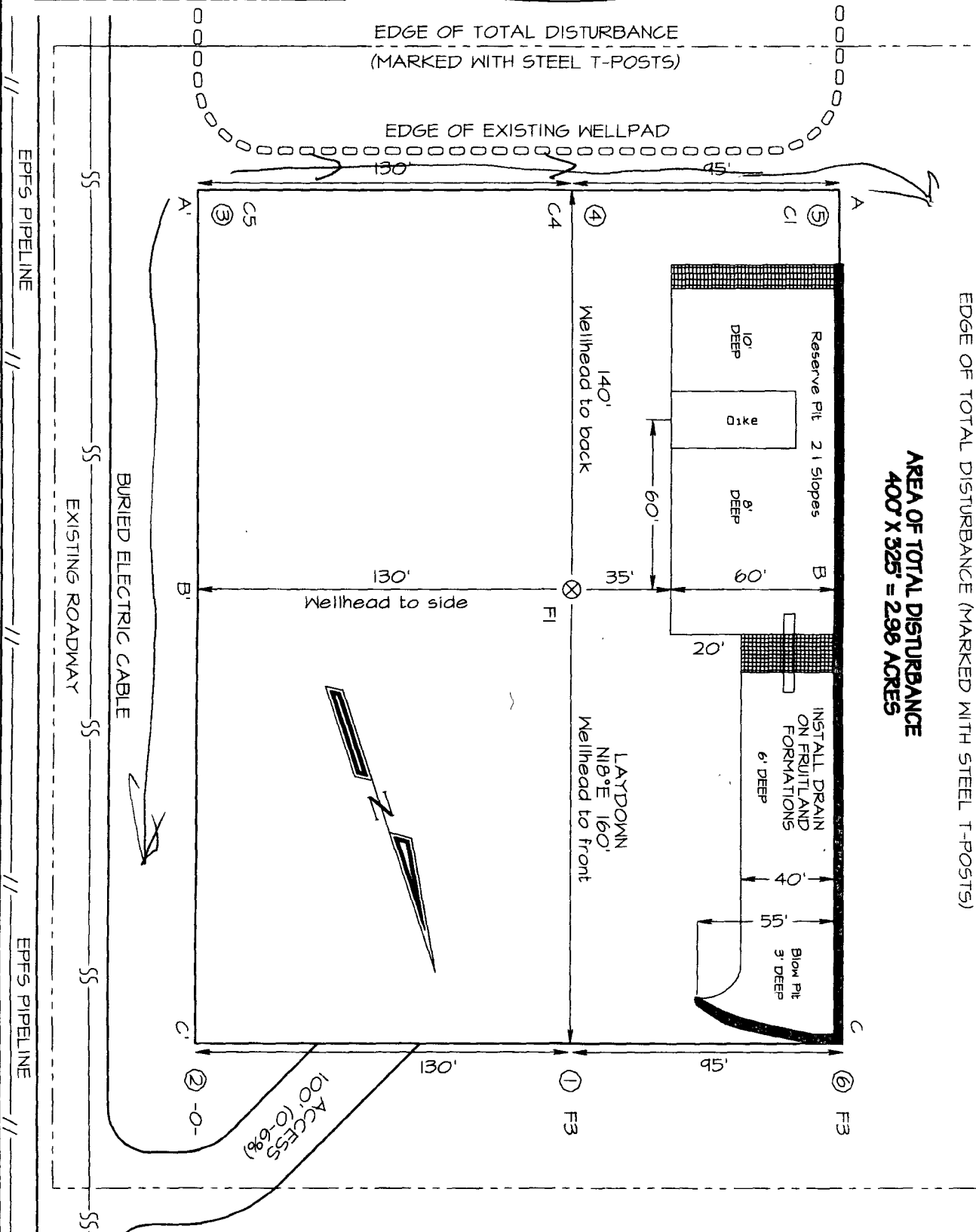

NCE SURVEYS IS NOT LIABLE FOR LOCATION OF UNDERGROUND UTILITIES OR PIPELINES.

CONTRACTOR SHOULD CONTACT ONE-CALL FOR LOCATION OF ANY MARKED OR UNMARKED UNDERGROUND UTILITIES OR PIPELINES ON WELLPAD AND/OR ACCESS ROAD AT LEAST TWO WORKING DAYS PRIOR TO CONSTRUCTION.

PROJECT PROPOSAL - New Drill / Sidetrack

San Juan Business Unit

BALLARD 13F

DEVELOPMENT

| | | | | | |
|-------------------------------|--|---------------------|-------------------|--------------------|------------------|
| Lease: | | AFE #: WAN.ZA2.5600 | | AFE \$: 555,456.70 | |
| Field Name: hBR_SAN JUAN | | Rig: Bearcat Rig 4 | | State: NM | County: SAN JUAN |
| Geologist: | | Phone: | Geophysicist: | | Phone: |
| Geoscientist: Head, Chip F | | Phone: 505-326-9772 | Prod. Engineer: | | Phone: |
| Res. Engineer: Prabowo, Wahyu | | Phone: 505-326-9797 | Proj. Field Lead: | | Phone: |

Primary Objective (Zones):

| Zone | Zone Name |
|------|-----------------------------|
| FRR | BASIN DAKOTA (PRORATED GAS) |

| | | | | | |
|---------------------|------------------------|--------------------|------|----------------|-------------|
| Location: Surface | | Datum Code: NAD 27 | | Straight Hole | |
| Latitude: 36.490540 | Longitude: -107.751857 | X: | Y: | Section: 14 | Range: 009W |
| Footage X: 755 FEL | Footage Y: 1745 FNL | Elevation: 6288 | (FT) | Township: 026N | |
| Tolerance: | | | | | |

| | | | |
|----------------|--------------------|------------------|--------------------|
| Location Type: | Start Date (Est.): | Completion Date: | Date In Operation: |
|----------------|--------------------|------------------|--------------------|

Formation Data: Assume KB = 6300 Units = FT

| Formation Call & Casing Points | Depth (TVD in Ft) | SS (Ft) | Depletion (Yes/No) | BHP (PSIG) | BHT | Remarks |
|--------------------------------|-------------------|---------|--------------------------|------------|-----|--|
| Surface Casing | 320 | 5980 | <input type="checkbox"/> | | | 320' 8 5/8" 24 ppf, J-55, STC casing. Cement with 320 cuft. Circulate cement to surface. |
| OJO ALAMO | 1181 | 5119 | <input type="checkbox"/> | | | |
| KIRTLAND | 1321 | 4979 | <input type="checkbox"/> | | | |
| FRUITLAND | 1736 | 4564 | <input type="checkbox"/> | | | Possible Gas |
| PICTURED CLIFFS | 1984 | 4316 | <input type="checkbox"/> | | | |
| LEWIS | 2076 | 4224 | <input type="checkbox"/> | | | |
| HUERFANITO BENTONITE | 2407 | 3893 | <input type="checkbox"/> | | | |
| CHACRA | 2852 | 3448 | <input type="checkbox"/> | | | |
| MASSIVE CLIFF HOUSE | 3531 | 2769 | <input type="checkbox"/> | | | |
| MENEFEE | 3633 | 2667 | <input type="checkbox"/> | | | |
| MASSIVE POINT LOOKOUT | 4415 | 1885 | <input type="checkbox"/> | | | GAS |
| MANCOS | 4788 | 1512 | <input type="checkbox"/> | | | |
| UPPER GALLUP | 5444 | 856 | <input type="checkbox"/> | | | |
| GREENHORN | 6297 | 3 | <input type="checkbox"/> | | | |
| GRANEROS | 6353 | -53 | <input type="checkbox"/> | | | |
| TWO WELLS | 6380 | -80 | <input type="checkbox"/> | 2050 | | Gas |
| PAGUATE | 6476 | -176 | <input type="checkbox"/> | | | |
| CUBERO | 6544 | -244 | <input type="checkbox"/> | | | |
| ENCINAL | 6598 | -298 | <input type="checkbox"/> | | | |
| TOTAL DEPTH DK | 6627 | -327 | <input type="checkbox"/> | | | Mud-drilled, we already allowed for 40' mud shoe. 7-7/8" hole. 4-1/2", 11.6 ppf, L-80, LTC casing. Cement with 1976 cuft. Circulate cement to surface. |

Reference Wells:

| Reference Type | Well Name | Comments |
|----------------|-----------|----------|
|----------------|-----------|----------|

PROJECT PROPOSAL - New Drill / Sidetrack

San Juan Business Unit

BALLARD 13F

DEVELOPMENT

Logging Program:

Intermediate Logs: ☐ Log only if show ☐ GR/ILD ☐ Triple Combo

TD Logs: ☐ Triple Combo ☐ Dipmeter ☐ RFT ☐ Sonic ☐ VSP ☐ TDT ☒ Other

GR/CBL. Est bottom perf: 25' above TD.

Additional Information:

| Log Type | Stage | From (Ft) | To (Ft) | Tool Type/Name | Remarks |
|----------|-------|-----------|---------|----------------|---------|
|----------|-------|-----------|---------|----------------|---------|

Comments: Location/Tops/Logging - DK 26N09W14NE Avoid A, twin Turner-Ballard 3-14 (PC), else prefer H,B,G - entire 1/4 in BLM Wildlife Project area.

Zones - DK 26N09W14NE