

UNITED STATES
DEPARTMENT OF THE INTERIOR
BUREAU OF LAND MANAGEMENT

RCVD OCT 23 '07

OIL CONS. DIV.

DIST. 3

APPLICATION FOR PERMIT TO DRILL, DEEPEN, OR PLUG BACK

1a. Type of Work DRILL	RECEIVED SEP 20 2007 Bureau of Land Management Farmington Field Office	5. Lease Number USA SF-080516
1b. Type of Well GAS		Unit Reporting Number
2. Operator BURLINGTON RESOURCES Oil & Gas Company, LP		6. If Indian, All. or Tribe
3. Address & Phone No. of Operator PO Box 4289, Farmington, NM 87499 (505) 326-9700		7. Unit Agreement Name San Juan 28-5 Unit
4. Location of Well Surf: Unit M(SWSW), 1035' FSL & 865' FWL BH: Unit K(NESW), 1955' FSL & 1925' FWL Surf: Latitude 36° 39.4070 N Longitude 107° 20.0406 W BH: Latitude 36° 39.5588 N Longitude 107° 19.8234 W		8. Farm or Lease Name 9. Well Number #91P 10. Field, Pool, Wildcat Blanco MV/Basin DK 11. Sec., Twn, Rge, Mer. (NMPM) M Sec. 14, T28N, R5W API # 30-039- 30372
14. Distance in Miles from Nearest Town 6 mile/Gobernador		12. County Rio Arriba
15. Distance from Proposed Location to Nearest Property or Lease Line 865'		13. State NM
16. Acres in Lease 640		17. Acres Assigned to Well MV 320 (S/2)/DK 320 (W/2)
18. Distance from Proposed Location to Nearest Well, Drlg, Compl, or Applied for on this Lease 50' from San Juan 28-5 91		
19. Proposed Depth 8227' TVD/8525' TMD		20. Rotary or Cable Tools Rotary
21. Elevations (DF, FT, GR, Etc.) 6849' GL		22. Approx. Date Work will Start
23. Proposed Casing and Cementing Program See Operations Plan attached		
24. Authorized by: <u>Rhonda Rogers</u> Rhonda Rogers (Regulatory Technician)		9-20-07 Date

NOTIFY AZTEC OCD 24 HRS.
PRIOR TO CASING & CEMENT

PERMIT NO. _____ APPROVAL DATE _____
APPROVED BY [Signature] TITLE AEM DATE 10/22/07

Archaeological Report attached

Threatened and Endangered Species Report attached

NOTE: This format is issued in lieu of U.S. BLM Form 3160-3

Title 18 U.S.C. Section 1001, makes it a crime for any person knowingly and willfully to make to any department or agency of the United States any false, fictitious or fraudulent statements or presentations as to any matter within its jurisdiction.

Example Master Plan Type 3

Bond Numbers NMB-000015 and NMB-000089

This action is subject to technical and procedural review pursuant to 43 CFR 3165.3 and appeal pursuant to 43 CFR 3165.4

OCT 30 2007
NMOCB

DRILLING OPERATIONS AUTHORIZED ARE
SUBJECT TO COMPLIANCE WITH ATTACHED
"GENERAL REQUIREMENTS".

HOLD C104 FOR directional survey
W8 Drilled C-102 Form

RECEIVED

District I
1625 N. French Dr., Hobbs, NM 88240

District II
1301 W. Grand Avenue, Artesia, NM 88210

District III
1000 Rio Brazos Rd., Aztec, NM 87410

District IV
1220 S. St. Francis Dr., Santa Fe, NM 87505

State of New Mexico
Energy, Minerals & Natural Resources Department

OIL CONSERVATION DIVISION
1220 South St. Francis Dr.
Santa Fe, NM 87505

SEP 20 2007

Form C-102
Revised October 12, 2005
Instructions on back
Submit to Appropriate District Office
State Lease - 4 Copies
Fee Lease - 3 Copies

☐ AMENDED REPORT

WELL LOCATION AND ACREAGE DEDICATION PLAT

*API Number 30-039-30372		*Pool Code 72319 / 71599	*Pool Name BLANCO MESAVERDE / BASIN DAKOTA
*Property Code 7460	*Property Name SAN JUAN 28-5 UNIT		*Well Number 91P
*DGRJO No. 14538	*Operator Name BURLINGTON RESOURCES OIL & GAS COMPANY, LP		*Elevation 6849'

10 Surface Location

UL or lot no.	Section	Township	Range	Lot 10	Feet from the	North/South line	Feet from the	East/West line	County
M	14	28N	5W		1035	SOUTH	865	WEST	RIO ARriba

11 Bottom Hole Location If Different From Surface

UL or lot no.	Section	Township	Range	Lot 10	Feet from the	North/South line	Feet from the	East/West line	County
K	14	28N	5W		1955	SOUTH	1925	WEST	RIO ARriba

*Dedicated Acres	320.0 Acres - S/2 (MV)	*Joint or Infill		*Consolidation Code		*Order No.	
	320.0 Acres - W/2 (DK)						

NO ALLOWABLE WILL BE ASSIGNED TO THIS COMPLETION UNTIL ALL INTERESTS HAVE BEEN CONSOLIDATED OR A NON-STANDARD UNIT HAS BEEN APPROVED BY THE DIVISION

	<p>16</p> <p>5297.16'</p> <p>LEASE USA SF-079250</p> <p>14</p> <p>5280.00'</p> <p>1605'</p> <p>685'</p> <p>1925'</p> <p>715'</p> <p>1406.0'</p> <p>1715'</p> <p>865'</p> <p>1035'</p> <p>1455'</p> <p>5283.96'</p> <p>BOTTOM-HOLE LOCATION LAT: 36.65832° N LONG: 107.33099° W DATUM: NAD83 LAT: 36.39.5582° N LONG: 107.19.8234° W DATUM: NAD27 SURFACE LOCATION LAT: 36.65679° N LONG: 107.33461° W DATUM: NAD83 LAT: 36.39.4070° N LONG: 107.20.0406° W DATUM: NAD27</p>	<p>17 OPERATOR CERTIFICATION</p> <p>I hereby certify that the information contained herein is true and complete to the best of my knowledge and belief, and that this organization either owns a working interest or has a right to drill this well at this location pursuant to a contract with an owner of such a mineral or working interest, or to a voluntary pooling agreement or a compulsory pooling order heretofore entered by the division.</p> <p><i>Kandis Roland</i> 6/22/07 Signature Date</p> <p>Kandis Roland Printed Name</p> <p>18 SURVEYOR CERTIFICATION</p> <p>I hereby certify that the well location shown on this plat was plotted from field notes of actual surveys made by me or under my supervision, and that the same is true and correct to the best of my belief</p> <p>Date of Survey: MAY 24, 2007</p> <p>Signature and Seal of Professional Surveyor</p> <p> JASON C. EDWARDS Certificate Number 15269</p>
--	---	---

Office

Energy, Minerals and Natural Resources

May 27, 2004

District I

1625 N. French Dr., Hobbs, NM 88240

District II

1301 W. Grand Ave., Artesia, NM 88210

District III

1000 Rio Brazos Rd., Aztec, NM 87410

District IV

1220 S. St. Francis Dr., Santa Fe, NM 87505

OIL CONSERVATION DIVISION

1220 South St. Francis Dr.

Santa Fe, NM 87505

WELL API NO.

30-039-30372

5. Indicate Type of Lease

STATE ☐FEE ☐

6. State Oil & Gas Lease No.

Federal Lease #USA SF-079250 080516

7. Lease Name or Unit Agreement Name

San Juan 28-5 Unit

8. Well Number

#91P

9. OGRID Number

14538

10. Pool name or Wildcat

Blanco MV/Basin DK

SUNDRY NOTICES AND REPORTS ON WELLS

(DO NOT USE THIS FORM FOR PROPOSALS TO DRILL OR TO DEEPEN OR PLUG BACK TO A DIFFERENT RESERVOIR. USE "APPLICATION FOR PERMIT" (FORM C-101) FOR SUCH PROPOSALS.)

1. Type of Well:

Oil Well ☐Gas Well ☒

Other

2. Name of Operator

BURLINGTON RESOURCES OIL & GAS COMPANY LP

3. Address of Operator

3401 E. 30TH STREET, FARMINGTON, NM 87402

4. Well Location

Unit Letter M : 1035' feet from the South line and 865' feet from the West line
Section 14 Township 28N Rng 5W NMPM County Rio Arriba

11. Elevation (Show whether DR, RKB, RT, GR, etc.)

6849'

Pit or Below-grade Tank Application

or Closure ☐

Pit type New Drill

Depth to Groundwater

>50

Distance from nearest fresh water well

>1000

Distance from nearest surface water

<1000

Pit Liner Thickness:

12

mil

Below-Grade Tank:

Volume

bbls;

Construction Material

12. Check Appropriate Box to Indicate Nature of Notice, Report or Other Data

NOTICE OF INTENTION TO:

PERFORM REMEDIAL WORK ☐PLUG AND ABANDON ☐TEMPORARILY ABANDON ☐CHANGE PLANS ☐PULL OR ALTER CASING ☐MULTIPLE COMPL ☐

OTHER:

New Drill ☒

SUBSEQUENT REPORT OF:

REMEDIAL WORK ☐ALTERING CASING ☐COMMENCE DRILLING OPNS. ☐P AND A ☐CASING/CEMENT JOB ☐OTHER: ☐

13. Describe proposed or completed operations. (Clearly state all pertinent details, and give pertinent dates, including estimated date of starting any proposed work). SEE RULE 1103. For Multiple Completions: Attach wellbore diagram of proposed completion or recompletion.

New Drill, Lined:

Burlington Resources proposes to construct a new drilling pit, an associated vent/flare pit and a pre-set mud pit (if required). Based on Burlington's interpretation of the Ecosphere's risk ranking criteria, the new drilling pit and pre-set mud pit will be lined pits as detailed in Burlington's Revised Drilling / Workover Pit Construction / Operation Procedures dated November 11, 2004 on file at the NMOCD office. A portion of the vent/flare pit will be designed to manage fluids and that portion will be lined as per the risk ranking criteria. Burlington Resources anticipates closing these pits according to the Drilling / Workover Pit Closure Procedure dated August 2, 2004 on file at the NMOCD office

I hereby certify that the information above is true and complete to the best of my knowledge and belief. I further certify that any pit or below-grade tank has been/will be constructed or closed according to NMOCD guidelines ☐, a general permit ☒ or an (attached) alternative OCD-approved plan ☐.

SIGNATURE

TITLE

Regulatory Technician

DATE

9-19-07

Type or print name

Rhonda Rogers

E-mail address:

rogerrs@conocophillips.com

Telephone No.

505-599-4018

For State Use Only

APPROVED BY

TITLE

Deputy Oil & Gas Inspector,
District #3

DATE

OCT 30 2007

Conditions of Approval (if any):



TECHNICAL SERVICES
A CORROSION COMPANY

CATHODIC PROTECTION PLAN FOR NEW WELLS

WELL NAME SJ 28-5 #91P LEGALS M-14-28-5 COUNTY Rio Arriba

PURPOSED C.P. SYSTEM: Drill GB on east edge of location set rectifier on SW side of the location. Trench approx 1000' of ALC from existing rectifier on SJ 28-5 #2 to new rectifier. Trench approx 300' of position from GB to rectifier. Trench approx 150' of #8 neg. from existing well to rectifier. Trench approx 225' of #8 neg. from proposed well to rectifier

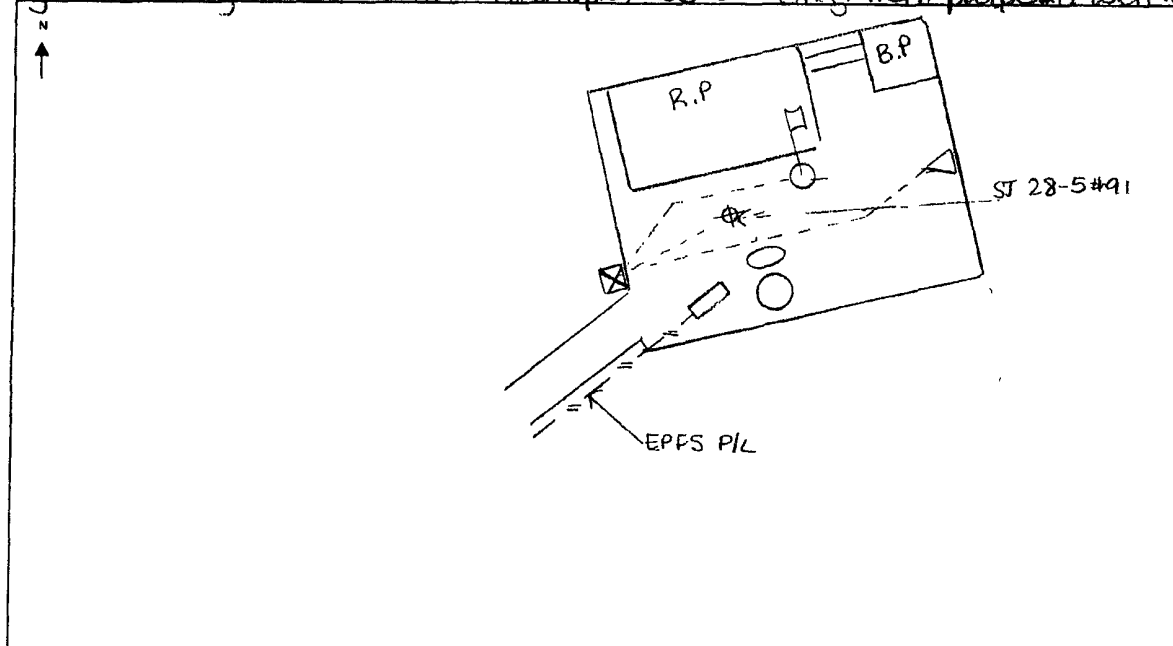

EXISTING WELLHEAD	METER HOUSE	G.B.	POWER SOURCE	CABLE	NEW WELL	OVERHEAD A.C.

COMMENTS: _____

NEAREST POWER SOURCE Existing Rect. SJ 28-5 #2 DISTANCE: 1000'

PIPELINES IN AREA: EPDS P/L

TECHNICIAN: Michael H. Hargrave DATE: 6/21/07

6 CR 5412 BLOOMFIELD, N.M. 87413
OFFICE: 505-634-0271 CELL: 505-793-6953

PROJECT PROPOSAL - New Drill / Sidetrack

San Juan Business Unit

SAN JUAN 28-5 UNIT 91P

DEVELOPMENT

Lease:		AFE #: WAN.CDR.7131		AFE \$:	
Field Name: hBR_SAN JUAN 28-5 UNIT		Rig: Aztec Rig 730		State: NM	County: RIO ARRIBA
Geologist:		Phone:		Geophysicist:	
Geoscientist: Riley, Brook		Phone: +1 505-324-6108		Prod. Engineer:	
Res. Engineer: McKee, Cory J		Phone: 505-326-9826		Proj. Field Lead:	
Primary Objective (Zones):					
Zone	Zone Name				
FRR	BASIN DAKOTA (PRORATED GAS)				
RON	BLANCO MESAVERDE (PRORATED GAS)				
Location: Surface					
Datum Code: NAD 27		Deviated			
Latitude: 36.656782	Longitude: -107.334009	X:	Y:	Section: 14	Range: 005W
Footage X: 865 FWL	Footage Y: 1035 FSL	Elevation: 6849	(FT)	Township: 028N	
Tolerance:					
Location: Bottom Hole					
Datum Code: NAD 27		Deviated			
Latitude: 36.659312	Longitude: -107.330389	X:	Y:	Section: 14	Range: 005W
Footage X: 1925 FWL	Footage Y: 1955 FSL	Elevation:	(FT)	Township: 028N	
Tolerance:					
Location Type: Restricted		Start Date (Est.): 1/1/2008		Completion Date:	
				Date In Operation:	
Formation Data: Assume KB = 6865 Units = FT					
Formation Call & Casing Points	Depth (TVD in Ft)	SS (Ft)	Depletion (Yes/No)	BHP (PSIG)	BHT
Surface Casing	200	6665	<input type="checkbox"/>		
OJAM	3150	3715	<input type="checkbox"/>		
KRLD	3276	3589	<input type="checkbox"/>		
FRLD	3426	3439	<input type="checkbox"/>		Possible Gas
PCCF	3805	3060	<input type="checkbox"/>		
LEWS	3964	2901	<input type="checkbox"/>		
Intermediate Casing	4064	2801	<input type="checkbox"/>		
HUERFANITO BENTONITE	4420	2445	<input type="checkbox"/>		
CHRA	4792	2073	<input type="checkbox"/>		
UCLFH	5387	1478	<input type="checkbox"/>		Gas
MASSIVE CLIFF HOUSE	5610	1255	<input type="checkbox"/>	678	Gas
MENF	5672	1193	<input type="checkbox"/>		
PTLK	5974	891	<input type="checkbox"/>		
MNCS	6442	423	<input type="checkbox"/>		
GLLP	7018	-153	<input type="checkbox"/>		
GRHN	7940	-1075	<input type="checkbox"/>		
GRRS	7994	-1129	<input type="checkbox"/>		
TWLS	8055	-1190	<input type="checkbox"/>	2500	Gas
CBRO	8125	-1260	<input type="checkbox"/>		
CBRL	8177	-1312	<input type="checkbox"/>		
TOTAL DEPTH DK	8227	-1362	<input type="checkbox"/>		
12-1/4 hole. 200' 9 5/8" 32.3 ppf, H-40, STC casing. Cement with 203 cuft. Circulate cement to surface.					
8 3/4" Hole. 7", 20/23 ppf, J-55, STC Casing. Cement with 972 cuft. Circulate cement to surface.					
6-1/4" Hole. 4-1/2", 10.6/11.6 ppf, J-55 STC/LTC casing. Cement with 567 cuft. Circulate cement a minimum of 100' inside the previous casing string.					

ConocoPhillips or its affiliates

Survey Report

Company:	ConocoPhillips Lower 48	Local Co-ordinate Reference:	Well SJ 28-5 #91P
Project:	San Juan Basin	TVD Reference:	WELL @ 6864.0ft (Original Well Elev)
Site:	Monty's Site for directional MV/DK wells	MD Reference:	WELL @ 6864.0ft (Original Well Elev)
Well:	SJ 28-5 #91P	North Reference:	True
Wellbore:	SJ 28-5 #91P	Survey Calculation Method:	Minimum Curvature
Design:	Plan #1	Database:	EDM Central Planning

Planned Survey										
Measured Depth (ft)	Inclination (d)	Azimuth (d)	Vertical Depth (ft)	+N/-S (ft)	+E/-W (ft)	Vertical Section (ft)	Dogleg Rate (d/100ft)	Build Rate (d/100ft)	Turn Rate (d/100ft)	
8,400.0	0.00	0.00	8,101.6	920.0	1,060.0	1,403.6	0.00	0.00	0.00	
8,423.4	0.00	0.00	8,125.0	920.0	1,060.0	1,403.6	0.00	0.00	0.00	
Upper Cubero										
8,475.4	0.00	0.00	8,177.0	920.0	1,060.0	1,403.6	0.00	0.00	0.00	
Lower Cubero										
8,500.0	0.00	0.00	8,201.6	920.0	1,060.0	1,403.6	0.00	0.00	0.00	
8,525.4	0.00	0.00	8,227.0	920.0	1,060.0	1,403.6	0.00	0.00	0.00	
TD - SJ 28-5 #91P - PCP										

Targets										
Target Name	hit/miss target	Dip Angle (d)	Dip Dir (d)	TVD (ft)	+N/-S (ft)	+E/-W (ft)	Northing (m)	Easting (m)	Latitude	Longitude
SJ 28-5 #91P - ICP	- plan hits target	0.00	0.00	4,064.0	920.0	1,060.0	275.81	327.14	30° 59' 33.618" N	109° 25' 31.916" W
	- Point									
SJ 28-5 #91P - PCP	- plan hits target	0.00	0.00	8,227.0	920.0	1,060.0	275.81	327.14	30° 59' 33.618" N	109° 25' 31.916" W
	- Point									

Formations						
Measured Depth (ft)	Vertical Depth (ft)	Name	Lithology	Dip (d)	Dip Direction (d)	
3,410.0	3,150.0	Ojo Alamo		0.00		
3,550.1	3,276.0	Kirtland		0.00		
3,711.9	3,426.0	Fruitland		0.00		
4,102.6	3,805.0	Pictured Cliffs		0.00		
4,262.3	3,964.0	Lewis		0.00		
4,718.4	4,420.0	Huerf Bent		0.00		
5,090.4	4,792.0	Chacra		0.00		
5,685.4	5,387.0	Upper Cliffhouse		0.00		
5,908.4	5,610.0	Mass Cliffhouse		0.00		
5,970.4	5,672.0	Menefee		0.00		
6,272.4	5,974.0	Pt. Lookout		0.00		
6,740.4	6,442.0	Mancos Shale		0.00		
7,316.4	7,018.0	Gallup		0.00		
8,238.4	7,940.0	Greenhorn		0.00		
8,292.4	7,994.0	Graneros		0.00		
8,353.4	8,055.0	Two Wells		0.00		
8,423.4	8,125.0	Upper Cubero		0.00		
8,475.4	8,177.0	Lower Cubero		0.00		
8,525.4	8,227.0	TD		0.00		

Checked By: _____ Approved By: _____ Date: _____

~ SURFACE OWNER ~

Bureau of Land Management

LATITUDE: 36°39.4070'N
LONGITUDE: 107°20.0406'W
DATUM: NAD1927

GRAPHIC SCALE 1"=50'

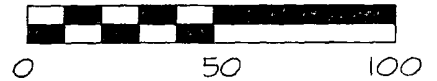

BURLINGTON RESOURCES OIL & GAS COMPANY SAN JUAN 28-5 UNIT #91P
1035' FSL & 865' FWL, SECTION 14, T28N, R5W, NMPM
RIO ARriba COUNTY, NEW MEXICO ELEVATION: 6849'

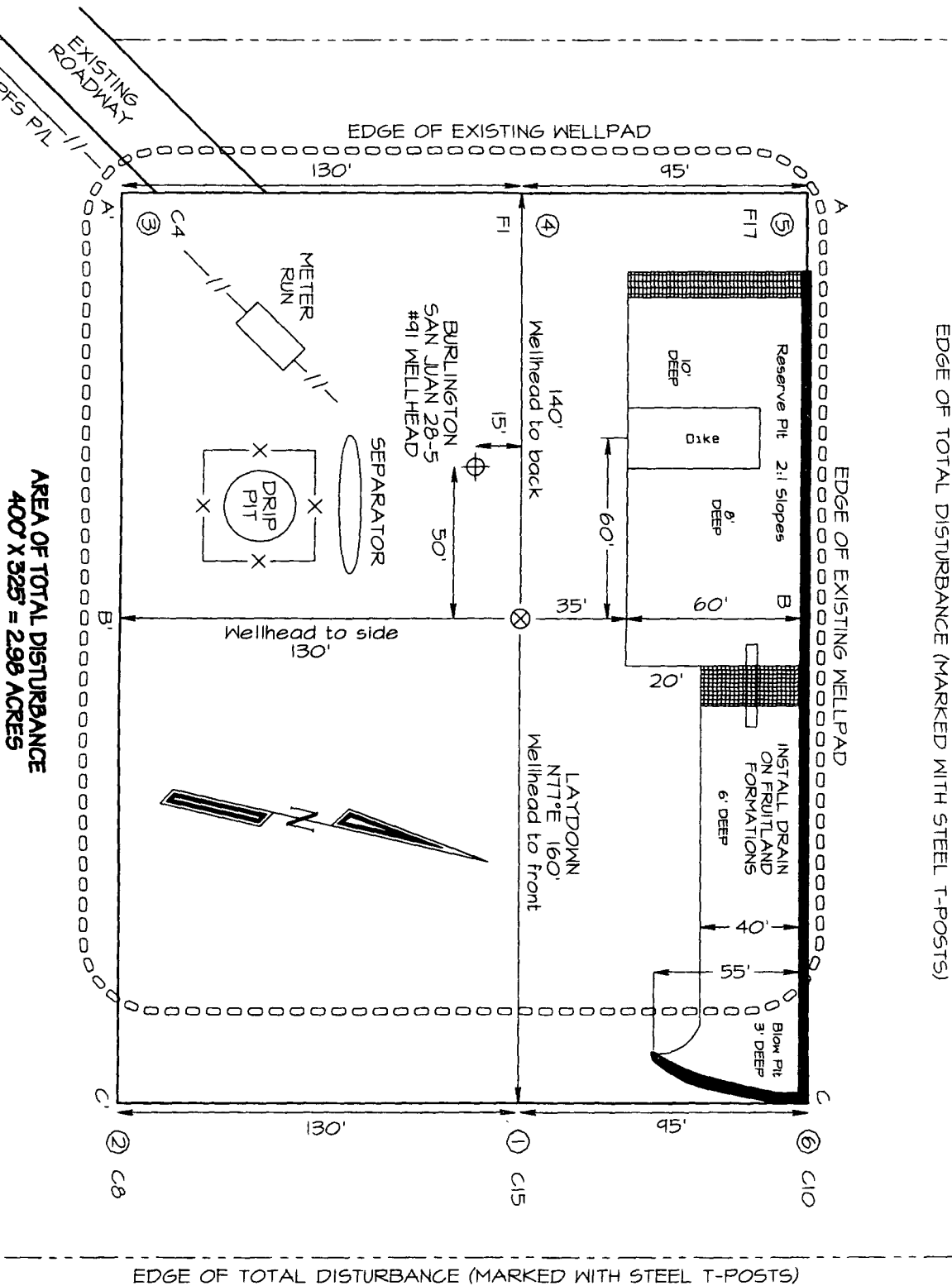

NCE SURVEYS IS NOT LIABLE FOR LOCATION OF UNDERGROUND UTILITIES OR PIPELINES.

CONTRACTOR SHOULD CONTACT ONE-CALL FOR LOCATION OF ANY MARKED OR UNMARKED UNDERGROUND UTILITIES OR PIPELINES ON WELLPAD AND/OR ACCESS ROAD AT LEAST TWO WORKING DAYS PRIOR TO CONSTRUCTION.

BURLINGTON RESOURCES OIL & GAS COMPANY SAN JUAN 28-5 UNIT #91P
1035' FSL & 865' FWL, SECTION 14, T28N, R5W, NMPM
RIO ARriba COUNTY, NEW MEXICO ELEVATION: 6849'

HORIZONTAL SCALE 1"=40'

C/L

VERTICAL SCALE 1"=30'

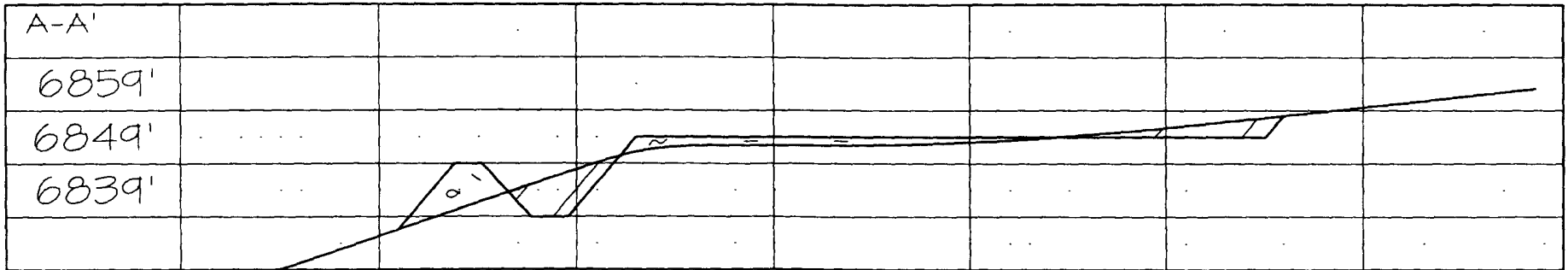

C/L

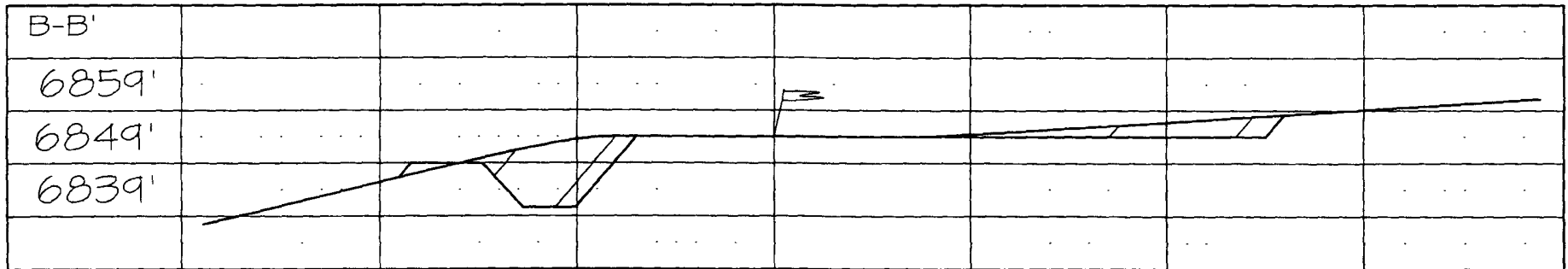

C/L

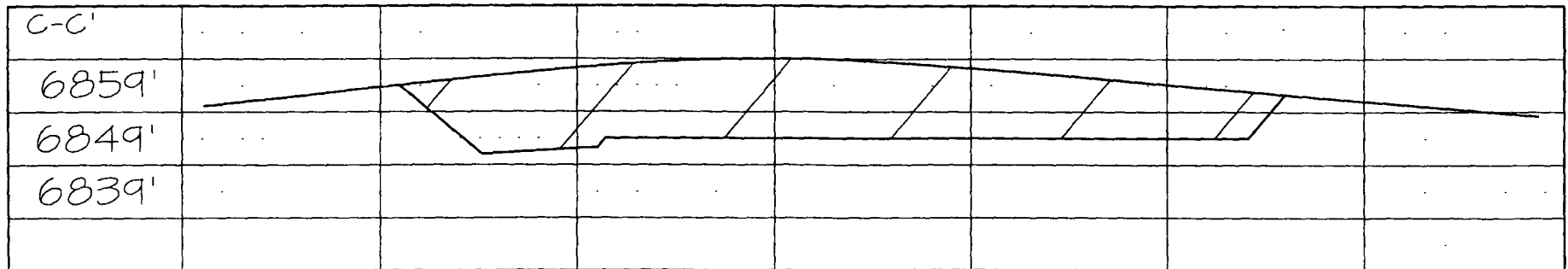

NCE SURVEYS IS NOT LIABLE FOR LOCATION OF UNDERGROUND UTILITIES OR PIPELINES.

CONTRACTOR SHOULD CONTACT ONE-CALL FOR LOCATION OF ANY MARKED OR UNMARKED UNDERGROUND UTILITIES OR PIPELINES ON WELLPAD AND/OR ACCESS ROAD AT LEAST TWO WORKING DAYS PRIOR TO CONSTRUCTION.