

UNITED STATES  
DEPARTMENT OF THE INTERIOR  
GEOLOGICAL SURVEY

30-039-2281 P

5. LEASE DESIGNATION AND SERIAL NO.

NM 43

6. IF INDIAN, ALLOTTEE OR TRIBE NAME

Jicarilla Contract #94

7. UNIT AGREEMENT NAME

8. FARM OR LEASE NAME

Jicarilla F

9. WELL NO.

7A

10. FIELD AND POOL, OR WILDCAT

Blanco Mesaverde Gas

11. SEC. T., R., M., OR BLK.  
AND SURVEY OR AREA

Sec. 24, T27N, R3W

12. COUNTY OR PARISH 13. STATE

Rio Arriba

NM

1a. TYPE OF WORK

DRILL ☒DEEPEN ☐PLUG BACK ☐

b. TYPE OF WELL

OIL  
WELL ☐GAS  
WELL ☒

OTHER

SINGLE  
ZONE ☒MULTIPLE  
ZONE ☐

2. NAME OF OPERATOR

Mobil Producing TX. &amp; N.M. Inc.

3. ADDRESS OF OPERATOR

9 Greenway Plaza, Ste. 2700, Houston, TX 77046

4. LOCATION OF WELL (Report location clearly and in accordance with any State requirements.)

At surface 790' FNL &amp; 890' FWL, Sec. 24, T27N, R3W

At proposed prod. zone Same as surface

14. DISTANCE IN MILES AND DIRECTION FROM NEAREST TOWN OR POST OFFICE\*

U. S. GEOLOGICAL SURVEY  
FARMINGTON, N. M.

15. DISTANCE FROM PROPOSED\* 790'

LOCATION TO NEAREST  
PROPERTY OR LEASE LINE, FT.  
(Also to nearest drig. unit line, if any)

16. NO. OF ACRES IN LEASE

2560

17. NO. OF ACRES ASSIGNED  
TO THIS WELL

320 (2 wells)

18. DISTANCE FROM PROPOSED LOCATION\*  
TO NEAREST WELL, DRILLING, COMPLETED,  
OR APPLIED FOR, ON THIS LEASE, FT.

1680'

19. PROPOSED DEPTH

6500'

20. ROTARY OR CABLE TOOLS

Rotary

21. ELEVATIONS (Show whether DF, RT, GR, etc.)

7075' - GR

DRILLING OPERATIONS AUTHORIZED ARE  
SUBJECT TO COMPLIANCE WITH ATTACHED

22. APPROX. DATE WORK WILL START\*

as soon as possible

23.

"GENERAL REQUIREMENTS"

PROPOSED CASING AND CEMENTING PROGRAM

This action is subject to administrative  
appeal pursuant to 30 CFR 290.

SIZE OF HOLE	SIZE OF CASING	WEIGHT PER FOOT	SETTING DEPTH	QUANTITY OF CEMENT
12-1/4"	8-5/8"*	20# H-40	0 - 350'	1. Circulate to surface
7-7/8"	5-1/2"*	14# K-55	0 - 5400'	2. Circulate to surface in two
	5-1/2"*	15.5# K-55	5400' - 6200'	stages. DV tool set at 3960'±

\*All casing will be new

## CEMENTING PROGRAM

1. Class B with 2% CaCl<sub>2</sub>2. Lead: Howco Lite + 5#/sx gelsonite + 1/4#/sx FC  
Tail: Class B + 1/4#/sx FC

## MUD PROGRAM

Depth	Type of Mud	Weight	Viscosity	PH	Water Loss
0 - 350'	Spud Mud	9.2	40	9.5	NC
350' - 6200'	Fresh Water Gel	8.8	35	9.5	10 cc's

## BLOWOUT PREVENTER PROGRAM

See Attachment

## LOGGING PROGRAM:

Type	Depth
SP-IEL	350' - TD
GR-CNO	350' - TD

IN ABOVE SPACE DESCRIBE PROPOSED PROGRAM: If proposal is to deepen or plug back, give data on present productive zone and proposed new productive zone. If proposal is to drill or deepen directionally, give pertinent data on subsurface locations and measured and true vertical depths. Give blowout preventer program, if any.

24.

SIGNED

*A.D. Bond*

A.D. Bond

TITLE

Regulatory Engineering

Coordinator II

DATE August 11, 1981

(This space for Federal or State office use)

PERMIT NO.

APPROVAL DATE

APPROVED BY

TITLE

DATE

CONDITIONS OF APPROVAL, IF ANY:

\*See Instructions On Reverse Side

NMOC

*Dean Elliott*  
for JAMES F. SIMS  
DISTRICT ENGINEER

**NEW MEXICO OIL CONSERVATION COMMISSION  
WELL LOCATION AND ACREAGE DEDICATION PLAT**

Form C-102  
Supersedes C-128  
Effective 1-1-65

All distances must be from the outer boundaries of the Section.

Operator <b>Mobil Producing TX. &amp; N.M. Inc.</b>			Lease <b>Jicarilla F</b>		Well No. <b>7A</b>
Unit Letter <b>D</b>	Section <b>24</b>	Township <b>27N</b>	Range <b>3W</b>	County <b>Rio Arriba</b>	
Actual Footage Location of Well:					
<b>790</b>		feet from the <b>North</b>	line and	<b>890</b>	feet from the <b>West</b> line
Ground Level Elev. <b>7075'</b>	Producing Formation <b>Mesaverde</b>		Pool <b>Blanco Mesaverde</b>		Dedicated Acreage: <b>320 (2wells)</b> Acres

1. Outline the acreage dedicated to the subject well by colored pencil or hachure marks on the plat below.
2. If more than one lease is dedicated to the well, outline each and identify the ownership thereof (both as to working interest and royalty).
3. If more than one lease of different ownership is dedicated to the well, have the interests of all owners been consolidated by communitization, unitization, force-pooling, etc?

☐ Yes ☐ No If answer is "yes," type of consolidation \_\_\_\_\_

If answer is "no," list the owners and tract descriptions which have actually been consolidated. (Use reverse side of this form if necessary.) \_\_\_\_\_

No allowable will be assigned to the well until all interests have been consolidated (by communitization, unitization, forced-pooling, or otherwise) or until a non-standard unit, eliminating such interests, has been approved by the Commission.

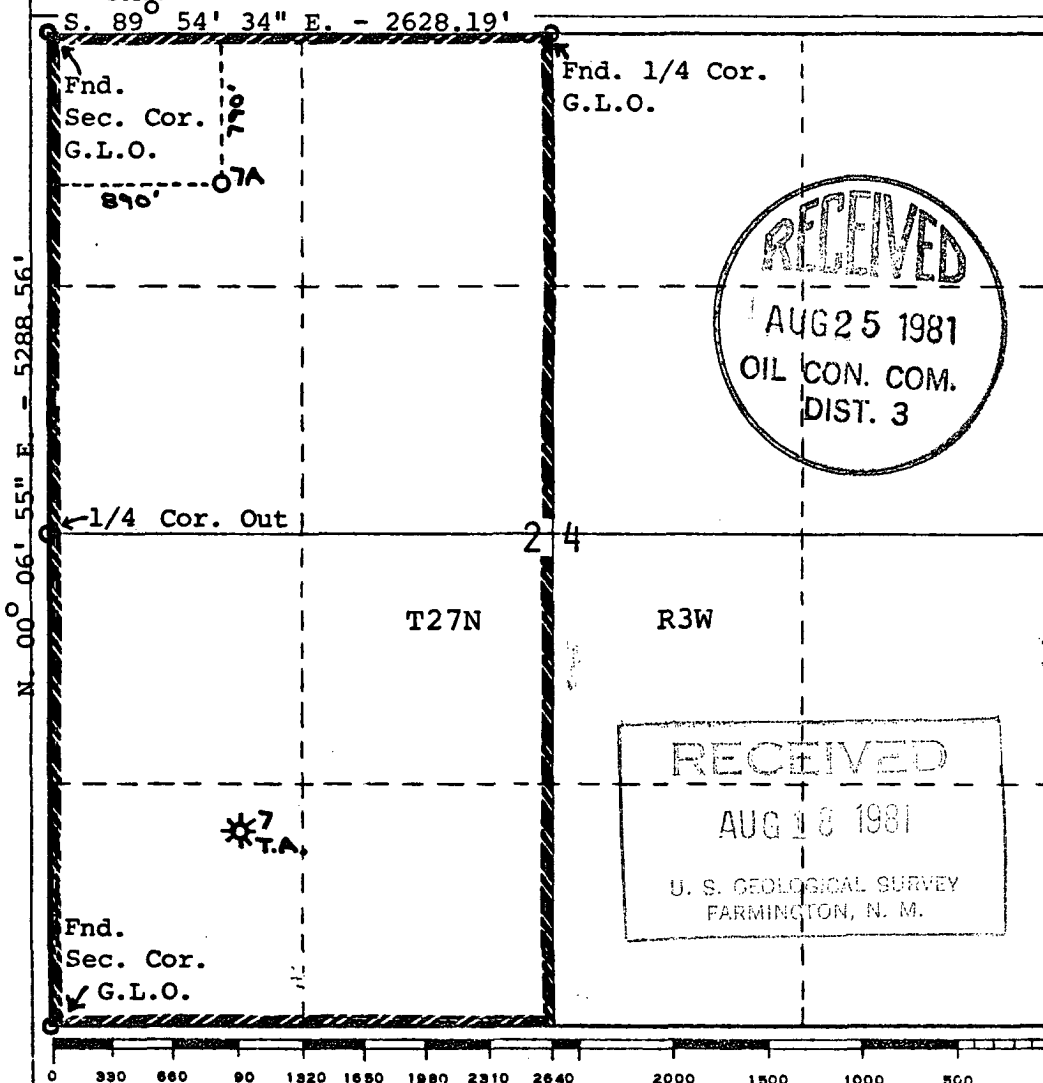

**CERTIFICATION**

I hereby certify that the information contained herein is true and complete to the best of my knowledge and belief.

Name  
**A.D. Bond**  
Position **Regulatory Engineering Coordinator II**  
Company **Mobil Producing TX. & N.M. Inc.**

Date  
**August 11, 1981**

I hereby certify that the well location shown on this plat was plotted from field notes of actual surveys made by me or under my supervision, and that the same is true and correct to the best of my knowledge and belief.

Date Surveyed  
**July 27, 1981**  
Registered Professional Engineer and/or Land Surveyor

**H.A. Carson, Jr.**

Certificate No.  
**5063**

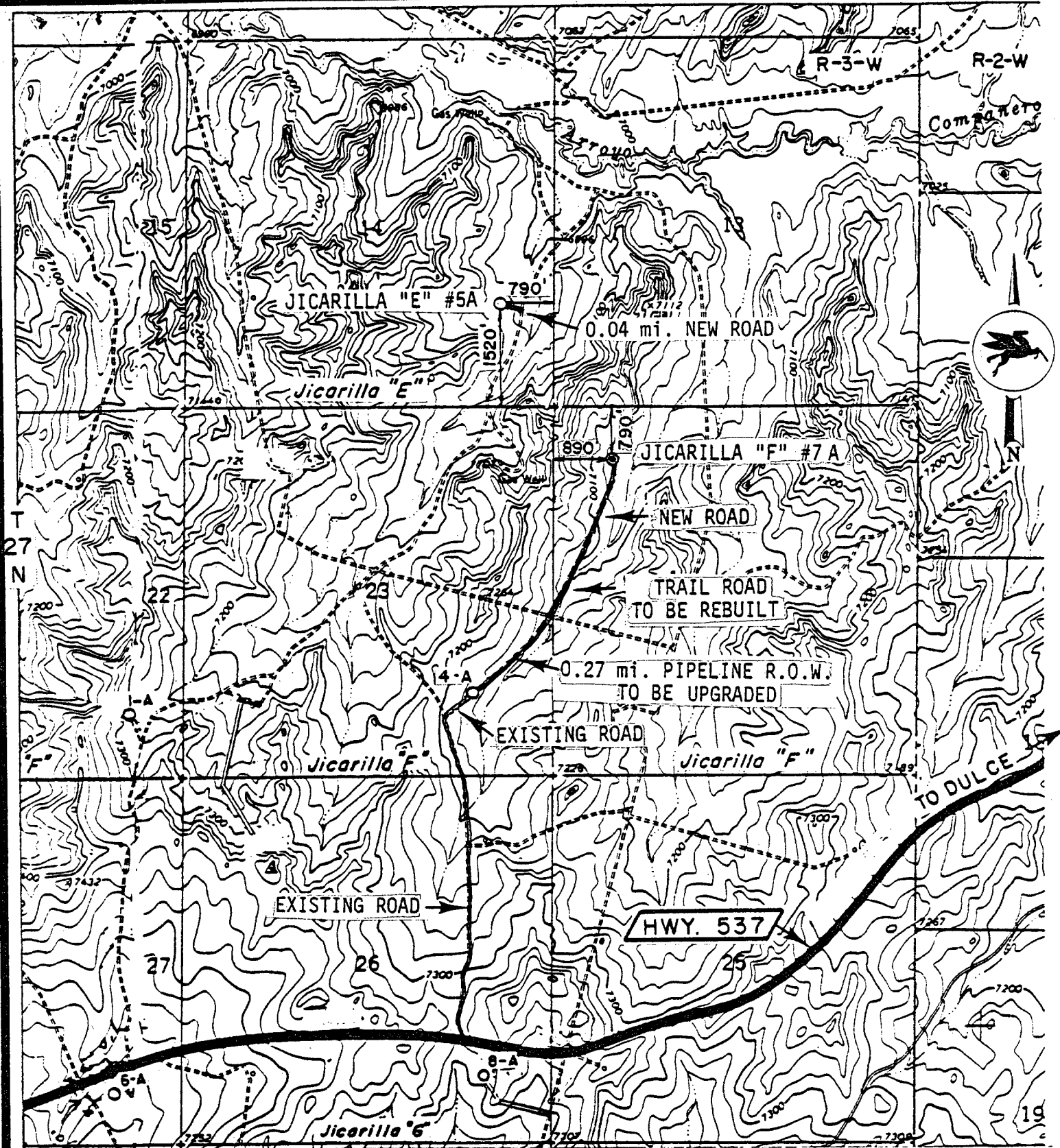

Mobil Producing  
Texas & New Mexico Inc.

MAP "B"  
JICARILLA AREA  
VICINITY PLAT  
BLANCO MESA VERDE FIELD  
RIO ARriba CO. N.MEXICO

Scale 1" = 2000'

Date 7-30-81

Drawn J.W.J.

Checked

Approved

Revised