

UNITED STATES
DEPARTMENT OF THE INTERIOR
BUREAU OF LAND MANAGEMENT

RCVD JAN 16 '08
OIL CONS. DIV.
DIST. 3

APPLICATION FOR PERMIT TO DRILL, DEEPEN, OR PLUG BACK

1a. Type of Work DRILL	5. Lease Number NMSF-078357 Unit Reporting Number
1b. Type of Well GAS	6. If Indian, All. or Tribe
2. Operator BURLINGTON RESOURCES Oil & Gas Company, LP	7. Unit Agreement Name
3. Address & Phone No. of Operator PO Box 4289, Farmington, NM 87499 (505) 326-9700	8. Farm or Lease Name Marshall 9. Well Number #1F
4. Location of Well Surf: Unit D(NWNW), 660' FNL & 660' FWL Surf: Latitude 36° 34.842153 N Longitude 107° 45.841553 W	10. Field, Pool, Wildcat Basin Dakota 11. Sec., Twn, Rge, Mer. (NMPM) D Sec. 14, T27N, R9W API # 30-045- 34423
14. Distance in Miles from Nearest Town 15 mile/Blanco	12. County San Juan 13. State NM
15. Distance from Proposed Location to Nearest Property or Lease Line 660'	
16. Acres in Lease	17. Acres Assigned to Well 312.13 (N/2)
18. Distance from Proposed Location to Nearest Well, Drlg, Compl, or Applied for on this Lease 236' from Marshall 1A	
19. Proposed Depth 6699'	20. Rotary or Cable Tools Rotary
21. Elevations (DF, FT, GR, Etc.) 6086' GL	22. Approx. Date Work will Start
23. Proposed Casing and Cementing Program See Operations Plan attached	
24. Authorized by: <u>Rhonda Rogers</u> Rhonda Rogers (Regulatory Technician)	9-6-07 Date

PERMIT NO. _____ APPROVAL DATE _____
APPROVED BY [Signature] TITLE ATM DATE 1/16/08

Archaeological Report attached

Threatened and Endangered Species Report attached

NOTE: This format is issued in lieu of U.S. BLM Form 3160-3

Title 18 U.S.C. Section 1001, makes it a crime for any person knowingly and willfully to make to any department or agency of the United States any false, fictitious or fraudulent statements or presentations as to any matter within its jurisdiction.

Example Master Plan Type 3

Bond Numbers NMB-000015 and NMB-000089

DRILLING OPERATIONS AUTHORIZED ARE
SUBJECT TO COMPLIANCE WITH ATTACHED
"GENERAL REQUIREMENTS".

JAN 18 2008

NMOCD

This action is subject to technical and
procedural review pursuant to 43 CFR 3165.3
and appeal pursuant to 43 CFR 3165.4

RECEIVED

SEP 06 2007

LOCATOR

1625 N. French Dr., Hobbs, NM 88240
 District II
 1301 W. Grand Avenue, Artesia, NM 88210
 District III
 1000 Rio Hondo Rd., Aztec, NM 87410
 District IV
 1220 S. St. Francis Dr., Santa Fe, NM 87505

State of New Mexico
 Energy, Minerals & Natural Resources Department
 OIL CONSERVATION DIVISION
 1220 South St. Francis Dr.
 Santa Fe, NM 87505

Form C-102

Revised October 12, 2005

Submit to Appropriate District Office

State Lease - 7 Copies

Fee Lease - 3 Copies

☐ AMENDED REPORT

WELL LOCATION AND ACREAGE DEDICATION PLAT

1 API Number 30-045-34423		2 Pool Code 71599		3 Pool Name DAKOTA	
4 Property Code 7289		5 Property Name MARSHALL			6 Well Number 1F
7 OGRID No. 14538		8 Operator Name BURLINGTON RESOURCES OIL AND GAS COMPANY			9 Elevation 6086

10 SURFACE LOCATION

UL or lot no.	Section	Township	Range	Lot Idn	Feet from the	North/South line	Feet from the	East/West line	County
D	14	27-N	9-W		660	NORTH	660	WEST	SAN JUAN

11 Bottom Hole Location If Different From Surface

UL or lot no.	Section	Township	Range	Lot Idn	Feet from the	North/South line	Feet from the	East/West line	County
D									

12 Dedicated Acres 312.13 N/2	13 Joint or Infill	14 Consolidation Code	15 Order No.
----------------------------------	--------------------	-----------------------	--------------

NO ALLOWABLE WILL BE ASSIGNED TO THIS COMPLETION UNTIL ALL INTERESTS HAVE BEEN CONSOLIDATED OR A NON-STANDARD UNIT HAS BEEN APPROVED BY THE DIVISION

16 	S 89°51'46" E 5217.5' (M) N 89°42'00" W 2687.5' (R)		17 OPERATOR CERTIFICATION I hereby certify that the information contained herein is true and complete to the best of my knowledge and belief, and that this organization either owns a working interest or unleased mineral interest in the land including the proposed bottom hole location or has a right to drill this well at this location pursuant to a contract with an owner of such a mineral or working interest, or to a voluntary pooling agreement or a compulsory pooling order heretofore entered by the division. Signature Rhonda Rogers Printed Name Regulatory Technician Title and E-mail Address 3-6-07 Date
	WELL FLAG NAD 83 LAT: 36.580711° N LONG: 107.784840° W NAD 27 LAT: 36°34.842153' N LONG: 107°45.841553' W		
	N/2 DEDICATED ACREAGE NMSF-078357 SECTION 14, T-27-N, R-9-W		
	18 SURVEYOR CERTIFICATION I hereby certify that the well location shown on this plat was plotted from field notes of actual surveys made by me or under my supervision, and that the same is true and correct to the best of my belief. Date of Survey: 7/10/07 Signature and Seal of Professional Surveyor Certificate Number: NM 11393		

Office

District I

1625 N. French Dr., Hobbs, NM 88240

District II

1301 W Grand Ave., Artesia, NM 88210

District III

1000 Rio Brazos Rd., Aztec, NM 87410

District IV

1220 S. St. Francis Dr., Santa Fe, NM 87505

Energy, Minerals and Natural Resources

OIL CONSERVATION DIVISION

1220 South St. Francis Dr.

Santa Fe, NM 87505

WELL API NO.

30-045-34423

5. Indicate Type of Lease

STATE ☐FEE ☐

6. State Oil & Gas Lease No.

Federal Lease #NMSF-078357

7. Lease Name or Unit Agreement Name

Marshall

8. Well Number

#1F

9. OGRID Number

14538

10. Pool name or Wildcat

Basin Dakota

SUNDRY NOTICES AND REPORTS ON WELLS
(DO NOT USE THIS FORM FOR PROPOSALS TO DRILL OR TO DEEPEN OR PLUG BACK TO A
DIFFERENT RESERVOIR USE "APPLICATION FOR PERMIT" (FORM C-101) FOR SUCH
PROPOSALS.)

1. Type of Well:

Oil Well ☐Gas Well ☒

Other

2. Name of Operator

BURLINGTON RESOURCES OIL & GAS COMPANY LP

3. Address of Operator

3401 E. 30TH STREET, FARMINGTON, NM 87402

4. Well Location

Unit Letter D : 660' feet from the North line and 660' feet from the West line
Section 14 Township 27N Rng 9W NMPM County San Juan

11. Elevation (Show whether DR, RKB, RT, GR, etc.)

6086'

Pit or Below-grade Tank Application

☐ or Closure ☐

Pit type

New Drill

Depth to Groundwater

>100

Distance from nearest fresh water well

>1000

Distance from nearest surface water

>200

Pit Liner Thickness:

12

mil

Below-Grade Tank:

Volume

bbls;

Construction Material

12. Check Appropriate Box to Indicate Nature of Notice, Report or Other Data

NOTICE OF INTENTION TO:

PERFORM REMEDIAL WORK ☐PLUG AND ABANDON ☐TEMPORARILY ABANDON ☐CHANGE PLANS ☐PULL OR ALTER CASING ☐MULTIPLE COMPL ☐

OTHER:

New Drill

☒

SUBSEQUENT REPORT OF:

REMEDIAL WORK ☐ALTERING CASING ☐COMMENCE DRILLING OPNS. ☐P AND A ☐CASING/CEMENT JOB ☐OTHER: ☐

13. Describe proposed or completed operations. (Clearly state all pertinent details, and give pertinent dates, including estimated date of starting any proposed work). SEE RULE 1103. For Multiple Completions: Attach wellbore diagram of proposed completion or recompletion.

New Drill, Lined:

Burlington Resources proposes to construct a new drilling pit, an associated vent/flare pit and a pre-set mud pit (if required). Based on Burlington's interpretation of the Ecosphere's risk ranking criteria, the new drilling pit and pre-set mud pit will be lined pits as detailed in Burlington's Revised Drilling / Workover Pit Construction / Operation Procedures dated November 11, 2004 on file at the NMOCD office. A portion of the vent/flare pit will be designed to manage fluids and that portion will be lined as per the risk ranking criteria. Burlington Resources anticipates closing these pits according to the Drilling / Workover Pit Closure Procedure dated August 2, 2004 on file at the NMOCD office

I hereby certify that the information above is true and complete to the best of my knowledge and belief. I further certify that any pit or below-grade tank has been/will be constructed or closed according to NMOCD guidelines ☐, a general permit ☒ or an (attached) alternative OCD-approved plan ☐.

SIGNATURE

TITLE

Regulatory Technician

DATE

9-4-07

Type or print name

Rhonda Rogers

E-mail address:

rogerrs@conocophillips.com

Telephone No.

505-599-4018

For State Use Only

APPROVED BY

TITLE

Deputy Oil & Gas Inspector,

DATE

JAN 18 2008

Conditions of Approval (if any):

District #3



TECHNICAL SERVICES
A CORROSION COMPANY

CATHODIC PROTECTION PLAN FOR NEW WELLS

WELL NAME Marshall #1F LEGALS D-14-27-9 COUNTY San Juan

PURPOSED C.P. SYSTEM: Drill GB and set solar on NE corner of the location. Trench approx 200' of #8 neg from proposed well to solar

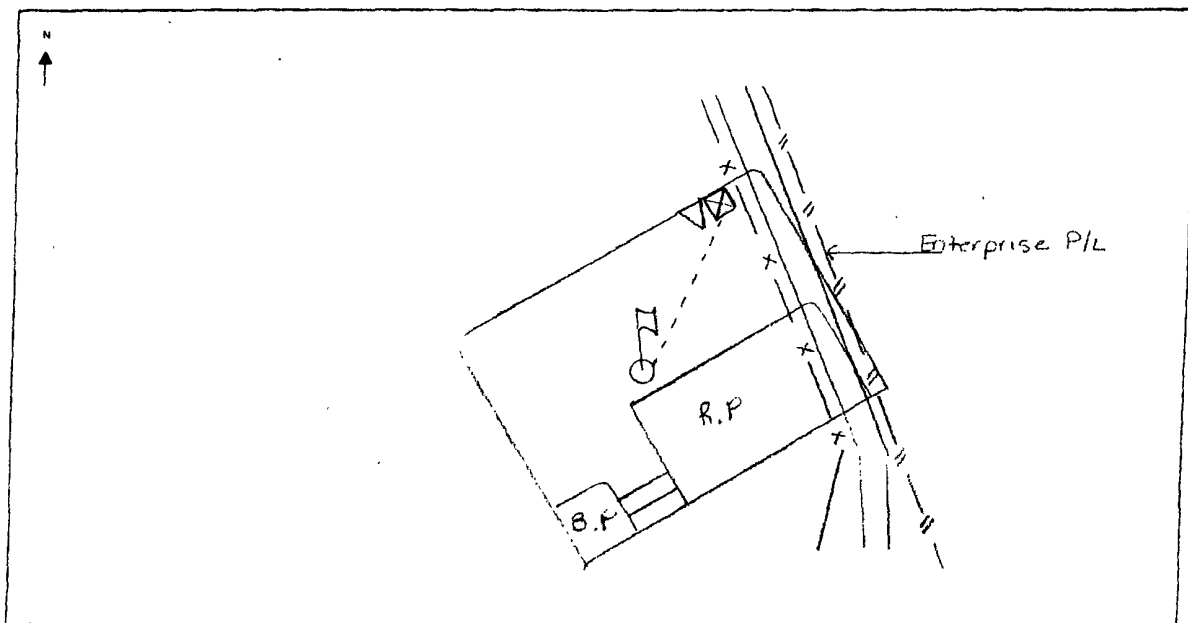

EXISTING WELLHEAD	METER HOUSE	G.B.	POWER SOURCE	CABLE	NEW WELL	OVERHEAD A.C.

COMMENTS: _____

NEAREST POWER SOURCE _____ DISTANCE: _____

PIPELINES IN AREA: Enterprise P/L

TECHNICIAN: Hedrick/Proctor DATE: 7/31/2007

6 CR 5412 BLOOMFIELD, N.M. 87413
OFFICE: 505-634-0271 CELL: 505-793-6953

PROJECT PROPOSAL - New Drill / Sidetrack

San Juan Business Unit

MARSHALL 1F

DEVELOPMENT

Lease:		AFE #: WAN.CDR.7273		AFE \$: 570,119.84	
Field Name: hBR_SAN JUAN		Rig: Bearcat Rig 4		State: NM	County: SAN JUAN
Geologist:		Phone:		Geophysicist:	
Geoscientist: Head, Chip F		Phone: 505-326-9772		Prod. Engineer:	
Res. Engineer: Prabowo, Wahyu		Phone: 505-326-9797		Proj. Field Lead:	
Primary Objective (Zones):					
Zone	Zone Name				
FRR	BASIN DAKOTA (PRORATED GAS)				
Location: Surface					
Datum Code: NAD 27		Straight Hole			
Latitude: 36.580703	Longitude: -107.764026	X:	Y:	Section: 14	Range: 009W
Footage X: 660 FWL	Footage Y: 660 FNL	Elevation: 6086	(FT)	Township: 027N	
Tolerance:					
Location Type: Year Round		Start Date (Est.): 1/1/2008		Completion Date:	
Formation Data: Assume KB = 6098		Units = FT			
Formation Call & Casing Points	Depth (TVD in Ft)	SS (Ft)	Depletion (Yes/No)	BHP (PSIG)	BHT
Surface Casing	216	5882	<input type="checkbox"/>		
OJO ALAMO	1188	4910	<input type="checkbox"/>		
KIRTLAND	1305	4793	<input type="checkbox"/>		
FRUITLAND	1839	4259	<input type="checkbox"/>		Possible Gas
PICTURED CLIFFS	2128	3970	<input type="checkbox"/>		
LEWIS	2208	3890	<input type="checkbox"/>		
HUERFANITO BENTONITE	2588	3510	<input type="checkbox"/>		
CHACRA	3012	3086	<input type="checkbox"/>		
MASSIVE CLIFF HOUSE	3641	2457	<input type="checkbox"/>	590	Gas
MENEFEE	3705	2393	<input type="checkbox"/>		
Intermediate Casing	3855	2243	<input type="checkbox"/>		
MASSIVE POINT LOOKOUT	4378	1720	<input type="checkbox"/>		
MANCOS	4738	1360	<input type="checkbox"/>		
UPPER GALLUP	5848	250	<input type="checkbox"/>		
GREENHORN	6364	-266	<input type="checkbox"/>		
GRANEROS	6417	-319	<input type="checkbox"/>		
TWO WELLS	6459	-361	<input type="checkbox"/>	1880	Gas
PAGUATE	6528	-430	<input type="checkbox"/>		
CUBERO	6587	-489	<input type="checkbox"/>		
ENCINAL	6653	-555	<input type="checkbox"/>		
TOTAL DEPTH DK	6699	-601	<input type="checkbox"/>		
12-1/4" hole. 9-5/8", 32.3 ppf, H-40, STC casing. Cement with 171 cu. ft. Circulate cement to surface.					
8-3/4" Hole. 7", 20 ppf, J-55, STC Casing. Cement with 868 cu. ft. Circulate cement to surface.					
6-1/4" Hole. 4-1/2", 10.5 ppf, J-55, STC casing. Cement with 391 cu. ft. Circulate cement a minimum of 100' inside the previous casing string.					
Reference Wells:					
Reference Type	Well Name		Comments		

PROJECT PROPOSAL - New Drill / Sidetrack

San Juan Business Unit

MARSHALL 1F

DEVELOPMENT

Logging Program:

Intermediate Logs: ☐ Log only if show ☐ GR/ILD ☐ Triple Combo

TD Logs: ☐ Triple Combo ☐ Dipmeter ☐ RFT ☐ Sonic ☐ VSP ☐ TDT ☒ Other

GR-CBL

Additional Information:

Log Type	Stage	From (Ft)	To (Ft)	Tool Type/Name	Remarks
----------	-------	-----------	---------	----------------	---------

Comments: Location/Tops/Logging - DKNM027N009W14NW2 Avoid F, twin Marshal 1A (PC ~ 900' to NW), else prefer D,E.

Zones - DKNM027N009W14NW2

MARSHALL 1F

660' FNL, 660' FWL

SECTION 14, T-27-N, R-9-W, N.M.P.M.
SAN JUAN COUNTY, NEW MEXICO

GROUND ELEV.:6086 NAVD88 DATE: JULY 10, 2007

NO NEW ACCESS



1. RESERVE PIT DIKE: TO BE 8" ABOVE DEEP SIDE (OVERFLOW-3' WIDE AND 1' ABOVE SHALLOW SIDE).
2. C.C.I. SURVEYS IS NOT LIABLE FOR UNDERGROUND UTILITIES OR PIPELINES.
CONTRACTOR SHOULD CALL ONE-CALL FOR LOCATION OF ANY MARKED OR UNMARKED BURIED
PIPELINES OR CABLES ON WELL PAD AND OR ACCESS ROAD AT LEAST TWO (2) WORKING DAYS PRIOR TO CONSTRUCTION.

BURLINGTON RESOURCES OIL AND GAS COMPANY

MARSHALL 1F

660' FNL, 660' FWL

SECTION 14, T-27-N, R-9-W, N.M.P.M.,

SANJ JUAN COUNTY, NEW MEXICO

ELEV.: 6086 NAVD88

A - A'

C/L

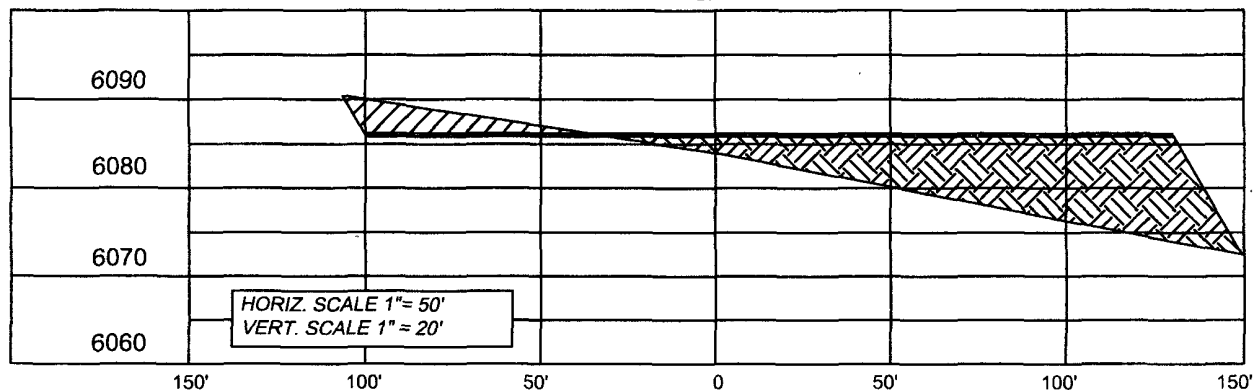

B - B'

C/L

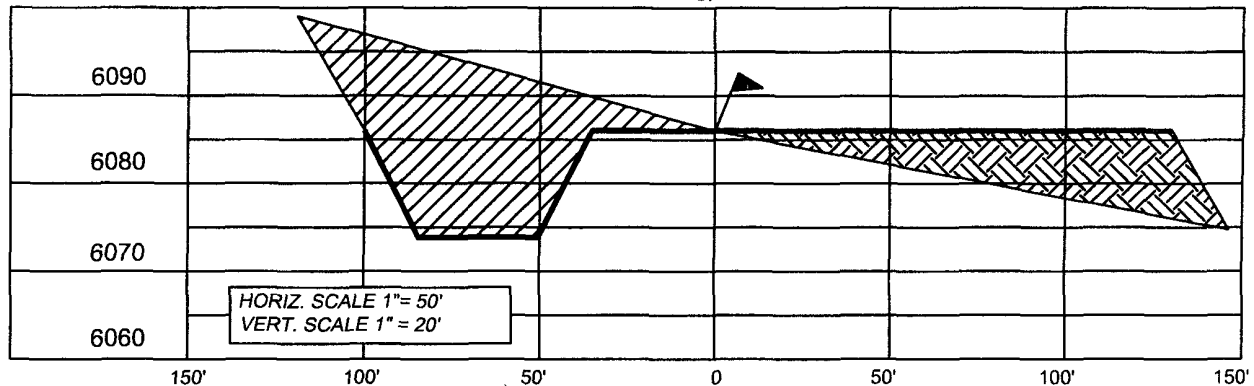

C - C'

C/L

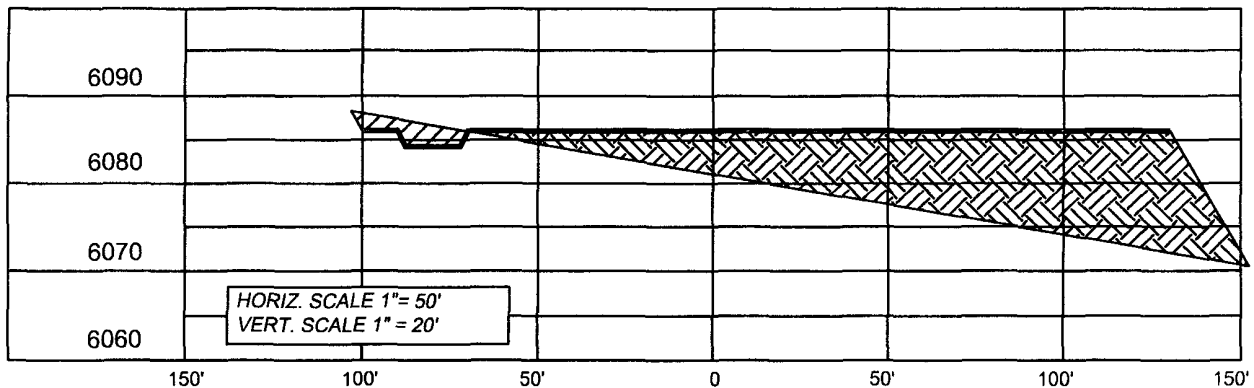

NOTE: CCI IS NOT LIABLE FOR UNDERGROUND UTILITIES OR PIPELINES.

CONTRACTOR SHOULD CALL ONE-CALL FOR LOCATION OF ANY MARKED OR UNMARKED BURIED PIPELINES OR CABLES ON WELL PAD AND OR ACCESS ROAD PRIOR TO CONSTRUCTION.

REVISIONS

NO	DESCRIPTION	REVISED BY	DATE
1	ISSUE FOR REVIEW	L.H.	7/10/07

CCI

CHENAULT CONSULTING INC.

P.O. BOX 328
BLOOMFIELD, NM, 87413
PHONE: (505) 325-7707