

(SUBMIT IN TRIPLICATE)

UNITED STATES  
DEPARTMENT OF THE INTERIOR  
GEOLOGICAL SURVEY

Indian Agency Havajo

Allottee \_\_\_\_\_

Lease No. 14-20-603-2034

Co. Loc. No. 234871

See Attached Wit

SUNDRY NOTICES AND REPORTS ON WELLS

NOTICE OF INTENTION TO DRILL	<input checked="" type="checkbox"/>	SUBSEQUENT REPORT OF WATER SHUT-OFF	
NOTICE OF INTENTION TO CHANGE PLANS		SUBSEQUENT REPORT OF SHOOTING OR ACIDIZING	
NOTICE OF INTENTION TO TEST WATER SHUT-OFF		SUBSEQUENT REPORT OF ALTERING CASING	
NOTICE OF INTENTION TO REDRILL OR REPAIR WELL		SUBSEQUENT REPORT OF REDRILLING OR REPAIR	
NOTICE OF INTENTION TO SHOOT OR ACIDIZE		SUBSEQUENT REPORT OF ABANDONMENT	
NOTICE OF INTENTION TO PULL OR ALTER CASING		SUPPLEMENTARY WELL HISTORY	
NOTICE OF INTENTION TO ABANDON WELL			

(INDICATE ABOVE BY CHECK MARK NATURE OF REPORT, NOTICE, OR OTHER DATA)

Havajo Tribe of Indians P

April 15, 1959

Well No. 10 is located 650 ft. from N line and 1980 ft. from E line of sec. 10

SW/4 NW/4 10

31-T

17-R

MTM

(1/4 Sec. and Sec. No.)

(Twp.)

(Range)

(Meridian)

Chimney Rock

San Juan

New Mexico

(Field)

(County or Subdivision)

(State or Territory)

The elevation of the derrick floor above sea level is inter ft.

DETAILS OF WORK

(State names of and expected depths to objective sands; show sizes, weights, and lengths of proposed casings; indicate mudding jobs, cementing points, and all other important proposed work)

CASING PROGRAM

CEMENT PROGRAM

CUSTOMER PROGRAM

Size	Wt.	Depth
7"	23#	35'
4"	14#	1700'

Circulate to surface.  
Sufficient volume to cement at least  
500' above pay zone.

None

Completion Method: Sand oil fracture with 20,000 gal oil and 30,000# sand.  
Ballston method of cementing to be used.  
Proposed total depth 1300' to test Gallup.

I understand that this plan of work must receive approval in writing by the Geological Survey before operations may be commenced.

Company Humble Oil & Refining Company

Address Box 1600

Midland, Texas

By [Signature]  
Title Asst. Div. Chief Clerk

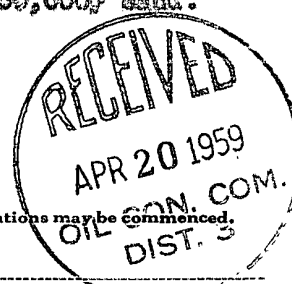

NEW MEXICO OIL CONSERVATION COMMISSION  
Well Location and Acreage Dedication Plat

Section A.

Date 4-13-59

Operator HUMBLE OIL & REFG. CO Lease Navajo Tribe of Indians "F"  
Well No. 18 Unit Letter "D" Section 10 Township 31-N Range 17-W NMPM  
Located 660 Feet From north Line, 1980 Feet From west Line  
County San Juan G. L. Elevation \_\_\_\_\_ Dedicated Acreage 40 Acres  
Name of Producing Formation Gallup Sand Pool Chimney Rock

1. Is the Operator the only owner\* in the dedicated acreage outlined on the plat below?  
Yes ☒ No ☐.
2. If the answer to question one is "no," have the interests of all the owners been consolidated by communitization agreement or otherwise? Yes ☐ No ☐. If answer is "yes," Type of Consolidation \_\_\_\_\_
3. If the answer to question two is "no," list all the owners and their respective interests below:

Owner

Land Description

Section B

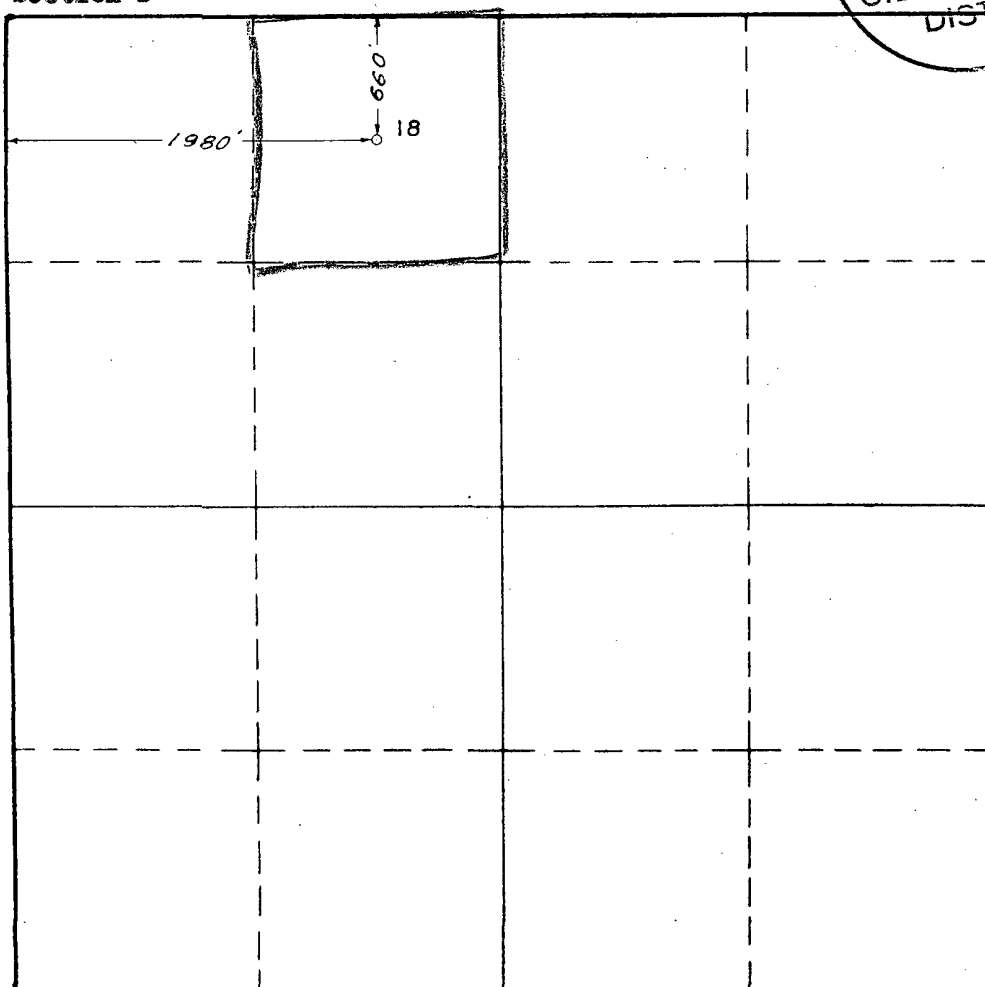
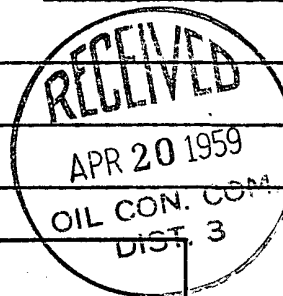

This is to certify that the information in Section A above is true and complete to the best of my knowledge and belief.

HUMBLE OIL & REFG. CO  
(Operator)

J. L. Hensley  
(Representative)  
Assistant Division Supt.  
Box 1600 Midland, Texas  
Address

This is to certify that the well location shown on the plat in Section B was plotted from field notes of actual surveys made by me or under my supervision and that the same is true and correct to the best of my knowledge and belief.

Date Surveyed April 13, 1959

W. S. Wintersfield  
Registered Professional  
Engineer and/or Land Surveyor.

0 330 660 990 1320 1650 1980 2310 2640 2000 1500 1000 500 0

Certificate No. 1382

LEASE NO. 234871

W-A - 2580