

115-30-039-06970
171-30-039-06944

DATA SHEET FOR DEEP GROUND BED CATHODIC PROTECTION WELLS
NORTHWESTERN NEW MEXICO
(Submit 3 copies to OCD Aztec Office)

Operator Union Oil Company of California Location: Unit Sec. 21 Twp 27N Rng 6W

Name of Well/Wells or Pipeline Serviced Rincon #115 PC/MV, Rincon #171 DK
and Rincon 240 FC

Elevation 6611' Completion Date 11-4-1965 Total Depth 325' Land Type* R

Casing, Sizes, Types & Depths None

If Casing is cemented, show amounts & types used None

If Cement or Bentonite Plugs have been placed, show depths & amounts used
None

Depths & thickness of water zones with description of water when possible:
Fresh, Clear, Salty, Sulphur, Etc. ?

RECEIVED

MAY 09 1990

Depths gas encountered: 400' OIL CON. DIV.

DIS. 3

Type & amount of coke breeze used: Type unknown 5620 lbs

Depths anodes placed: 64'-235'

Depths vent pipes placed: 169'

Vent pipe perforations: ?

Remarks: El Paso Natural Gas was the operator when this ground bed was installed.
First ground bed installed.

If any of the above data is unavailable, please indicate so. Copies of all logs, including Drillers Log, Water Analyses & Well Bore Schematics should be submitted when available. Unplugged abandoned wells are to be included.

*Land Type may be shown: F-Federal; I-Indian; S-State; P-Fee.
If Federal or Indian, add Lease Number.

WELL CASING
CATHODIC PROTECTION CONSTRUCTION REPORT
DAILY LOG

#15

Date 11-5-65

Well Name Rincon # 115 & 171			CPS No. 693W			
Location IW 21-27-6			Work Order No. 184-53454-50-20 184-54234-50-20			
Anode Hole Depth 325	Total Drilling Rig Time 15 Hrs.	Type & Size Bit Used 7 7/8 - 40010	No. Sacks Mud Used 1			
No. Sacks Lost Circulation Mat'l Used 0	Anode Depth #1 235	#2 239	#3 190	#4 183	#5 177	#6 171
Total Lbs. Coke Used 4620	Anode Output (Volts) #1 2.6	#2 2.7	#3 3.3	#4 3.5	#5 3.6	#6 3.7
Total Circuit Resistance Volts 11.8	Amps 11.0	Ohms 1.07	No. Ft. Surface Cable Conduit 1145'			

Drilling Log (Attach Hereto)

Remarks: Remote 1/3 600' W #115 = .72, 600' N # 171 = .65
Rectifier = Good All 30V 20A (3 NEG) Ser.# 65C6673
3/4" Hose to No. 8 Anode = 169'
4 lbs Chemical

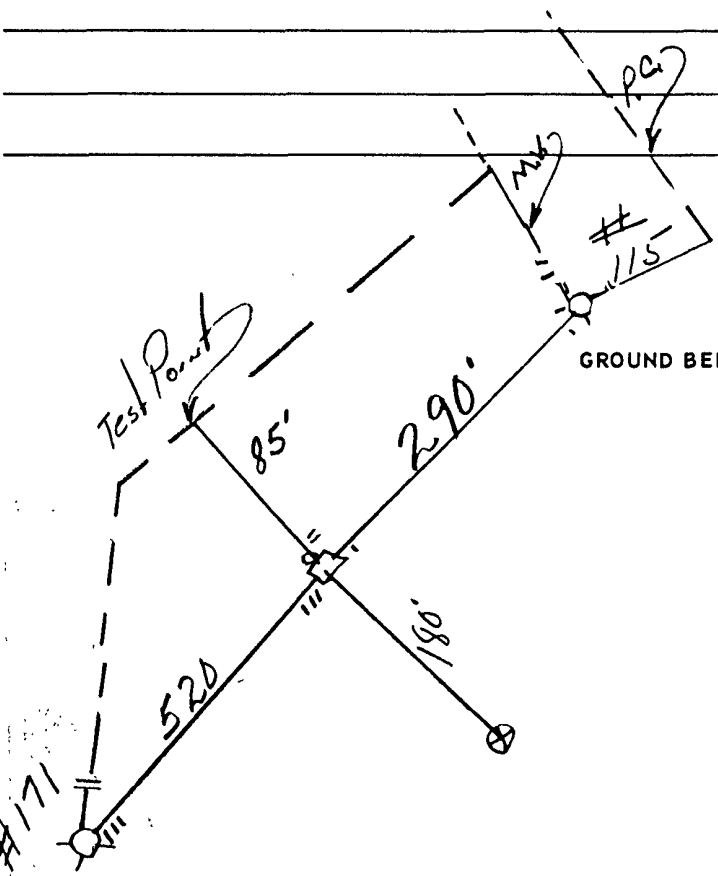

GROUND BED LAYOUT SKETCH

All Construction Completed
Farrell
(Signature)

2898' 28 WIRE

C.P.S. 693-W

LEASE WELL NO. CONTRACTOR *L. E. Wilson* RIG NO. *D-8* REPORT NO. DATE *11-3-65* 19*65*

MORNING					DAYLIGHT					EVENING				
Driller		Total Men In Crew			Driller		Total Men In Crew			Driller		Total Men In Crew		
FROM	TO	FORMATION	WT-BIT	R.P.M.	FROM	TO	FORMATION	WT-BIT	R.P.M.	FROM	TO	FORMATION	WT-BIT	R.P.M.
<i>0</i>	<i>22</i>	<i>Sandstone</i>			<i>240</i>	<i>325</i>	<i>Sandstone</i>							
<i>22</i>	<i>95</i>	<i>Shale</i>												
<i>95</i>	<i>165</i>	<i>Sandstone</i>												
<i>165</i>	<i>240</i>	<i>Sandstone & Shale</i>												

BIT NO.	NO. DC	SIZE	LENG.	BIT NO.	NO. DC	SIZE	LENG.	BIT NO.	NO. DC	SIZE	LENG.
SERIAL NO. <i>40010</i>	STANDS			SERIAL NO.	STANDS			SERIAL NO.	STANDS		
SIZE <i>7 7/8</i>	SINGLES			SIZE	SINGLES			SIZE	SINGLES		
TYPE <i>Retip</i>	DOWN ON KELLY			TYPE	DOWN ON KELLY			TYPE	DOWN ON KELLY		
MAKE	TOTAL DEPTH			MAKE	TOTAL DEPTH			MAKE	TOTAL DEPTH		

MUD RECORD			MUD, ADDITIVES USED AND RECEIVED			MUD RECORD			MUD, ADDITIVES USED AND RECEIVED			MUD RECORD			MUD, ADDITIVES USED AND RECEIVED			
Time	Wt.	Vis.	Time	Wt.	Vis.	Time	Wt.	Vis.	Time	Wt.	Vis.	Time	Wt.	Vis.	Time	Wt.	Vis.	
			<i>Total Time 15 hrs.</i>						<i>11-3-65</i>			<i>5 hrs.</i>			<i>11-4-65</i>			<i>10 hrs.</i>
																		<i>15 hrs.</i>

FROM	TO	TIME BREAKDOWN	FROM	TO	TIME BREAKDOWN	FROM	TO	TIME BREAKDOWN
		<i>1 lock mud</i>						

REMARKS - *11-3-65 left last loc. at 12:00 Moved & drilled post hole and drilled to 100ft left Rig at 5:00*

REMARKS - *11-4-65 left yard at 6:00 arrived at Rig 7:45 & drilled from 100ft. to 325ft lined hole at 5:00*

SIGNED: Toolpusher _____ Company Supervisor *Jarvels*