

RCVD APR 28 '08

OIL CONS. DIV.

DIST. 3

UNITED STATES
DEPARTMENT OF THE INTERIOR
BUREAU OF LAND MANAGEMENT

APPLICATION FOR PERMIT TO DRILL, DEEPEN, OR PLUG BACK

1a. Type of Work DRILL	RECEIVED MAR 24 2008 Bureau of Land Management Farmington Field Office	5. Lease Number USA SF-078161 Unit Reporting Number
1b. Type of Well GAS		6. If Indian, All. or Tribe
2. Operator BURLINGTON RESOURCES Oil & Gas Company, LP		7. Unit Agreement Name
3. Address & Phone No. of Operator PO Box 4289, Farmington, NM 87499 (505) 326-9700		8. Farm or Lease Name Lloyd B Com 9. Well Number #100
4. Location of Well Surf: Unit F (SENW), 1650' FNL & 2014' FWL Surf: Latitude 36.742931° N Longitude 107.944950° W		10. Field, Pool, Wildcat Basin Fruitland Coal 11. Sec., Twn, Rge, Mer. (NMPM) Sec. 12, T29N, R11W API # 30-045-34669
14. Distance in Miles from Nearest Town 4 miles/Bloomfield	12. County San Juan	13. State NM
15. Distance from Proposed Location to Nearest Property or Lease Line 1650'		
16. Acres in Lease 240.00	17. Acres Assigned to Well 320.00 (W/2)	
18. Distance from Proposed Location to Nearest Well, Drig, Compl, or Applied for on this Lease 181' from Lloyd B #4 - Chacra		
19. Proposed Depth 2277'	20. Rotary or Cable Tools Rotary	
21. Elevations (DF, FT, GR, Etc.) 5748' GR	22. Approx. Date Work will Start DRILLING OPERATIONS AUTHORIZED ARE SUBJECT TO COMPLIANCE WITH ATTACHED "GENERAL REQUIREMENTS".	
23. Proposed Casing and Cementing Program See Operations Plan attached		
24. Authorized by: <u>Crystal Walker</u> Crystal Walker (Regulatory Technician)	Date <u>3/20/08</u>	

PERMIT NO.

APPROVAL DATE

APPROVED BY

TITLE

DATE

Archaeological Report attached

Threatened and Endangered Species Report attached

NOTE: This format is issued in lieu of U.S. BLM Form 3160-3

Title 18 U.S.C. Section 1001, makes it a crime for any person knowingly and willfully to make to any department or agency of the United States any false, fictitious or fraudulent statements or presentations as to any matter within its jurisdiction.

Example Master Plan Type 2

Bond Numbers NMB-000015 and NMB-000089

HOLD ON FOR NSL

NMOCD 8

APR 29 2008

NOTIFY AZTEC OGD 24 HRS.
PRIOR TO CASING & CEMENT

DISTRICT I
1625 N. French Dr., Hobbs, N.M. 88240

DISTRICT II
1301 W. Grand Avenue, Artesia, N.M. 88210

DISTRICT III
1000 Rio Brazos Rd., Aztec, N.M. 87410

DISTRICT IV
1220 S. St. Francis Dr., Santa Fe, N.M. 87505

State of New Mexico
Energy, Minerals & Natural Resources Department

OIL CONSERVATION DIVISION
1220 South St. Francis Dr.
Santa Fe, N.M. 87505

Form C-102

Revised October 12, 2005

Submit to Appropriate District Office

State Lease - 4 Copies

Fee Lease - 3 Copies

MAR 24 2008

☐ AMENDED REPORT

WELL LOCATION AND ACREAGE DEDICATION PLAT

'API Number 30-045- 34669	'Pool Code 71629	'Pool Name BASIN (FRUITLAND COAL)
'Property Code 37140	'Property Name LLOYD B COM	'Well Number 100
'OGRID No. 14538	'Operator Name BURLINGTON RESOURCES OIL & GAS COMPANY LP.	'Elevation 5748

¹⁰ Surface Location

UL or lot no.	Section	Township	Range	Lot Idn	Feet from the	North/South line	Feet from the	East/West line	County
F	12	29 N	11 W		1650	NORTH	2014	WEST	SAN JUAN

¹¹ Bottom Hole Location If Different From Surface

UL or lot no.	Section	Township	Range	Lot Idn	Feet from the	North/South line	Feet from the	East/West line	County
F									

¹² Dedicated Acres	¹³ Joint or Infill	¹⁴ Consolidation Code	¹⁵ Order No.
320 (W/2)			

NO ALLOWABLE WILL BE ASSIGNED TO THIS COMPLETION UNTIL ALL INTERESTS HAVE BEEN CONSOLIDATED
OR A NON-STANDARD UNIT HAS BEEN APPROVED BY THE DIVISION

16 S 89°55'23" E 2635.73' USA SF-081085	2634.52' 1650'	N 89°48' E 2642.97'	17 OPERATOR CERTIFICATION I hereby certify that the information contained herein is true and complete to the best of my knowledge and belief, and that this organization either owns a working interest or unleased mineral interest in the land including the proposed bottom hole location or has a right to drill this well at this location pursuant to a contract with an owner of such a mineral or working interest, or to a voluntary pooling agreement or a compulsory pooling order heretofore entered by the division. Signature: Crystal Walker Date: 3/4/08
E 2014' N 0°21'10"	USA SF-078161	NAD 83 LAT: 36.742931° N LONG: 107.944950° W NAD 27 LAT: 36°44.5755' N LONG: 107°56.6597' W	Crystal Walker Printed Name
2640.00' USA SF-078161	FEE	SECTION 12	18 SURVEYOR CERTIFICATION I hereby certify that the well location shown on this plat was plotted from field notes of actual surveys made by me or under my supervision, and that the same is true and correct to the best of my belief. Date of Survey: 9/20/07 Signature and Seal of Professional Surveyor: [Signature] Certificate Number: 17078
N 0°11' E S 89°48' W	2633.73'	S 89°48' W 2633.73'	

Office

Energy, Minerals and Natural Resources

May 27, 2004

District I

1625 N French Dr., Hobbs, NM 88240

District II

1301 W. Grand Ave., Artesia, NM 88210

District III

1000 Rio Brazos Rd., Aztec, NM 87410

District IV

1220 S. St. Francis Dr., Santa Fe, NM 87505

OIL CONSERVATION DIVISION

1220 South St. Francis Dr.

Santa Fe, NM 87505

WELL API NO.

30-045-34669

5. Indicate Type of Lease

STATE ☐FEE ☒

6. State Oil & Gas Lease No.

SF-078161

7. Lease Name or Unit Agreement Name

Lloyd B Com

8. Well Number

#100

9. OGRID Number

14538

10. Pool name or Wildcat

Basin Fruitland Coal

SUNDRY NOTICES AND REPORTS ON WELLS

(DO NOT USE THIS FORM FOR PROPOSALS TO DRILL OR TO DEEPEN OR PLUG BACK TO A DIFFERENT RESERVOIR. USE "APPLICATION FOR PERMIT" (FORM C-101) FOR SUCH PROPOSALS.)

1. Type of Well:

Oil Well ☐Gas Well ☒

Other

2. Name of Operator

BURLINGTON RESOURCES OIL & GAS COMPANY LP

3. Address of Operator

3401 E. 30TH STREET, FARMINGTON, NM 87402

4. Well Location

Unit Letter F : 1650' feet from the North line and 2014' feet from the West line
Section 12 Township 29N Rng 11W NMPM County San Juan

11. Elevation (Show whether DR, RKB, RT, GR, etc.)

5748' GL

Pit or Below-grade Tank Application

☐ or Closure ☐Pit type New Drill

Depth to Groundwater

>100'

Distance from nearest fresh water well

>1000'

Distance from nearest surface water

<1000'

Pit Liner Thickness:

12

mil

Below-Grade Tank:

Volume

bbls;

Construction Material

12. Check Appropriate Box to Indicate Nature of Notice, Report or Other Data**NOTICE OF INTENTION TO:**PERFORM REMEDIAL WORK ☐PLUG AND ABANDON ☐TEMPORARILY ABANDON ☐CHANGE PLANS ☐PULL OR ALTER CASING ☐MULTIPLE COMPL ☐

OTHER:

New Drill Pit ☒**SUBSEQUENT REPORT OF:**REMEDIAL WORK ☐ALTERING CASING ☐COMMENCE DRILLING OPNS. ☐P AND A ☐CASING/CEMENT JOB ☐OTHER: ☐

13. Describe proposed or completed operations. (Clearly state all pertinent details, and give pertinent dates, including estimated date of starting any proposed work). SEE RULE 103. For Multiple Completions: Attach wellbore diagram of proposed completion or recompletion.

New Drill, Lined:

Burlington Resources proposes to construct a new drilling pit, an associated vent/flare pit and a pre-set mud pit (if required). Based on Burlington's interpretation of the Ecosphere's risk ranking criteria, the new drilling pit and pre-set mud pit will be lined pits as detailed in Burlington's Revised Drilling / Workover Pit Construction / Operation Procedures dated November 11, 2004 on file at the NMOCD office. A portion of the vent/flare pit will be designed to manage fluids and that portion will be lined as per the risk ranking criteria. Burlington Resources anticipates closing these pits according to the Drilling / Workover Pit Closure Procedure dated August 2, 2004 on file at the NMOCD office.

I hereby certify that the information above is true and complete to the best of my knowledge and belief. I further certify that any pit or below-grade tank has been/will be constructed or closed according to NMOCD guidelines ☐, a general permit ☒ or an (attached) alternative OCD-approved plan ☐.

SIGNATURE

TITLE

Regulatory Specialist

DATE

1/8/2008

Type or print name

Patsy Clugston

E-mail address: clugspl@conocophillips.com

Telephone No. 505-326-9518

For State Use Only

APPROVED BY

TITLE

Deputy Oil & Gas Inspector,
District #3

DATE

APR 29 2008

Conditions of Approval (if any):



NEW MEXICO
STATE ENGINEER'S OFFICE

CATHODIC PROTECTION PLAN FOR NEW WELLS

WELL NAME Lloyd B. Carr #100 LEGALS 6-17-89.11 COUNTY San Juan

PURPOSED C.P. SYSTEM: Drill CB and set sacrificial anode on NW 1/4 of Section 16, Township 36N, Range 12E, Meridian 10E, New Mexico. Considered to be in the same well as Carr #100.

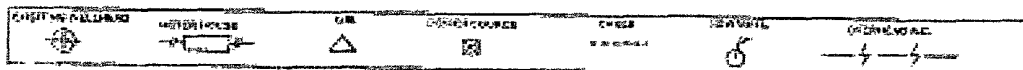
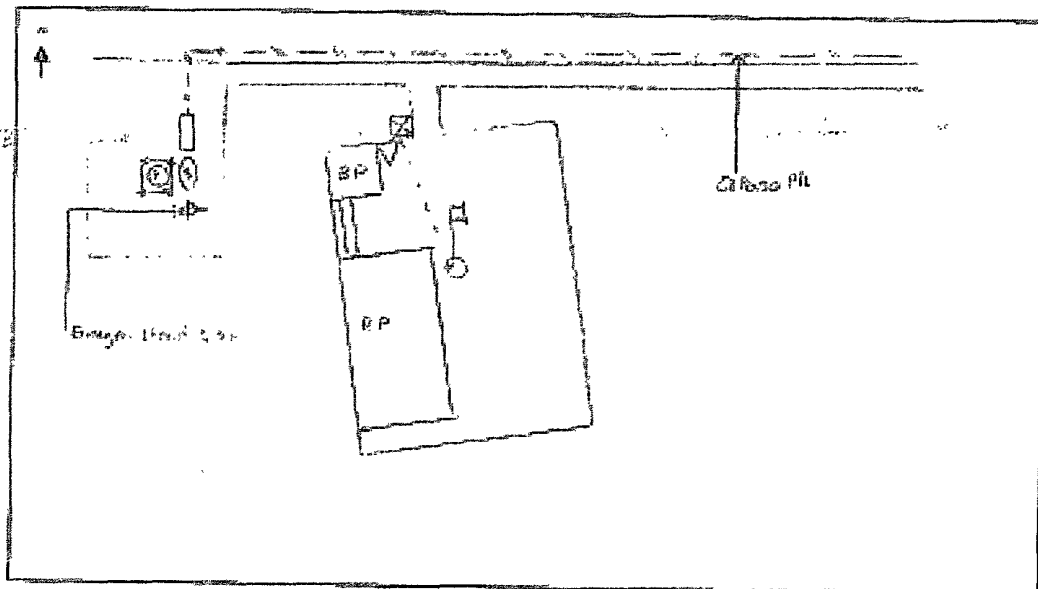

COMMENTS:

NEAREST POWER SOURCE N/A DISTANCE: _____
PIPELINES IN AREA: 10' from BP

TECHNICIAN: Mike H. Hargrave DATE: 10/30/01

6 CR 6412 BLOOMFIELD, N.M. 87413
OFFICE: 505-634-0271 CELL: 505-793-6853

LS

PROJECT PROPOSAL - New Drill / Sidetrack

LLOYD B COM 100

DEVELOPMENT

Lease:		AFE #: WAN.CDR.7360		AFE \$: 191,791.86	
Field Name: hBR_SAN JUAN		Rig: Aztec Rig 580		State: NM	County: SAN JUAN
Geologist:		Phone:		Geophysicist:	
Geoscientist: Clark, Dave D		Phone: 505-326-9762		Prod. Engineer:	
Res. Engineer:		Phone:		Proj. Field Lead:	
				Phone:	

Primary Objective (Zones):

Zone	Zone Name
JCV	BASIN FRUITLAND COAL (GAS)

Location: Datum Code: NAD 27

Latitude: 36.742926	Longitude: -107.944328	X:	Y:	Section: 12	Range: 011W
Footage X: 2014 FWL	Footage Y: 1650 FNL	Elevation: 5748	(FT)	Township: 029N	

Tolerance:

Location Type: Year Round Start Date (Est.): 1/1/2008 Completion Date: Date In Operation:

Formation Data: Assume KB = 5760 Units = FT

Formation Call & Casing Points	Depth (TVD in Ft)	SS (Ft)	Depletion (Yes/No)	BHP (PSIG)	BHT	Remarks
Surface Casing	120	5640	<input type="checkbox"/>			8-3/4 hole. 7" 20 ppf, J-55 STC csg. Cement with 50 cuft. Circulate cement to surface.
OJO ALAMO	796	4964	<input type="checkbox"/>			
KIRTLAND	907	4853	<input type="checkbox"/>			
FRUITLAND	1763	3997	<input type="checkbox"/>	300		Gas
FRUITLAND COAL	1882	3878	<input type="checkbox"/>			
PICTURED CLIFFS	2077	3683	<input type="checkbox"/>			Gas
Total Depth	2277	3483	<input type="checkbox"/>			6-1/4" hole. 4-1/2" 10.5 ppf, J-55, STC casing. Cement with 350 cuft. Circulate cement to surface.

Reference Wells:

Reference Type	Well Name	Comments
----------------	-----------	----------

Logging Program:

Intermediate Logs: ☐ Log only if show ☐ GR/ILD ☐ Triple Combo

TD Logs: ☐ Triple Combo ☐ Dipmeter ☐ RFT ☐ Sonic ☐ VSP ☐ TDT ☒ Other
GR_CBL

Additional Information:

Log Type	Stage	From (Ft)	To (Ft)	Tool Type/Name	Remarks
----------	-------	-----------	---------	----------------	---------

Comments:

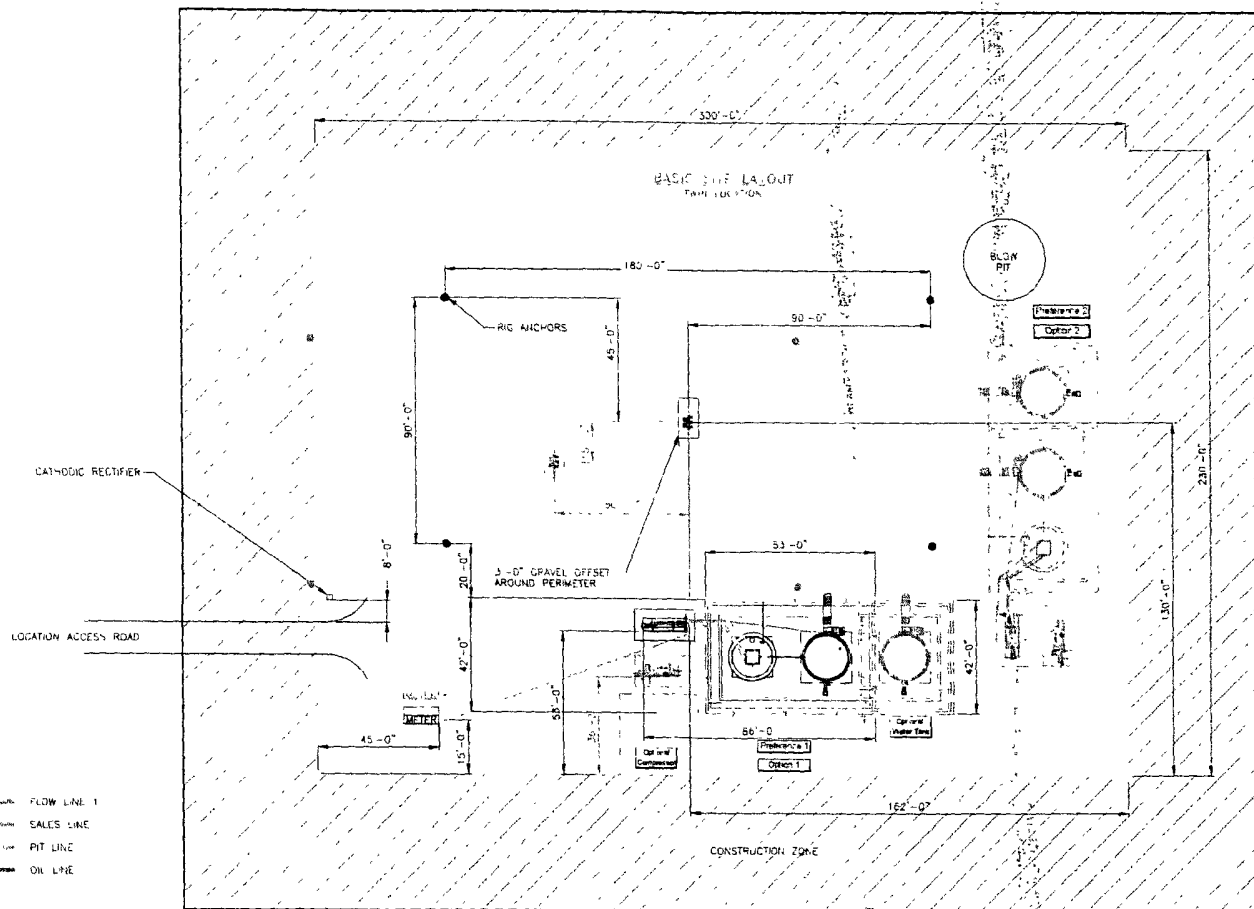

SHEET 1 OF 5

ENGINEERING REVIEW										REFERENCE DRAWINGS		CONOCOPHILLIPS			
DISCIPLINE										NO.		HIGH PRESSURE 3 PHASE			
REVIEWED										DESCRIPTION		FACILITY DIAGRAM - SITE LAYOUT			
DATE															

BURLINGTON RESOURCES OIL & GAS COMPANY LP.
LLOYD B COM 100 - 1650' FNL & 2014' FWL
SECTION 12, T-29-N, R-11-W, N.M.P.M., SAN JUAN COUNTY, N.M.
GROUND ELEVATION: 5748 - DATE: SEPTEMBER 20, 2007

PAD CONST. SPECS.

1. RAMP INTO PIT CONSTRUCTED FROM PAD GRADE INTO FLARE AREA AT 5% SLOPE
2. APPROXIMATE 13x75' PIT AREA LINED WITH 12 MIL POLYLINER
3. RESERVE PIT DIKE TO BE 8' ABOVE DEEP SIDE (OVERFLOW - 3' WIDE AND 1' ABOVE SHALLOW SIDE)
4. EDGE OF TEMPORARY CONSTRUCTION DEFINED IN FIELD W/G T-POST

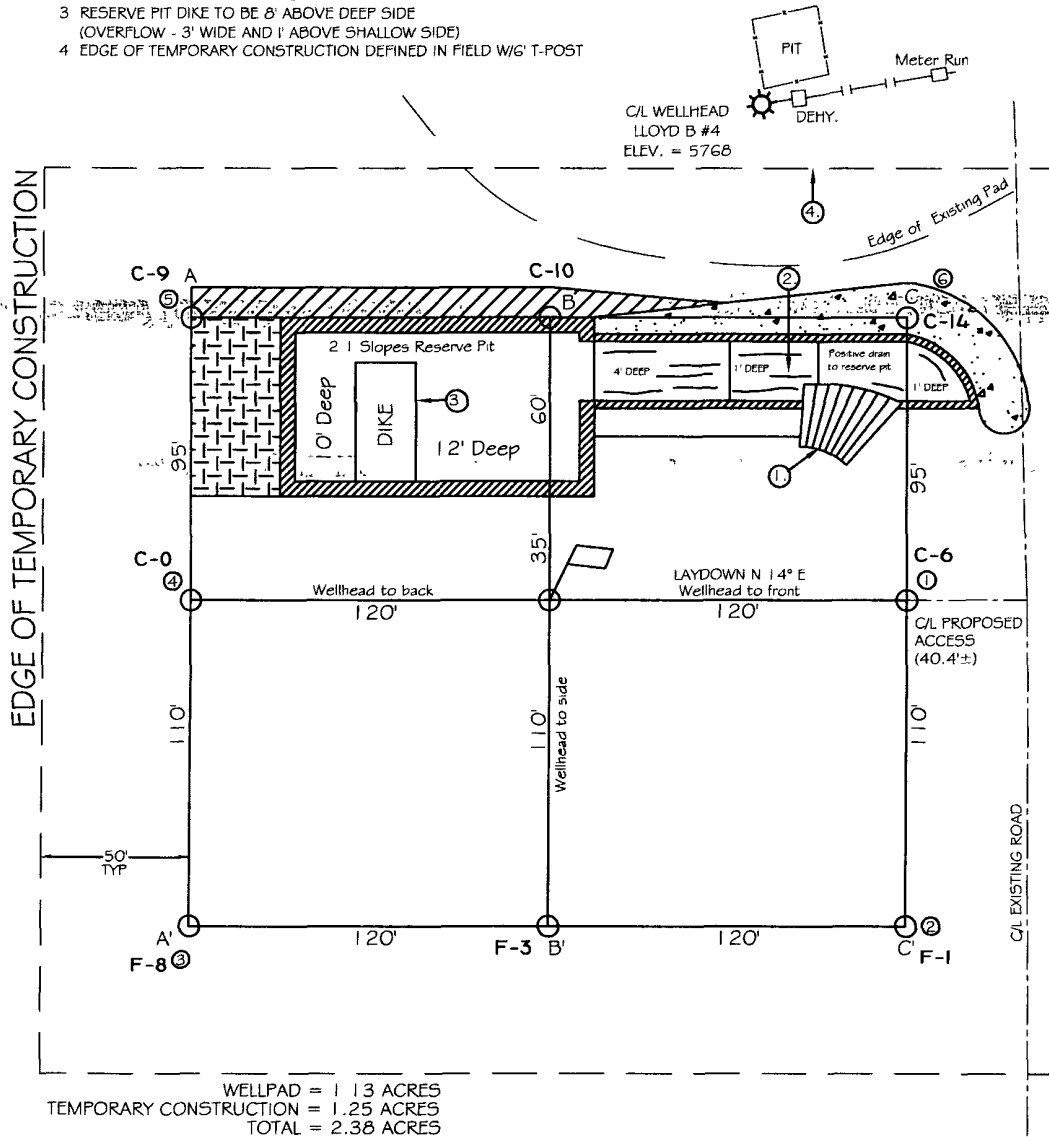

LATITUDE: 36°44.5755' N LONGITUDE: 107°56.6597' W NAD 27

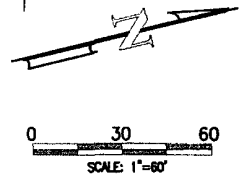

NOTES:

- 1.) CONTRACTOR SHOULD CALL "ONE-CALL" FOR LOCATION OF ANY MARKED OR UNMARKED BURIED PIPELINES OR CABLES ON WELLPAD AND OR ACCESS ROAD AT LEAST TWO (2) WORKING DAYS PRIOR TO CONST.
- 2.) UNITED FIELD SERVICES, INC IS NOT LIABLE FOR UNDERGROUND UTILITIES OR PIPELINES.

SURVEYED: 9/20/07

REV. DATE:

APP. BY M.W.L.

DRAWN BY: H.S.

DATE DRAWN: 10/8/07

FILE NAME: 7934L01



P.O. BOX 3651
 FARMINGTON, NM 87499
 OFFICE: (505)334-0408

BURLINGTON RESOURCES OIL & GAS COMPANY LP.
 LLOYD B COM 100 - 1650' FNL & 2014' FWL
 SECTION 12, T-29-N, R-11-W, N.M.P.M., SAN JUAN COUNTY, N.M.
 GROUND ELEVATION: 5748 - DATE: SEPTEMBER 20, 2007

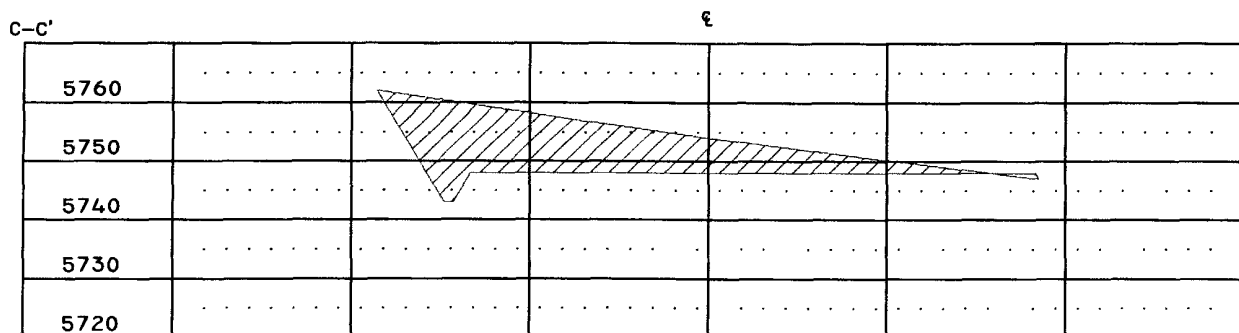
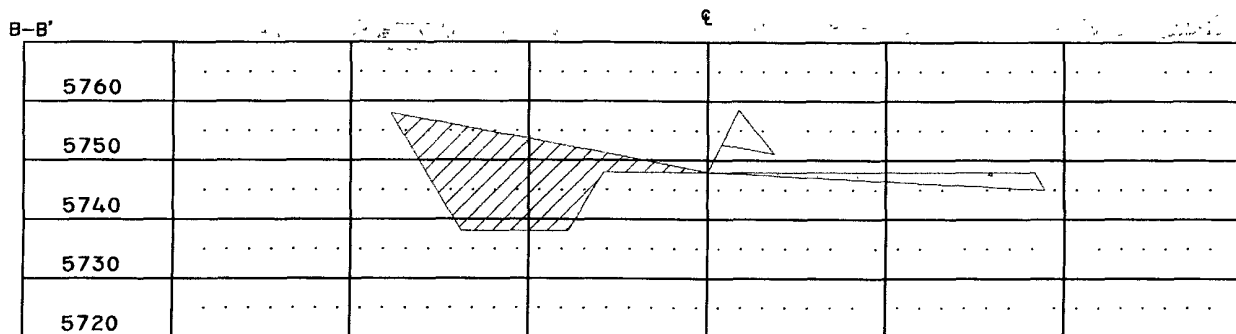
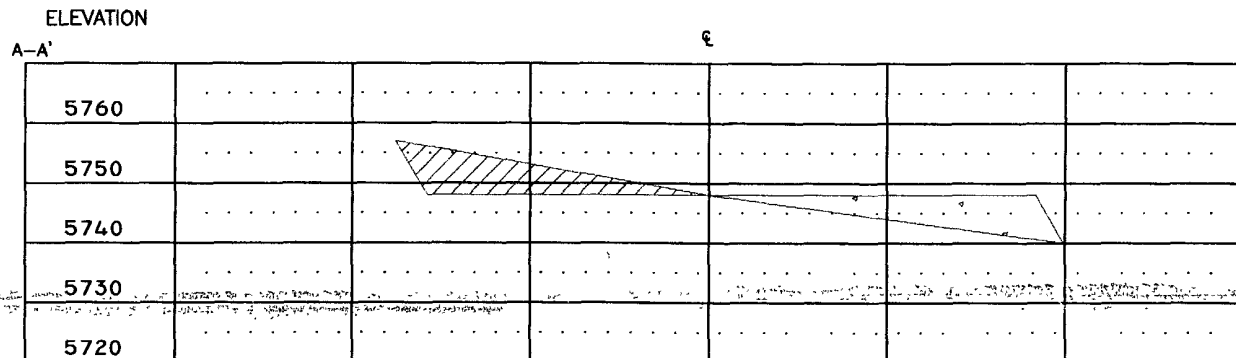

1" = 60' - HORIZ.
 1" = 30' - VERT.

NOTES:

- 1.) CONTRACTOR SHOULD CALL "ONE-CALL" FOR LOCATION OF ANY MARKED OR UNMARKED BURIED PIPELINES OR CABLES ON WELLPAD AND OR ACCESS ROAD AT LEAST TWO (2) WORKING DAYS PRIOR TO CONST.
- 2.) UNITED FIELD SERVICES, INC. IS NOT LIABLE FOR UNDERGROUND UTILITIES OR PIPELINES

SURVEYED: 9/20/07

REV. DATE:

APP. BY M.W.L.

DRAWN BY: H.S.

DATE DRAWN: 10/8/07

FILE NAME: 7934C01



P.O. BOX 3651
 FARMINGTON, NM 87499
 OFFICE: (505)334-0408