

1129

#50 30-039-06996 ^E

#138 30-039-20463

DATA SHEET FOR DEEP GROUND BED CATHODIC PROTECTION WELLS
NORTHWESTERN NEW MEXICO
(Submit 3 copies to OCD Aztec Office)

Operator MERIDIAN OIL Location: Unit NE Sec. 19 Twp 27 Rng 5

Name of Well/Wells or Pipeline Serviced SAN JUAN 27-5 UNIT #50, #138

cps 1752w

Elevation 6412' Completion Date 11/1/84 Total Depth 360' Land Type* N/A

Casing, Sizes, Types & Depths N/A

If Casing is cemented, show amounts & types used N/A

If Cement or Bentonite Plugs have been placed, show depths & amounts used
N/A

Depths & thickness of water zones with description of water when possible:
Fresh, Clear, Salty, Sulphur, Etc. 80', 120', 180'

Depths gas encountered: N/A

Type & amount of coke breeze used: 4450 lbs.

Depths anodes placed: 315', 295', 255', 245', 235', 225', 205', 190', 135', 125'

Depths vent pipes placed: 348'

Vent pipe perforations: 280'

Remarks: g5 #1

RECEIVED
R
MAY 31 1991
OIL CON. DIV.
DIST. 3

If any of the above data is unavailable, please indicate so. Copies of all logs, including Drillers Log, Water Analyses & Well Bore Schematics should be submitted when available. Unplugged abandoned wells are to be included.

*Land Type may be shown: F-Federal; I-Indian; S-State; P-Fee.
If Federal or Indian, add Lease Number.

WELL CASING
CATHODIC PROTECTION CONSTRUCTION REPORT
DAILY LOG

Drilling Log (Attach Hereto)

Completion Date 11/1/84

CPS #	Well Name, Line or Plant	Work Order #	Static	Ins	Union Check				
1752 W	S.J. 27-5 #50	53956-19-50-20	.77V	<input checked="" type="checkbox"/>	Good <input type="checkbox"/> Bad				
	S.J. 27-5 #138	54974-19-50-20	.73V						
Location NE 19-27-5		Anode Size 2' x 60"	Anode Type DUPON	Size Bit 6 3/4"					
Depth Drilled 360'	Depth Logged 348'	Drilling Rig Time	Total Lbs. Coke Used Supplied 4450 LB	Lost Circulation Mat'l Used	No Sacks Mud Used				
Anode Depth									
# 1 315	# 2 295	# 3 255	# 4 245	# 5 235	# 6 225	# 7 205	# 8 190	# 9 135	# 10 125
Anode Output (Amps)									
# 1 3.1	# 2 2.8	# 3 3.4	# 4 2.8	# 5 3.2	# 6 3.0	# 7 3.4	# 8 3.0	# 9 3.3	# 10 4.2
Anode Depth									
# 11	# 12	# 13	# 14	# 15	# 16	# 17	# 18	# 19	# 20
Anode Output (Amps)									
# 11	# 12	# 13	# 14	# 15	# 16	# 17	# 18	# 19	# 20
Total Circuit Resistance			No. 8 C.P. Cable Used			No. 2 C.P. Cable Used			
Volts 12.0	Amps 17.6	Ohms .68							

Remarks: Drilled To 80' Hit moisture. Two days later could not blow water out of the hole. Started 1M. Drilled To 120'. Blew hole dry and weighted 10 min. Blew 5 to 10 gal. of water out of the hole. Est. hole to be making 1-2 gal./min. Drilled To 360'. Hit more water at 180'. Approx 30 gal./min. Logged 348'. Water standing at 120' when we came out of the hole. Installed 348' of 1" P.V.C. vent pipe Perforated 280'.

Rectifier Size: 60 V 30 A ✓
 Addn'l Depth: _____
 Depth Credit: 152 ✓
 Extra Cable: 224' ✓
 Ditch & 1 Cable: 488' ✓
 25' Meter Pole: 1 ✓
 20' Meter Pole: _____
 10' Stub Pole: _____

All Construction Completed

J.E. Stottle
(Signature)

GROUND BED LAYOUT SKETCH

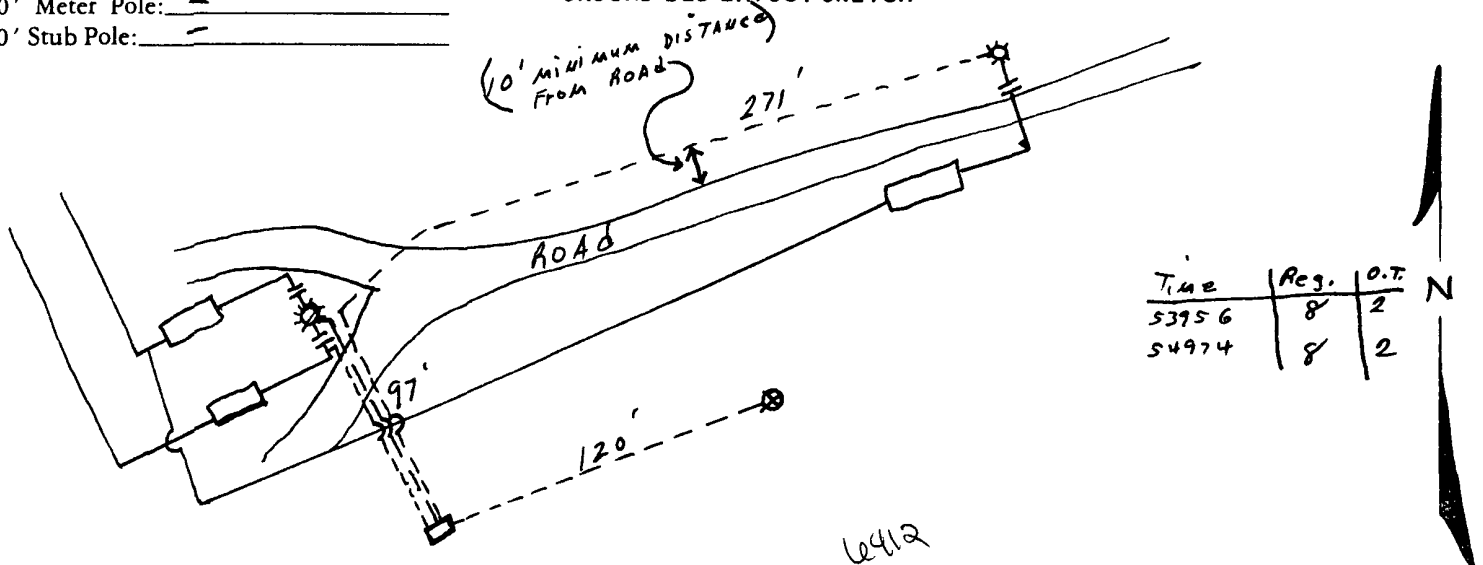

Time	Reg.	O.T.
53956	8	2
54974	8	2

CONSTRUCTION LOGGING READINGS

CPS #: 1752 W WELL NAME: S.J. 27-5 * 50 LOCATION: NE19-27-5 DATE: 11/1/84

TOTAL VOLTS: 12.0 TOTAL AMPS: 17.6 OHMS RESISTANCE: 68

												ANODE READINGS			
DEEP	LOG ANODE	ANODE NO.	DEEP	LOG ANODE	ANODE NO.	DEEP	LOG ANODE	ANODE No.	DEEP	LOG ANODE	ANODE No.	NO.	DEPTH	NO COKE	WITH COKE
5			185	1.1		365			545			1	315	2.0	3.1
10			190	1.3	8	370			550			2	295	1.5	2.8
15			195	1.2		375			555			3	255	1.7	3.4
20			200	1.2		380			560			4	245	1.4	2.8
25			205	1.5	7	385			565			5	235	1.7	3.2
30			210	1.3		390			570			6	225	1.6	3.0
35			215	.6		395			575			7	205	1.9	3.4
40			220	.4		400			580			8	190	1.6	3.0
45			225	1.2	6	405			585			9	135	2.1	3.3
50			230	1.3		410			590			10	125	2.6	4.2
55			235	1.4	5	415			595						
60			240	1.0		420			600						
65			245	1.2	4	425			605						
70			250	1.3		430			610						
75			255	1.2	3	435			615						
80			260	1.0		440			620						
85			265	.9		445			625						
90			270	.8		450			630						
95			275	.7		455			635						
100			280	.6		460			640						
105			285	.6		465			645						
110			290	.7		470			650						
115			295	1.3	2	475			655						
120	1.5		300	.9		480			660						
125	1.7	10	305	.8		485			665						
130	1.6		310	1.2		490			670						
135	1.4	9	315	1.5	1	495			675						
140	1.3		320	.3		500			680						
145	1.1		325	.2		505			685						
150	1.1		330	.2		510			690						
155	1.2		335	.2		515			695						
160	1.1		340	.2		520			700						
165	.4		345	3.48	T.D.	525			705						
170	.2		350			530			710						
175	.8		355			535			715						
180	1.2		360			540			720						

REMARKS: Drilled to 80' HIT moisture. Two days later, could not blow water out of the hole. Started INS. Drilled to 120'. Blew hole dry and weighted 10 min. Blew 5 to 10 gal of water out of the hole. EST. H2O TO BE MAKING 1-2 gal/min. Drilled to 360' HIT more water AT 160' approx 30 gal/min. Logged 3.48' WATER AT 120' when we came out of the hole. Installed 3.48' of 1" P.V.C. VENT PIPE PERFORATED 280'.

1952 W CR

LEASE: 1952 W CR WELL NO: CONTRACTOR: Anderson Control RIG NO: 41 REPORTING NO: DATE: 11-1-84 19

MORNING				DAYLIGHT				EVENING						
Driller		Total Mch In Core		Driller		Total Mch In Core		Driller		Total Mch In Core				
FROM	TO	FORMATION	WT-BIT	R.P.M.	FROM	TO	FORMATION	WT-BIT	R.P.M.	FROM	TO	FORMATION	WT-BIT	R.P.M.
0	30	Clay - sandstone, sand			160	175	sand - water 50 gpm			260	270	sandstone		
30	110	shale 1-2 gpm			175	210	shale			270	305	shale - sand		
110	120	shale			210	280	sand - water			305	315	shale - sand		
120	160	shale - bentonite			280	260	shale - bentonite			315	360	sand - bentonite		
NO. DC SIZE LENG.			NO. DC SIZE LENG.			NO. DC SIZE LENG.			NO. DC SIZE LENG.			NO. DC SIZE LENG.		
BIT NO. SIZE LENG. 20'			BIT NO. SIZE LENG.			BIT NO. SIZE LENG.			BIT NO. SIZE LENG.			BIT NO. SIZE LENG.		
SE. NO. STANDS			SE. NO. STANDS			SE. NO. STANDS			SE. NO. STANDS			SE. NO. STANDS		
SIZE SINGLES 18			SIZE SINGLES			SIZE SINGLES			SIZE SINGLES			SIZE SINGLES		
TYPE DOWN ON KELLY			TYPE DOWN ON KELLY			TYPE DOWN ON KELLY			TYPE DOWN ON KELLY			TYPE DOWN ON KELLY		
MAKE <u>De Ruur</u>			MAKE			MAKE			MAKE			MAKE		
TOTAL DEPTH 360'			TOTAL DEPTH			TOTAL DEPTH			TOTAL DEPTH			TOTAL DEPTH		
MUD RECORD			MUD RECORD			MUD RECORD			MUD RECORD			MUD RECORD		
MUD, ADDITIVES USED AND RECEIVED			MUD, ADDITIVES USED AND RECEIVED			MUD, ADDITIVES USED AND RECEIVED			MUD, ADDITIVES USED AND RECEIVED			MUD, ADDITIVES USED AND RECEIVED		
Time	WT.	VIS.	Time	WT.	VIS.	Time	WT.	VIS.	Time	WT.	VIS.	Time	WT.	VIS.
FROM	TO	TIME BREAKDOWN	FROM	TO	TIME BREAKDOWN	FROM	TO	TIME BREAKDOWN	FROM	TO	TIME BREAKDOWN	FROM	TO	TIME BREAKDOWN

REMARKS - To wet to drill watered at 80' 2 days now drill down out around water for 1 day per drilled to 120' depth was the hole, out 10 gallons, all mud water at 120' 30 gpm Apply. Come out of hole at 120' turn then depth by still at 120' total depth 360' Log depth 348'

SIGNED: Toolpusher Brian S. Swager

Company Supervisor