

UNITED STATES  
DEPARTMENT OF THE INTERIOR  
BUREAU OF LAND MANAGEMENT

APPLICATION FOR PERMIT TO DRILL OR REENTER

FORM APPROVED  
OMB No 1004-0136  
Expires January 31, 2004

5 Lease Serial No  
Jicarilla Apache Contract #92  
6 If Indian, Allottee or Tribe Name  
Jicarilla Apache Nation  
7 If Unit or CA Agreement, Name and No

RECEIVED  
JUL 15 2008

1a Type of Work ☒ DRILL ☐ REENTER

1b Type of Well. ☐ Oil Well ☒ Gas Well ☐ Other ☒ Single Zone ☐ Multiple Zone

2 Name of Operator

Williams Production Company, LLC

3a. Address

P.O. Box 640 Aztec, NM 87410

3b Phone No (include area code)

(505) 634-4208

4 Location of Well (Report location clearly and in accordance with any State requirements \*)

At surface 990' FNL & 920' FEL

At proposed prod zone same

8 Lease Name and Well No  
Jicarilla 92 #17A

9 API Well No

30-039-29918

10 Field and Pool, or Exploratory

Blanco MV

11. Sec, T., R., M., or Blk and Survey or Area

A Section 31, T27N R3W

12 County or Parish

Rio Arriba

13. State

NM

14 Distance in miles and direction from nearest town or post office\*

16 miles from Lindrith, NM

15 Distance from proposed\*

location to nearest  
property or lease line, ft  
(Also to nearest drg unit line, if any) 920'

16 No. of Acres in lease

320

17 Spacing Unit dedicated to this well

320 (E/2)

18 Distance from proposed location\*  
to nearest well, drilling, completed,  
applied for, on this lease, ft

672'

19. Proposed Depth

6,527'

20 BLM/BIA Bond No on file

B001576

21 Elevations (Show whether DF, KDB, RT, GL, etc)

7,138' GR

22 Approximate date work will start\*

August 1, 2005

23 Estimated duration

1 month

24. Attachments

The following, completed in accordance with the requirements of Onshore Oil and Gas Order No 1, shall be attached to this form

1. Well plat certified by a registered surveyor.

2. A Drilling Plan

3. A Surface Use Plan (if the location is on National Forest System Lands, the  
SUPO shall be filed with the appropriate Forest Service Office)

4. Bond to cover the operations unless covered by an existing bond on file (see  
Item 20 above)

5. Operator certification

6. Such other site specific information and/or plans as may be required by the  
authorized officer

25 Signature

Name (Printed/Typed)

Date

Title

Larry Higgins

5-15-06

Drilling COM

Approved by (Signature)

Name (Printed/Typed)

Date

Title

Office

7/14/08

Application approval does not warrant or certify that the applicant holds legal or equitable title to those rights in the subject lease which would entitle the applicant to conduct  
operations thereon.

Conditions of approval, if any, are attached

Title 18 U S C Section 1001 and Title 43 U S C Section 1212, make it a crime for any person knowingly and willfully to make to any department or agency of the United  
States any false, fictitious or fraudulent statements or representations as to any matter within its jurisdiction

\*(Instructions on reverse)

Williams Production Company, LLC, proposes to drill a vertical well to develop the Blanco Mesa Verde formation at the above described location in  
accordance with the attached drilling and surface use plans

The surface is located on Jicarilla Apache Nation lands.

This location has been archaeologically surveyed by Velarde Energy

A 156 5 foot pipeline tie would be required for this location and it is also located on Jicarilla Apache Nation Land

800' of new access road will be needed to access this well.

NOTIFY AZTEC OCD  
PRIOR TO CASING & CEMENT

A COMPLETE C-144 MUST BE SUBMITTED TO AND  
APPROVED BY THE NMOC FOR: A PIT, CLOSED  
LOOP SYSTEM, BELOW GRADE TANK, OR  
PROPOSED ALTERNATIVE METHOD, PURSUANT TO  
NMOC PART 19.15.17, PRIOR TO THE USE OR  
CONSTRUCTION OF THE ABOVE APPLICATIONS.

This action is subject to technical and  
procedural review pursuant to 43 CFR 3165.3  
and appeal pursuant to 43 CFR 3165.4

DRILLING OPERATIONS AUTHORIZED ARE  
SUBJECT TO COMPLIANCE WITH ATTACHED  
"GENERAL REQUIREMENTS".

JUL 17 2008

NMOC

District II  
PO Drawer DD, Artesia, NM 88211-0719

District III  
1000 Rio Brazos Rd., Aztec, NM 87410

District IV  
PO Box 2088, Santa Fe, NM 87504-2088

## OIL CONSERVATION DIVISION

PO Box 2088  
Santa Fe, NM, 87504-2088

Submit to Appropriate District Office  
State Lease - 4 Copies  
Fee Lease - 3 Copies

☐ AMENDED REPORT

RECEIVED  
FARMINGTON NM

WELL LOCATION AND ACREAGE DEDICATION PLAT

'API Number'	'Pool Code'	'Pool Name'
30-039-29918	72319	BLANCO MESAVERDE
'Property Code'	'Property Name'	'Well Number'
17028	JICARILLA 92	17A
'OGRID No.'	'Operator Name'	'Elevation'
120782	WILLIAMS PRODUCTION COMPANY	7138'

<sup>10</sup> Surface Location

UL or lot no.	Section	Township	Range	Lot Idn	Feet from the	North/South line	Feet from the	East/West line	County
A	31	27N	3W		990	NORTH	920	EAST	RIO ARriba

<sup>11</sup>Bottom Hole Location If Different From Surface

UL or lot no.	Section	Township	Range	Lot Idn	Feet from the	North/South line	Feet from the	East/West line	County
---------------	---------	----------	-------	---------	---------------	------------------	---------------	----------------	--------

<sup>12</sup> Dedicated Acres	<sup>13</sup> Joint or Infill	<sup>14</sup> Consolidation Code	<sup>15</sup> Order No.
320.0 Acres - (E/2)			

NO ALLOWABLE WILL BE ASSIGNED TO THIS COMPLETION UNTIL ALL INTERESTS HAVE BEEN CONSOLIDATED OR A NON-STANDARD UNIT HAS BEEN APPROVED BY THE DIVISION

16

The map shows Section 31, which is divided into four lots. The dimensions for each lot are as follows:

Lot	Width (Feet)	Depth (Feet)
LOT 1	1037.52'	2649.90'
LOT 2	1320.00'	2640.00'
LOT 3	1020.36'	2640.00'
LOT 4	1320.00'	2640.00'

Additional features and measurements include:

- A north arrow pointing towards the top right of the map.
- A scale bar indicating 120 feet.
- The text "Jicarilla Contract #92" is located in the center of the section.
- The section number "31" is prominently displayed in the center.
- The total width of the section is 2640.00'.
- The total depth of the section is 10280.00'.

17 OPERATOR CERTIFICATION

I hereby certify that the information  
contained herein is true and complete  
to the best of my knowledge and belief

Signature Larry Hagg

LARRY HIGGINS  
Printed Name

Drilling Company  
Title

5-15-06

Date \_\_\_\_\_

<sup>18</sup> SURVEYOR CERTIFICATION

I hereby certify that the well location shown on this plat was plotted from field notes of actual surveys made by me or under my supervision, and that the same is true and correct to the best of my belief.

Date of Survey: MARCH 14, 2005

Signature and Seal of Professional Surveyor



JASON C. EDWARDS  
Certificate Number 15269



## WILLIAMS PRODUCTION COMPANY

### Operations Plan

*(Note: This procedure will be adjusted on site based upon actual conditions)*

**DATE:** 5/10/2006 **FIELD:** Blanco MV  
**WELL NAME:** Jicarilla 92 #17A **SURFACE:** BOIA  
**BH LOCATION:** NENE Sec 31-27N-3W **MINERALS:** Jicarilla #92  
Rio Arriba, NM  
**ELEVATION:** 7,138' GR **LEASE #** Jicarilla #92  
**MEASURED DEPTH:** 6,527'

**I. GEOLOGY:** Surface formation - San Jose

**A. FORMATION TOPS:** ( KB)

Name	MD	Name	MD
Ojo Alamo	3,392	Cliff House	5,617
Kirtland	3,592	Menefee	5,737
Fruitland	3,682	Point Lookout	6,052
Picture Cliffs	3,917	Mancos	6,407
Lewis	4,142	TD	6,527

**B. MUD LOGGING PROGRAM:** none

**C. LOGGING PROGRAM:** High Resolution Induction/ GR and Density/ Neutron log from intermediate shoe to TD. Onsite geologist will pick Density/ Neutron log intervals on both logging runs.

**D. NATURAL GAUGES:** Gauge any noticeable increases in gas flow. Record all gauges in Tour book and on morning reports.

## **II. DRILLING:**

**A. MUD PROGRAM:** Clear water with benex to 7" casing point. Convert to a LSND mud to log and run pipe. Treat for lost circulation as necessary. Obtain 100% returns prior to cementing. Notify Engineering of any mud losses. Use air w/Air Hammer from 7 in. csg.to TD.

**B. BOP TESTING:** While drill pipe is in use, the pipe rams and the blind rams will be function tested once each trip. The anticipated reservoir is expected to be less than 1300 psi, so the BOPE will be tested to **250 psi (Low) for 5 minutes** and **1500 psi (High) for 10 minutes**. Utilize a BOPE Testing Unit with a recording chart and appropriate test plug for testing. The drum brakes will be inspected and tested each tour. **All tests and inspections will be recorded in the tour book as to time and results.**

**III. MATERIALS****A. CASING PROGRAM:**

<u>CASING TYPE</u>	<u>HOLE SIZE</u>	<u>DEPTH (MD)</u>	<u>CASING SIZE</u>	<u>WT. &amp; GRADE</u>
Surface	12-1/4"	+/- 300'	9-5/8"	36# K-55
Intermediate	8-3/4"	+/- 4,292'	7"	20# K-55
Prod. Liner	6-1/4"	+/- 4,192-6,527'	4-1/2"	10.5# K-55

**B. FLOAT EQUIPMENT:**

1. SURFACE CASING: 9-5/8" notched regular pattern guide shoe. Run (1) standard centralizer on each of the bottom (3) joints of Surface Casing.
2. INTERMEDIATE CASING: 7" cement nose guide shoe with a self-fill insert float. Place float collar one joint above the shoe. Install (1) Turbulent centralizer on each of the bottom (3) joints and one standard centralizer every (3) joints to 2,500 ft. Run (1) Turbulent centralizer at 2,700 ft., 2,500 ft., 2,300ft., 2,000ft., 1,500 ft., and 1,000 ft. (NTL-FRA 90-1).
3. PRODUCTION CASING: 4-1/2" & 5-1/2" whirler type cement nose guide shoe with a latch collar on top of 20' bottom joint. Place marker joint above 5,400'. Place centralizers as needed across selected production intervals.

**IV. CEMENTING:**

*(Note: Volumes may be adjusted onsite due to actual conditions)*

1. SURFACE: Slurry: 150sx (205 cu.ft.) of "Type III" + 2% CaCl<sub>2</sub> + 1/4 # of cello-flake/sk (Yield = 1.39 cu.ft./sk, Weight = 14.5 #/gal.). The 100% excess should circulate cement to the surface. WOC 12 hours. Test csg to 1500psi.
2. INTERMEDIATE: Lead - 550 sx (1,150) cu.ft.) of "Premium Light" with 8% gel, 1% CaCl<sub>2</sub> and 1/4# cello-flake/sk (Yield = 2.09 cu.ft./sk, Weight = 12.1 #/gal.). Tail - 50 sx (70cu.ft.) of "Type III" with 1/4# cello-flake/sk (Yield = 1.4 cu.ft./sk, Weight = 14.5#/gal.). Use **100% excess in Lead Slurry** to circulate to surface. **No excess in Tail Slurry**. Total volume = 1,220 cu.ft. Bump Plug to 1,500 psi. Notify engineering if cement is not circulated to surface.
3. PRODUCTION LINER: 10 bbl Gelled Water space. Lead: 50sx (130ft<sup>3</sup>) of Premium Light HS + 1% FL-52 + .2% CD-32, 0.1% R-3, 3 #/sk CSE. (Yield = 2.59 cu.ft./sk, Weight = 11.6 #/gal.). Tail: 100 sx (215 ft<sup>3</sup>) of Premium Light HS + 1% FL-52 + .2% CD-32, 0.1% R-3, 3 #/sk CSE, 1/4 #/sk cello flake and 4% Phenoseal. (Yield = 2.15 ft<sup>3</sup>/sk, Weight = 12.3 #/gal.). Displace cement at a minimum of 8 BPM. The 20% excess in lead and tail should cover 100 ft into intermediate casing. Total volume ~~300~~ <sup>345</sup> ft<sup>3</sup>. WOC 12 hours

**V. IV COMPLETION****A. CBL**

1. Run Cement Bond Log across all intervals to be perforated and find Top of Cement behind all casing strings if cement is not circulated to surface.

**B. PRESSURE TEST**

1. Pressure test 7" & 4-1/2" casing to 3300# for 15 minutes.

**C. STIMULATION**

1. Perforate the Point Lookout as determined from the open hole logs.
2. Stimulate with approximately 9,300# of 14/30 LiteProp™ sand in slick water.
3. Isolate Point Lookout with a CIBP.
4. Perforate the Menefee/Cliff House as determined from the open hole logs.
5. Stimulate with approximately 9,300# of 14/30 LiteProp™ sand in slick water.
6. Test each zone before removing bridge plugs.

**D. RUNNING TUBING**

1. Mesa Verde. Run 2-3/8", 4.7#, J-55, EUE tubing with a SN (1.91" ID) on top of bottom joint. Land tubing approximately 25' above the bottom Point Lookout perforation.

  
for Gary Sizemore  
Sr. Drilling Engineer

WILLIAMS PRODUCTION COMPANY JICARILLA 92 #17A  
 990' FNL & 920' FEL, SECTION 31, T27N, R3W, NMPM  
 RIO ARriba COUNTY, NEW MEXICO ELEVATION: 7138'

LATITUDE: 36°32'04"  
 LONGITUDE: 107°10'46"  
 DATUM: NAD1927

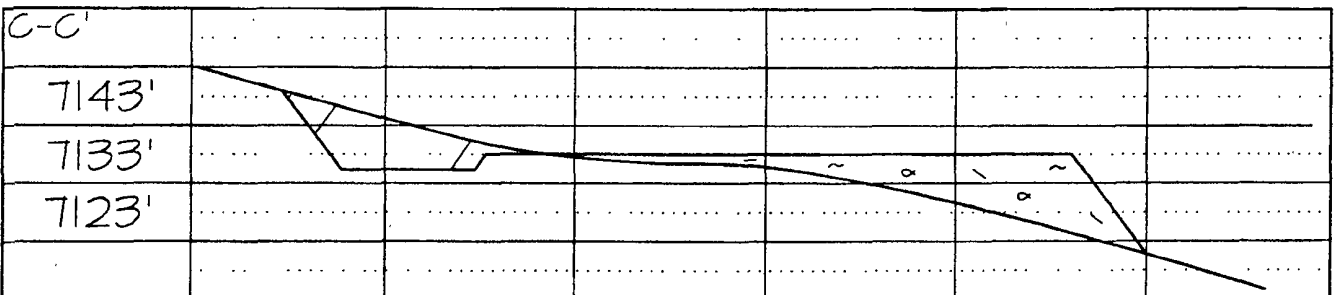
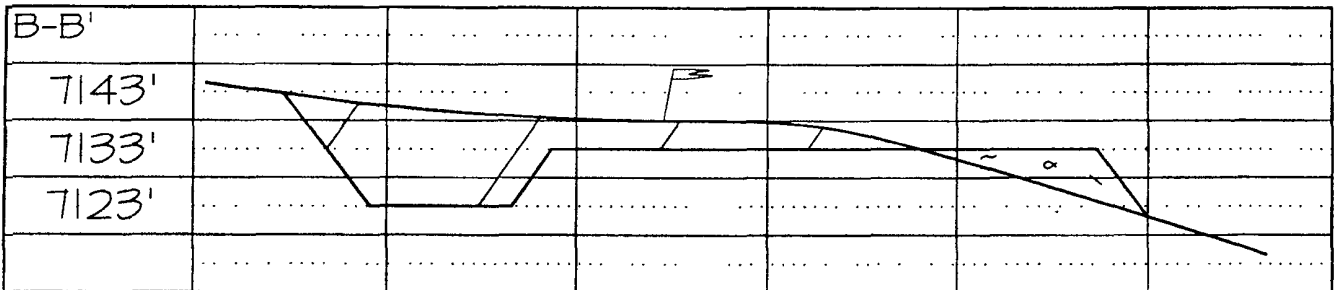
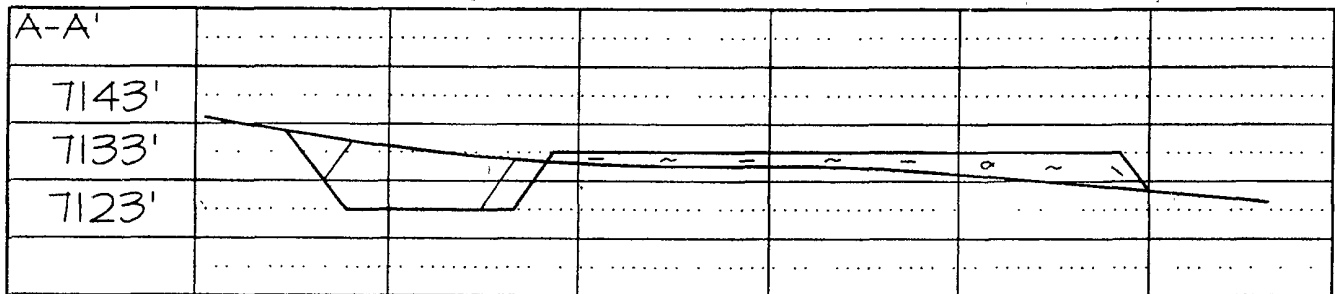
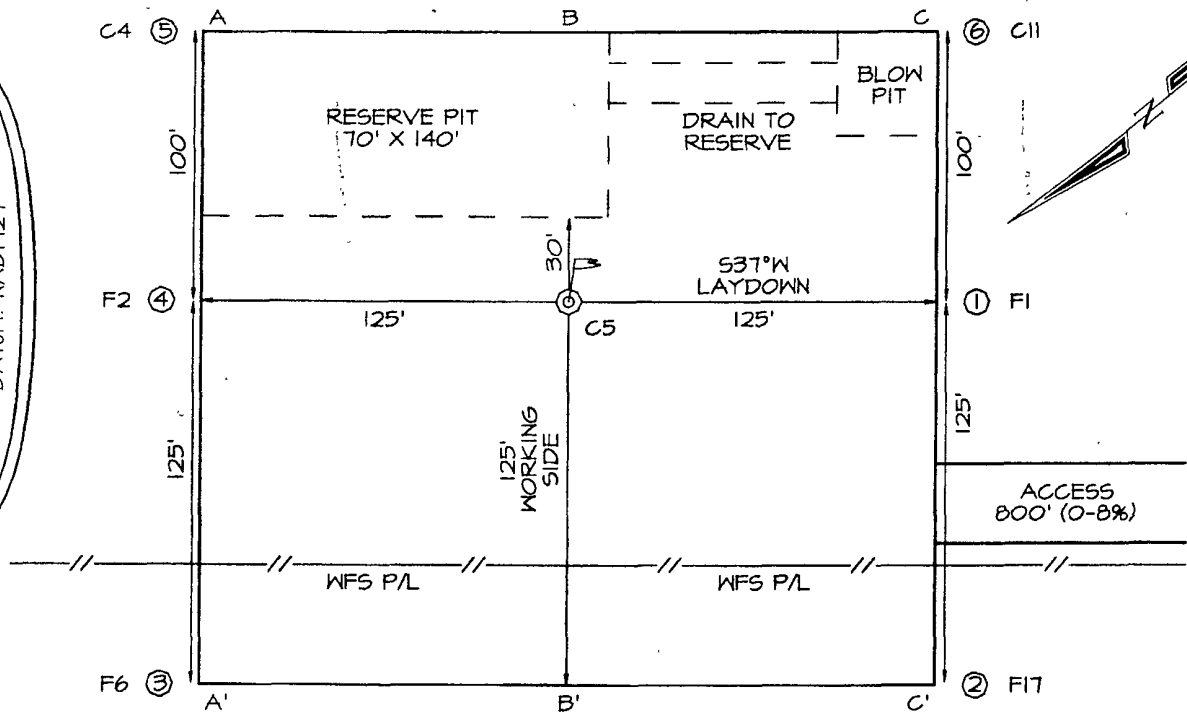

# Plat #3 Location Diagram

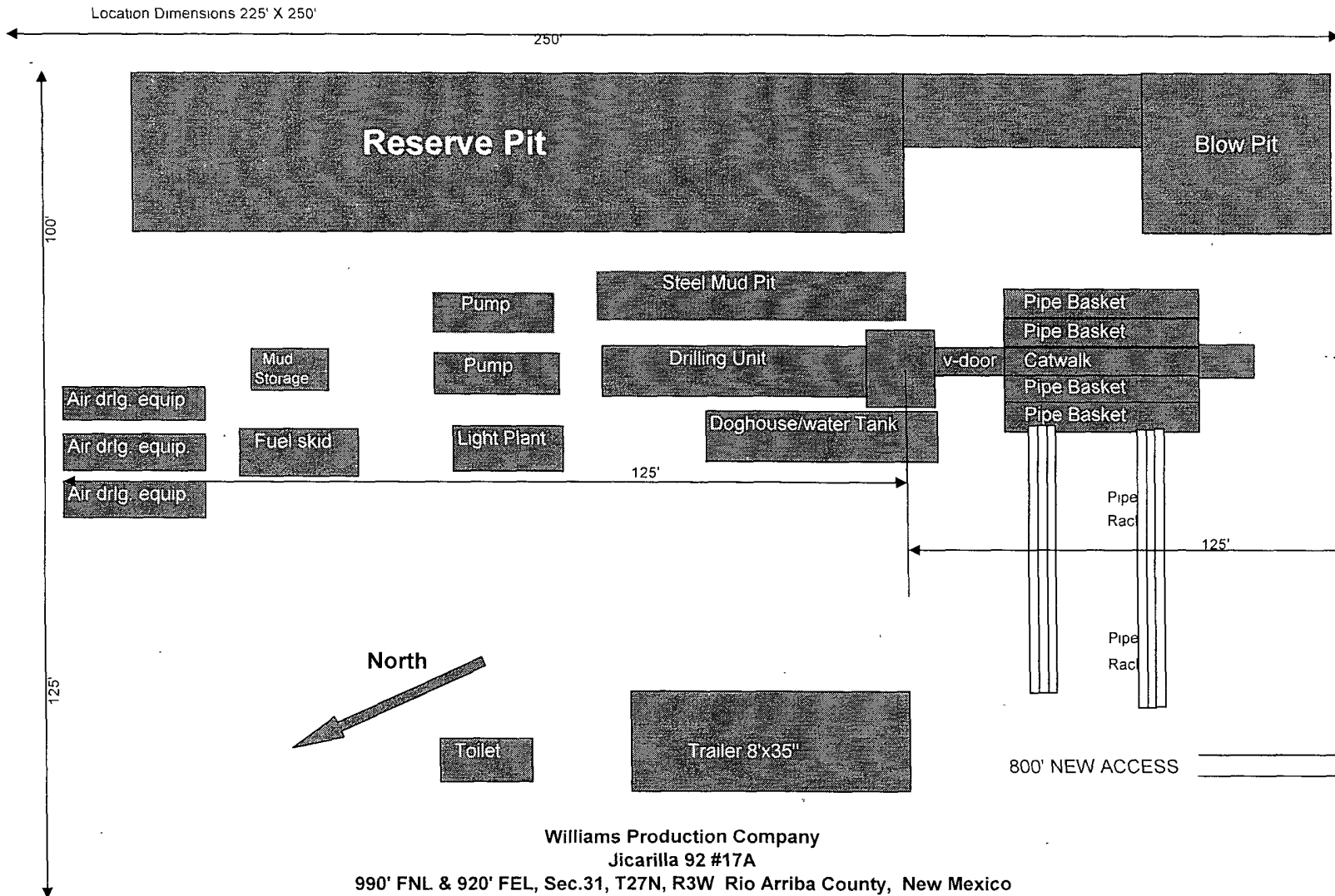

# Well Control Equipment Schematic for 2M Service

Attachment to Drilling Technical Program

## Exhibit #1 Typical BOP setup

Location: San Juan Basin, New Mexico

Date: August 20, 2001

By: John Thompson (Walsh E&P)

