

RECEIVED

2002 SEP -4 AM 10:1

070 FARMINGTON, NM

☐ Single Zone ☒ Multiple Zone

RICHARDSON OPERATING CO.

3b. Phone No. (include area code)
(505) 564-3100

10. Field and Pool, or Exploratory
BAS. FRUIT. COAL & W KUTZ PC

11. Sec., T., R., M., or Blk. and Survey or Area

M35-29n-14w NMPM

12. County or Parish SAN JUAN	13. State NM
---	------------------------

6 AIR MILES SW OF FARMINGTON

16. No. of Acres in lease

2,560

17. Spacing Unit dedicated to this well

FRUIT: 320 AC. (W2) PC: 160 AC. (SW4)

19. Proposed Depth
1.700'

20. BLM/BIA Bond No. on file
#158293308 (BLM - NATIONWIDE)

21. Elevations (Show whether DF, KDB, RT, GL, etc.)
5.807' GL

22. Approximate date work will start*
UPON APPROVAL

23. Estimated duration
2 WEEKS

24. Attachments

The following, completed in accordance with the requirements of Onshore Oil and Gas Order No.1, shall be attached to this form:

- | | |
|---|--|
| 1. Well plat certified by a registered surveyor. | 4. Bond to cover the operations unless covered by an existing bond on file (see Item 20 above). |
| 2. A Drilling Plan. | 5. Operator certification. |
| 3. A Surface Use Plan (if the location is on National Forest System Lands, the SUPO shall be filed with the appropriate Forest Service Office). | 6. Such other site specific information and/or plans as may be required by the authorized officer. |

Comments

This action is subject to technical and procedural review pursuant to 43 CFR 3165.8 and appeal pursuant to 43 CFR 3165.4

DRILLING OPERATIONS AUTHORIZED ARE
SUBJECT TO COMPLIANCE WITH ATTACHED
"GENERAL REQUIREMENTS".

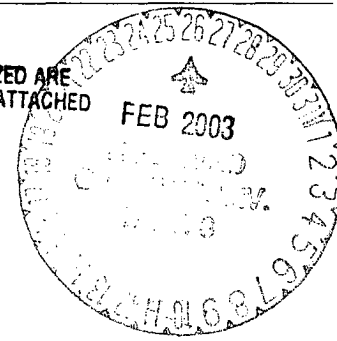

cc: BIA, BLM (&OCD), Richardson, Tribe

25. Signature

Name (*Printed/Typed*)

BRIAN WOOD

Date
9-2-02

Title

CONSULTANT

PHONE: 505 466-8120

FAX: 505 466-9682

Approved by (Signature) _____

/ s / David J. Mendicino2

Name (*Printed/Typed*)

Date FEB 24 2003

Title

Office

Application approval does not warrant or certify the the applicant holds legal or equitable title to those rights in the subject lease which would entitle the applicant to conduct operations thereon.

Conditions of approval, if any, are attached.

Title 18 U.S.C. Section 1001 and Title 43 U.S.C. Section 1212, make it a crime for any person knowingly and willfully to make to any department or agency of the United States any false, fictitious or fraudulent statements or representations as to any matter within its jurisdiction.

MMOCB

State of New Mexico
Energy, Minerals & Mining Resources Department
OIL CONSERVATION DIVISION
2040 South Pacheco
Santa Fe, NM 87505

Form C - 102

2002 SEP -4 AM 10:14
AMENDED REPORT

WELL LOCATION AND ACREAGE DEDICATION PLAT

APA Number 30-045-31192	Pool Code 71629 & 79680	Pool Name BASIN FRUIT. COAL & WEST KUTZ PC
Property Code 31906	Property Name NV NAVAJO 35	Well Number 3
OGRD No. 019219	Operator Name RICHARDSON OPERATING COMPANY	Elevation 5807'

Surface Location

UL or Lot	Sec.	Twp.	Rge.	Lot Idn.	Feet from >	North/South	Feet from >	East/West	County
M	35	29 N.	14 W.		1000'	SOUTH	1115'	WEST	SAN JUAN

Bottom Hole Location If Different From Surface

UL or Lot	Sec.	Twp.	Rge.	Lot Idn.	Feet from >	North/South	Feet from >	East/West	County

Dedication	Joint ?	Consolidation	Order No.

NO ALLOWABLE WILL ASSIGNED TO THIS COMPLETION UNTIL ALL INTERESTS HAVE BEEN CONSOLIDATED
OR A NON-STANDARD UNIT HAS BEEN APPROVED BY THE DIVISION

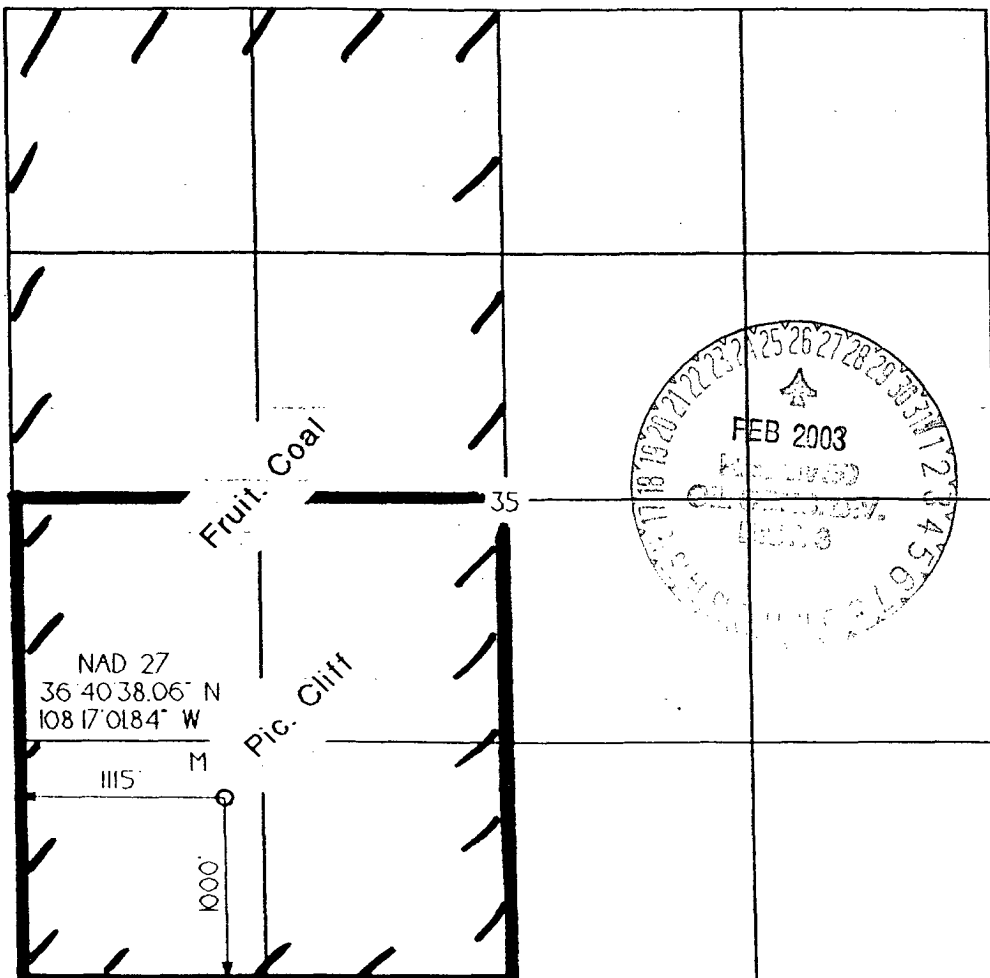

OPERATOR CERTIFICATION

I hereby certify that the information contained herein is true and complete to the best of my knowledge and belief.

Signature

Brian Wood

Printed Name

BRIAN WOOD

Title

CONSULTANT

Date

SEPT. 2, 2002

SURVEYOR CERTIFICATION

I hereby certify that the well location on this plat was plotted from field notes of actual surveys made by me or under my supervision, and that the same is true and correct to the best of my belief.

Date of Survey

MAY 2002

Signature and Seal of Professional Surveyor

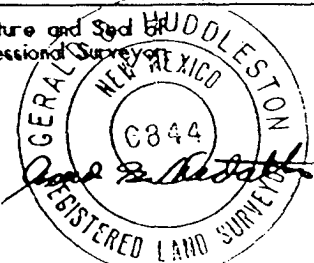

Richardson Operating Co.
NV Navajo 35 #3
1000' FSL & 1115' FWL
Sec. 35, T. 29 N., R. 14 W.
San Juan County, New Mexico

PAGE 1

Drilling Program

1. ESTIMATED FORMATION TOPS

<u>Formation Name</u>	<u>GL Depth</u>	<u>KB Depth</u>	<u>Elevation</u>
Kirtland Sh	000'	5'	+5,807'
Fruitland Fm	957'	962'	+4,850'
Pictured Cliffs Ss	1,257'	1,262'	+4,550'
Total Depth (TD)*	1,700'	1,705'	+4,107'

* all elevations reflect the ungraded ground level of 5,807'

2. NOTABLE ZONES

Gas Zones

Fruitland Fm
Pictured Cliffs

Water Zones

Fruitland Fm

Coal Zones

Fruitland Fm

Water zones will be protected with casing, cement, and weighted mud. Fresh water encountered during drilling will be recorded by depth, cased, and cemented. Oil and gas shows will be tested for commercial potential based on the well site geologist's recommendations.

3. PRESSURE CONTROL

The drilling contract has not yet been awarded, thus the exact BOP model to be used is not yet known. (A typical 2,000 psi model is on PAGE 3.) Double ram or annular system with a rotating head will be used. All ram preventers and related equipment will be hydraulically tested at nipple up and after any use under pressure to 1000 psi.

Blind rams will be hydraulically activated and checked for operational readiness

Richardson Operating Co.
NV Navajo 35 #3
1000' FSL & 1115' FWL
Sec. 35, T. 29 N., R. 14 W.
San Juan County, New Mexico

PAGE 2

each time pipe is pulled out of the hole. All checks of the BOP stack and equipment will be noted on the daily drilling report. BOP equipment will include a kelly cock, floor safety valve, and choke manifold all rated to 2000 psi. Maximum expected pressure is \approx 400 psi.

4. CASING & CEMENT

<u>Hole Size</u>	<u>O. D.</u>	<u>Weight (lb/ft)</u>	<u>Grade</u>	<u>Age</u>	<u>GL Setting Depth</u>
8-3/4"	7"	20	K-55	New	120'
6-1/4"	4-1/2"	10.5	K-55	New	1,700'

Surface casing will be cemented to surface with \approx 36 cubic feet (\approx 30 sacks) Class B + 2% CaCl_2 . Volume is based on 100% excess, yield of 1.18 cubic feet per sack, and slurry weight of 15.6 pounds per gallon. W. O. C. = 12 hours. Pressure test surface casing to 600 psi for 30 minutes.

Production casing hole will first be cleaned of rock chips by circulating at least 150% of hole volume with mud to the surface. Thirty barrels of fresh water will next be circulated. Lead with \approx 195 cubic feet (\approx 95 sacks) of Class B with 2% metasilicate (yield = 2.06 cubic feet per sack, slurry weight = 12.5 pounds per gallon). Tail with \approx 115 cubic feet (\approx 95 sacks) of Class B with 2% CaCl_2 (yield = 1.18 cubic feet per sack, slurry weight = 15.6 pounds per gallon). Total cement volume is \approx 310 cubic feet based on 75% excess and circulating to surface.

Production casing will have 4-1/2" cement guide shoe and self fill float collar. Float will be placed one joint above the shoe. Five centralizers will be spaced on every other joint starting above the shoe. Five turbolizers will be placed on every other joint starting from the top of the well.