



UNITED STATES
DEPARTMENT OF THE INTERIOR
BUREAU OF LAND MANAGEMENT

RCVD DEC 31 '08
OIL CONS. DIV.

DIST. 3

707 MAR 30 PM 2:48
APPLICATION FOR PERMIT TO DRILL, DEEPEN, OR PLUG BACK

1a. Type of Work DRILL	5. Lease Number SF-079290-A Unit Reporting Number	
1b. Type of Well GAS	6. If Indian, All. or Tribe	
2. Operator ConocoPhillips	7. Unit Agreement Name San Juan 28-7 Unit	
3. Address & Phone No. of Operator PO Box 4289, Farmington, NM 87499 (505) 326-9700	8. Farm or Lease Name 9. Well Number #158M	
4. Location of Well Unit H (SENE), 1380' FNL & 220' FEL, Latitude 36° 39.0124 N Longitude 107° 32.0413 W	10. Field, Pool, Wildcat Blanco MV/Basin DK 11. Sec., Twn, Rge, Mer. (NMPM) Sec. 23, T28N, R7W API # 30-039-30238	
14. Distance in Miles from Nearest Town 21 miles/Blanco	12. County Rio Arriba	13. State NM
15. Distance from Proposed Location to Nearest Property or Lease Line 220'		
16. Acres in Lease  H ₂ S POTENTIAL EXIST	17. Acres Assigned to Well DK & MV - 320 - (E/2)	
18. Distance from Proposed Location to Nearest Well, Drlg, Compl, or Applied for on this Lease 680' San Juan 28-7 Unit 428		
19. Proposed Depth 7843'	20. Rotary or Cable Tools Rotary	
21. Elevations (DF, FT, GR, Etc.) 6651' GL	22. Approx. Date Work will Start	
23. Proposed Casing and Cementing Program See Operations Plan attached		
24. Authorized by:  Rhonda Rogers (Regulatory Technician)	3-29-07 Date	

A COMPLETE C-144 MUST BE SUBMITTED TO AND APPROVED BY THE NMOCD FOR: A PIT, CLOSED LOOP SYSTEM, BELOW GRADE TANK, OR PROPOSED ALTERNATIVE METHOD, PURSUANT TO NMOCD PART 19.15.17, PRIOR TO THE USE OR CONSTRUCTION OF THE ABOVE APPLICATIONS.

PERMIT NO.

APPROVAL DATE

APPROVED BY 

TITLE

AFM

DATE

12/30/08

Archaeological Report attached

Threatened and Endangered Species Report attached

NOTE: This format is issued in lieu of U.S. BLM Form 3160-3

Title 18 U.S.C. Section 1001, makes it a crime for any person knowingly and willfully to make to any department or agency of the United States any false, fictitious or fraudulent statements or presentations as to any matter within its jurisdiction.

Example Master Plan Type 3

This action is subject to technical and procedural review pursuant to 43 CFR 3165.3 and appeal pursuant to 43 CFR 3165.4

JAN 07 2009

NMOCD

DRILLING OPERATIONS AUTHORIZED ARE SUBJECT TO COMPLIANCE WITH ATTACHED "GENERAL REQUIREMENTS".

NOTIFY AZTEC OCD 24 HRS.
PRIOR TO CASING & CEMENT

DISTRICT I
1835 N. French Dr., Hobbs, N.M. 88249

DISTRICT II
1301 West Grand Avenue, Artesia, N.M. 88210

DISTRICT III
1000 Rio Brazos Rd., Aztec, N.M. 87410

DISTRICT IV
1220 S. St. Francis Dr., Santa Fe, NM 87505

State of New Mexico
Energy, Minerals & Natural Resources Department

OIL CONSERVATION DIVISION

1220 South St. Francis Dr.
Santa Fe, NM 87505

RECEIVED

BLM
210 FARMINGTON NM

Form C-102
Revised October 12, 2005

Submit to Appropriate District Office
State Lease - 4 Copies
Fee Lease - 3 Copies

☐ AMENDED REPORT

WELL LOCATION AND ACREAGE DEDICATION PLAT

API Number 80-039-30238		Pool Code 72319/71599	Pool Name Blanco Mesaverde/Basin Dakota
Property Code 31739	Property Name SAN JUAN 28-7 UNIT		Well Number 158M
GRID No. 217817	Operator Name CONOCOPHILLIPS COMPANY		Elevation 6651'

10 Surface Location

UL or lot no.	Section	Township	Range	Lot Idn	Feet from the	North/South line	Feet from the	East/West line	County
H	23	28-N	7-W		1380'	NORTH	220'	EAST	RIO ARriba

11 Bottom Hole Location if Different From Surface

UL or lot no.	Section	Township	Range	Lot Idn	Feet from the	North/South line	Feet from the	East/West line	County
H									
Dedicated Acres 320 acres MV/DK			Joint or Infill		Consolidation Code		Order No.		

NO ALLOWABLE WILL BE ASSIGNED TO THIS COMPLETION UNTIL ALL INTERESTS HAVE BEEN CONSOLIDATED
OR A NON-STANDARD UNIT HAS BEEN APPROVED BY THE DIVISION

<p>16</p> <p>LAT: 36°39.0124' N. LONG: 107°32.0413' W. NAD 1927</p> <p>LAT: 36.650214' N. LONG: 107.534625' W. NAD 1983</p>	<p>9 00° 37' 11" W 2855.00'</p>		<p>1380'</p> <p>220'</p> <p>2855.00'</p>	<p>17 OPERATOR CERTIFICATION</p> <p>I hereby certify that the information contained herein is true and complete to the best of my knowledge and belief, and that this operation either owns a working interest or undivided mineral interest in the land including the proposed bottom hole location or has a right to drill this well at this location pursuant to a contract with an owner of such a mineral or a working interest, or to a voluntary pooling agreement or a compulsory pooling order heretofore entered by the Division.</p> <p><i>Kandis Roland</i> Signature Kandis Roland Printed Name</p>
	SF-079290-A			
	23			
<p>18 SURVEYOR CERTIFICATION</p> <p>I hereby certify that the well location shown on this plat was plotted from field notes of actual surveys made by me or under my supervision, and that the same is true and correct to the best of my belief.</p> <p>11-01-05 Date of Survey NEW MEXICO 15703 Signature and Seal of Professional Surveyor C. Lee W. Russell Certificate Number 15703</p>				



TECHNICAL SERVICES
A CORROSION COMPANY

CATHODIC PROTECTION PLAN FOR NEW WELLS

WELL NAME S.J. 28-7 #308 158M LEGALS B.23 28-7 COUNTY Rio Arriba

PURPOSED C.P. SYSTEM: Drill G.B. and set rectifier on southwest corner of location. Trench approx 250' of #8 neg. cable from rectifier to well head. Trench approx 1400' of A/C from existing rect. on SJ 28-7 #258G (FMI #248A) to proposed new rectifier.

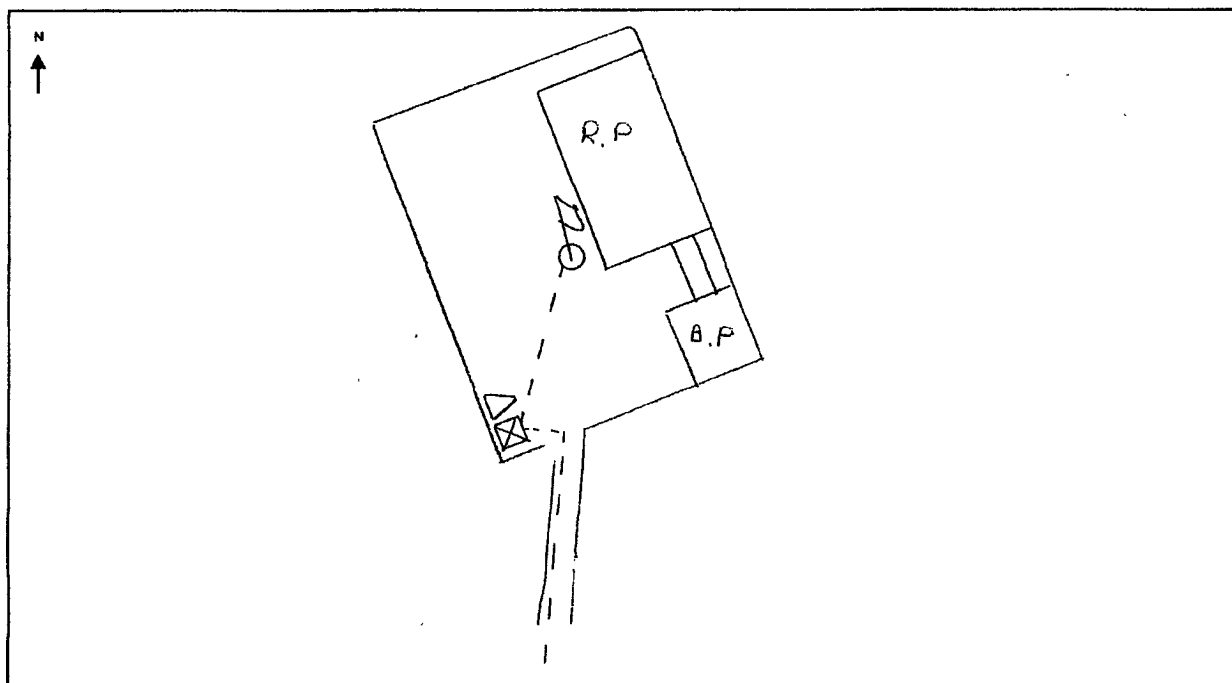

EXISTING WELLHEAD	METER HOUSE	G.B.	POWER SOURCE	CABLE	NEW WELL	OVERHEAD A.C.

COMMENTS: _____

NEAREST POWER SOURCE Existing Rect SJ 28-7 #258G (FMI #248A) DISTANCE: 1400'
PIPELINES IN AREA: N/A

TECHNICIAN: Michelle Hargrove DATE: 12/5/06

6 CR 5412 BLOOMFIELD, N.M. 87413
OFFICE: 505-634-0271 CELL: 505-793-6953

PROJECT PROPOSAL - New Drill / Sidetrack

San Juan Business Unit

SAN JUAN 28-7 UNIT 158M

DEVELOPMENT

Lease:		AFE #: WAN.CNV.7160		AFE \$:	
Field Name: 28-7		Rig: XX 2008 28N		State: NM	County: RIO ARRIBA
Geologist:		Phone:		Geophysicist:	
Geoscientist: Glaser, Terry J		Phone: (832)486-2332		Prod. Engineer: Fontenot, Jessie C	
Res. Engineer: Johnson, Tom B.		Phone: (832)-486-2347		Proj. Field Lead: Fransen, Eric E.	
				Phone:	

Primary Objective (Zones):

Zone	Zone Name
R20002	MESAVERDE(R20002)
R20076	DAKOTA(R20076)

Location: Surface		Datum Code: NAD 27		Straight Hole	
Latitude: 36.650206	Longitude: -107.534020	X:	Y:	Section: 23	Range: 007W
Footage X: 220 FEL	Footage Y: 1380 FNL	Elevation: 6651	(FT)	Township: 028N	
Tolerance:					

Location Type: Year Round	Start Date (Est.):	Completion Date:	Date In Operation:
Formation Data: Assume KB = 6665 Units = FT			

Formation Call & Casing Points	Depth (TVD in Ft)	SS (Ft)	Depletion (Yes/No)	BHP (PSIG)	BHT	Remarks
SURFACE CSG	216	6449	<input type="checkbox"/>			12-1/4" hole. 9-5/8" 32.3 ppf, H-40, STC casing. Cement with 171 cuft. Circulate cement to surface.
OJAM	2391	4274	<input type="checkbox"/>			Possible water flows.
KRLD	2635	4030	<input type="checkbox"/>			
FRLD	3148	3517	<input type="checkbox"/>			Possible gas.
PCCF	3383	3282	<input type="checkbox"/>			
LEWS	3438	3227	<input type="checkbox"/>			
Intermediate Casing	3538	3127	<input type="checkbox"/>			8-3/4" hole. 7", 20 ppf, J-55, STC Casing. Cement with 796 cuft. Circulate cement to surface.
CHRA	4323	2342	<input type="checkbox"/>			
UCLFH	5018	1647	<input type="checkbox"/>			
CLFH	5123	1542	<input type="checkbox"/>			Gas; possibly wet
MENF	5163	1502	<input type="checkbox"/>			Gas.
PTLK	5562	1103	<input type="checkbox"/>	400		Gas possible, highly fractured
MANCOS	6028	637	<input type="checkbox"/>			
GLLP	6779	-114	<input type="checkbox"/>			
GREENHORN	7522	-857	<input type="checkbox"/>	1200		
GRANEROS	7582	-917	<input type="checkbox"/>			
TWO WELLS	7620	-955	<input type="checkbox"/>			
PAGU	7712	-1047	<input type="checkbox"/>			Gas. Highly Fractured.
CBRO	7740	-1075	<input type="checkbox"/>			
CBRL	7772	-1107	<input type="checkbox"/>			
ENCINAL	7843	-1178	<input type="checkbox"/>			
TD	7843	-1178	<input type="checkbox"/>			TD at T/ENCN, 6-1/4" hole. 4-1/2" 10.5/11.6 J-55 STC/LTC casing. Cement with 586 cuft. Circulate cement a minimum of 100' inside the previous casing string.

Reference Wells:

Reference Type	Well Name	Comments
Intermediate	SJ 28-7 9	14-28N-7W-SW, KB = 6537

PROJECT PROPOSAL - New Drill / Sidetrack

SAN JUAN 28-7 UNIT 158M

DEVELOPMENT

Intermediate	SJ 28-7 158	23-28N-7W-NE, KB = 6717
--------------	-------------	-------------------------

Logging Program:			
Intermediate Logs:	<input type="checkbox"/> Log only if show	<input type="checkbox"/> GR/ILD	<input type="checkbox"/> Triple Combo

TD Logs:	<input type="checkbox"/> Triple Combo	<input type="checkbox"/> Dipmeter	<input type="checkbox"/> RFT	<input type="checkbox"/> Sonic	<input type="checkbox"/> VSP	<input type="checkbox"/> TDT	<input checked="" type="checkbox"/> Other
CBL/GR							

Additional Information:

Log Type	Stage	From (Ft)	To (Ft)	Tool Type/Name	Remarks
----------	-------	-----------	---------	----------------	---------

Comments: Location/Tops/Logging - TD is 300' below PNLK DK 28N07W23NE2 AND MVNM028N007W23NE2

Zones - 158M is in the same unit Ltr as 158. It cannot be drill as a 80/80 in this location. Well type is change to a Mv single
11/14/2006 Added the DK formation DK 28N07W23NE2 AND MVNM028N007W23NE2 due to new location.

General/Work Description - 3/16/07 Renamed from the 28-7 Unit 50B to the 28-7 Unit 158M
11/14/2006 . The BLM will not let us stake it at the original proposed location and directional economics would not have supported going solely for the MV. We believe we have a new location in a different 1/4 1/4 that the BLM will approve. And in that new location will would now be legal to add the DK back to the project and not strand those reserves. NO LEWIS

Directions from the PO in Blanco, NM

To:

CONOCOPHILLIPS COMPANY

SAN JUAN 28-7 UNIT 50B 158m

1380' FNL & 220' FEL,

Section 23, T28N, R7W, N.M.P.M., Rio Arriba County,
New Mexico

Go East on Hwy 64 for 8.5 miles,
turn right (southerly) 0.6 miles,
stay left at y-Intersection (southeasterly) 1.0 miles,
turn left (northerly) for 0.3 miles,
turn right (easterly) along Ridge Road 6.4 miles,
continue southeast 1.2 miles,
continue (southeasterly) 2 miles,
continue (southwesterly) 0.6 miles,
turn left (east) 0.3 miles,
turn right (southerly) 0.7 miles to y-intersection,
stay left (southerly) 0.1 miles,
to beginning of new access on the left (east) side of road
which continues for 350' to the newly staked well location.