

District I
1625 N. French Dr., Hobbs, NM 88240
District II
1301 W. Grand Avenue, Artesia, NM 88210
District III
1000 Rio Brazos Road, Aztec, NM 87410
District IV
1220 S. St. Francis Dr., Santa Fe, NM 87505

State of New Mexico
Energy Minerals and Natural Resources

Oil Conservation Division
1220 South St. Francis Dr.
Santa Fe, NM 87505

OK
RISK
No Benzene
BTEX
Submit 1 copy to appropriate District Office and 1 copy to the Santa Fe Office (Revised 3/9/94)

PIT REMEDIATION AND CLOSURE REPORT

30-045-09855

Operator: Amoco (Site Closed by El Paso Field Services) Telephone: _____

Address: _____

Facility Or: Atlantic B LS 4, Meter 70181

Well Name _____

Location: Unit or Qtr/Qtr Sec N Sec 5 T 30 R 10 County San Juan

Pit Type: Separator _____ Dehydrator _____ Other Drip

Land Type: BLM X, State _____, Fee _____ Other _____

Pit Location: Pit dimensions: length 26', width 25', depth 4'
(Attach diagram)

Reference: wellhead X, other _____

Footage from reference: 57'

Direction from reference: 242 Degrees X East North _____
of _____ West South _____

Depth To Ground Water	Less than 50 feet	(20 points)
(Vertical distance from	50 feet to 99 feet	(10 points)
contaminants to seasonal	Greater than 100 feet	(0 points) <u>10</u>
high water elevation of		
ground water.)		

Wellhead Protection Area:	Yes (20 points)
(Less than 200 feet from a private	No (0 points) <u>0</u>
domestic water source, or; less than	
1000 feet from all other water sources.)	

Distance To Surface Water:	Less than 200 feet	(20 points)
(Horizontal distance to perennial	200 feet to 1000 feet	(10 points)
lakes, ponds, rivers, streams, creeks,	Greater than 1000 feet	(0 points) <u>10</u>
irrigation canals and ditches.)		

RANKING SCORE (TOTAL POINTS): 20

Date Remediation Started: 09/14/94 Date completed: 09/14/94

Remediation Method: Excavation X Approx. cubic yards 80
(Check all appropriate sections.) Landfarmed _____ Insitu Bioremediation _____
Other _____

Remediation Location: Onsite _____ Offsite Tierra
(i.e. landfarmed onsite, name and location of offsite facility)

General Description of Remedial Action: Excavated pit to 12'. Took PID sample, closed pit. Contamination at approximately 11' to 12' deep.

Ground Water Encountered: No X Yes _____ Depth _____

Final Pit: Sample location Four walls and center of pit composite
Closure Sampling: _____
(if multiple samples, attach sample results and diagram of sample locations and depths) Sample depth 12'

Sample Date 09/14/94 Sample time 10:15

Sample Results

Benzene(ppm) <0.025

Total BTEX(ppm) 0.124

Field headspace(ppm) 10

TPH 149

Ground Water Sample: Yes _____ No X (If yes, attach sample results)

I hereby certify that the information above is true and complete to the best of my knowledge and belief.

Date 4/23/93

Signature



Printed Name
and Title

Scott Pope, Senior Environmental Scientist

**Atlantic B LS 4
Meter/Line ID 70181**

SITE DETAILS

Legals - Twn: 30N	Rng: 10W	Sec: 5	Unit: N
NMOCD Hazard Ranking: 20		Land Type: BLM	
Operator: Amoco Production Company		Pit Closure Date: 9/14/94	

RATIONALE FOR RISK-BASED CLOSURE

The pit noted above was assessed and ranked according to the criteria in the New Mexico Oil Conservation Division's (NMOCD) Unlined Surface Impoundment Closure Guidelines.

A test pit was excavated to 12 feet (ft) below ground surface (bgs) and a soil sample was collected for field headspace and laboratory analysis for TPH and BTEX. Groundwater was not encountered in the test pit. Headspace analysis indicated an organic vapor content of 10 ppm; laboratory analysis indicated a benzene concentration of <0.025 mg/kg, a total BTEX concentration of 0.124 mg/kg, and a TPH concentration of 149 mg/kg. The TPH measurement exceeded recommended remediation levels for the Hazard Ranking Score of 20.

Approximately 80 cubic yards of soil were excavated and hauled to Tierra, a commercial landfarm, for treatment and disposal. The pit was backfilled with clean soil and graded in a manner to direct surface runoff away from the pit area.

A Phase II boring was terminated at 30 ft bgs. A soil sample was collected at 28-30 ft bgs for field headspace and laboratory analysis for BTEX and TPH. No groundwater was encountered in the soil boring. Headspace analysis indicated an organic vapor content of 43 ppm; laboratory analysis indicated a benzene concentration of <0.025 mg/kg, a total BTEX concentration of 0.030 mg/kg, and a TPH concentration of 581 mg/kg. The benzene and total BTEX concentrations were below recommended remediation levels for the Hazard Ranking Score of 20.

No Phase III activities were conducted.

El Paso Field Services requests closure of the above-mentioned pit location for the following reasons:

- The primary source, discharge to the pit, has been removed for over 8 years.
- Approximately 80 cubic yards of source material was excavated to the practical extent of the equipment and disposed of offsite.
- The pit was backfilled and the former pit area graded to direct surface runoff away from the former pit.
- The clean soil from the berms placed on top of the excavation would limit the potential for direct contact with hazardous constituents by livestock or the public; i.e., direct contact exposure pathways are unlikely to be completed.
- Groundwater was not encountered in the soil boring to 30 ft bgs; local geologic features indicate the depth to groundwater is greater than 50 ft bgs..

REVISED FIELD PIT SITE ASSESSMENT FORM

GENERAL

Meter: 70181 Location: ATLANTIC B L S 4
 Operator #: 0203 Operator Name: AMOCO P/L District: AZTEC
 Coordinates: Letter N Section 5 Township: 30 Range: 11
 or Latitude _____ Longitude _____
 Pit Type: Dehydrator _____ Location Drip: X Line Drip: _____ Other: _____
 Site Assessment Date: 8-16-94 Area: 04 Run: 33
 Revised Date: 1-24-03

SITE ASSESSMENT

NMOCD Zone:

(from NMCOD Maps)

Land Type:

BLM ☒ (1)

State ☐ (2)

Fee ☐ (3)

Indian _____

Inside ☒ (1)

Outside ☐ (2)

Depth to Groundwater

Less than 50 Feet (20 points) ☐ (1)

50 Feet to 99 Feet (10 Points) ☒ (2)

Greater than 100 Feet (0 Points) ☐ (3)

Well Protection Area

Is it less than 1000 feet from well, spring or other source of fresh water extraction?
 or; Is it less than 200 feet from a private domestic water source?

☐ YES (20 Points)

☒ NO (0 Points)

Horizontal Distance to Surface Water Body

Less than 200 Feet (20 points) ☐ (1)

200 Feet to 1000 Feet (10 Points) ☒ (2)

Greater than 1000 Feet (0 Points) ☐ (3)

Name of Surface Water Body NORTH FORK CANYON

(Surface Water Body: Perennial River, Stream, Creek, Irrigation Canal, Ditch, Lake, Pond)

Distance to Nearest Ephemeral Stream ☐ (1) < 100 feet (Navajo Pits Only)

☐ (2) > 100 feet

TOTAL HAZARD RANKING SCORE 20 **POINTS**

REMARKS

Remarks: REASSESS^{AK} REVISION BASED ON REASSESSMENT OF THE
DEPTH TO GROUNDWATER AND THE HORIZONTAL DISTANCE
TO SURFACE WATER BODY.

FIELD PIT SITE ASSESSMENT FORM

GENERAL	Meter: <u>70-181</u> Location: <u>Atlantic B L54</u> Operator #: <u>0203</u> Operator Name: <u>Amoco Production</u> P/L District: <u>Aztec</u> Coordinates: Letter: <u>N</u> Section <u>5</u> Township: <u>30</u> Range: <u>10</u> Or Latitude _____ Longitude _____ Pit Type: Dehydrator _____ Location Drip: <u>X</u> Line Drip: _____ Other: _____ Site Assessment Date: <u>8/16/94</u> Area: <u>04</u> Run: <u>33</u>	
SITE ASSESSMENT	NMOCD Zone: (From NMOCD Maps) Inside <input checked="" type="checkbox"/> (1) Outside <input type="checkbox"/> (2) Land Type: BLM <input checked="" type="checkbox"/> (1) State <input type="checkbox"/> (2) Fee <input type="checkbox"/> (3) Indian _____ Depth to Groundwater Less Than 50 Feet (20 points) <input checked="" type="checkbox"/> (1) 50 Ft to 99 Ft (10 points) <input type="checkbox"/> (2) Greater Than 100 Ft (0 points) <input type="checkbox"/> (3) Wellhead Protection Area : Is it less than 1000 ft from wells, springs, or other sources of fresh water extraction? , or ; Is it less than 200 ft from a private domestic water source? <input type="checkbox"/> (1) YES (20 points) <input checked="" type="checkbox"/> (2) NO (0 points) Horizontal Distance to Surface Water Body Less Than 200 Ft (20 points) <input checked="" type="checkbox"/> (1) 200 Ft to 1000 Ft (10 points) <input type="checkbox"/> (2) Greater Than 1000 Ft (0 points) <input type="checkbox"/> (3) Name of Surface Water Body <u>N. Fork Knewton Canyon</u> (Surface Water Body : Perennial Rivers, Major Wash, Streams, Creeks, Irrigation Canals, Ditches, Lakes, Ponds) Distance to Nearest Ephemeral Stream <input type="checkbox"/> (1) < 100' (Navajo Pits Only) <input type="checkbox"/> (2) > 100' TOTAL HAZARD RANKING SCORE: <u>40</u> POINTS	
REMARKS	Remarks : <u>Redline Book - Inside</u> <u>Vulnerable Zone Tap - Inside</u> <u>Four pits, location drip pit has liquid in it. Will close one pit.</u> <div style="text-align: right;">NTR 0. 44111</div>	

ORIGINAL PIT LOCATION

ORIGINAL PIT LOCATION

Original Pit : a) Degrees from North 242° Footage from Wellhead 57'
b) Length : 26' Width : 25' Depth : 4'

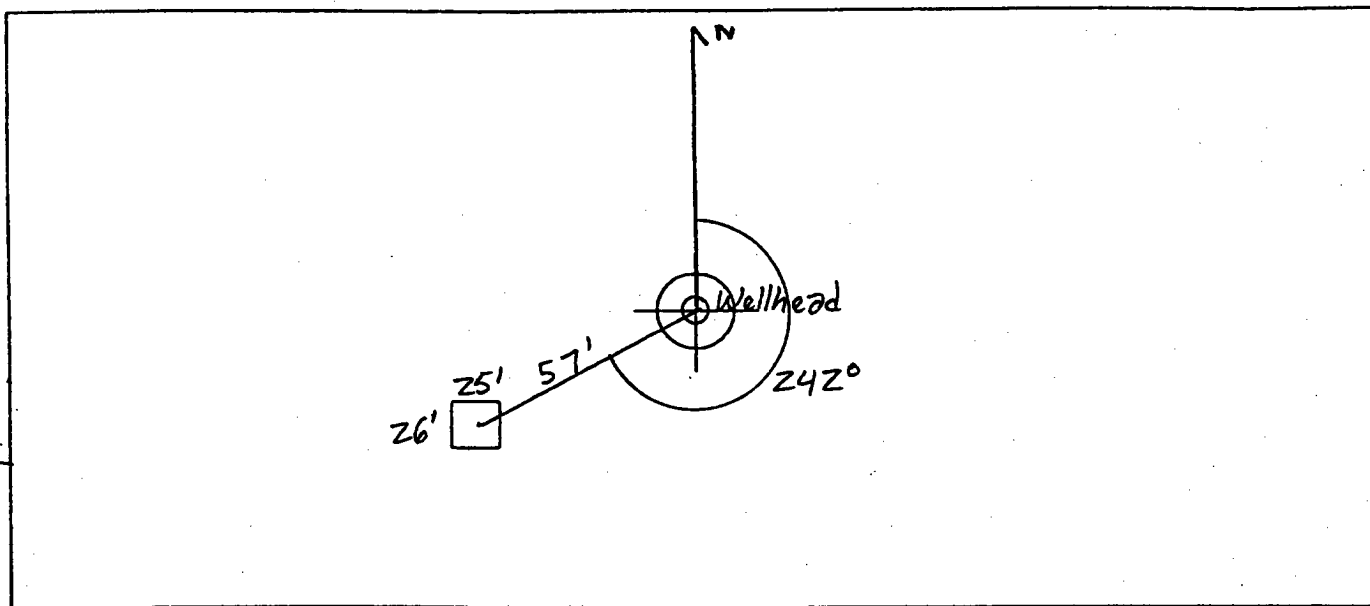

REMARKS

Remarks :

Pictures @ 1238 (1-4, Roll 1, 8/16/94)
Dump Truck

Completed By:

Mark Hall
Signature

8/16/94
Date

GENERAL

Date Started : 9/14/94 Area: 04 Run: 33

FIELD OBSERVATIONS

Yes No

Groundwater Encountered ☐ (1) ☒ (2) Approximate Depth _____ Feet

CLOSURE

Pit Closure Date: 9/14/94 Pit Closed By: BGI

REMARKS

Remarks : EXCAVATED pit to 12', TOOK PID Sample,
Closed pit. Contamination End at approximately 11' to 12' Deep.

Signature of Specialist: King Jan