

District I
1625 N. French Dr., Hobbs, NM 88240
District II
1301 W. Grand Ave., Artesia, NM 88210
District III
1000 Rio Brazos Rd., Aztec, NM 87410
District IV
1220 S. St Francis Dr., Santa Fe, NM 87505

State of New Mexico
Energy, Minerals and Natural Resources
Oil Conservation Division
1220 S. St Francis Dr.
Santa Fe, NM 87505

Form C-1

APPLICATION FOR PERMIT TO DRILL

Operator Name and Address RICHARDSON OPERATING CO 3100 La Plata Highway Farmington, NM 87401		OGRID Number 19219
		API Number 30-045-32098
Property Code 33345	Property Name WF FRPC 17	Well No. 001

Surface Location

UL or Lot	Section	Township	Range	Lot Idn	Feet From	N/S Line	Feet From	E/W Line	County
A	17	29N	14W	A	1188	N	888	E	San Juan

Proposed Pools

BASIN FRUITLAND COAL (GAS) 71629
TWIN MOUNDS FRUITLAND SAND PC (GAS) 86620

Work Type New Well	Well Type GAS	Cable/Rotary	Lease Type Private	Ground Level Elevation 5180
Multiple Y	Proposed Depth 1200	Formation Pictured Cliffs Formation	Contractor	Spud Date 03/15/2004

Proposed Casing and Cement Program

Type	Hole Size	Casing Size	Casing Weight/ft	Setting Depth	Sacks of Cement	Estimated TOC
Surf	8.75	7	20	120	55	0
Prod	6.25	4.5	10.5	1200	150	0

Proposed Blowout Prevention Program

Type	Working Pressure	Test Pressure	Manufacturer
Double Ram	2000	1000	

I hereby certify that the information given above is true and complete to the best of my knowledge and belief.

Electronically Signed By: Anne Jones

Title:

Date: 01/22/2004

Phone: 505-564-8115

OIL CONSERVATION DIVISION

Electronically Approved By: Frank Chavez

Title: District Supervisor

Approval Date: 01/27/2004

Expiration Date: 01/27/2005

Conditions of Approval:

No Conditions

State of New Mexico
Energy, Minerals & Mining Resources Department
OIL CONSERVATION DIVISION
2040 South Pacheco
Santa Fe, NM 87505

Form C - 102

☐ AMENDED REPORT

WELL LOCATION AND ACREAGE DEDICATION PLAT

APA Number 30-045- 32098	Pool Code 86620	Pool Name Twin Mounds Fruitland Sand PC (Gas)
Property Code	Property Name WF FRPC 17	Well Number 1
OGARD No. 19219	Operator Name RICHARDSON OPERATING COMPANY	Elevation 5180'

Surface Location									
UL or Lot A	Sec. 17	Twp. 29 N.	Rge. 14 W.	Lot No.	Feet from 888'	North/South NORTH	Feet from 888'	East/West East	County SAN JUAN

Bottom Hole Location if Different From Surface									
UL or Lot	Sec.	Twp.	Rge.	Lot No.	Feet from	North/South	Feet from	East/West	County

Dedication	Joint ?	Consolidation	Order No.
------------	---------	---------------	-----------

NO ALLOWABLE WILL ASSIGNED TO THIS COMPLETION UNTIL ALL INTERESTS HAVE BEEN CONSOLIDATED
OR A NON-STANDARD UNIT HAS BEEN APPROVED BY THE DIVISION

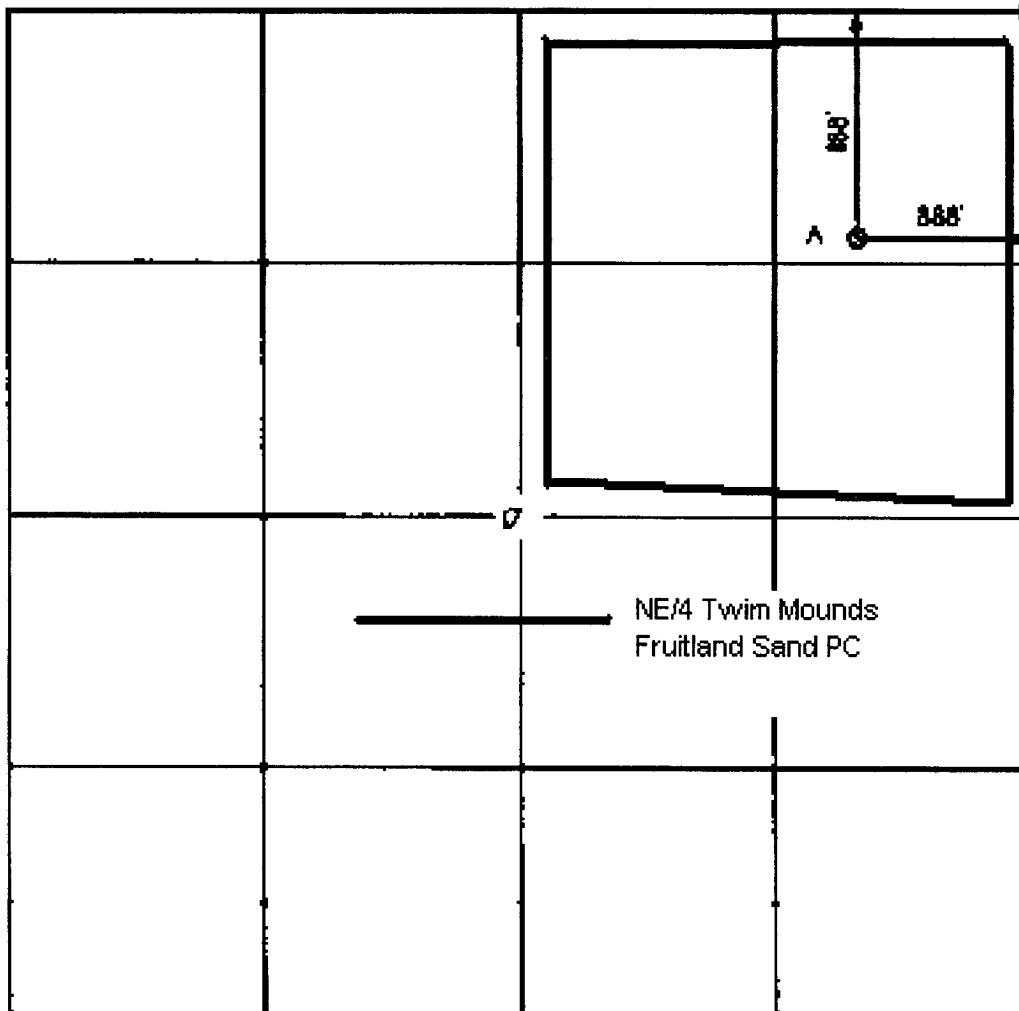

OPERATOR CERTIFICATION

I hereby certify that the information contained herein is true and complete to the best of my knowledge and belief.

Signature

Paul Lehrman

Printed Name

Paul Lehrman

Title

Landman

Date

1/22/04

SURVEYOR CERTIFICATION

I hereby certify that the well location on this plat was plotted from field notes of actual surveys made by me or under my supervision, and that the same is true and correct to the best of my belief.

Date of Survey

5/29/03

Signature
Professional



State of New Mexico
Energy, Minerals & Mining Resources Department
OIL CONSERVATION DIVISION
2040 South Pacheco
Santa Fe, NM 87505

Form C - 102

☐ AMENDED REPORT

WELL LOCATION AND ACREAGE DEDICATION PLAT

30-045- 32098	71629	Basin Fruitland Coal
Property Code	Property Name WF FRPC 17	Well Number 1
OGHD No. 19219	Operator Name RICHARDSON OPERATING COMPANY	Elevation 5180'

Surface Location

TL or Lot	Sec	Twp	Rge	Lot No.	Feet from	North/South	Feet from	East/West	County
A	17	29 N	14 W		888'	NORTH	888'	East	SAN JUAN

Bottom Hole Location if Different from Surface

TL or Lot	Sec	Twp	Rge	Lot No.	Feet from	North/South	Feet from	East/West	County

Dedication	Date	Completion	Order No.

NO ALLOWABLE WELL ASSIGNED TO THIS COMPLETION UNTIL ALL INTERESTS HAVE BEEN CONSOLIDATED
OR A NON-STANDARD UNIT HAS BEEN APPROVED BY THE DIVISION

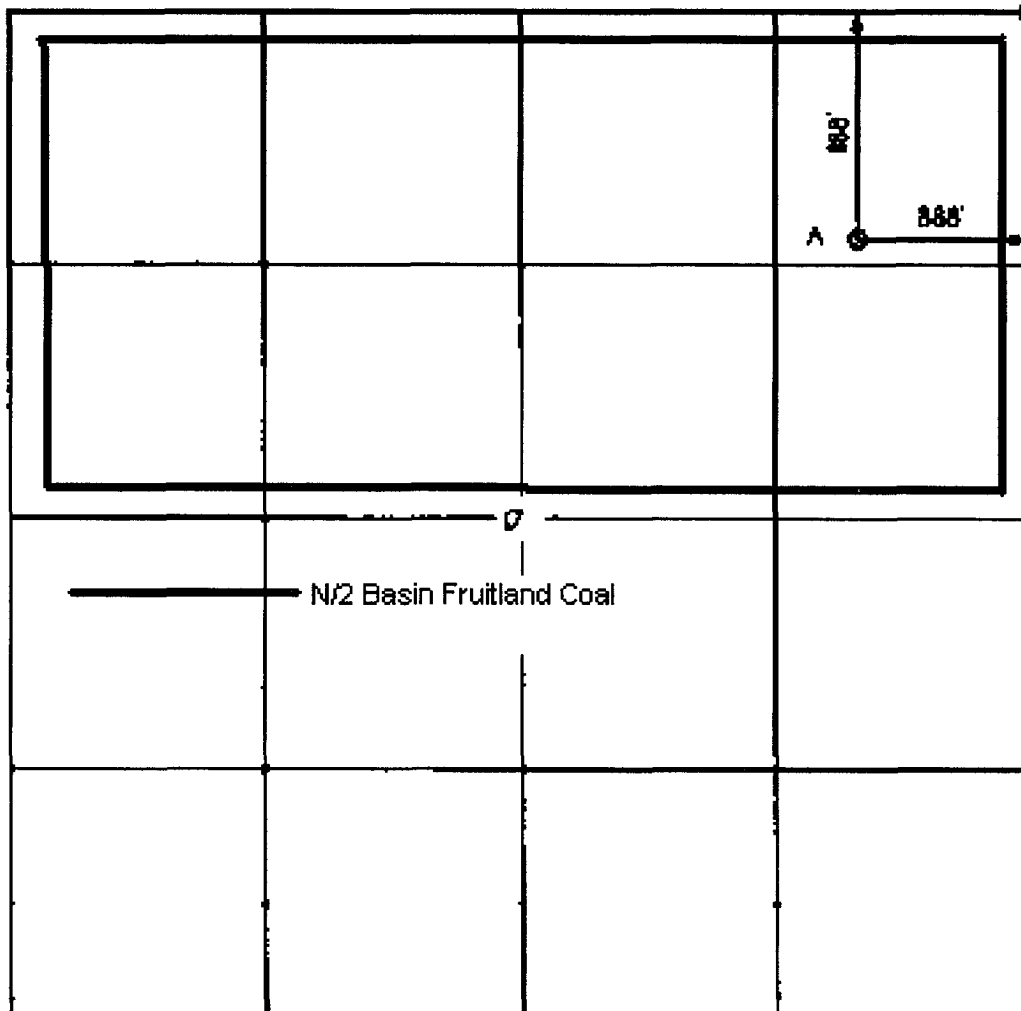

OPERATOR CERTIFICATION

I hereby certify that the information contained herein is true and complete to the best of my knowledge and belief.

Signature

Paul Lehrman

Printed Name

Paul Lehrman

Title

Landman

Date

1/22/04

SURVEYOR CERTIFICATION

I hereby certify that the well location on this plat was plotted from field notes of actual surveys made by me or under my supervision, and that the same is true and correct to the best of my belief.

Date of Survey

5/29/03

Signature

Professional

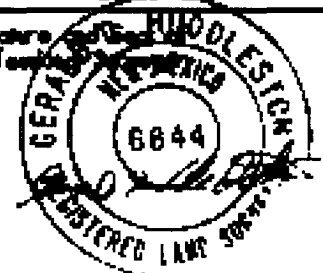

Permit Comments

Operator: RICHARDSON OPERATING CO , 19219

Well: ROPCO 17 #1 #001

User Name	Comment	Comment Date
SHAYDEN	This well will require an attached plat. Please attach a tif. image of the C-102 and resubmit.	1/8/2004
SHAYDEN	The attached form C-102 has not been completely filled out, including the information at the top of the page and the dedicated acreage is not marked.	1/22/2004
SHAYDEN	9.01 acres added that ONGARD does not recognize from lot WO1-San Juan River acreage.	1/26/2004