

UNITED STATES  
DEPARTMENT OF THE INTERIOR  
BUREAU OF LAND MANAGEMENT

RECEIVED

APPLICATION FOR PERMIT TO DRILL, DEEPEN, OR PLUG BACK

2004 JAN 15 PM 2:5

070 Farmington, NM

1a. Type of Work DRILL	5. Lease Number SF-078509 Unit Reporting Number
1b. Type of Well GAS	6. If Indian, All. or Tribe
2. Operator <b>BURLINGTON</b> RESOURCES Oil & Gas Company	Unit Agreement Name San Juan 32-9 Unit
3. Address & Phone No. of Operator PO Box 4289, Farmington, NM 87499 (505) 326-9700	8. Farm or Lease Name San Juan 32-9 Unit 9. Well Number #277S
4. Location of Well 1630' FNL, 1630' FWL  Latitude 36° 57.4852'N, Longitude 107° 49.2228'W	10. Field, Pool, Wildcat Basin Fruitland Coal 11. Sec., Twn, Rge, Mer. (NMPM) Sec. 30, T32N, R09W API # 30-045- 32137
14. Distance in Miles from Nearest Town 16.6 miles to the intersection of Hwy 550 and Hwy 173 in Aztec, NM	12. County San Juan 13. State NM
15. Distance from Proposed Location to Nearest Property or Lease Line 1630'	17. Acres Assigned to Well 196.56 <i>W/2 eq. vibrant</i>
16. Acres in Lease	
18. Distance from Proposed Location to Nearest Well, Drig, Compl, or Applied for on this Lease 21'	
19. Proposed Depth 3525'	20. Rotary or Cable Tools Rotary
21. Elevations (DF, FT, GR, Etc.) 6616' GR	22. Approx. Date Work will Start
23. Proposed Casing and Cementing Program See Operations Plan attached	
24. Authorized by: <i>Jon Clark</i> Regulatory/Compliance Specialist	10-23-03 Date

PERMIT NO. \_\_\_\_\_ APPROVAL DATE \_\_\_\_\_  
APPROVED BY WAYNE TOWNSEND TITLE \_\_\_\_\_ DATE 3/8/04

Archaeological Report attached

Threatened and Endangered Species Report attached

NOTE: This format is issued in lieu of U.S. BLM Form 3160-3

Title 18 U.S.C. Section 1001, makes it a crime for any person knowingly and willfully to make to any department or agency of the United States any false, fictitious or fraudulent statements or presentations as to any matter within its jurisdiction.

DRILLING OPERATIONS AUTHORIZED ARE  
SUBJECT TO COMPLIANCE WITH ATTACHED  
"GENERAL REQUIREMENTS".

This action is subject to technical and  
procedural review pursuant to 43 CFR 3165.3  
and appeal pursuant to 43 CFR 3165.4

NMOC

DISTRICT I  
1625 N. French Dr., Hobbs, N.M. 88240

State of New Mexico  
Energy, Minerals & Natural Resources Department

Form C-102  
Revised August 15, 2000

DISTRICT II  
811 South First, Artesia, N.M. 88210

DISTRICT III  
1000 Rio Brazos Rd., Aztec, N.M. 87410

DISTRICT IV  
2040 South Pacheco, Santa Fe, NM 87505

OIL CONSERVATION DIVISION  
2040 South Pacheco  
Santa Fe, NM 87505

Submit to Appropriate District Office  
State Lease - 4 Copies  
Fee Lease - 3 Copies

☐ AMENDED REPORT

WELL LOCATION AND ACREAGE DEDICATION PLAT

<sup>1</sup> API Number 30-045 <b>32137</b>	<sup>2</sup> Pool Code 71629	<sup>3</sup> Pool Name Basin Fruitland Coal
<sup>4</sup> Property Code 7473	<sup>5</sup> Property Name SAN JUAN 32-9 UNIT	<sup>6</sup> Well Number 277S
<sup>7</sup> OGRID No. 14538	<sup>8</sup> Operator Name BURLINGTON RESOURCES OIL AND GAS COMPANY LP	<sup>9</sup> Elevation 6616'

<sup>10</sup> Surface Location

UL or lot no.	Section	Township	Range	Lot Idn	Feet from the	North/South line	Feet from the	East/West line	County
F	30	32-N	9-W		1630'	NORTH	1630'	WEST	SAN JUAN

<sup>11</sup> Bottom Hole Location If Different From Surface

UL or lot no.	Section	Township	Range	Lot Idn	Feet from the	North/South line	Feet from the	East/West line	County
<sup>12</sup> Dedicated Acres 196.56					<sup>13</sup> Joint or Infill		<sup>14</sup> Consolidation Code		<sup>15</sup> Order No. R-9222 Tract 9

NO ALLOWABLE WILL BE ASSIGNED TO THIS COMPLETION UNTIL ALL INTERESTS HAVE BEEN CONSOLIDATED  
OR A NON-STANDARD UNIT HAS BEEN APPROVED BY THE DIVISION

<b>16</b>	N 87-07 E 1714.68'		LOT 7	1630'	LOT 6	LOT 5	
	S 00-40 E 2484.90'						
	1630'		LOT 10	LOT 11	LOT 12		
	SF-078509		LOT 15	LOT 14	LOT 13	LOT 18	LOT 19

LAT: 36°57.4852' N.  
LONG: 107°49.2228' W.  
NAD 1927

**17 OPERATOR CERTIFICATION**  
I hereby certify that the information contained herein is true and complete to the best of my knowledge and belief.  
Signature: Joni Clark  
Printed Name: Joni Clark  
Title: 10-23-03  
Date: 10-23-03

**18 SURVEYOR CERTIFICATION**  
I hereby certify that the well location shown on this plat was plotted from field notes of actual surveys made by me or under my supervision and that the same is true and correct to the best of my knowledge and belief.  
Date of Survey: 10-23-03  
Signature: Glen W. Russell  
Certificate Number: 15703

RECEIVED  
OIL CONSERV. DIV.  
DIST. 3  
MAR 2004

# BURLINGTON RESOURCES

RECEIVED

SAN JUAN DIVISION

February 10, 2004

Bureau of Land Management  
1235 La Plata Highway  
Farmington, New Mexico 87401

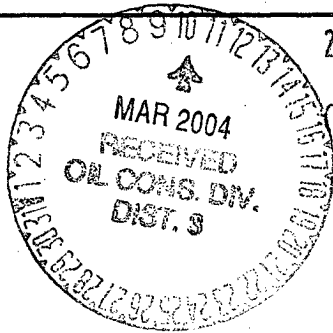

2004 FEB 11 AM 10:18

070 Farmington, NM

Dear Adrienne Garcia:

The surface cement slurry has been changed for the following wells to:

Cement with Type III cement with 0.25 pps Celloflake, 3% calcium chloride. (1.28 yeild, 15.2 ppg, 200% excess, bring cement to surface). Wait on cement appropriate time until cement achieves 250 psi compressive strength at 60 degrees F. prior to nipple up of BOPE. Wait on cement for 8 hrs for conventionally set holes before pressure testing or drilling out from under surface. Test casing to 600 psi for 30 minutes.

9-5/8" csg set @ 120'  
88 sxs cmt  
113 cu. ft. of slurry

Allison Unit 120S, NWSE, Sec. 30, T-32-N, R-6-W, Federal lease NM-04207.  
Allison Unit 121S, SENW, Sec. 30, T-32-N, R-6-W, Federal lease SF-081155.  
Carson SRC 101S, SWNW, Sec. 1, T-30-N, R-5-W, Federal lease NM-4453.  
Federal G 1N, SESW, Sec. 35, T-31-N, R-12-W, Federal lease SF-078120A.  
Hale 351S, SWNW, Sec. 34, T-31-N, R-8-W, Federal lease SF-079037.  
Hale 352S, NWSE, Sec. 27, T-31-N, R-8-W, Federal lease SF-079037.  
Howell A 301S, NENW, Sec. 4, T-30-N, R-8-W, Federal lease SF-078580.  
Howell Com J 301S, NWNW, Sec. 11, T-30-N, R-8-W, Federal lease NM-010468.  
Howell D 350S, SWSW, Sec. 28, T-31-N, R-8-W, Federal lease SF-078387.  
Howell D 351S, SENW, Sec. 29, T-31-N, R-8-W, Federal lease SF-078387.  
Johnston Federal 15S, NWSW, Sec. 35, T-31-N, R-9-W, Federal lease SF-078439.  
Johnston Federal 26S, SWNW, Sec. 7, T-31-N, R-9-W, Federal lease SF-078439.  
Johnston Federal 29S, SWSE, Sec. 7, T-31-N, R-9-W, Federal lease SF-078439.  
San Juan 32-9 Unit 250S, SWSE, Sec. 4, T-31-N, R-9-W, Federal lease SF-080875.  
San Juan 32-9 Unit 277S, SENW, Sec. 30, T-32-N, R-9-W, Federal lease SF-078509.  
San Juan 32-9 Unit 283S, NENW, Sec. 33, T-32-N, R-9-W, Federal lease SF-079048.  
Scott 100S, SENW, Sec. 29, T-32-N, R-10-W, Federal lease SF-078604.  
Scott Com 291S, NESE, Sec. 29, T-32-N, R-10-W, Federal lease SF-078604.  
Vanderslice 100S, SWNW, Sec. 18, T-32-N, R-10-W, Federal lease SF-078215A.  
Waller 100S, SESE, Sec. 11, T-32-N, R-11-W, Federal lease SF-078119A.  
Wilmer Canyon 101S, NENW, Sec. 25, T-32-N, R-8-W, Federal lease NM-6893.

Sincerely,

Tammy Wimsatt  
Regulatory Specialist

ACCEPTED FOR RECORD

MAR 08 2004

FARMINGTON FIELD OFFICE

NMOC

FARMINGTON

## OPERATIONS PLAN

**Well Name:** San Juan 32-9 Unit #277S  
**Location:** 1630' FNL, 1630' FWL Section 30, T-32-N, R-09-W  
Latitude 36° 57.4852'N, Longitude 107° 49.2228'W  
San Juan County, NM  
**Formation:** Basin Fruitland Coal  
**Elevation:** 6616' GR

Formation:	Top	Bottom	Contents
Surface	San Jose	2068'	
Ojo Alamo	2068'	2161'	aquifer
Kirtland	2161'	2883'	
Fruitland	2883'	3198'	
Intermediate TD	3178'		
Fruitland Coal	3198'	3440'	gas
B/Basal Coal	3440'	3450'	gas
Pictured Cliffs	3450'		
Total Depth	3525'		

**Logging Program:** none  
**Mudlog:** from 7" to 3525'  
**Coring Program:** none

**Mud Program:**

Interval	Type	Weight	Vis.	Fluid Loss
0-120'	Spud/Air/Air Mist	8.4-9.0	40-50	no control
120-3178'	Non-dispersed	8.4-9.0	30-60	no control
3178-3525'	Air/Mist			

**Casing Program (as listed, the equivalent, or better):**

Hole Size	Depth Interval	Csg. Size	Wt.	Grade
12 1/4"	0' - 120'	9 5/8"	32.3#	H-40
8 3/4"	0' - 3178'	7"	20.0#	J-55
6 1/4"	3178' - 3525'	open hole		

**Alternate Casing Program (as listed, the equivalent, or better):**

Hole Size	Depth Interval	Csg. Size	Wt.	Grade
12 1/4"	0' - 120'	9 5/8"	32.3#	H-40
8 3/4"	0' - 3178'	7"	20.0#	J-55
6 1/4"	3138' - 3525'	5 1/2"	15.5#	J-55

**Tubing Program:**

0' - 3525'	2 3/8"	4.7#	J-55
------------	--------	------	------

**Float Equipment:** 9 5/8" surface casing - saw tooth guide shoe. Centralizers will be run in accordance with Onshore Order #2.

7" intermediate casing - guide shoe and self-fill float collar. Standard centralizers run every other joint above shoe. Two turbolizing type centralizers - one below and one into the base of the Ojo Alamo @ 2161'. Standard centralizers thereafter every fourth joint up to the base of the surface pipe.

**Wellhead Equipment:** 9 5/8" x 7" x 2 3/8" x 11" 2000 psi xmas tree assembly.

**Cementing:**

9 5/8" surface casing -

Pre-Set Drilled Cement with 23 sx Type I, II cement with 20% flyash mixed at 14.5 ppg, 1.61 cu ft per sack yield. (37 cu ft of slurry, bring cement to surface) Wait on cement for 24 hours for pre-set holes before pressure testing or drilling out from under surface.

Conventionally Drilled

Cement with 80 sx Type III cement with 0.25 pps Celloflake, 2% CaCl. (113 cu ft of slurry, 200% excess, bring cement to surface) Wait on cement for 8 hrs for conventionally set holes before pressure testing or drilling out from under surface.

~~Waive the 6 hours WOC in lieu of 4 hours prior to NU of BOPE.~~ See BHM General Requirements

7" intermediate casing - lead w/278 sacks Premium Lite with 3% calcium chloride, 5 pps LCM-1, and 1/4#/sack flocele, 0.4% FL-52, & 0.4% SMS. Tail with 90 sacks Type III cmt with 1% calcium chloride, 1/4#/sack flocele and 0.2% FL-52 (716 cu.ft., 50% excess to circulate to surface).

5 1/2" liner - will not be cemented if run.

Note: If open hole logs are run, cement volumes will be based on 25% excess over caliper volumes.

**BOP and tests:**

Surface to intermediate TD - 11" 2000 psi (minimum) double gate BOP stack (Reference Figure #1). Prior to drilling out surface casing, test rams to 600#/30 min.

Intermediate TD to Total Depth - 7 1/6" 2000 psi (minimum) double gate BOP stack (Reference Figure #2). Prior to drilling out intermediate casing, test blind rams and casing to 1500 psi for 30 minutes; all pipe rams and casing to 1500 psi for 30 minutes each.

From surface to TD - choke manifold (Reference Figure #3).

Pipe rams will be actuated at least once each day and blind rams actuated once each trip to test proper functioning. An upper kelly cock valve with handle and drill string safety valves to fit each drill string will be maintained and available on the rig floor.

**Additional information:**

- \* The Fruitland Coal formation will be completed.
- \* Anticipated pore pressure for the Fruitland is less than 500 psi.
- \* This gas is dedicated.
- \* The west half of Section 30 is dedicated to the Fruitland Coal.

Date:

January 14, 2004

Drilling Engineer:

Jim McCarthy

# BURLINGTON RESOURCES

SAN JUAN DIVISION

*Released  
3-11-04*  
November 14, 2003

(Certified Mail – Return Receipt Requested)

*St*  
Re: San Juan 32-9 Unit 277S  
Basin Fruitland Coal  
1630'FNL, 1630'FWL Section 30, T-32-N, R-9-W  
San Juan County, New Mexico

To the Affected Persons:

Burlington Resources Oil & Gas Company LP is submitting the enclosed Application for Permit to Drill to the appropriate regulatory agency(s) for approval. This well is located inside the High Productivity Area of the Basin-Fruitland Coal Pool as indicated on the attached plat. Notice is being made pursuant to New Mexico Oil Conservation Commission Order R-8768-F dated July 17, 2003.

The affected parties have twenty (20) days from receipt of this notice in which to file with the District Office of the New Mexico Oil Conservation Division written objection to the proposed Application for Permit to Drill.

Sincerely,

*Frances Bond*

Frances Bond  
Regulatory Assistant

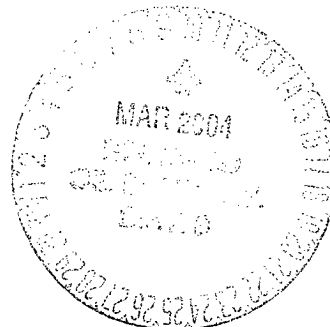

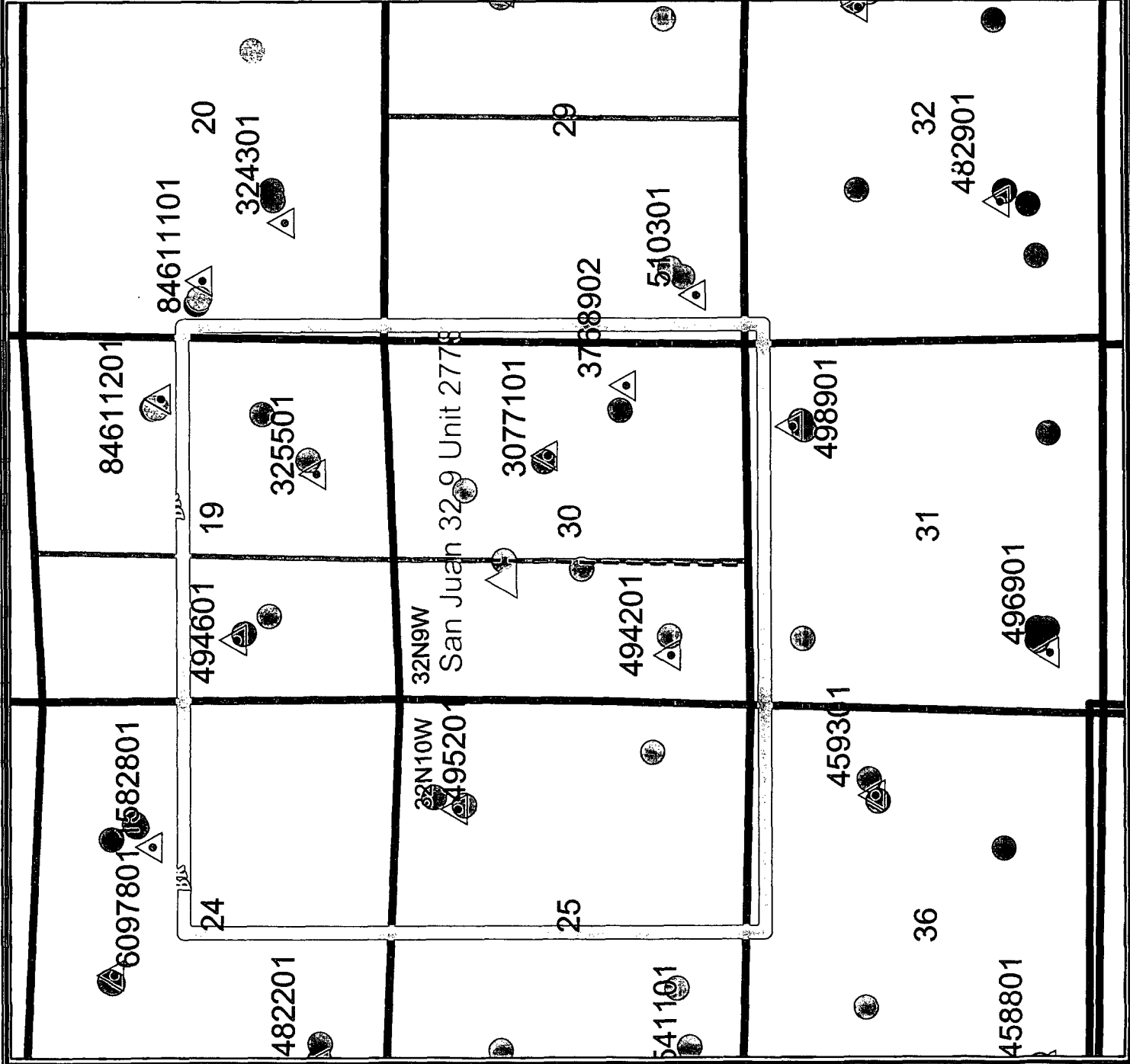

**Legend**

△ FRUITLAND COAL

● Current Operator

● Current Operator

● UNKNOWN

● BP AMERICA

● BROG

CONOCOPHILLIPS

□ Sections

□ Townships

□ County Lines

□ San Juan Federal Units Outlines

**BURLINGTON**  
RESOURCES

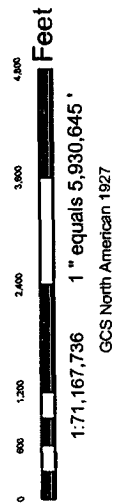

**BURLINGTON RESOURCES**

San Juan

San Juan 32-9 Unit 277S (HPA)

T32N R9W

Prepared By: mib Date: 10/23/2003  
 File Number: Revised Date: 10/23/2003  
 File Name: Public Projects\San Juan Basin Users\San Juan Basin Users

ATN AMERICA PRODUCTION COMPANY  
ATTN BRYAN ANDERSON OSO ENG

SAN JUAN BU  
WEST LAKE 1 ROOM 19-114  
501 WESTLAKE PARK BLVD  
HOUSTON, TX 77079

A. Signature <input checked="" type="checkbox"/> X		Agent <input type="checkbox"/>	
B. Received by (Print Name)		C. Date of Delivery	
		11-14-03	
D. Is delivery address different from item 1? <input type="checkbox"/> Yes			
If YES enter delivery address: 0000 N/A			

Service Type

☒ Certified

4. Restricted Delivery? (Extra Fee)

☐ Yes

707912604 36  
S Form 3811  
11/22 AM 10/27/2003  
Code: S1 329111  
Receipt  
File: HPA INFI 1