



**LTR**



**Job separation sheet**

NUMBER OF COPIES RECEIVED	
DISTRIBUTION	
SANTA FE	1
FILE	1
U.S.G.S.	2
LAND OFFICE	
TRANSPORTER	
OIL	
GAS	
PRODUCTION OFFICE	
OPERATOR	1

**NEW MEXICO OIL CONSERVATION COMMISSION**  
**Santa Fe, New Mexico**

Form C-101  
Revised (12/1/55)

**NOTICE OF INTENTION TO DRILL**

Notice must be given to the District Office of the Oil Conservation Commission and approval obtained before drilling or recompletion begins. If changes in the proposed plan are considered advisable, a copy of this notice showing such changes will be returned to the sender. Submit this notice in **QUINTUPLICATE**. One copy will be returned following approval. See additional instructions in Rules and Regulations of the Commission. **If State Land submit 6 Copies Attach Form C-128 in triplicate to first 3 copies of form C-101**

P. O. Box 2475, Pampa, Texas  
(Place)

April 15, 1963  
(Date)

OIL CONSERVATION COMMISSION  
SANTA FE, NEW MEXICO

Gentlemen:

You are hereby notified that it is our intention to commence the Drilling of a well to be known as  
**Sidwell Oil and Gas, Inc.**

(Company or Operator)

**Fernandez Company** (Lease), Well No. **1**, in **0** (Unit) The well is located **3500** feet from the **West** line and **990** feet from the **South** line of Section **8**, T. **15N**, R. **7W**, NMPM. (GIVE LOCATION FROM SECTION LINE) **wildcat** Pool. **McKinley** County

D	C	B	A
E	F	G	H
L	K	J	I
M	N	O	P

If State Land the Oil and Gas Lease is No. ....

If patented land the owner is **Fernandez Company**

Address **San Mateo, New Mexico**

We propose to drill well with drilling equipment as follows:  
**Failing 1500 Rotary Rig to total depth**

The status of plugging bond is **applied for**

Drilling Contractor **D & W. Drilling Company**  
**Grants, New Mexico**

We intend to complete this well in the **Hospah Sand** formation at an approximate depth of **850** feet.

**CASING PROGRAM**

We propose to use the following strings of Casing and to cement them as indicated:

Size of Hole	Size of Casing	Weight per Foot	New or Second Hand	Depth	Sacks Cement
<b>9</b>	<b>7</b>	<b>20.00</b>	<b>New</b>	<b>60'</b>	<b>10 sx.</b>
<b>6-1/4</b>	<b>4-1/2</b>	<b>9.50</b>	<b>New</b>	<b>800'</b>	<b>85 sx.</b>

If changes in the above plans become advisable we will notify you immediately.

**ADDITIONAL INFORMATION** (If recompletion give full details of proposed plan of work.)

**On surface casing enough cement will be used to circulate to surface. Objective Hospah Sand will be cored, if productive production casing will be run on top of sand and open hole completion made.**

APR 19 1963

Approved \_\_\_\_\_, 19\_\_\_\_\_  
Except as follows:

Sincerely yours,

**SIDWELL OIL AND GAS, INC.**

By **E. R. Sidwell** (Company or Operator)

Position **Vice President**

Send Communications regarding well to

Name **E. R. Sidwell**

Address **P. O. Box 2475, Pampa, Texas**

OIL CONSERVATION COMMISSION

By **E. R. Sidwell**

NUMBER OF COPIES RECEIVED	
DISTRIBUTION	
SANTA FE	
FILE	
U.S.G.S.	
LAND OFFICE	
TRANSPORTER	OIL GAS
PRODUCTION OFFICE	
OPERATOR	

**NEW MEXICO OIL CONSERVATION COMMISSION**  
**WELL LOCATION AND ACREAGE DEDICATION PLAT**  
 SEE INSTRUCTIONS FOR COMPLETING THIS FORM ON THE REVERSE SIDE

FORM C-128  
 Revised 5/1/57

**SECTION A**

Operator <b>Sidwell Oil and Gas, Inc.</b>			Lease <b>Fernandez Company</b>		Well No. <b>1</b>
Unit Letter <b>0</b>	Section <b>8</b>	Township <b>15N</b>	Range <b>7W</b>	County <b>McKinley</b>	
Actual Footage Location of Well: <b>3500</b> feet from the <b>West</b> line and <b>990</b> feet from the <b>South</b> line					
Ground Level Elev.	Producing Formation <b>Hospah</b>		Pool <b>Wildcat</b>		Dedicated Acreage: <b>40</b> Acres

1. Is the Operator the only owner in the dedicated acreage outlined on the plat below? YES X NO \_\_\_\_ . ("Owner" means the person who has the right to drill into and to produce from any pool and to appropriate the production either for himself or for himself and another. (65-3-29 (e) NMSA 1935 Comp.)
2. If the answer to question one is "no," have the interests of all the owners been consolidated by communitization agreement or otherwise? YES \_\_\_\_ NO \_\_\_\_ . If answer is "yes," Type of Consolidation \_\_\_\_\_
3. If the answer to question two is "no," list all the owners and their respective interests below:

Owner	Land Description

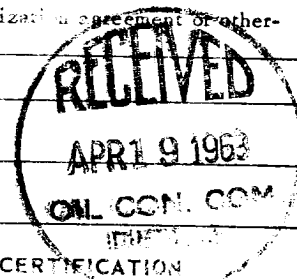

**SECTION B**

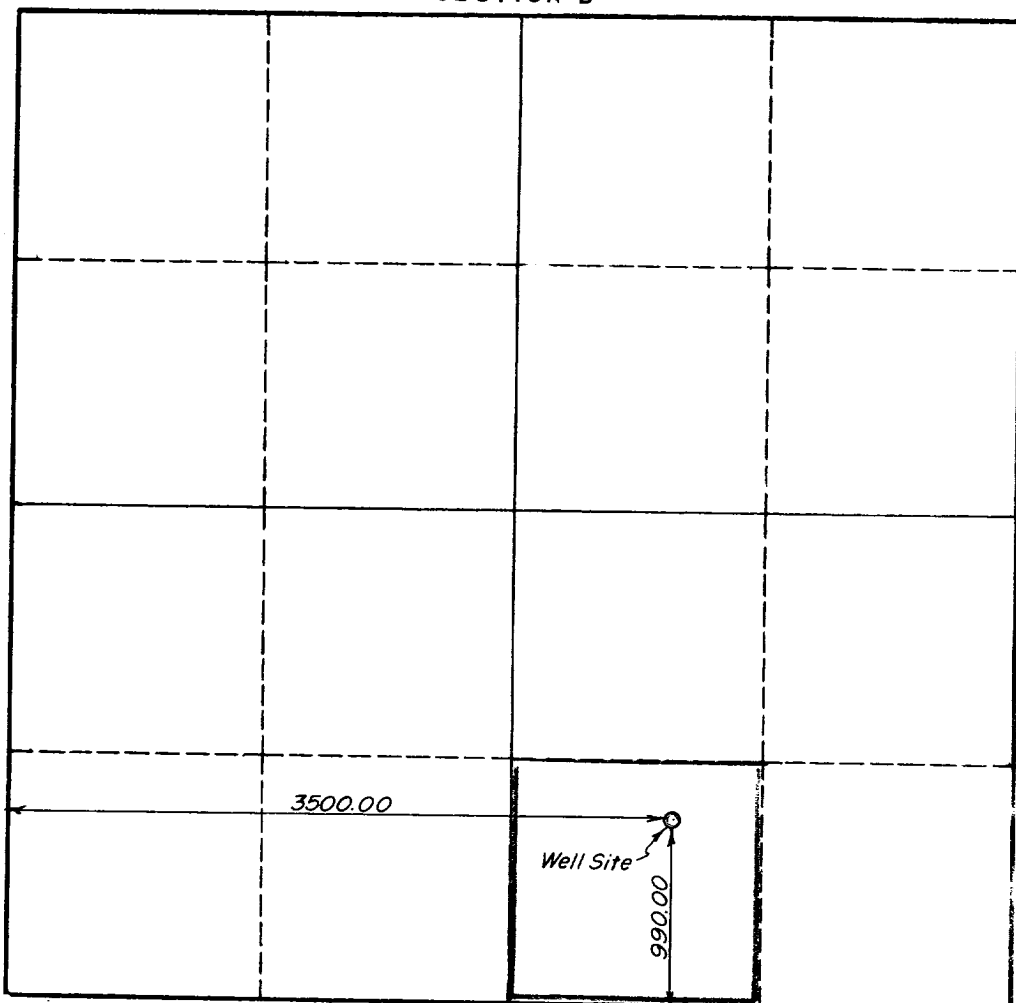

**CERTIFICATION**

I hereby certify that the information in SECTION A above is true and complete to the best of my knowledge and belief.

Name	<b>E. R. Sidwell</b>
Position	<b>Vice President</b>
Company	<b>Sidwell Oil and Gas, Inc.</b>
Date	<b>April 15, 1963</b>

I hereby certify that the well location shown on the plat in SECTION B was plotted from field notes of actual surveys made by me or under my supervision, and that the same is true and correct to the best of my knowledge and belief.

Date Surveyed	<b>March 26, 1963</b>
Registered Professional Engineer and/or Land Surveyor	<i>[Signature]</i>

**N.M.L.S. NO. 1010**  
 Certificate No.

## INSTRUCTIONS FOR COMPLETION OF FORM C-128

1. Operator shall furnish and certify to the information called for in Section A.
2. Operator shall outline the dedicated acreage for *both* oil and gas wells on the plat in Section B.
3. A registered professional engineer or land surveyor registered in the State of New Mexico or approved by the Commission shall show on the plat the location of the well and certify this information in the space provided.
4. All distances shown on the plat must be from the outer boundaries of the Section.
5. If additional space is needed for listing owners and their respective interests as required in question 3 of Section A, please use space below.