

A circular black and white stamp. The word "RECEIVED" is at the top in a bold, sans-serif font. Below it, the date "MAY 17 1966" is stamped. At the bottom, the text "OIL CON. COM." and "DIST. 3" are stamped in two lines.

NEW MEXICO  
OIL CONSERVATION COMMISSION

Form C-128

Well Location and/or Gas Proration Plat

Date **May 16, 1956**

Operator **Sinclair Oil & Gas Company**

Lease **Santa Fe 93 Sand Springs**

Well No. **1 ~~Santa Fe~~ ~~Sand Springs~~** Section **18** Township **17 North** Range **7 West** NMPM

Located **1980** Feet From **South** Line, **660** Feet From **West** Line,

**McKinley** County, New Mexico. G. L. Elevation **Not Yet Available**

Name of Producing Formation \_\_\_\_\_ Pool **Wildcat** Dedicated Acreage **40**

(Note: All distances must be from outer boundaries of Section)

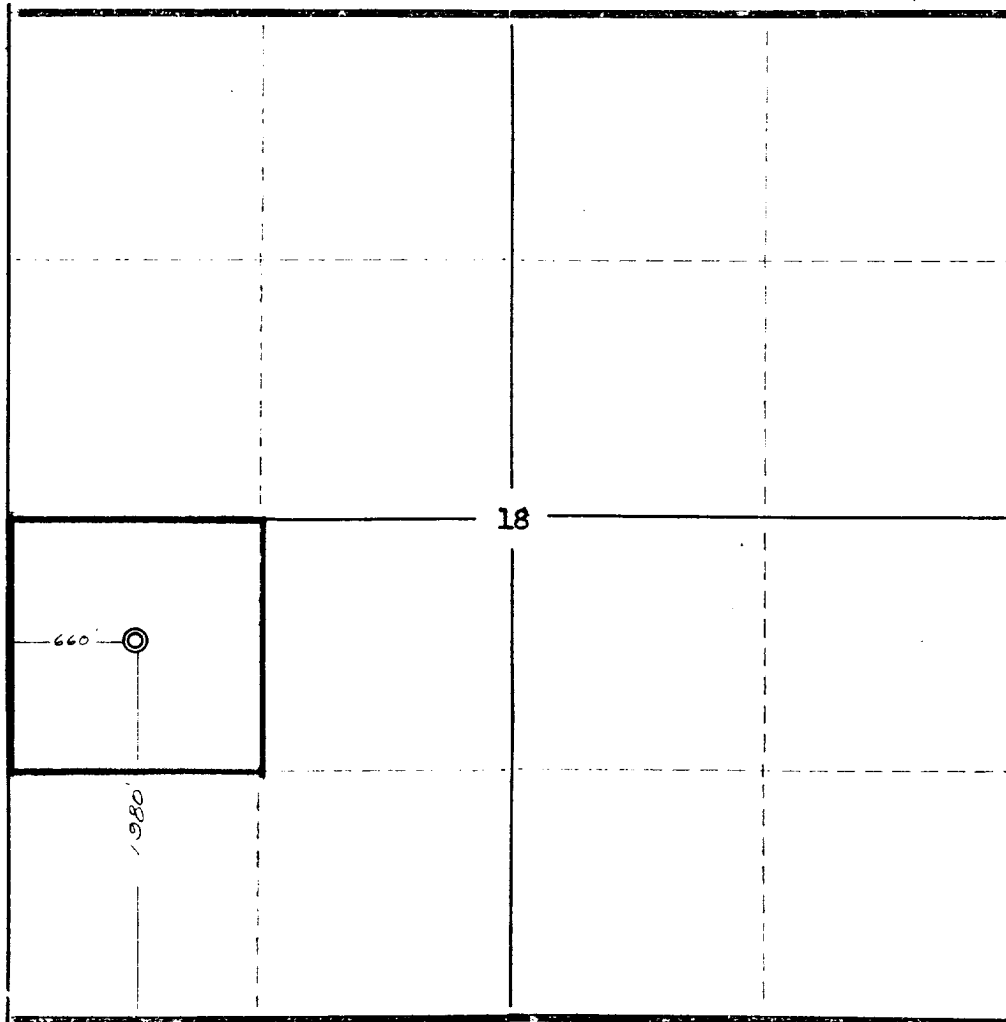

NOTE

This section of form is to be used for gas wells only.



SCALE: 1" = 1000'

1. Is this Well a Dual Comp. ? Yes No
2. If the answer to Question 1 is yes, are there any other dually completed wells within the dedicated acreage?  
Yes No

Name \_\_\_\_\_  
Position \_\_\_\_\_  
Representing \_\_\_\_\_  
Address \_\_\_\_\_

This is to certify that the above plat was prepared from field notes of actual surveys made by me or under my supervision and that the same are true and correct to the best of my knowledge and belief.

Date Surveyed **April 19, 1956**

*Ernest V. Echohawk*  
Ernest V. Echohawk  
Reg. Land Surveyor, N. Mex., Reg. No. 1545

# OIL CONSERVATION COMMISSION

## AZTEC DISTRICT OFFICE

No. Copies Received 5

### DISTRIBUTION

	NO. RECEIVED	
1. Mr. [illegible]	1	
2. Mr. [illegible]	1	
3. Mr. [illegible]		
4. Mr. [illegible]		
5. Mr. [illegible]	2	
6. Mr. [illegible]	1	✓
7. Mr. [illegible]		