

NO. OF COPIES RECEIVED	6
DISTRIBUTION	
SANTA FE	1
FILE	1
U.S.G.S.	2
LAND OFFICE	1
OPERATOR	1

# NEW MEXICO OIL CONSERVATION COMMISSION

Form C-101  
Revised 1-1-65

5A. Indicate Type of Lease STATE <input checked="" type="checkbox"/> FEE <input type="checkbox"/>
5. State Oil & Gas Lease No. Santa Fe 9747
7. Unit Agreement Name
8. Farm or Lease Name Triangle
9. Well No. 1
10. Field and Pool, or Wildcat Wildcat
12. County McKinley
19. Proposed Depth 1800
19A. Formation Gallup
23. Rotary or C.T. Rotary
21. Elevations (Show whether DF, RT, etc.) 6935 Ground
21A. Kind & Status Plug. Bond Single Well
21B. Drilling Contractor Crane Drilling Co.
22. Approx. Date Work will start December 1, 1965

APPLICATION FOR PERMIT TO DRILL, DEEPEN, OR PLUG BACK			
1a. Type of Work b. Type of Well DRILL <input checked="" type="checkbox"/> DEEPEN <input type="checkbox"/> PLUG BACK <input type="checkbox"/> OIL WELL <input checked="" type="checkbox"/> GAS WELL <input type="checkbox"/> OTHER <input type="checkbox"/> SINGLE ZONE <input checked="" type="checkbox"/> MULTIPLE ZONE <input type="checkbox"/>			
2. Name of Operator Stone Drilling, Inc.			
3. Address of Operator 1807 Chaco Ave., Farmington, New Mexico			
4. Location of Well UNIT LETTER 0 LOCATED 1865 FEET FROM THE East LINE AND 345 FEET FROM THE South LINE OF SEC. 8 TWP. 17 N RGE. 9 W NMPM			
23. PROPOSED CASING AND CEMENT PROGRAM			
SIZE OF HOLE	SIZE OF CASING	WEIGHT PER FOOT	SETTING DEPTH
8 3/4	7"	20#	40'
SACKS OF CEMENT EST. TOP			
10 Sax Surface			

Drill 6 1/4" hole w/mud thru Hospah Gallup and run logs

If completion is attempted, set 4 1/2" casing and SOF

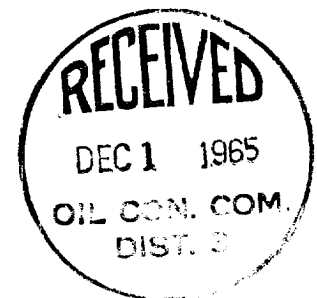

IN ABOVE SPACE DESCRIBE PROPOSED PROGRAM; IF PROPOSAL IS TO DEEPEN OR PLUG BACK, GIVE DATA ON PRESENT PRODUCTIVE ZONE AND PROPOSED NEW PRODUCTIVE ZONE, GIVE BLOWOUT PREVENTER PROGRAM, IF ANY.

I hereby certify that the information above is true and complete to the best of my knowledge and belief.

Signed W. F. Stone Title President Date November 29, 1965

(This space for State Use)

APPROVED BY Emory C. Clavel TITLE Sup Dist TD DATE 12-1-65  
CONDITIONS OF APPROVAL, IF ANY:

**NEW MEXICO OIL CONSERVATION COMMISSION  
WELL LOCATION AND ACREAGE DEDICATION PLAT**

Form C-102  
Supersedes C-128  
Effective 1-1-65

All distances must be from the outer boundaries of the Section.

Operator <b>Stone Drilling Inc.</b>			Lease <b>Triangle</b>		Well No. <b>1</b>
Unit Letter <b>0</b>	Section <b>8</b>	Township <b>17 North</b>	Range <b>9 West</b>	County <b>McKinley</b>	
Actual Footage Location of Well: <b>345</b> feet from the <b>South</b> line and <b>1865</b> feet from the <b>East</b> line					
Ground Level Elev. <b>6935</b>	Producing Formation <b>Hospah Gallup</b>	Pool <b>Wildcat</b>		Dedicated Acreage: <b>40</b> Acres	

1. Outline the acreage dedicated to the subject well by colored pencil or hatchure marks on the plat below.
2. If more than one lease is dedicated to the well, outline each and identify the ownership thereof (both as to working interest and royalty).
3. If more than one lease of different ownership is dedicated to the well, have the interests of all owners been consolidated by communitization, unitization, force-pooling, etc?

☐ Yes    ☐ No    If answer is "yes," type of consolidation \_\_\_\_\_

If answer is "no," list the owners and tract descriptions which have actually been consolidated. (Use reverse side of this form if necessary.) \_\_\_\_\_

No allowable will be assigned to the well until all interests have been consolidated (by communitization, unitization, forced-pooling, or otherwise) or until a non-standard unit, eliminating such interests, has been approved by the Commission.

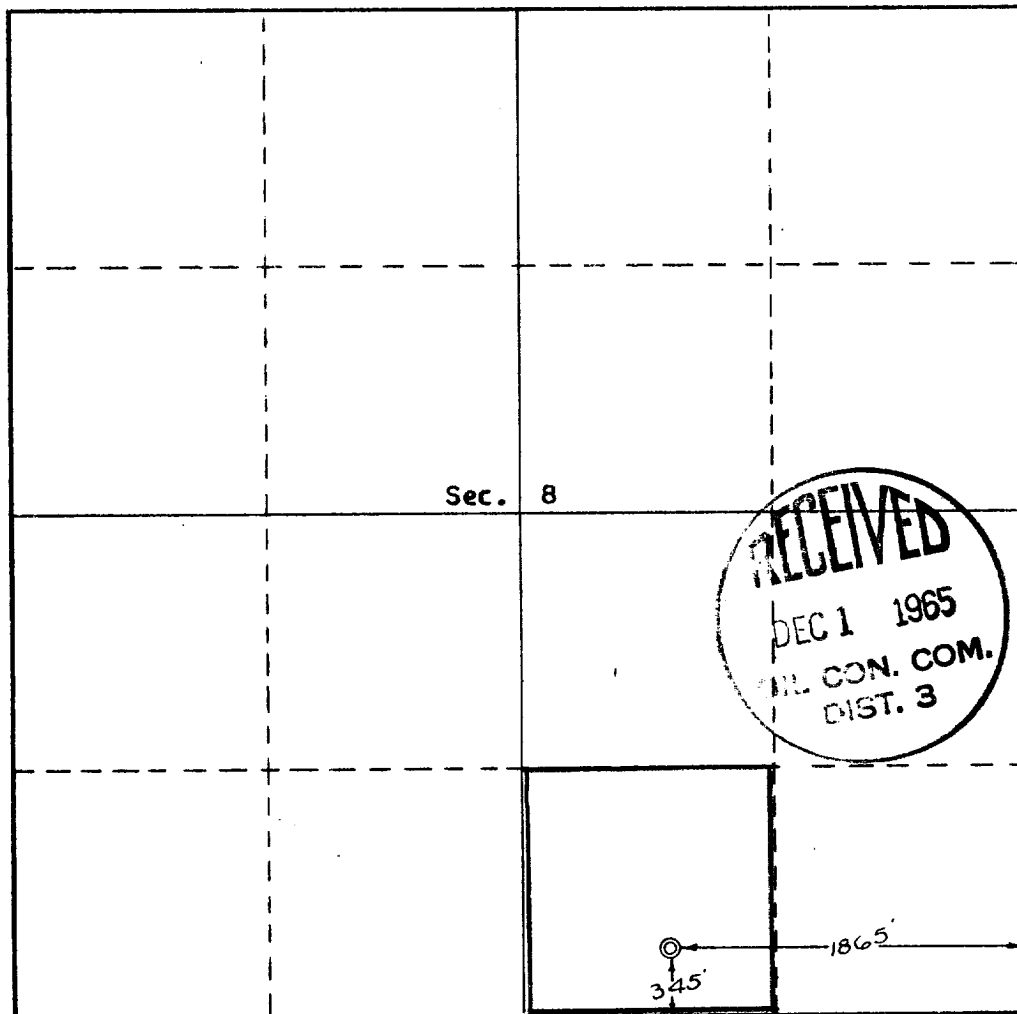

**CERTIFICATION**

I hereby certify that the information contained herein is true and complete to the best of my knowledge and belief.

Name

Position

**President**

Company

**Stone Drilling Inc.**

Date

**November 29, 1965**

I hereby certify that the well location shown on this plat was plotted from field notes of actual surveys made by me or under my supervision, and that the same is true and correct to the best of my knowledge and belief.

Date Surveyed

**November 22, 1965**

Registered Professional Engineer  
and/or Land Surveyor

Certificate No.

**3602**

