

UNITED STATES  
DEPARTMENT OF THE INTERIOR  
GEOLOGICAL SURVEY

SUBMIT IN TRIPLICATE\*  
(Other instructions on  
reverse side)

Form approved.  
Budget Bureau No. 42-R1425.

30-031-20805

APPLICATION FOR PERMIT TO DRILL, DEEPEN, OR PLUG BACK

1a. TYPE OF WORK  
DRILL ☐ DEEPEN ☐ PLUG BACK ☒

b. TYPE OF WELL  
OIL WELL ☒ GAS WELL ☐ OTHER ☐  
SINGLE ZONE ☒ MULTIPLE ZONE ☐

2. NAME OF OPERATOR

Tesoro Petroleum Corporation

3. ADDRESS OF OPERATOR 633 17th Street, Suite 2000

Denver, CO 80202 Telephone: (303) 825-2000

4. LOCATION OF WELL (Report location clearly and in accordance with any State requirements.)

At surface 794' FSL, 576' FWL

At proposed prod. zone

Same

14. DISTANCE IN MILES AND DIRECTION FROM NEAREST TOWN OR POST OFFICE\*

7 Miles South of White Horse Post Office

15. DISTANCE FROM PROPOSED\*

LOCATION TO NEAREST  
PROPERTY OR LEASE LINE, FT.  
(Also to nearest drlg. unit line, if any)

576' FLL

18. DISTANCE FROM PROPOSED LOCATION\*

150' from

TO NEAREST WELL, DRILLING, COMPLETED,  
OR APPLIED FOR, ON THIS LEASE, FT.

Hanson #15

21. ELEVATIONS (Show whether DF, RT, GR, etc.)

6922' KB

PROPOSED CASING AND CEMENTING PROGRAM

SIZE OF HOLE	SIZE OF CASING	WEIGHT PER FOOT	SETTING DEPTH
12 1/4"	8 5/8"	24#	40'
6 3/4"	4 1/2"	?	1544' KB
3 3/4"	Open Hole	-	1569' KB

QUANTITY OF CEMENT  
40 sx (TOC @ Surface)  
100 sx (TOC @ 1000' ±)

The captioned well is currently producing 1.2 BOPD and 5.9 BWPD from the Lower Hospah.  
If the well is recompleted to the Upper Hospah, it should make 10 to 15 BOPD.  
Proposed activities are as follows:

1. Squeeze Lower Hospah with 10 sx cement from 1569' KB to 1540' KB (400% excess).
2. Perforate the Upper Hospah from 1531'-36' KB, 1524'-28' KB, and 1515'-21' KB w/2 JSPF.

IN ABOVE SPACE DESCRIBE PROPOSED PROGRAM: If proposal is to deepen or plug back, give data on present productive zone and proposed new productive zone. If proposal is to drill or deepen directionally, give pertinent data on subsurface locations and measured and true vertical depths. Give blowout preventer program, if any.

24. SIGNED *John Yates* TITLE Production Engineer

DATE 6/22/82

(This space for Federal or State use)

APPROVED

PERMIT NO.

APPROVAL DATE

APPROVED BY

DATE

CONDITIONS OF APPROVAL, IF ANY

JUL 27 1982  
*James F. Sims*  
JAMES F. SIMS  
DISTRICT ENGINEER

NMOCC

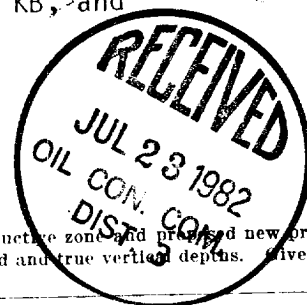

All distances must be from the outer boundaries of the Section

Operator <b>TESORO PETROLEUM CORPORATION</b>			Lease <b>HANSON</b>		Well No. <b>2</b>
Tract Letter <b>M</b>	Section <b>6</b>	Township <b>17N</b>	Range <b>8W</b>	County <b>McKinley</b>	
Actual Footage Location of Well:					
<b>287 794</b> feet from the <b>South</b> line and <b>586 576</b> feet from the <b>West</b> line					
Ground Level Elev. <b>5923 6922</b>	Producing Formation <b>Upper Hespah</b>	Pool <b>South Hespah Upper Sand</b>	Estimated Area in Acres <b>40</b>		

1. Outline the acreage dedicated to the subject well by colored pencil or hatchure marks on the plat below.
2. If more than one lease is dedicated to the well, outline each and identify the ownership thereof (both as to working interest and royalty).
3. If more than one lease of different ownership is dedicated to the well, have the interests of all owners been consolidated by communitization, unitization, force-pooling, etc?

☐ Yes ☐ No If answer is "yes," type of consolidation \_\_\_\_\_

If answer is "no," list the owners and tract descriptions which have actually been consolidated. (Use reverse side of this form if necessary.) \_\_\_\_\_

No allowable will be assigned to the well until all interests have been consolidated (by communitization, unitization, forced-pooling, or otherwise) or until a non-standard unit, eliminating such interests, has been approved by the Commission.

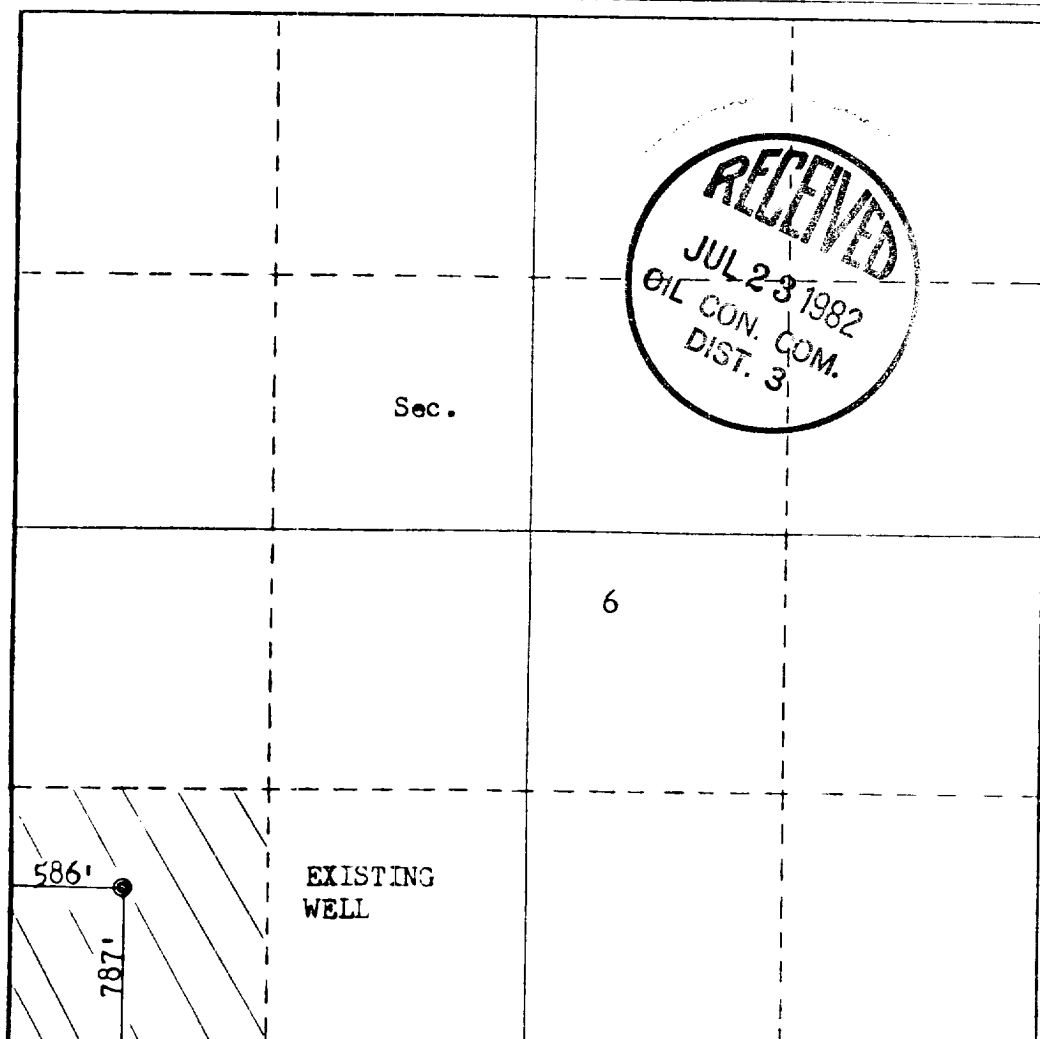

#### CERTIFICATION

I hereby certify that the information contained herein is true and complete to the best of my knowledge and belief.

Name: **Jim Yates**  
Position: **Production Engineer**  
Company: **Tesoro Petroleum Corp.**  
Date: **7/13/82**

I hereby certify that the well location shown on this plat was plotted from field notes of actual surveys made by me or under my supervision, and that the same is true and correct to the best of my knowledge and belief.

Date Surveyed: **June 17, 1982**  
Registered Professional Engineer and/or Land Surveyor  
**Fred B. Kerr Jr.**  
Certificate No. **3950**