

(SUBMIT IN TRIPLICATE)

UNITED STATES
DEPARTMENT OF THE INTERIOR
GEOLOGICAL SURVEY

Land Office Santa Fe, New Mexico
Lease No. NM. 040742
Unit _____

SUNDRY NOTICES AND REPORTS ON WELLS

NOTICE OF INTENTION TO DRILL	SUBSEQUENT REPORT OF WATER SHUT-OFF
NOTICE OF INTENTION TO CHANGE PLANS	SUBSEQUENT REPORT OF SHOOTING OR ACIDIZING
NOTICE OF INTENTION TO TEST WATER SHUT-OFF	SUBSEQUENT REPORT OF ALTERING CASING
NOTICE OF INTENTION TO RE-DRILL OR REPAIR WELL	SUBSEQUENT REPORT OF RE-DRILLING OR REPAIR
NOTICE OF INTENTION TO SHOOT OR ACIDIZE	SUBSEQUENT REPORT OF ABANDONMENT
NOTICE OF INTENTION TO PULL OR ALTER CASING	SUPPLEMENTARY WELL HISTORY
NOTICE OF INTENTION TO ABANDON WELL	

(INDICATE ABOVE BY CHECK MARK NATURE OF REPORT, NOTICE, OR OTHER DATA)

1 October, 1962

Well No. #3 R₁ is located 334' ft. from N line and 1544' ft. from E line of sec. 2

SEL NW1 SEL Act. 2
 41 (1/4 Sec. #1) (Sec. #1)
 (Twp.) 17 N, 11 W (Range) N. M. P. M. (Meridian)
 (Field) McKimby (County or Subdivision) New Mexico (State or Territory)

The elevation of the derrick floor above sea level is 6700' ft.

DETAILS OF WORK

(State names of and expected depths to objective sands; show sizes, weights, and lengths of proposed casings; indicate mudding jobs, cementing points, and all other important proposed work)

[illegible]

the plan to establish the "International Day of the Girl" on the 10th of June. It was decided that the day should be observed in all countries and that the United Nations should declare it. The day was established in 1979 and is now celebrated annually.

I understand that this plan of work must receive approval in writing by the Geological Survey before operations may be commenced.

Company Jorge Serrantonich
Address 131 Valley Drive, Santa Fe, NM.

By Jane Doe
Title operator

NUMBER OF COPIES RECEIVED	
-DISTRIBUTION	
SANTA FE	
FILE	
U.S.G.S.	
LAND OFFICE	
TRANSPORTER	OIL GAS
PRODUCTION OFFICE	
OPERATOR	

NEW MEXICO OIL CONSERVATION COMMISSION
WELL LOCATION AND ACREAGE DEDICATION PLAT
 SEE INSTRUCTIONS FOR COMPLETING THIS FORM ON THE REVERSE SIDE

FORM C-128
Revised 5/1/57

SECTION A

Operator <u>George Seuntovich</u>		Lease <u>NM. 040742</u>		Well No. <u>#3 Pass</u>
Unit Letter <u>---</u>	Section <u>2</u>	Township <u>17 North</u>	Range <u>11 East</u>	County <u>McKinley County, New Mexico</u>
Actual Footage Location of Well: <u>3314</u> feet from the <u>North</u> line and <u>1544</u> feet from the <u>East</u> line of Section 2				
Ground Level Elev. <u>6700'</u>	Producing Formation <u>Musgrave?</u>	Pool <u>Wildcat</u>	Dedicated Acreage: <u>40</u> Acres	

1. Is the Operator the only owner in the dedicated acreage outlined on the plat below? YES X NO ---. ("Owner" means the person who has the right to drill into and to produce from any pool and to appropriate the production either for himself or for himself and another. (65-3-29 (e) NMSA 1935 Comp.)
2. If the answer to question one is "no," have the interests of all the owners been consolidated by communization agreement or otherwise? YES --- NO ---. If answer is "yes," Type of Consolidation ---
3. If the answer to question two is "no," list all the owners and their respective interests below:

Owner <u>George Seuntovich</u>	Land Description <u>Site located in Section 2, T.17 N., R.11 E., N.M.P.M.</u>
<u>121 Valley Drive, Santa Fe, New Mexico</u>	

RECEIVED
 JAN 20 1963
 U.S. GEOLOGICAL SURVEY
 NEW MEXICO

SECTION B

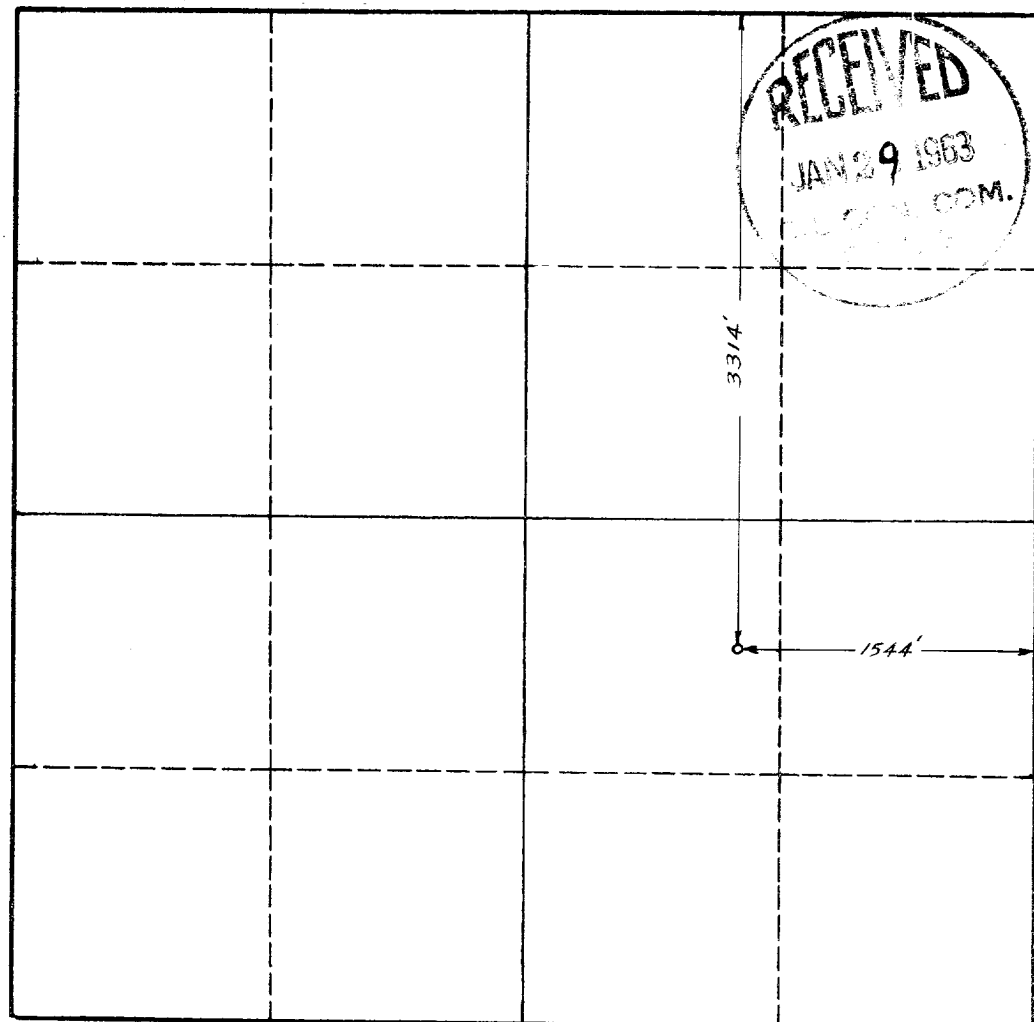

CERTIFICATION

I hereby certify that the information in SECTION A above is true and complete to the best of my knowledge and belief.

Name <u>George Seuntovich</u>
Position <u>Owner</u>
Company <u>Same as -</u>
Date <u>1 October, 1962</u>

I hereby certify that the well location shown on the plat in SECTION B was plotted from field notes of actual surveys made by me or under my supervision, and that the same is true and correct to the best of my knowledge and belief.

Date Surveyed <u>November 27, 1962</u>
Registered Professional Engineer and/or Land Surveyor <u>Edmund Ross</u>
Certificate No. <u>81</u>

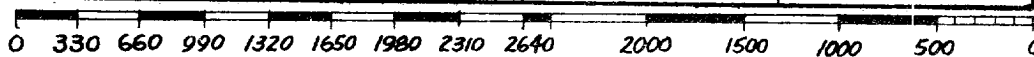

INSTRUCTIONS FOR COMPLETION OF FORM C-128

1. Operator shall furnish and certify to the information called for in Section A.
2. Operator shall outline the dedicated acreage for *both* oil and gas wells on the plat in Section B.
3. A registered professional engineer or land surveyor registered in the State of New Mexico or approved by the Commission shall show on the plat the location of the well and certify this information in the space provided.
4. All distances shown on the plat must be from the outer boundaries of the Section.
5. If additional space is needed for listing owners and their respective interests as required in question 3 of Section A, please use space below.