

Submit 3 Copies  
to Appropriate  
District Office

State of New Mexico  
Energy, Minerals and Natural Resources Department

Form C-103  
Revised 1-1-89

DISTRICT I  
P.O. Box 1980, Hobbs, NM 88240

DISTRICT II  
P.O. Drawer DD, Artesia, NM 88210

DISTRICT III  
1000 Rio Brazos Rd., Aztec, NM 87410

OIL CONSERVATION DIVISION  
P.O. Box 2088  
Santa Fe, New Mexico 87504-2088

WELL API NO.

5. Indicate Type of Lease

STATE ☐

FEE ☒

6. State Oil & Gas Lease No.

SUNDRY NOTICES AND REPORTS ON WELLS  
(DO NOT USE THIS FORM FOR PROPOSALS TO DRILL OR TO DEEPEN OR PLUG BACK TO  
DIFFERENT RESERVOIR. USE "APPLICATION FOR PERMIT"  
(FORM C-101) FOR SUCH PROPOSALS.)

1. Type of Well:

OIL  
WELL ☒

GAS  
WELL ☐

OTHER ☐

2. Name of Operator

American Exploration Company

3. Address of Operator

1331 Lamar, Suite 900, Houston, Texas 77010-3088

4. Well Location

Unit Letter B : 660 Feet From The

NORTH  
South

Line and

3330

Feet From The

EAST  
West

Line

Section 1

Township 17N

Range 9W

NMPM

McKinley

County

10. Elevation (Show whether DF, RKB, RT, GR, etc.)

6639 GL

11.

Check Appropriate Box to Indicate Nature of Notice, Report, or Other Data

NOTICE OF INTENTION TO:

PERFORM REMEDIAL WORK ☐

PLUG AND ABANDON ☐

TEMPORARILY ABANDON ☐

CHANGE PLANS ☐

PULL OR ALTER CASING ☐

OTHER: Deepen well to Lower Hospah ☐

SUBSEQUENT REPORT OF:

REMEDIAL WORK ☐

ALTERING CASING ☐

COMMENCE DRILLING OPNS. ☐

PLUG AND ABANDONMENT ☐

CASING TEST AND CEMENT JOB ☐

OTHER: ☐

12. Describe Proposed or Completed Operations (Clearly state all pertinent details, and give pertinent dates, including estimated date of starting any proposed work) SEE RULE 1103.

MIRU WOR, POH w/tbg., rods & pump. GIH w/bit & clean out to TD @ 1575'.  
POH. GIH w/pkr. to 1500'. Press. test csg. POH. RIH w/120' 4-1/2"  
liner. Set liner @ TD w/TOL @ 1455'. Cmt. liner w/25 sx. cmt. Rel.  
from TOL & rev. clean. GIH w/6-1/4" bit, clean out and drill 2' new hole.  
POH. GIH w/pkr. on tbg. Swab test csg. shoe, sq. as necessary. POH.  
PU bit & continue drlg. Deepen to 10' below top of Lower Hospah.

I hereby certify that the information above is true and complete to the best of my knowledge and belief.

SIGNATURE

Marty B. McClanahan

TITLE

Sr. Regulatory

Analyst

DATE

7/30/92

TYPE OR PRINT NAME

TELEPHONE NO.

(This space for State Use)

APPROVED BY

Eric Beale

TITLE

DATE

AUG 21 1992

CONDITIONS OF APPROVAL, IF ANY:

Submit to Appropriate  
District Office  
State Lease - 4 copies  
Fee Lease - 3 copies

State of New Mexico  
Energy, Minerals and Natural Resources Department

Form C-102  
Revised 1-1-89

OIL CONSERVATION DIVISION

P.O. Box 2088

Santa Fe, New Mexico 87504-2088

DISTRICT I  
P.O. Box 1980, Hobbs, NM 88240

DISTRICT II  
P.O. Drawer DD, Artesia, NM 88210

DISTRICT III  
1000 Rio Brazos Rd., Aztec, NM 87410

WELL LOCATION AND ACREAGE DEDICATION PLAT

All Distances must be from the outer boundaries of the section

Operator American Exploration Company			Lease Hospah Sand Unit		Well No. 51
Unit Letter B	Section 1	Township 17N	Range 9W	County McKinley	
Actual Footage Location of Well: 660 feet from the <u>NORTH</u> line and <u>3330</u> feet from the <u>EAST</u> line					
Ground level Elev. 6639	Producing Formation Hospah Lower Sand		Pool Hospah Lower Sand <u>EXT</u>		Dedicated Acreage: 40 Acres

1. Outline the acreage dedicated to the subject well by colored pencil or hatchure marks on the plat below.
2. If more than one lease is dedicated to the well, outline each and identify the ownership thereof (both as to working interest and royalty).
3. If more than one lease of different ownership is dedicated to the well, have the interest of all owners been consolidated by communitization, unitization, force-pooling, etc.?  
☐ Yes ☐ No If answer is "yes" type of consolidation \_\_\_\_\_

If answer is "no" list the owners and tract descriptions which have actually been consolidated. (Use reverse side of this form if necessary.)

No allowable will be assigned to the well until all interests have been consolidated (by communitization, unitization, forced-pooling, or otherwise) or until a non-standard unit, eliminating such interest, has been approved by the Division.

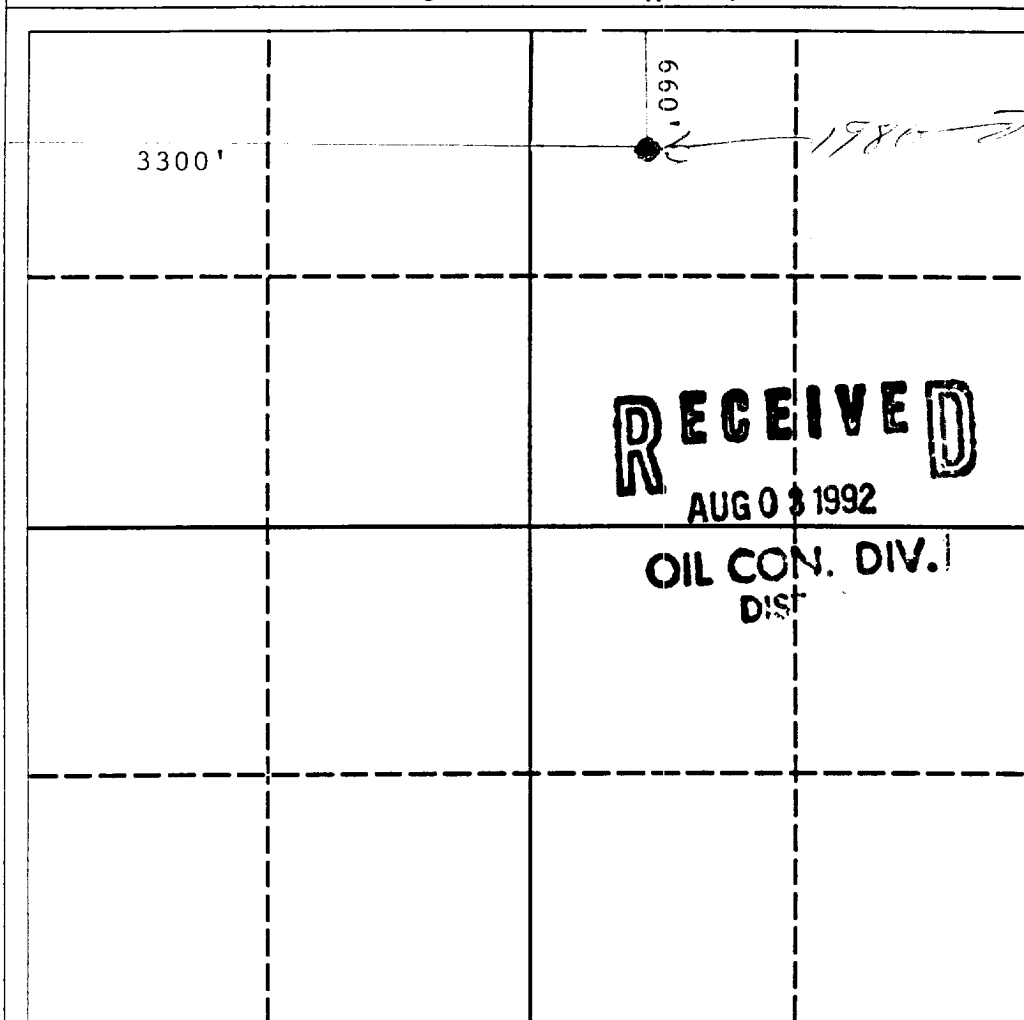

OPERATOR CERTIFICATION

I hereby certify that the information contained herein is true and complete to the best of my knowledge and belief.

Marty B. McClanahan  
Signature

Marty B. McClanahan  
Printed Name

Sr. Regulatory Analyst  
Position

Sr. Regulatory Analyst  
Position

American Exploration Co  
Company

July 29, 1992  
Date

SURVEYOR CERTIFICATION

I hereby certify that the well location shown on this plat was plotted from field notes of actual surveys made by me or under my supervision, and that the same is true and correct to the best of my knowledge and belief.

Date Surveyed

Signature & Seal of  
Professional Surveyor

Certificate No.

0 330 660 990 1320 1650 1980 2310 2640 2000 1500 1000 500 0