

(SUBMIT IN TRIPLICATE)

UNITED STATES
DEPARTMENT OF THE INTERIOR
GEOLOGICAL SURVEY

Indian Agency Window Rock
Allottee Navajo
Lease No. 14-20-603-67

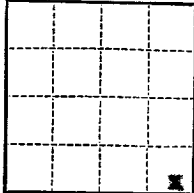

SUNDRY NOTICES AND REPORTS ON WELLS

NOTICE OF INTENTION TO DRILL	<input checked="" type="checkbox"/>	SUBSEQUENT REPORT OF WATER SHUT-OFF	
NOTICE OF INTENTION TO CHANGE PLANS		SUBSEQUENT REPORT OF SHOOTING OR ACIDIZING	
NOTICE OF INTENTION TO TEST WATER SHUT-OFF		SUBSEQUENT REPORT OF ALTERING CASING	
NOTICE OF INTENTION TO REDRILL OR REPAIR WELL		SUBSEQUENT REPORT OF REDRILLING OR REPAIR	
NOTICE OF INTENTION TO SHOOT OR ACIDIZE		SUBSEQUENT REPORT OF ABANDONMENT	
NOTICE OF INTENTION TO PULL OR ALTER CASING		SUPPLEMENTARY WELL HISTORY	
NOTICE OF INTENTION TO ABANDON WELL			

(INDICATE ABOVE BY CHECK MARK NATURE OF REPORT, NOTICE, OR OTHER DATA)

January 2, 1958

Well No. Navajo "B"-1 is located 330 ft. from SW line and 330 ft. from E line of sec. 32
SE SE SE Sec. 32 18 N 16 W N10W
 (1/4 Sec. and Sec. No.) (Twp.) (Range) (Meridian)
Coyote Canyon Area McKinley New Mexico
 (Field) (County or Subdivision) (State or Territory)

The elevation of the ~~surface~~ ^{ground} above sea level is 6695 ft.

DETAILS OF WORK

(State names of and expected depths to objective sands; show sizes, weights, and lengths of proposed casings; indicate mudding jobs, cementing points, and all other important proposed work)

Propose to drill well to test test Water Sand, a member of Morrison Formation, at about 3000'. Will set about 150' of 10-3/4" surface casing with cement circulated to surface.

Will set 7" 20# casing on top of or through any commercial production encountered.

USGS (4)
State (2)
Boeh
Fraser
Maurer
Knapp
Smith
File

I understand that this plan of work must receive approval in writing by the Geological Survey before operations may be commenced.

Company The Superior Oil Co.

Address Box 276
Cortez, Colorado

By Geo. E. Nugent
 Title Engineer

NEW MEXICO OIL CONSERVATION COMMISSION
Well Location and Acreage Dedication Plat

Section A.

Date January 2, 1958

Operator THE SUPERIOR OIL COMPANY Lease NAVAJO
Well No. K-1 Unit Letter P Section 32 Township 18 NORTH Range 16 WEST NMPM
Located 330 Feet From the SOUTH Line, 330 Feet From the EAST Line
County McKINLEY G. L. Elevation 6695.0 Dedicated Acreage SE/4 SE/4 40 Acres
Name of Producing Formation _____ Pool Wildcat

1. Is the Operator the only owner* in the dedicated acreage outlined on the plat below?
Yes ☒ No ☐.
2. If the answer to question one is "no," have the interests of all the owners been consolidated by communitization agreement or otherwise? Yes ☐ No ☐. If answer is "yes," Type of Consolidation _____
3. If the answer to question two is "no," list all the owners and their respective interests below:

Ref: GLO plat dated 3 August 1935

Owner

Land Description

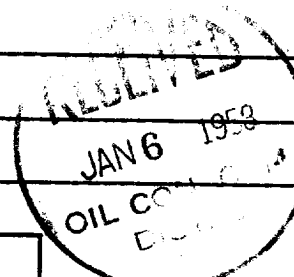

Section B

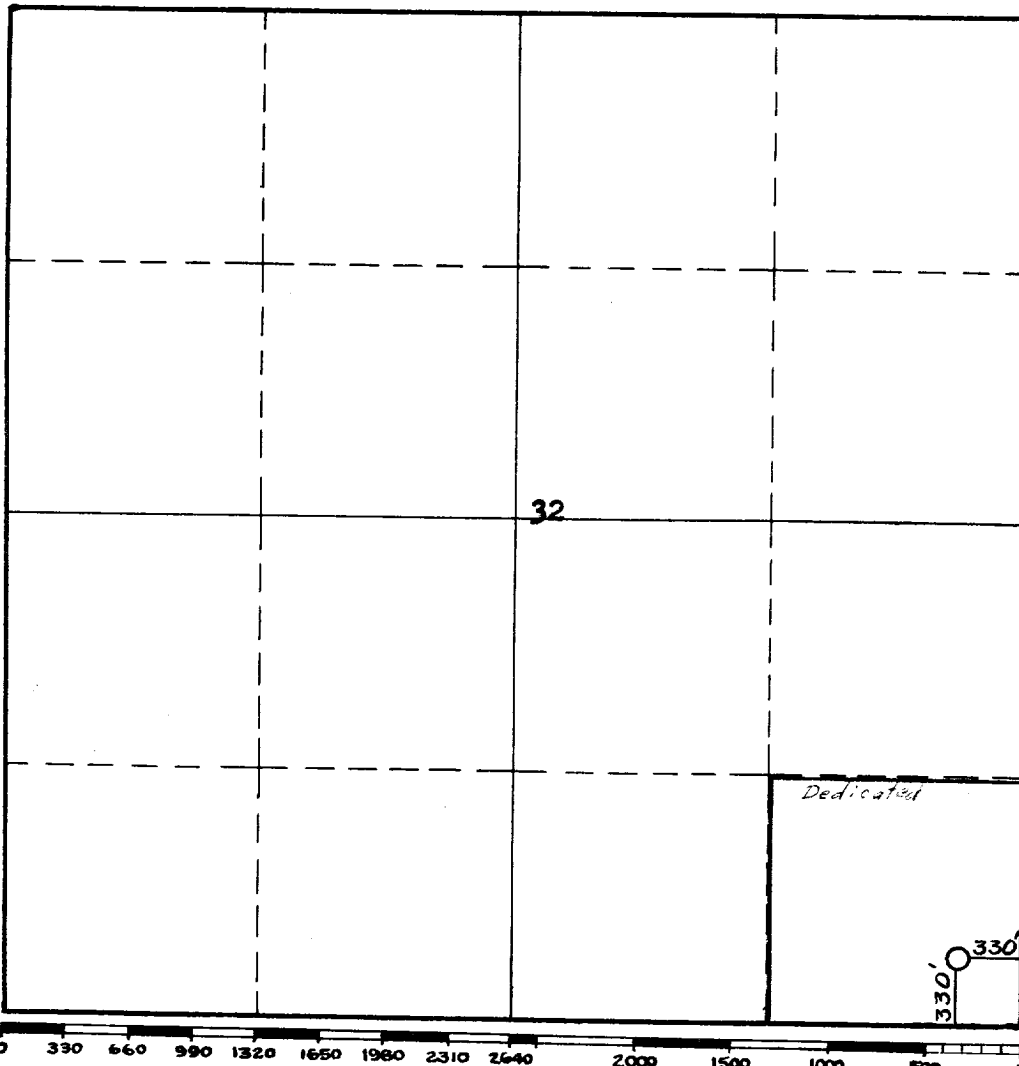

This is to certify that the information in Section A above is true and complete to the best of my knowledge and belief.

The Superior Oil Co.
(Operator)

Geo. C. Nugent
(Representative)

Box 276 Cortez, Colo.
Address

This is to certify that the well location shown on the plat in Section B was plotted from field notes of actual surveys made by me or under my supervision and that the same is true and correct to the best of my knowledge and belief.

Date Surveyed 29 December 1957

James P. Leese
Registered Professional
Engineer and/or Land Surveyor.

James P. Leese

Certificate No. 1463

(See instructions for completing this form on the reverse side)

INSTRUCTIONS FOR COMPLETION:

1. Operator shall furnish and certify to the information called for in Section A.
2. Operator shall outline the dedicated acreage for both oil and gas wells on the plat in Section B.
3. A registered professional engineer or land surveyor registered in the State of New Mexico or approved by the Commission shall show on the plat the location of the well and certify this information in the space provided.
4. All distances shown on the plat must be from the outer boundaries of Section.
5. If additional space is needed for listing owners and their respective interests as required in question 3, Section A, please use space below

* "Owner" means the person who has the right to drill into and to produce from any pool and to appropriate the production either for himself or for himself and another. (65-3-29 (e) NMSA 1953 Comp.)