

NEW MEXICO OIL CONSERVATION COMMISSION
Santa Fe, New Mexico

NOTICE OF INTENTION TO DRILL OR RECOMPLETE

Notice must be given to the District Office of the Oil Conservation Commission and approval obtained before drilling or recompletion begins. If changes in the proposed plan are considered advisable, a copy of this notice showing such changes will be returned to the sender. Submit this notice in **QUINTUPPLICATE**. One copy will be returned following approval. See additional instructions in Rules and Regulations of the Commission. **If State Land submit 6 Copies**

Denver, Colorado

(Place)

June 5, 1956

(Date)

OIL CONSERVATION COMMISSION
SANTA FE, NEW MEXICO

Gentlemen:

You are hereby notified that it is our intention to commence the (Drilling) (~~Recompletion~~) of a well to be known as

Sinclair Oil & Gas Company

(Company or Operator)

Santa Fe 88 Buck

(Lease)

Well No. **1**, in **51st** The well is

located **1980** feet from the **South** line and **660** feet from the

West

line of Section **8**, T. **18-N**, R. **9-W**, NMPM.

(GIVE LOCATION FROM SECTION LINE) **Wildcat** Pool, **McKinley** County

D	C	B	A
E	F	G	H
L	K	J	I
M	N	O	P

If State Land the Oil and Gas Lease is No.....

If patented land the owner is **Patented**

Address.....

We propose to drill well with drilling equipment as follows: **Rotary Tools**

The status of plugging bond is **Statewide Bond**

Drilling Contractor **Rotary Tools. Contract not yet awarded.**

We intend to complete this well in the **Gallup Formation** formation at an approximate depth of **2550** feet.

CASING PROGRAM

We propose to use the following strings of Casing and to cement them as indicated:

Size of Hole	Size of Casing	Weight per Foot	New or Second Hand	Depth	Sacks Cement
12-1/4"	8-5/8"	32#	New	100	150
7-7/8"	5-1/2"	20#	New	2550	200

If changes in the above plans become advisable we will notify you immediately.

ADDITIONAL INFORMATION (If recompletion give full details of proposed plan of work.)

Approved..... **6-6**, 19**56**
Except as follows:

Sincerely yours,

Sinclair Oil & Gas Company
(Company or Operator)

By **G. L. Weger** *G. L. Weger*

Position **Asst. Div. Supt. - Production Dept.**

Send Communications regarding well to

Name **J. A. Jackman**

Address **601 Denver Club Bldg., Denver, Colorado**

OIL CONSERVATION COMMISSION

By *Ernest C. [Signature]*



NEW MEXICO
OIL CONSERVATION COMMISSION

Form C-128

Well Location and/or Gas Proration Plat

Date **June 5, 1956**

Operator **Sinclair Oil & Gas Company**

Lease **Santa Fe 88 Buck**

Well No. **1 Santa Fe Buck** Section **8** Township **18 North** Range **9 West** NMPM

Located **1930** Feet From **South** Line, **660** Feet From **West** Line,

McKinley County, New Mexico. G. L. Elevation **Not Yet Available**

Name of Producing Formation _____ Pool **Wildcat** Dedicated Acreage **40**

(Note: All distances must be from outer boundaries of Section)

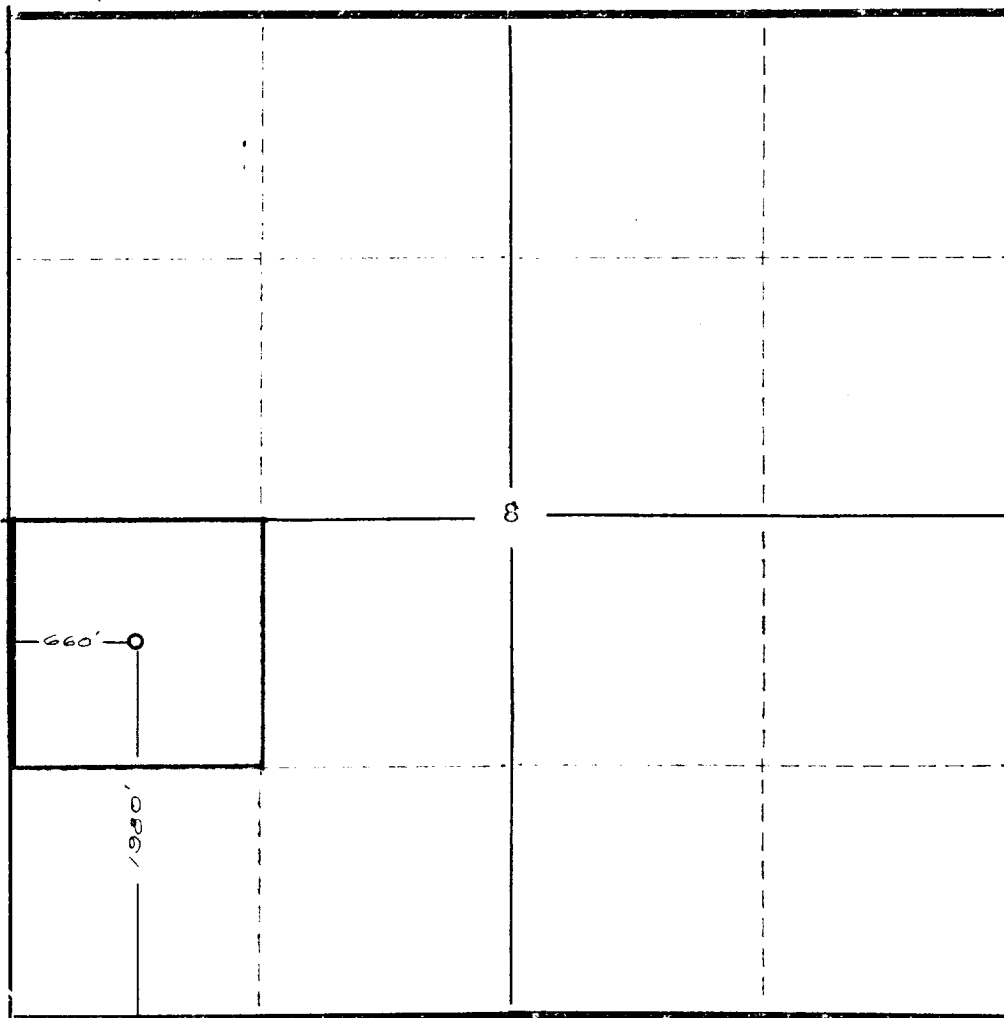

SCALE: 1" 1000'

NOTE

This section of form is to be used for gas wells only.



1. Is this Well a Dual Comp. ? Yes No
2. If the answer to Question 1 is yes, are there any other dually completed wells within the dedicated acreage?
Yes No

Name _____
Position _____
Representing _____
Address _____

This is to certify that the above plat was prepared from field notes of actual surveys made by me or under my supervision and that the same are true and correct to the best of my knowledge and belief.

Date Surveyed **April 23, 1956**

Ernest V. Echshawk

Ernest V. Echshawk
Reg. Land Surveyor, N. Mex., Reg. No. 1545

OIL CONSERVATION COMMISSION		
AZTEC DISTRICT OFFICE		
No. Copies Received		5
DISTRIBUTION		
	FILED	
Operator	1	
Santa Fe	1	
Proration Office		
State Land Office		
U. S. G. S.	2	
Transporter		
File	1	✓