

NEW MEXICO OIL CONSERVATION COMMISSION
Santa Fe, New Mexico

Form C-101
Revised (12/1/55)

NOTICE OF INTENTION TO DRILL

Notice must be given to the District Office of the Oil Conservation Commission and approval obtained before drilling or recompletion begins. If changes in the proposed plan are considered advisable, a copy of this notice showing such changes will be returned to the sender. Submit this notice in QUINTUPPLICATE. One copy will be returned following approval. See additional instructions in Rules and Regulations of the Commission. If State Land submit 6 Copies Attach Form C-128 in triplicate to first 3 copies of form C-101

Farmington, New Mexico
(Place)

December 22, 1960
(Date)

OIL CONSERVATION COMMISSION
SANTA FE, NEW MEXICO

Gentlemen:

You are hereby notified that it is our intention to commence the Drilling of a well to be known as

Harry Leyman

(Company or Operator)

Sinclair-Santa Fe
(Lease)

Well No. 1, in A. The well is

located 620 feet from the north line and 755 feet from the east. Line of Section 28, T. 19N, R. 6W, NMPM.

(GIVE LOCATION FROM SECTION LINE) Wildcat Pool, McKinley County

If State Land the Oil and Gas Lease is No.

If patented land the owner is Santa Fe Railroad

Address Los Angeles, California

We propose to drill well with drilling equipment as follows: Rotary tools from surface to T.D.

The status of plugging bond is ~~Sinclair-Santa Fe~~

Drilling Contractor Century Drilling Co.

We intend to complete this well in the Dakota formation at an approximate depth of 4242 feet.

CASING PROGRAM

We propose to use the following strings of Casing and to cement them as indicated:

Size of Hole	Size of Casing	Weight per Foot	New or Second Hand	Depth	Sacks Cement
13-1/4"	10-3/4"	---	New	92	75
8-3/4"	7-7/8"	---	New	2217	200

If changes in the above plans become advisable we will notify you immediately.

ADDITIONAL INFORMATION (If recompletion give full details of proposed plan of work.)

Propose to drill with mud to 2217', set 7-7/8" casing, then drill with air to T.D.

Approved
Except as follows:

2-15, 1961

Sincerely yours,

Harry Leyman

(Company or Operator)

By Harrell Budd

Position Consulting Geologist

Send Communications regarding well to

Name Harrell Budd

Address 211 1/2 West Main Street
Farmington, New Mexico

OIL CONSERVATION COMMISSION

By



NEW MEXICO OIL CONSERVATION COMMISSION
Well Location and Acreage Dedication Plat

Section A.

Date September 29, 1960

Operator Leyman Corporation Lease Sinclair Santa Fe
Well No. 1 Unit Letter A Section 28 Township 19 North Range 6 West NMPM
Located 617 Feet From North Line, 755 Feet From East Line
County McKinley G. L. Elevation 6937 Dedicated Acreage 40 Acres
Name of Producing Formation _____ Pool _____

1. Is the Operator the only owner* in the dedicated acreage outlined on the plat below?
Yes _____ No X.
2. If the answer to question one is "no," have the interests of all the owners been consolidated by communitization agreement or otherwise? Yes X No _____. If answer is "yes," Type of Consolidation _____
3. If the answer to question two is "no," list all the owners and their respective interests below:

Owner

Land Description

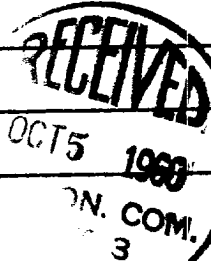

Section B

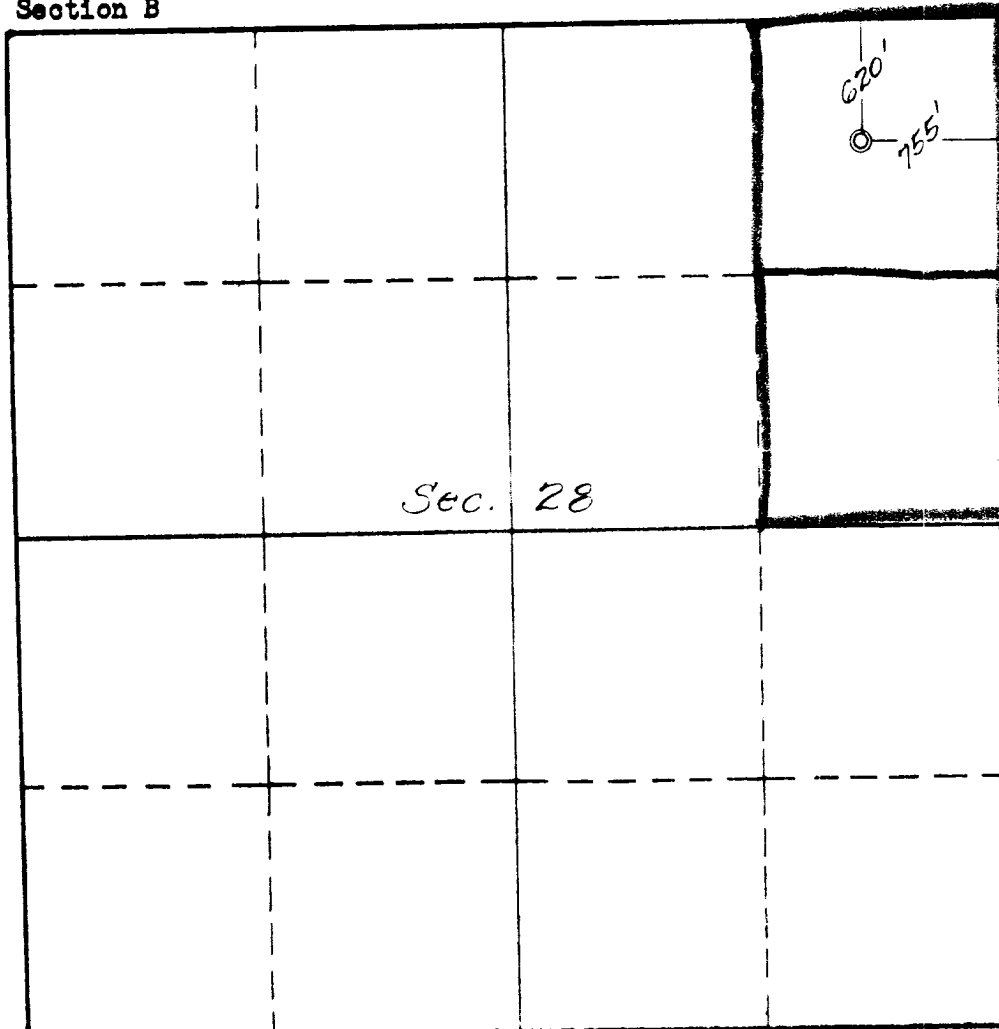

This is to certify that the information in Section A above is true and complete to the best of my knowledge and belief.

Leyman Corp.
(Operator)

Geo. G. Johnson
(Representative)

Redwood Lodge
Address Hamington N. Mex.

This is to certify that the well location shown on the plat in Section B was plotted from field notes of actual surveys made by me or under my supervision and that the same is true and correct to the best of my knowledge and belief.

Date Surveyed Sept. 26-27, 1960

C. L. Tateet
Registered Professional
Engineer and/or Land Surveyor.

Certificate No. 3084

17/11/71

over