

NEW MEXICO OIL CONSERVATION COMMISSION
Santa Fe, New Mexico

Form G-101
Revised (12/1/55)

NOTICE OF INTENTION TO DRILL

Notice must be given to the District Office of the Oil Conservation Commission and approval obtained before drilling or recompletion begins. If changes in the proposed plan are considered advisable, a copy of this notice showing such changes will be returned to the sender. Submit this notice in QUINTUPLICATE. One copy will be returned following approval. See additional instructions in Rules and Regulations of the Commission. Attach Form G-128 in duplicate to this notice. 3 copies of form G-101

Star Lake, Mc Kinley Co, N.M.

(Place)

(Date)

OIL CONSERVATION COMMISSION
SANTA FE, NEW MEXICO

Gentlemen:

You are hereby notified that it is our intention to commence the Drilling of a well to be known as

~~Reynolds & Burke Balknap-Santa Fe 1-13~~

(Company, or Operator)

660 (Lease) East Well No. 1, in 1960. The well is

located South feet from the 15 line and 6-W feet from the

Section 15, T. 19-N, R. 6-W NMPM.

(GIVE LOCATION FROM SECTION LINE) Mc Kinley, N.M. Pool, County

If State Land the Oil and Gas Lease is No. Santa Fe Railroad

If patented land the owner is Los Angeles, Calif.

Address

We propose Rotary Drilling equipment as follows:

Otto V. Reynolds

The status of plugging bond is

Drilling Contractor Apache Drilling Co.

Minnefo Section of Mesa-verde.

We intend to complete this well in the Also to test Gallop
formation at an approximate depth of at about 3500, feet.

CASING PROGRAM

We propose to use the following strings of Casing and to cement them as indicated:

Size of Hole	Size of Casing	Weight per Foot	New or Second Hand	Depth	Sacks Cement
9 5/8	9 5/8	28	New	200	80
7 7/8	4 1/2	9 lb	New	3200 ?	Circulate

If changes in the above plans become advisable we will notify you immediately.

ADDITIONAL INFORMATION (If recompletion give full details of proposed plan of work.)

Approved 2-17, 1960
Except as follows:

OIL CONSERVATION COMMISSION

By

Since Otto V. Reynolds

By Otto Reynolds (Company or Operator)

Position Owner

Name Otto Reynolds Send Communications regarding well to

Address Bloomfield, N.M.

OIL CONSERVATION COMMISSION		
AZTEC DISTRICT OFFICE		
No. Copies Received <u>5</u>		
DISTRIBUTION		
	NO. FURNISHED	
Director	1	
Asst. Dir.	1	
Education Office		
State Land Office		
U. S. G. S.	2	
Transporter		
File	1	<input checked="" type="checkbox"/>

NEW MEXICO OIL CONSERVATION COMMISSION
Well Location and Acreage Dedication Plat

Section A.

Date February 17, 1960

Operator Otto Reynolds Lease Otto Reynolds & Burke Sollman Santa Fe 1-13
Well No. 1-13 Unit Letter I Section 13 Township 19 North Range 6 West NMPM
Located 660 Feet From East Line, 1960 Feet From South Line
County McKinley G. L. Elevation 6767 Dedicated Acreage 40 Acres
Name of Producing Formation Hospiak Gallup Pool Wildcat

1. Is the Operator the only owner* in the dedicated acreage outlined on the plat below?
Yes _____ No X.
2. If the answer to question one is "no," have the interests of all the owners been consolidated by communitization agreement or otherwise? Yes X No _____. If answer is "yes," Type of Consolidation _____
3. If the answer to question two is "no," list all the owners and their respective interests below:

Owner

Land Description

_____	_____
_____	_____
_____	_____

Section B

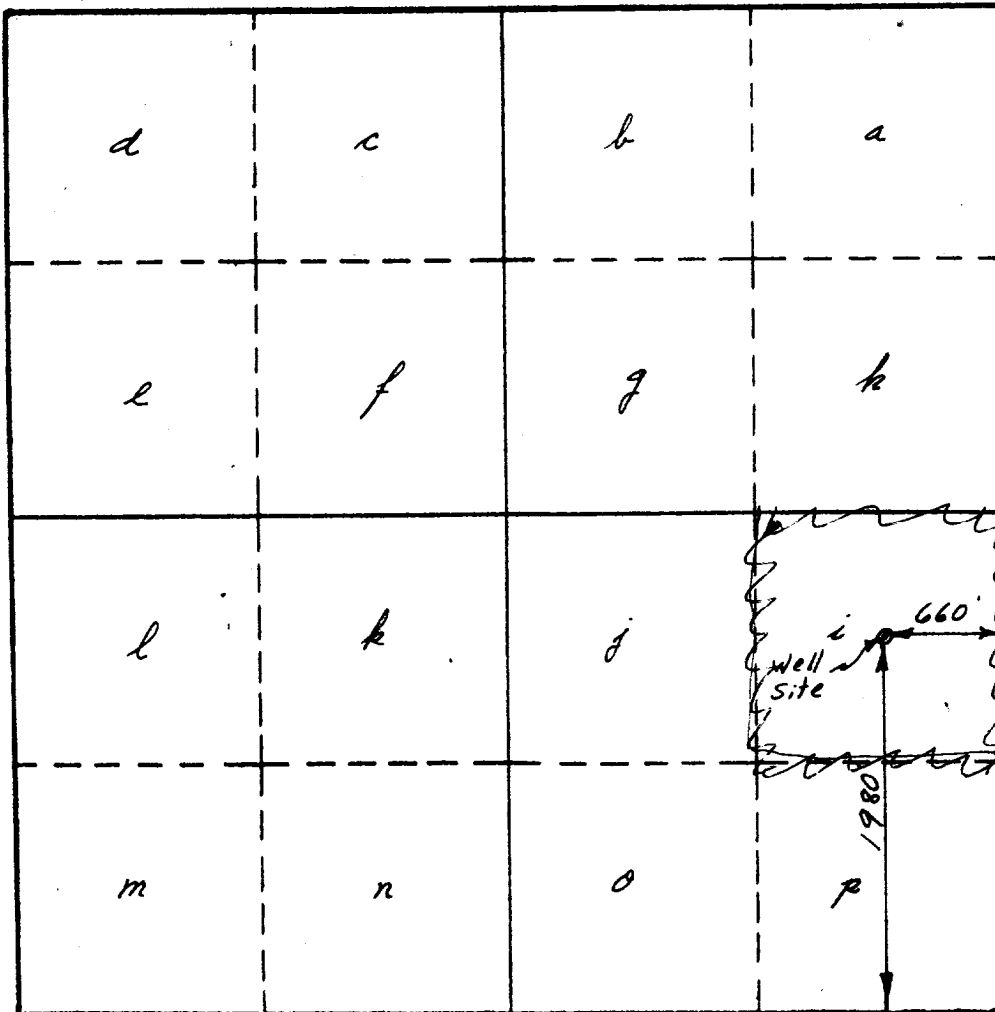

This is to certify that the information in Section A above is true and complete to the best of my knowledge and belief.

Otto Reynolds

(Operator)

Otto Reynolds
(Representative)

Bloomfield, New Mexico

Address

This is to certify that the well location shown on the plat in Section B was plotted from field notes of actual surveys made by me or under my supervision and that the same is true to the best of my knowledge and belief.

Date Surveyed February 17, 1960
[Signature]
Registered Professional
Engineer and Land Surveyor

Certificate No. 204