

NEW MEXICO OIL CONSERVATION COMMISSION

Santa Fe, New Mexico

NOTICE OF INTENTION TO DRILL OR RECOMPLETE

Notice must be given to the District Office of the Oil Conservation Commission and approval obtained before drilling or recompletion begins. If changes in the proposed plan are considered advisable, a copy of this notice showing such changes will be returned to the sender. Submit this notice in QUINTUPLICATE. One copy will be returned following approval. See additional instructions in Rules and Regulations of the Commission.

If State Land submit 6 Copies

Denver 2, Colorado
(Place)

August 29, 1956
(Date)

OIL CONSERVATION COMMISSION
SANTA FE, NEW MEXICO

Gentlemen:

You are hereby notified that it is our intention to commence the (Drilling) (~~Recompletion~~) of a well to be known as

Sinclair Oil & Gas Company

(Company or Operator)

Santa Fe 190 North Buck

(Lease)

Well No. **1**, in **19N** The well is

(Unit)

located **1980** feet from the **East line** line and **1980** feet from the

South line

Line of Section **8**, T. **19N**, R. **9W**, NMPM.

(GIVE LOCATION FROM SECTION LINE) **Wildcat** Pool, **McKinley** County

If State Land the Oil and Gas Lease is No.

If patented land the owner is **Patented**

Address

We propose to drill well with drilling equipment as follows: **Rotary Tools**

The status of plugging bond is **Statewide**

Drilling Contractor **Contract not yet awarded**

We intend to complete this well in the **Hempden-Gallup** formation at an approximate depth of **3000** feet.

CASING PROGRAM

We propose to use the following strings of Casing and to cement them as indicated:

Size of Hole	Size of Casing	Weight per Foot	New or Second Hand	Depth	Sacks Cement
12-1/4"	8-5/8"	24#	N	30	30
7-7/8"	5-1/2"	15.5#	N	3000	275

If changes in the above plans become advisable we will notify you immediately.

ADDITIONAL INFORMATION (If recompletion give full details of proposed plan of work.)

Approved
Except as follows:

8-31, 19 **56**

OIL CONSERVATION COMMISSION

By

Sincerely yours,

Sinclair Oil & Gas Company
(Company or Operator)

By **G.L. Weger**

Position **Asst. Div. Supt. - Prod. Dept.**

Send Communications regarding well to

Name **J.A. Jackson**

Address **601 Denver Club Bldg., Denver, Colo.**



AZTEC DISTRICT OFFICE

No. Copies Received 5

DISTRIBUTION

	NO. FURNISHED	
Operator		
Santa Fe	<u>1</u>	
Proration Office	<u>1</u>	
State Land Office		
U. S. G. S.		
Transportation	<u>2</u>	
File	<u>1</u>	<input checked="" type="checkbox"/>

NEW MEXICO
OIL CONSERVATION COMMISSION

Form C-128

Well Location and/or Gas Proration Plat

Date August 29, 1956

Operator Sinclair Oil & Gas Company

Lease Santa Fe 190 North Bank

Well No. 1 ~~1000~~ Section 8 Township 19 North Range 9 West NMPM

Located 1980 Feet From South Line, 1980 Feet From East Line,

McKinley County, New Mexico. G. L. Elevation 6589

Name of Producing Formation _____ Pool Wildcat Dedicated Acreage 40

(Note: All distances must be from outer boundaries of Section)

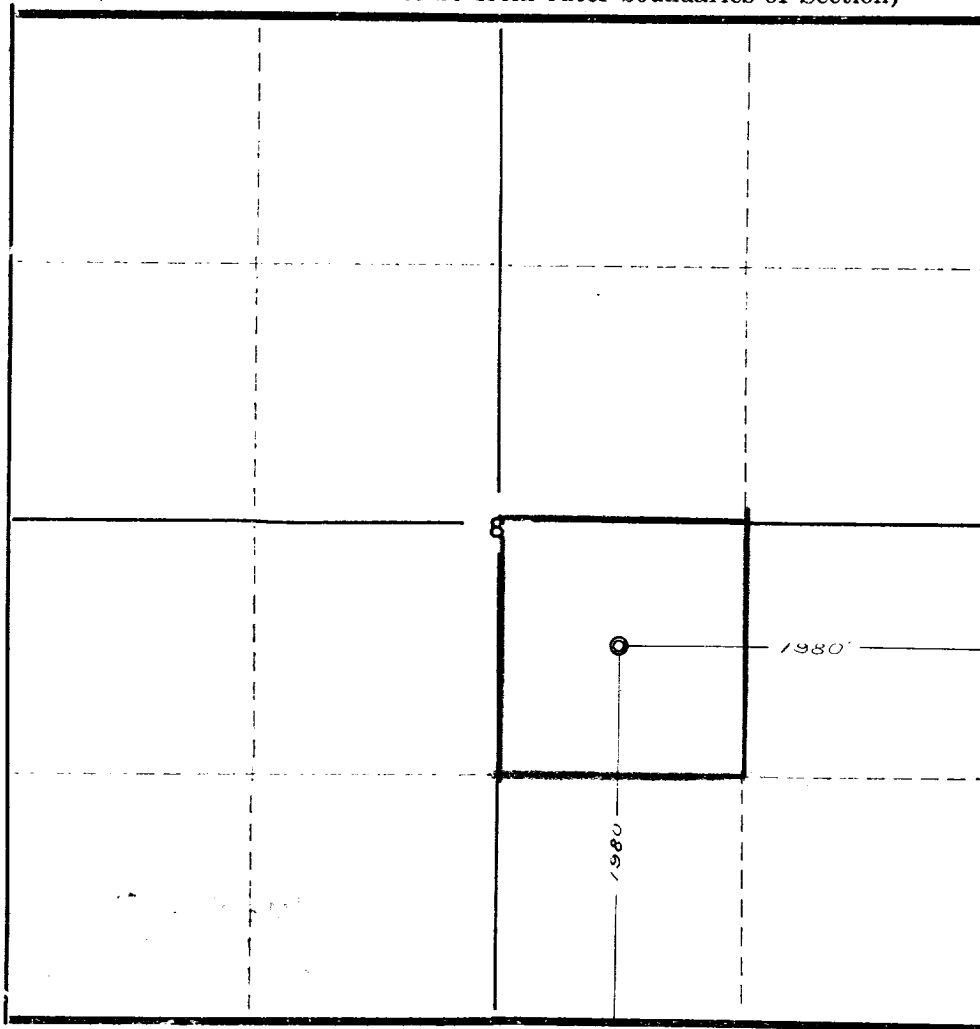

NOTE

This section of form is to be used for gas wells only.

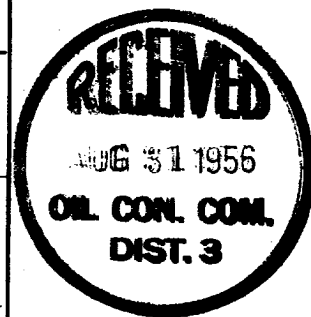

SCALE: 1" = 1000'

1. Is this Well a Dual Comp. ? Yes No
2. If the answer to Question 1 is yes, are there any other dually completed wells within the dedicated acreage?
Yes No

Name _____
Position _____
Representing _____
Address _____

This is to certify that the above plat was prepared from field notes of actual surveys made by me or under my supervision and that the same are true and correct to the best of my knowledge and belief.

Date Surveyed August 23, 1956

Ernest V. Echohawk

Ernest V. Echohawk
Reg. Land Surveyor, N. Mex., Reg. No. 1545

DISTRICT OFFICE
No. Copies Received 5

DISTRIBUTION

	NO. FURNISHED	
Operator	1	
Santa Fe	1	
Proration Office		
State Land Office		
U. S. G. S.	2	
Transporter		
File	1	✓