

NEW MEXICO OIL CONSERVATION COMMISSION
Santa Fe, New Mexico

Form C-101
Revised (12/1/55)

NOTICE OF INTENTION TO DRILL

Notice must be given to the District Office of the Oil Conservation Commission and approval obtained before drilling or recompletion begins. If changes in the proposed plan are considered advisable, a copy of this notice showing such changes will be returned to the sender. Submit this notice in QUINTUPLICATE. One copy will be returned following approval. See additional instructions in Rules and Regulations of the Commission. If State Land submit 6 Copies Attach Form C- 128 in triplicate to first 3 copies of form C-101

P. O. Box 394, Albuquerque, N.M.

(Place)

9 Dec., 1958

(Date)

OIL CONSERVATION COMMISSION
SANTA FE, NEW MEXICO

Gentlemen:

You are hereby notified that it is our intention to commence the Drilling of a well to be known as
CHACO OIL CO.

(Company or Operator)

Santa Fe Pac RR Co.

(Lease)

Well No. 29-19

in

(Unit)

The well is

located 100 feet from the north line and 1300 feet from the east line of Section 29, T. 20 N., R. 9 E., NMPM.

(GIVE LOCATION FROM SECTION LINE)

Red Mountain

Pool,

McKinley

County

If State Land the Oil and Gas Lease is No.

If patented land the owner is Santa Fe Pac R R

Address 4549 Produce Place, Los Angeles 58, Calif.

We propose to drill well with drilling equipment as follows:

Mayhew 1000 rig, mounted on F-800 Ford truck

The status of plugging bond is on file in Santa Fe

Drilling Contractor O. L. Ray Drilling Co.

Box 536, Grants, N.M.

We intend to complete this well in the Menefee

formation at an approximate depth of 470 feet.

CASING PROGRAM

We propose to use the following strings of Casing and to cement them as indicated:

Size of Hole	Size of Casing	Weight per Foot	New or Second Hand	Depth	Sacks Cement
4 1/2"	2"	2.7#	new	470	15

If changes in the above plans become advisable we will notify you immediately.

ADDITIONAL INFORMATION (If recompletion give full details of proposed plan of work.)

Pay zone will be cored; if oil pay is present, pump barrel, and tail pipe will be run on 2" pipe cemented, and perforated for slim-hole completion.

Permission for unorthodox location granted by NMOC Order 7-1-96

Approved
Except as follows:

12-15, 1958

Sincerely yours,

Chaco Oil Co.

(Company or Operator)

By

Henry J. Bridges

Position CO-OWNER

Send Communications regarding well to

Name P.O. Box 394, Albuquerque, N.M.

Address

OIL CONSERVATION COMMISSION

By

OIL CONSERVATION COMMISSION		
ADJEC DISTRICT OFFICE		
NO. 1001		
DATE		
...	1	
...	1	
...		
...		
...		
...	2	
Transporter		
File	1	✓

NEW MEXICO OIL CONSERVATION COMMISSION
Well Location and Acreage Dedication Plat

Section A.

Date 8 Dec., 1953

Operator CHACO OIL CO. Lease Santa Fe Pacific RR # 9426
Well No. 29-19 Unit Letter B Section 29 Township 20N Range 9E NMPM
Located 100 Feet From north Line, 1300 Feet From east Line
County McKinley G. L. Elevation _____ Dedicated Acreage see reverse Acres
Name of Producing Formation Menefee Pool Red Mountain

1. Is the Operator the only owner* in the dedicated acreage outlined on the plat below?
Yes X No _____.
2. If the answer to question one is "no," have the interests of all the owners been consolidated by communitization agreement or otherwise? Yes _____ No _____. If answer is "yes," Type of Consolidation _____
3. If the answer to question two is "no," list all the owners and their respective interests below:

Owner

Land Description

Section B

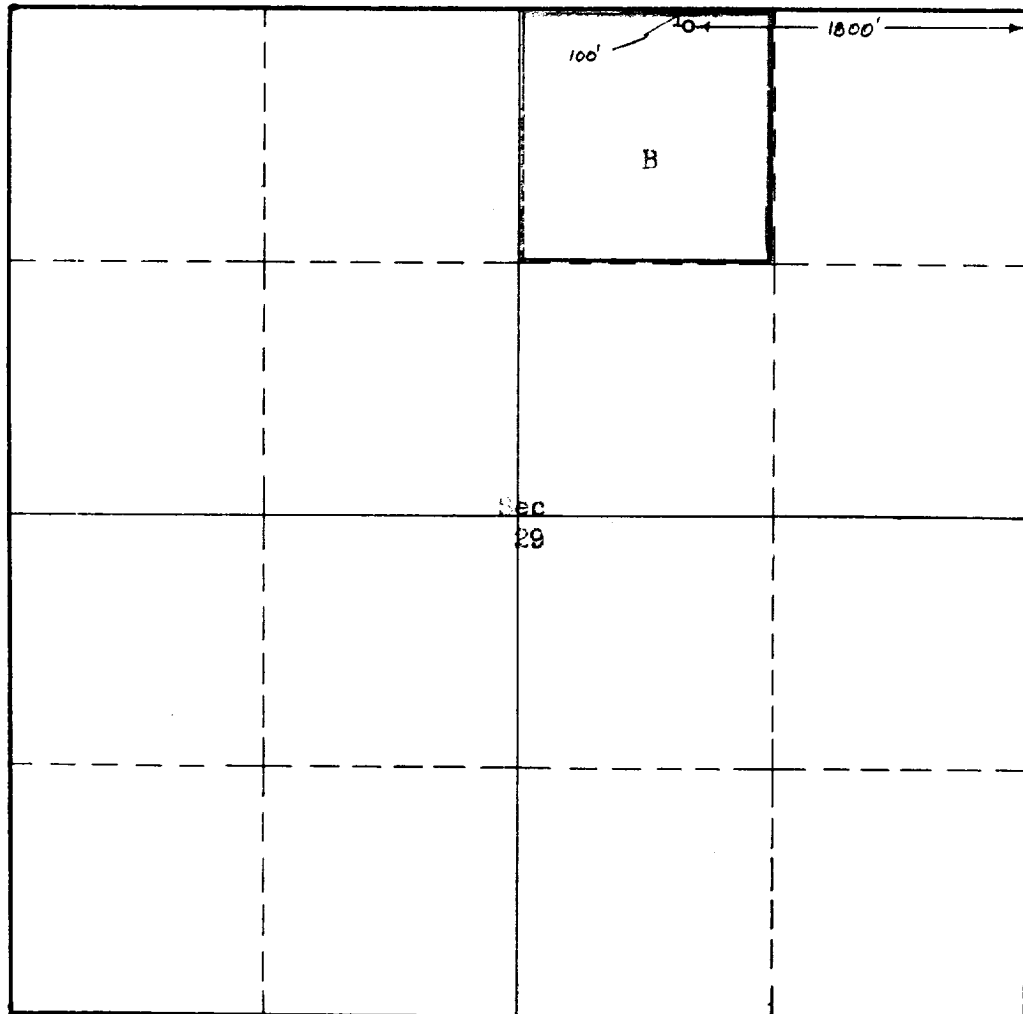

This is to certify that the information in Section A above is true and complete to the best of my knowledge and belief.

CHACO OIL CO.

(Operator)

H. S. Birdseye

(Representative)

Pox 8394, Albuquerque, N.M.

Address

This is to certify that the well location shown on the plat in Section B was plotted from field notes of actual surveys made by me or under my supervision and that the same is true and correct to the best of my knowledge and belief.

Date Surveyed 8 Dec., 1953

Henry S. Birdseye
Registered Professional
Engineer and/or Land Surveyor.

Auth: 67-21-2 NMCA 1953
Certificate No. _____

(See instructions for completing this form on the reverse side)

INSTRUCTIONS FOR COMPLETION:

1. Operator shall furnish and certify to the information called for in Section A.
2. Operator shall outline the dedicated acreage for both oil and gas wells on the plat in Section B.
3. A registered professional engineer or land surveyor registered in the State of New Mexico or approved by the Commission shall show on the plat the location of the well and certify this information in the space provided.
4. All distances shown on the plat must be from the outer boundaries of Section.
5. If additional space is needed for listing owners and their respective interests as required in question 3, Section A, please use space below

NOTE: Authority for Unorthodox Location granted by RMCCC Order E-1493

STATE OF NEW MEXICO COMMISSION		
LAND AND MINERAL RIGHTS OFFICE		
Operator		
Owner		
Surveyor		
Production Office		
State Land Office		
U. S. M. S.		
Transporter		
File		

* "Owner" means the person who has the right to drill into and to produce from any pool and to appropriate the production either for himself or for himself and another. (65-3-29 (e) NMSA 1953 Comp.)