

NUMBER OF COPIES RECEIVED		3
DISTRIBUTION		
SANTA FE	1	1
FILE	1	1
U.S.G.	2	
LANE	1	
TRANSPORTER		
OIL		
GAS		
PRODUCTION OFFICE		
OPERATOR	1	

NEW MEXICO OIL CONSERVATION COMMISSION
Santa Fe, New Mexico

Form C-101
Revised (12/1/55)

NOTICE OF INTENTION TO DRILL

Notice must be given to the District Office of the Oil Conservation Commission and approval obtained before drilling or recompletion begins. If changes in the proposed plan are considered advisable, a copy of this notice showing such changes will be returned to the sender. Submit this notice in QUINTUPLICATE. One copy will be returned following approval. See additional instructions in Rules and Regulations of the Commission. If State Land submit 6 Copies Attach Form C-128 in triplicate to first 3 copies of form C-101

Farmington, New Mexico

September 22, 1961

OIL CONSERVATION COMMISSION
SANTA FE, NEW MEXICO

Gentlemen:

You are hereby notified that it is our intention to commence the Drilling of a well to be known as

Scanlon & Shepard

(Company or Operator)

Santa Fe R.R. Company

(Lease)

Well No. 5

in P

(Unit)

The well is

located 990 feet from the South line and 330 feet from the

East

line of Section 21

T. 20N

R. 9W

NMPM.

(GIVE LOCATION FROM SECTION LINE)

Wildcat

Pool,

McKinley

County

If State Land the Oil and Gas Lease is No.

If patented land the owner is Santa Fe R. R. Company

Address Los Angeles, California

We propose to drill well with drilling equipment as follows:

The status of plugging bond is Blanket Bond

Drilling Contractor Self

We intend to complete this well in the Ghaera

formation at an approximate depth of 320 feet.

CASING PROGRAM

We propose to use the following strings of Casing and to cement them as indicated:

Size of Hole	Size of Casing	Weight per Foot	New or Second Hand	Depth	Sacks Cement
7"	6 5/8"	7	Used	30	5
6"	4"	9	Used	312	10

If changes in the above plans become advisable we will notify you immediately.

ADDITIONAL INFORMATION (If recompletion give full details of proposed plan of work.)

Approved
Except as follows:

10-30, 19 61

Sincerely yours,

Scanlon-Shepard

(Company or Operator)

By R. J. Scanlon

Position

Owner Communications regarding well to

Name

R. J. Scanlon

Address

Box 601, Farmington, New Mexico

OIL CONSERVATION COMMISSION

By Emery C. Covel

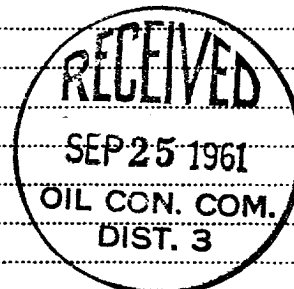

NUMBER OF COPIES RECEIVED	
DISTRIBUTION	
SANTA FE	
FILE	
LAND OFFICE	
TRANSPORTER	OIL GAS
PRODUCTION OFFICE	
OPERATOR	

NEW MEXICO OIL CONSERVATION COMMISSION
WELL LOCATION AND ACREAGE DEDICATION PLAT
SEE INSTRUCTIONS FOR COMPLETING THIS FORM ON THE REVERSE SIDE

FORM C-128
Revised 5/1/57

SECTION A

Operator Scanlon-Shepard		Lease Santa Fe R.R. Company		Well No. 45
Unit Letter P	Section 21	Township 20N	Range 9W	County McKinley
Actual Footage Location of Well: 990 feet from the South line and 330 feet from the East line				
Ground Level Elev. 6408	Producing Formation Chacra	Pool Wildcat	Dedicated Acreage: SE SE 40 Acres	

1. Is the Operator the only owner in the dedicated acreage outlined on the plat below? YES ☒ NO ☐ . ("Owner" means the person who has the right to drill into and to produce from any pool and to appropriate the production either for himself or for himself and another. (65-3-29 (e) NMSA 1935 Comp.)

2. If the answer to question one is "no," have the interests of all the owners been consolidated by communitization agreement or otherwise? YES ☐ NO ☐ . If answer is "yes," Type of Consolidation _____

3. If the answer to question two is "no," list all the owners and their respective interests below:

Owner	Land Description



SECTION B

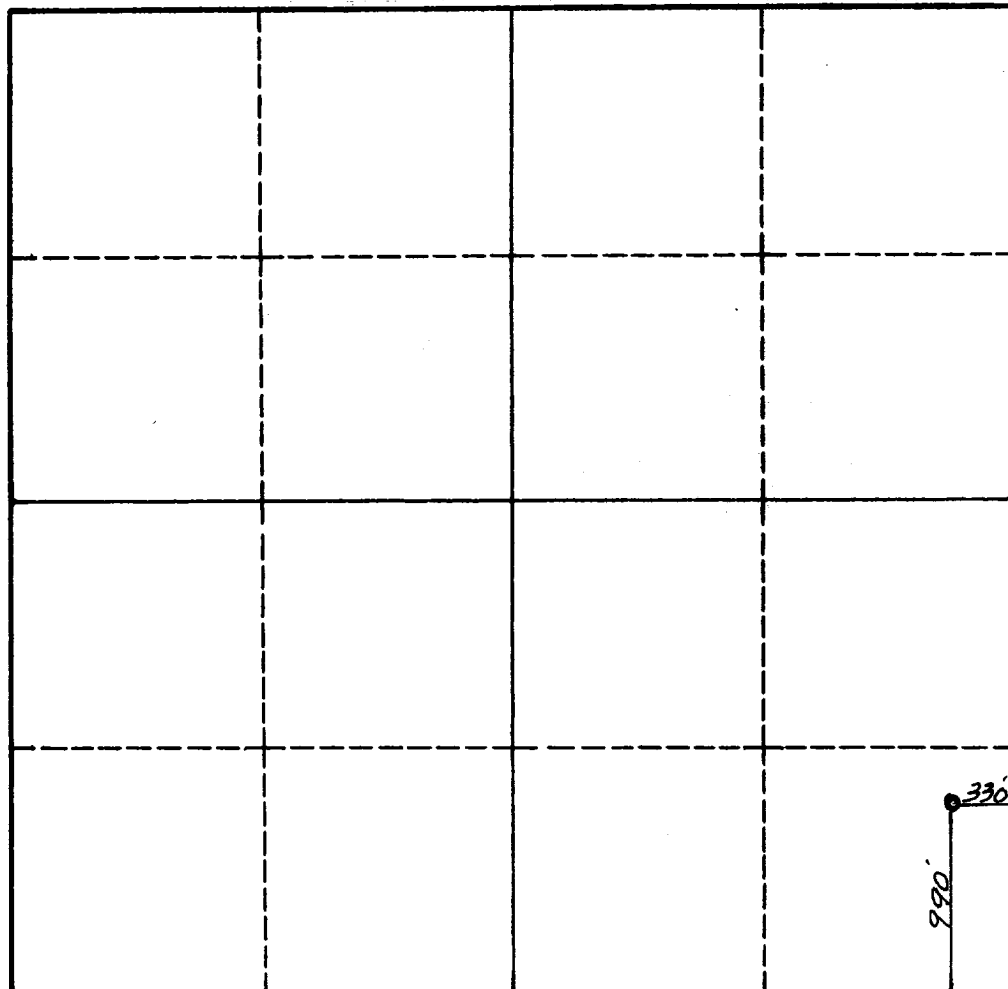

I hereby certify that the information in SECTION A above is true and complete to the best of my knowledge and belief.

Name R. J. Scanlon
Position Owner
Company Scanlon & Shepard
Date September 22, 1961

I hereby certify that the well location shown on the plat in SECTION B was plotted from field notes of actual surveys made by me or under my supervision, and that the same is true and correct to the best of my knowledge and belief.

Date Surveyed September 17, 1961
Registered Professional Engineer and/or Land Surveyor R. J. Scanlon
Certificate No. 1457

0 330 660 990 1320 1650 1980 2310 2640 2000 1500 1000 500 0