

UNITED STATES
DEPARTMENT OF THE INTERIOR
GEOLOGICAL SURVEY

APPLICATION FOR PERMIT TO DRILL, DEEPEN, OR PLUG BACK

1a. TYPE OF WORK

DRILL ☐DEEPEN ☐PLUG BACK ☐

b. TYPE OF WELL

OIL
WELL ☐GAS
WELL ☐OTHER **Re-Entry**SINGLE
ZONE ☐MULTIPLE
ZONE ☒

2. NAME OF OPERATOR

Basin Fuels, Incorporated (Ph 505/325-1702)

3. ADDRESS OF OPERATOR

152 Petroleum Center Bldg., Farmington, New Mexico 87401

4. LOCATION OF WELL (Report location clearly and in accordance with any State requirements.*)

At surface

660' FSL, 660' FZL

At proposed prod. zone

Same

14. DISTANCE IN MILES AND DIRECTION FROM NEAREST TOWN OR POST OFFICE*

20 Miles SE Counselor, N.M., 5 Miles West Ojo Encino School

15. DISTANCE FROM PROPOSED*

LOCATION TO NEAREST

PROPERTY OR LEASE LINE, FT.

(Also to nearest drlg. unit line, if any)

660 ft.

16. NO. OF ACRES IN LEASE

16017. NO. OF ACRES ASSIGNED
TO THIS WELL**40 if oil; 160 if gas**

18. DISTANCE FROM PROPOSED LOCATION*

TO NEAREST WELL, DRILLING, COMPLETED,
OR APPLIED FOR, ON THIS LEASE, FT.**1320 ft.**

19. PROPOSED DEPTH

3000'

20. ROTARY OR CABLE TOOLS

Rotary

21. ELEVATIONS (Show whether DF, RT, GR, etc.)

DF 6751', GL 6745'

22. APPROX. DATE WORK WILL START*

Nov. 30, 1975

23.

PROPOSED CASING AND CEMENTING PROGRAM

SIZE OF HOLE	SIZE OF CASING	WEIGHT PER FOOT	SETTING DEPTH	QUANTITY OF CEMENT
See original well file	Same	Same	Same	Same
7-7/8	4-1/2	9.50#	3000	150 ex

Attempt to wash down plugs in old hole to a depth of 3,000 feet; if successful, run logs and if production is indicated, set and cement 4 1/2" production casing with 150 sacks cement. Gun perforate, fracture treat in a completion attempt. If non-commercial, will plug and abandon in accordance with U.S.G.S. abandonment instructions, and restore surface.

A 10" Shaffer 3000 Series blow-out preventer will be used at all times during the "wash-down" operation.

IN ABOVE SPACE DESCRIBE PROPOSED PROGRAM: If proposal is to deepen or plug back, give data on present productive zone and proposed new productive zone. If proposal is to drill or deepen directionally, give pertinent data on subsurface locations and measured and true vertical depths. Give blowout preventer program, if any.

24.

SIGNED

TITLE

President

DATE

Nov. 11, 1975

(This space for Federal or State office use)

PERMIT NO.

APPROVAL DATE

APPROVED BY

TITLE

CONDITIONS OF APPROVAL, IF ANY:

*See Instructions On Reverse Side

NEW MEXICO OIL CONSERVATION COMMISSION
WELL LOCATION AND ACREAGE DEDICATION PLAT

Form C-102
Supersedes C-128
Effective 1-1-65

All distances must be from the outer boundaries of the Section.

Operator BASIN FUELS, INC.		Lease McCOLLUM		Well No. 1
Unit Letter P	Section 12	Township 20 NORTH	Range 6 WEST	County McKINLEY
Actual Footage Location of Well: <div style="display: flex; justify-content: space-between;"> 660 feet from the SOUTH line and 660 feet from the EAST line </div>				
Ground Level Elev. 6745	Producing Formation esaverde	Pool wildcat	Dedicated Acreage: 40 Acres	

1. Outline the acreage dedicated to the subject well by colored pencil or hatchure marks on the plat below.
2. If more than one lease is dedicated to the well, outline each and identify the ownership thereof (both as to working interest and royalty).
3. If more than one lease of different ownership is dedicated to the well, have the interests of all owners been consolidated by communitization, unitization, force-pooling, etc?

☐ Yes ☐ No If answer is "yes," type of consolidation _____

If answer is "no," list the owners and tract descriptions which have actually been consolidated. (Use reverse side of this form if necessary.) _____

No allowable will be assigned to the well until all interests have been consolidated (by communitization, unitization, forced-pooling, or otherwise) or until a non-standard unit, eliminating such interests, has been approved by the Commission.

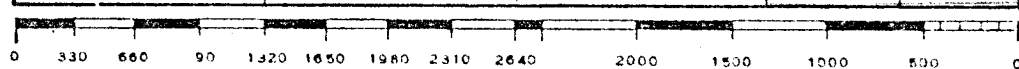
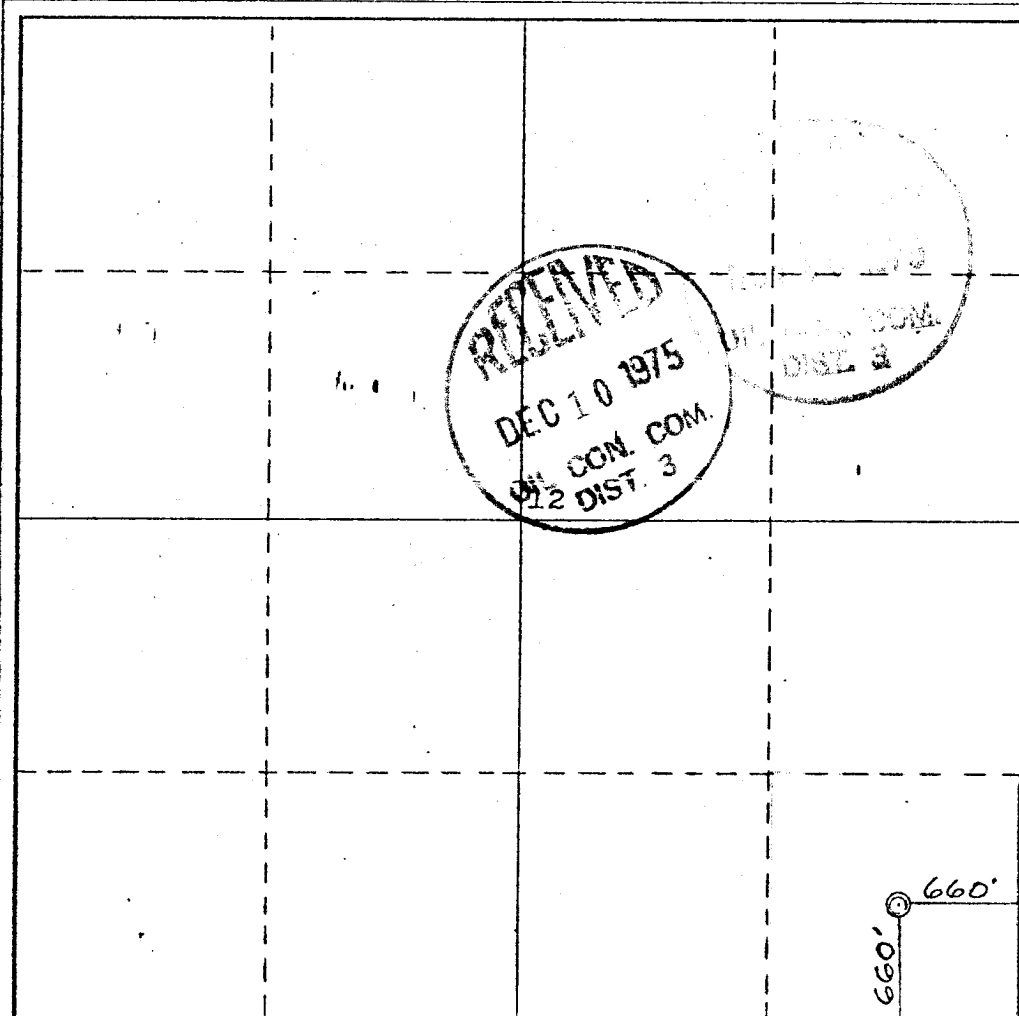

CERTIFICATION

I hereby certify that the information contained herein is true and complete to the best of my knowledge and belief.

Name
President
Position
Basin Fuels, Inc. Incorporated
Company
1975
Date

I hereby certify that the well location shown on this plat was plotted in the field notes, actual surveys made by me or under my supervision and that the same is true and correct to the best of my knowledge and belief.

Date Surveyed **10 November 1975**
Registered Professional Engineer and/or Land Surveyor
James P. Leese

James P. Leese

Certificate No.
1463

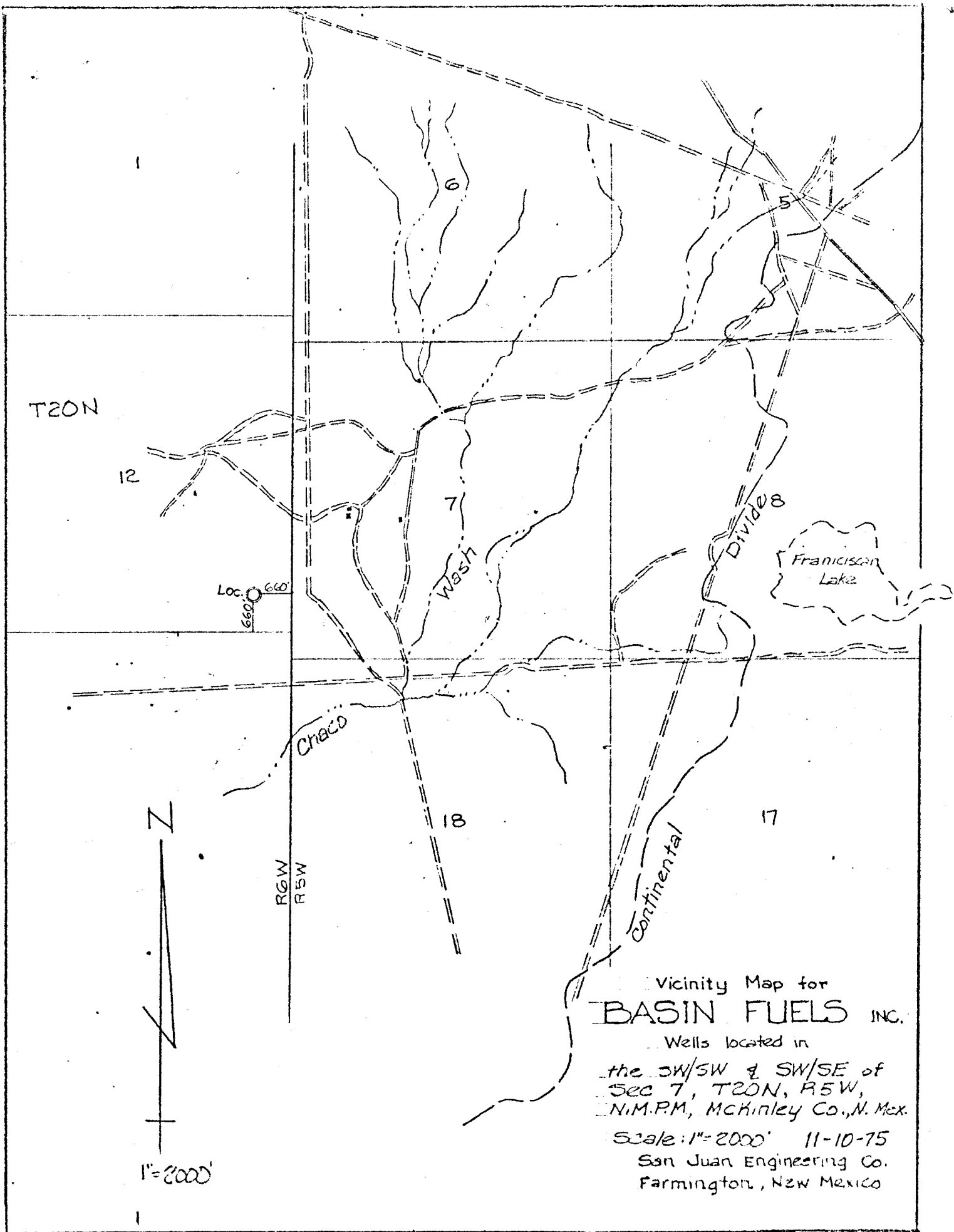

DEVELOPMENT PLAN FOR SURFACE RESUME

COMPANY:

Basin Fuels, Incorporated
152 Petroleum Center Building
Farmington, New Mexico 87401

WELL:

McCollum No. 1
660' FSL, 660' FEL,
Sec. 12, T20N, R5W
McKinley County, N.M.

1. Location and vicinity map, San Juan Engineering Company
Exit Highway 44: 19 miles Northwest of Lease. Directions to site: At Counselor, N.M. - Turn right, go 4.5 miles to cross-road, left at cross-road, on Ojo Encino road go 14.5 miles, at this point, trail off main road, go south 2 miles to site.
2. Approximately 1300 feet of new road will be required to reach location
3. Three producing wells located in SW SW Sec. 7, T.20N., R.5W., SW SE Sec. 7, T.20N., R.5W., and NW NW Sec. 18, T.20N., R.5W.
4. Roads shown on vicinity plat and location plat.
5. In the event of production, tank battery to be installed on location.
6. Water to come from pits adjoining existing wells on the lease.
7. All trash and waste material to be placed in mud pit and covered. No other surface to be used.
8. None.
9. None.
10. Rig layout shown on plat attached. Area is flat with sagebrush. Drilling pad to be compacted.
11. Upon completion of drilling or producing operation, the surface will be leveled and restored in accordance with instructions from appropriate governmental agency.
12. Area is flat, covered with sagebrush. Drill site to be compacted, and upon completion of operation will be leveled and restored.

Field representative to contact:

Joel B. Burr, Jr.
Basin Fuels, Incorporated
152 Petroleum Center Building
Farmington, New Mexico 87401
Phone: (505) 325-1702

COLEMAN DRILLING CO.

P. O. BOX 1915

FARMINGTON, N. M. 87401

PHONE 505 / 325-6892

RIG # 2

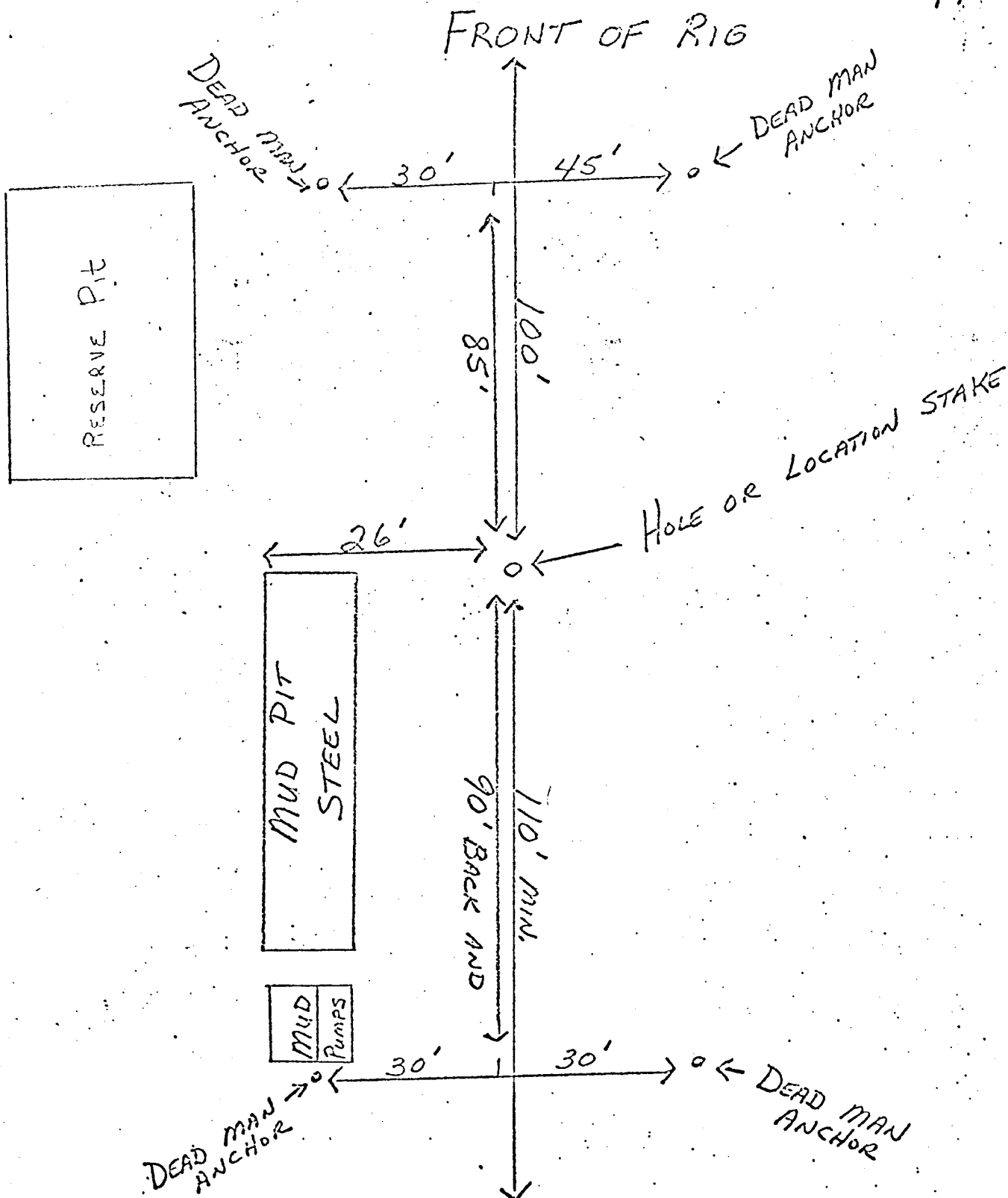

RESERVE PIT 90'X90'X5' DEEP