

NO. OF COPIES RECEIVED 5

DISTRIBUTION

SANTA FE 1

FILE 1

U.S.G.S. 2

LAND OFFICE 1

OPERATOR 1

NEW MEXICO OIL CONSERVATION COMMISSION

Form C-101  
Revised 1-1-65

5A. Indicate Type of Lease  
STATE ☐ FEE ☒

5. State Oil & Gas Lease No.

APPLICATION FOR PERMIT TO DRILL, DEEPEN, OR PLUG BACK

1a. Type of Work  
b. Type of Well DRILL ☒ DEEPEN ☐ PLUG BACK ☐  
OIL WELL ☒ GAS WELL ☐ OTHER ☐ SINGLE ZONE ☒ MULTIPLE ZONE ☐

2. Name of Operator Northwest Production Corporation  
3. Address of Operator Box 1796, El Paso, Texas 79949

4. Location of Well UNIT LETTER E LOCATED 1900 FEET FROM THE NORTH LINE  
AND 500 FEET FROM THE WEST LINE OF SEC. 8 TWP. 17 N RGE. 7 W NMPM

7. Unit Agreement Name  
8. Farm or Lease Name SANTA FE  
9. Well No. 1  
10. Field and Pool, or Wildcat WILDCAT  
12. County McKINLEY

19. Proposed Depth 1850  
19A. Formation HOSPAN  
20. Rotary or C.T. ROTARY

21. Elevations (Show whether DF, RT, etc.) 6762  
21A. Kind & Status Plug. Bond Blanket - Current  
21B. Drilling Contractor Crane Drilling Co.  
22. Approx. Date Work will start JAN 8 1966

23.

PROPOSED CASING AND CEMENT PROGRAM

SIZE OF HOLE	SIZE OF CASING	WEIGHT PER FOOT	SETTING DEPTH	SACKS OF CEMENT	EST. TOP
9-7/8	7-5/8	24.00	33 ft	15	Surface
6-3/4	4-1/2	9.50	1850 ft	100	1150



IN ABOVE SPACE DESCRIBE PROPOSED PROGRAM: IF PROPOSAL IS TO DEEPEN OR PLUG BACK, GIVE DATA ON PRESENT PRODUCTIVE ZONE AND PROPOSED NEW PRODUCTIVE ZONE. GIVE BLOWOUT PREVENTER PROGRAM, IF ANY.

I hereby certify that the information above is true and complete to the best of my knowledge and belief.

Signed J. M. Newman Title J. M. Newman, Manager Date JAN 5 1966  
(This space for State Use)

APPROVED BY Emma C. Cline TITLE Sup Dist III DATE 1-7-66

CONDITIONS OF APPROVAL, IF ANY:

APPROVAL VALID  
FOR 90 DAYS UNLESS  
DRILLING COMMENCED,

EXPIRES 3-20-66

**NEW MEXICO OIL CONSERVATION COMMISSION  
WELL LOCATION AND ACREAGE DEDICATION PLAT**

Form C-102  
Supersedes  
Effective 1-4-65

All distances must be from the outer boundaries of the Section.

Operator <b>Northwest Production Corporation</b>			Lease <b>SAVANA 75</b>		Well No. <b>1</b>
Unit Letter <b>E</b>	Section <b>8</b>	Township <b>17 North</b>	Range <b>7 West</b>	County <b>McKinley</b>	
Actual Footage Location of Well: <b>1900</b> feet from the <b>North</b> line and <b>500</b> feet from the <b>West</b> line					
Ground Level Elev. <b>6762</b>	Producing Formation <b>DEVIL</b>		Pool <b>WILKIN</b>	Dedicated Acreage: <b>0.00</b> Acres	

1. Outline the acreage dedicated to the subject well by colored pencil or hachure marks on the plat below.
2. If more than one lease is dedicated to the well, outline each and identify the ownership thereof (both as to working interest and royalty).
3. If more than one lease of different ownership is dedicated to the well, have the interests of all owners been consolidated by communitization, unitization, force-pooling, etc?

☐ Yes    ☐ No    If answer is "yes," type of consolidation \_\_\_\_\_

If answer is "no," list the owners and tract descriptions which have actually been consolidated. (Use reverse side of this form if necessary.) \_\_\_\_\_

No allowable will be assigned to the well until all interests have been consolidated (by communitization, unitization, forced-pooling, or otherwise) or until a non-standard unit, eliminating such interests, has been approved by the Commission.

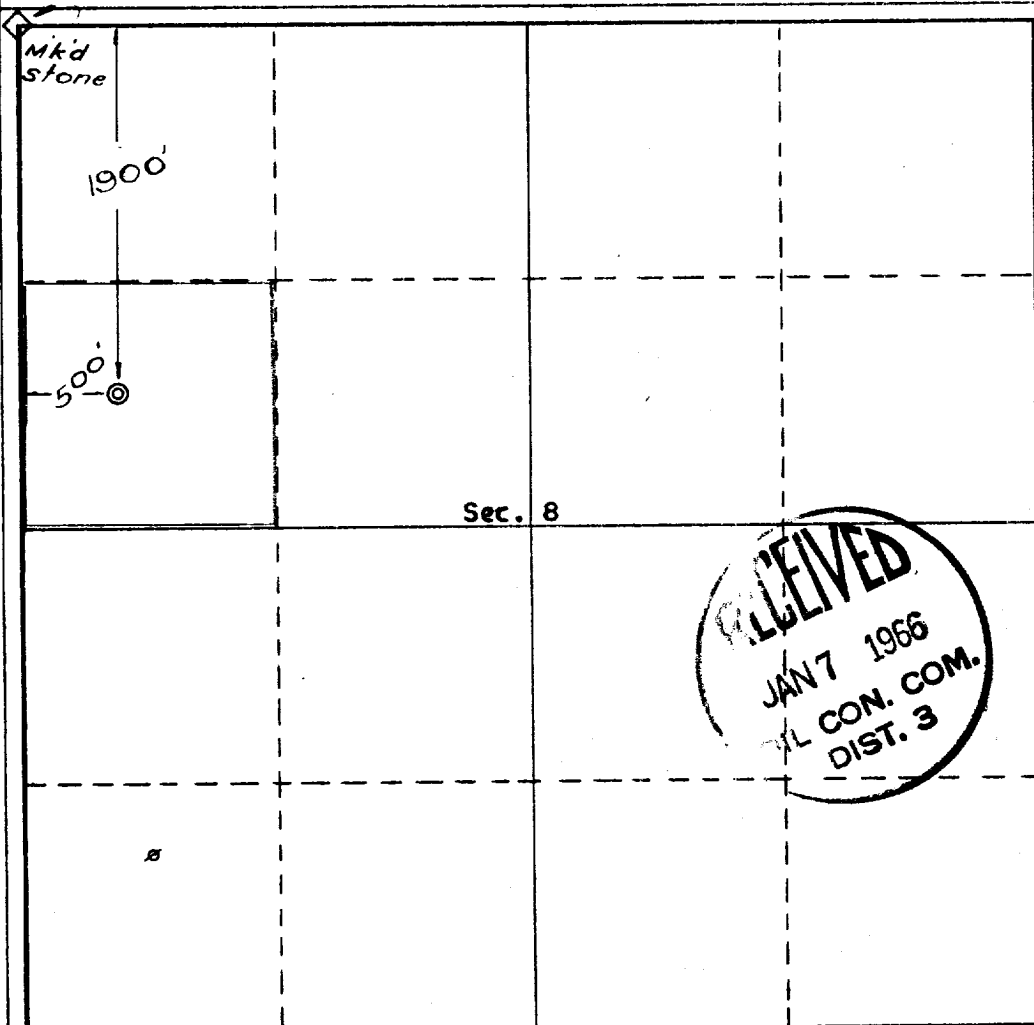

**CERTIFICATION**

I hereby certify that the information contained herein is true and complete to the best of my knowledge and belief.

Name \_\_\_\_\_

Position **J. M. Newman, Manager  
Production Operations**

Company  
**NORTHWEST PRODUCTION CORPORATION**

Date **JAN 5 1966**

I hereby certify that the well location shown on this plat was plotted from field notes of original surveys made by me or under my supervision, and that the same is true and correct to the best of my knowledge and belief.

Date Surveyed

**January 3, 1966**

Registered Professional Engineer  
and/or Land Surveyor

*E. V. Echols*

Certificate No.

**3602**

0 330 660 990 1320 1650 1980 2310 2640 2000 1500 1000 500 0

