

NO. OF COPIES RECEIVED	6
DISTRIBUTION	
SANTA FE	
FILE	
U.S.G.S.	
LAND OFFICE	
OPERATOR	

NEW MEXICO OIL CONSERVATION COMMISSION

Form C-101
Revised 1-1-65

5A. Indicate Type of Lease	
STATE <input type="checkbox"/>	FEE <input checked="" type="checkbox"/>

5. State Oil & Gas Lease No.

APPLICATION FOR PERMIT TO DRILL, DEEPEN, OR PLUG BACK

1a. Type of Work		7. Unit Agreement Name	
b. Type of Well OIL WELL <input checked="" type="checkbox"/> GAS WELL <input type="checkbox"/> OTHER <input type="checkbox"/>		8. Farm or Lease Name	
DRILL <input checked="" type="checkbox"/> DEEPEN <input type="checkbox"/> PLUG BACK <input type="checkbox"/>		Santa Fe	
2. Name of Operator		9. Well No.	
Walker Bros. Oil Company		11	
3. Address of Operator		10. Field and Pool, or Wildcat	
P.O. Box 776, Durango, Colorado (P.O. Box 18715, Oklahoma City, Oklahoma)		Hospah Area	
4. Location of Well		12. County	
UNIT LETTER <u>K</u> LOCATED <u>1650</u> FEET FROM THE <u>West</u> LINE AND <u>2280</u> FEET FROM THE <u>South</u> LINE OF SEC. <u>7</u> TWP. <u>17N</u> RGE. <u>8W</u> NMPM		McKinley	
19. Proposed Depth		19A. Formation	
2700		Dakota	
20. Rotary or C.T.		Rotary	
21. Elevations (Show whether DF, RT, etc.)		21B. Drilling Contractor	
7025 ground		Johney Myers	
21A. Kind & Status Plug. Bond		22. Approx. Date Work will start	
Blanket		May 10, 1966	

23.

PROPOSED CASING AND CEMENT PROGRAM

SIZE OF HOLE	SIZE OF CASING	WEIGHT PER FOOT	SETTING DEPTH	SACKS OF CEMENT	EST. TOP
12"	8 5/8	24	60'	20	surface
6 3/4"	4 1/2	9.5	2700	100	2200'

Propose to drill and test both the Gallup and Dakota formation.
If during drilling of the Gallup we deem it not necessary to drill deeper, we will try and effect a completion in the Gallup formation;
4 1/2" pipe will then be set into the Gallup.



IN ABOVE SPACE DESCRIBE PROPOSED PROGRAM: IF PROPOSAL IS TO DEEPEN OR PLUG BACK, GIVE DATA ON PRESENT PRODUCTIVE ZONE AND PROPOSED NEW PRODUCTIVE ZONE. GIVE BLOWOUT PREVENTER PROGRAM, IF ANY.

I hereby certify that the information above is true and complete to the best of my knowledge and belief.

Signed Gloria Thuermer Title Secretary Date April 21, 1966

(This space for State Use)

APPROVED BY [Signature] TITLE SUPERVISOR DIST. 73 DATE 4-22-66

CONDITIONS OF APPROVAL, IF ANY:

FOR 30 DAYS UNLESS
DRILLING COMMENCED.

EXPIRES

**NEW MEXICO OIL CONSERVATION COMMISSION
WELL LOCATION AND ACREAGE DEDICATION PLAT**

Form C-102
Supersedes C-128
Effective 1-1-65

All distances must be from the outer boundaries of the Section.

Operator Walker Brothers Oil Co.			Lease Santa Fe		Well No. 11
Unit Letter K	Section 7	Township 17 N	Range 8 W	County Mc Kinley	
Actual Footage Location of Well: <div style="display: flex; justify-content: space-between;"> 1650 feet from the West line and 2280 feet from the South line </div>					
Ground Level Elev. 7025	Producing Formation Gallup	Pool Hospah	Dedicated Acreage: 40 Acres		

1. Outline the acreage dedicated to the subject well by colored pencil or hachure marks on the plat below.
2. If more than one lease is dedicated to the well, outline each and identify the ownership thereof (both as to working interest and royalty).
3. If more than one lease of different ownership is dedicated to the well, have the interests of all owners been consolidated by communitization, unitization, force-pooling, etc?

☐ Yes ☒ No If answer is "yes," type of consolidation **one lease**

If answer is "no," list the owners and tract descriptions which have actually been consolidated. (Use reverse side of this form if necessary.) _____

No allowable will be assigned to the well until all interests have been consolidated (by communitization, unitization, forced-pooling, or otherwise) or until a non-standard unit, eliminating such interests, has been approved by the Commission.

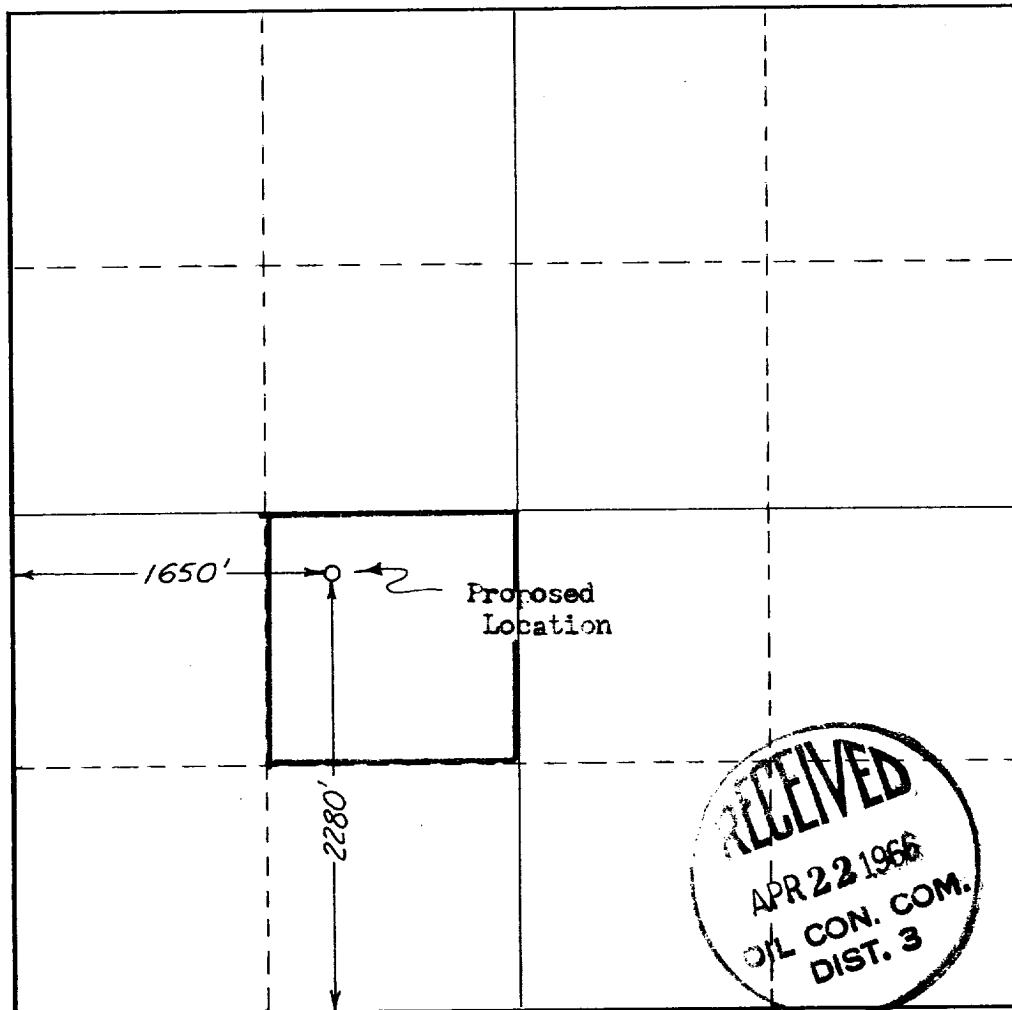

CERTIFICATION

I hereby certify that the information contained herein is true and complete to the best of my knowledge and belief.

Name *Gloria Thuermer*

Position
Secretary

Company
Walker Bros. Oil Co.

Date
April 21, 1966

I hereby certify that the well location shown on this plat was plotted from field notes of actual surveys made by me or under my supervision, and that the same is true and correct to the best of my knowledge and belief.

Date Surveyed
March 24, 1966

Registered Professional Engineer and/or Land Surveyor

Indurich H Reed
Certificate No.

N. M. # 3795

