

NUMBER OF COPIES RECEIVED	
DISTRIBUTION	
SANTA FE	
FILE	
U.S.G.S.	
LAND OFFICE	
TRANSPORTER	OIL GAS
PRORATON OFFICE	
OPERATOR	

NEW MEXICO OIL CONSERVATION COMMISSION
Santa Fe, New Mexico

Form G-101
Revised (12/1/55)

NOTICE OF INTENTION TO DRILL

Notice must be given to the District Office of the Oil Conservation Commission and approval obtained before drilling or recompletion begins. If changes in the proposed plan are considered advisable, a copy of this notice showing such changes will be returned to the sender. Submit this notice in QUINTUPLICATE. One copy will be returned following approval. See additional instructions in Rules and Regulations of the Commission. **If State Land submit 6 Copies Attach Form G- 128 in triplicate to first 3 copies of form G-101**

Albuquerque, N. M.
(Please)

4-12-62
(Date)

OIL CONSERVATION COMMISSION
SANTA FE, NEW MEXICO

Gentlemen:

You are hereby notified that it is our intention to commence the Drilling of a well to be known as

CHACO OIL CO.

(Company, or Operator)

Santa Fe Pac. R.R.
(Lease)

, Well No. I-15,

in 0 The well is
(Unit)

located 560 feet from the south line and 2470 feet from the
east line of Section 20, T. 20 N., R. 9 W., NMPM.

(GIVE LOCATION FROM SECTION LINE) Red Mountain Pool, McKinley County

If State Land the Oil and Gas Lease is No.

If patented land the owner is Santa Fe Pac. R.R. Co.

Address 4542 Produce Plaza, Los Angeles 58, Calif.

We propose to drill well with drilling equipment as follows:

Mayhew 2000

The status of plugging bond is on file at Santa Fe

Drilling Contractor O. L. Ray, Grants, N. M.

We intend to complete this well in the Menefee
formation at an approximate depth of 500 feet.

CASING PROGRAM

We propose to use the following strings of Casing and to cement them as indicated:

Size of Hole	Size of Casing	Weight per Foot	New or Second Hand	Depth	Sacks Cement
4-3/4"	2"	3.7	new	470	8

If changes in the above plans become advisable we will notify you immediately.

ADDITIONAL INFORMATION (If recompletion give full details of proposed plan of work.)

Verbal permission by E. C. Arnold, 4-16-62

Approved
Except as follows:

4-18-62

Sincerely yours,

Chaco Oil Co.

(Company or Operator)

By

Position Co-owner

Send Communications regarding well to

Name H. S. Birdseye

Address P. O. Box 8294, Albuquerque, N. M.

OIL CONSERVATION COMMISSION

By

A. L. Kendrick

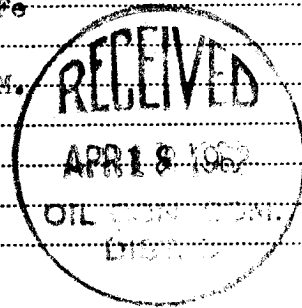

NEW MEXICO OIL CONSERVATION COMMISSION
Well Location and Acreage Dedication Plat

Section A.

Date 4-12-62

Operator Chaco Oil Co. Lease Santa Fe Pacific R R
Well No. I-15 Unit Letter 0 Section 20 Township 20 N Range 9 W NMPM
Located 560 Feet From south Line, 2470 Feet From east Line
County McKinley G. L. Elevation 6409 Dedicated Acreage -- Acres
Name of Producing Formation Menefee Pool Red Mountain

1. Is the Operator the only owner* in the dedicated acreage outlined on the plat below?
Yes ☒ No ☐.
2. If the answer to question one is "no," have the interests of all the owners been consolidated by communitization agreement or otherwise? Yes ☐ No ☐. If answer is "yes," Type of Consolidation _____
3. If the answer to question two is "no," list all the owners and their respective interests below:

Owner

Land Description

Section B

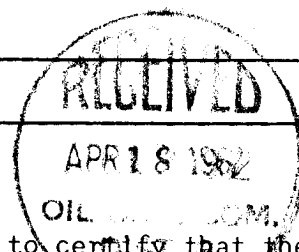
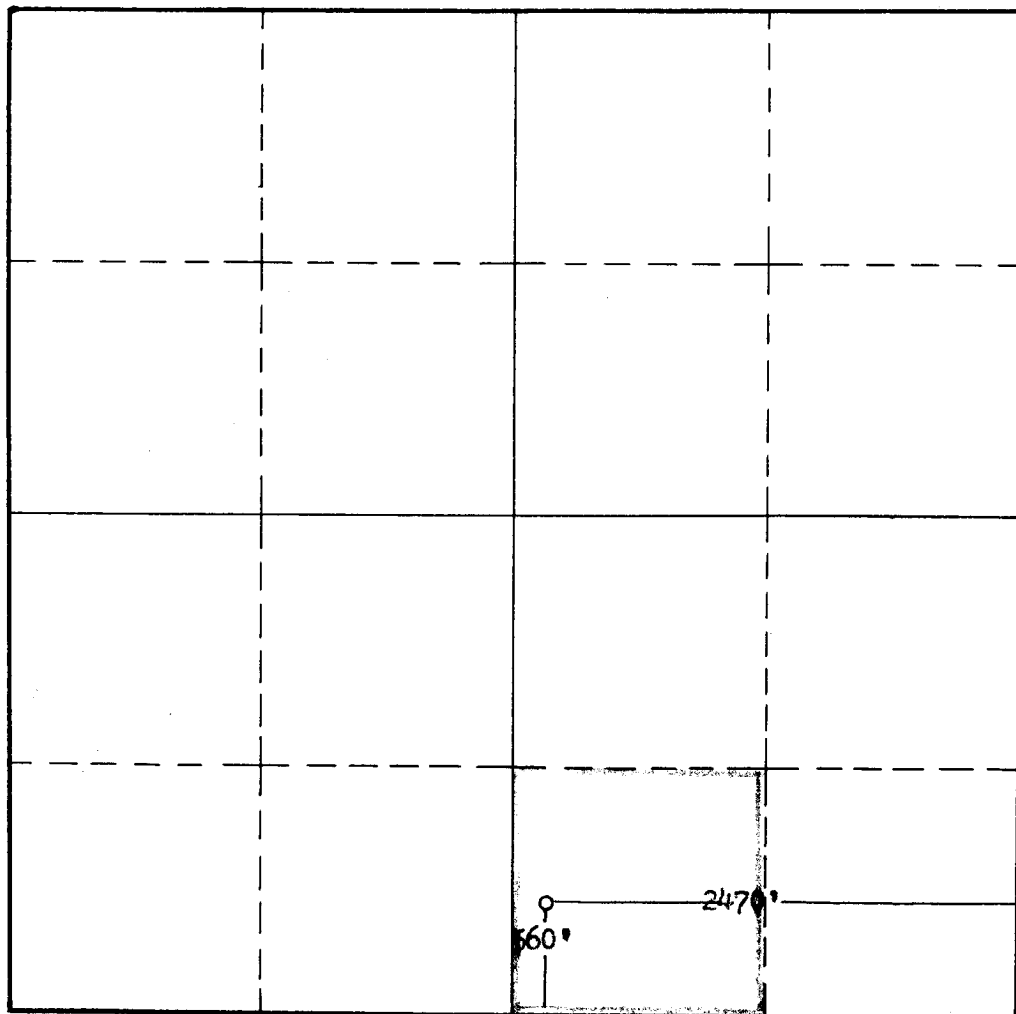

This is to certify that the information in Section A above is true and complete to the best of my knowledge and belief.

Chaco Oil Co.

(Operator)

MBridges
(Representative)

P O Box 3294, Albuquerque, N.M.
Address

This is to certify that the well location shown on the plat in Section B was plotted from field notes of actual surveys made by me or under my supervision and that the same is true and correct to the best of my knowledge and belief.

Date Surveyed 4-13-62

MBridges
Registered Professional
Engineer and Land Surveyor

Auth: Sec 67-21-2, NMS Annot 1953

Certificate No. _____

(See instructions for completing this form on the reverse side)