

NO. OF COPIES RECEIVED	
DISTRIBUTION	
SANTA FE	
FILE	
U.S.G.S.	
LAND OFFICE	
OPERATOR	

NEW MEXICO OIL CONSERVATION COMMISSION

Form C-101
Revised 1-1-65

5A. Indicate Type of Lease	
STATE <input type="checkbox"/>	FEE <input checked="" type="checkbox"/>
5. State Oil & Gas Lease No.	

APPLICATION FOR PERMIT TO DRILL, DEEPEN, OR PLUG BACK

1a. Type of Work		7. Unit Agreement Name	
b. Type of Well OIL WELL <input type="checkbox"/> GAS WELL <input type="checkbox"/> OTHER <input type="checkbox"/> Wildcat		8. Farm or Lease Name Santa Fe & Pacific R.R.	
2. Name of Operator Worldwide Petroleum Corporation		9. Well No. 10	
3. Address of Operator 4150 East Mexico Avenue, Denver, Colorado 80222		10. Field and Pool, or Wildcat Wildcat	
4. Location of Well UNIT LETTER C LOCATED 330 FEET FROM THE North LINE AND 2310 FEET FROM THE West LINE OF SEC. 19 TWP. 18N RGE. 68W NMPM		12. County McKinley	
19. Proposed Depth 2850		19A. Formation Morrison	
20. Rotary or C.T. Rotary		21. Elevations (Show whether DF, RT, etc.) 6552 GL	
21A. Kind & Status Plug. Bond \$10,000 in force		21B. Drilling Contractor Signal Oilfield Service	
22. Approx. Date Work will start 9-15-65			

PROPOSED CASING AND CEMENT PROGRAM

SIZE OF HOLE	SIZE OF CASING	WEIGHT PER FOOT	SETTING DEPTH	SACKS OF CEMENT	EST. TOP
12-1/4"	10-3/4"	32.75#	270'	80	Surface
8-3/4"	7"	23.00#	1700'	125	700'
6-1/4"	4-1/2"	10.50#	2850'	125	1600'

It is proposed to drill a 12-1/4" hole to 270 feet and set 10-3/4" surface casing with 80 sacks. 8-3/4" hole will be drilled to 1700 feet and set 7" casing with 125 sack cement. 6-1/4" hole will be drilled to approximately 2850' to be bottomed in the Morrison formation. If Dakota is productive, 4-1/2" casing will be cemented at TD with 125 sack cement. If Dakota is nonproductive and Gallup is productive, 4-1/2" casing will be set at 1900' and cemented with 40 sack cement after which plugs below as designated by the Commission.

APPROVAL VALID
FOR 90 DAYS UNLESS
DRILLING COMMENCED,

EXPIRES 12-21-65

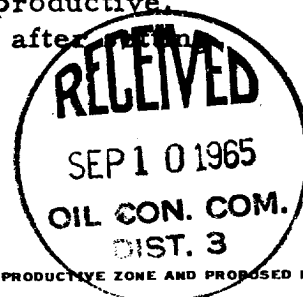

IN ABOVE SPACE DESCRIBE PROPOSED PROGRAM: IF PROPOSAL IS TO DEEPEN OR PLUG BACK, GIVE DATA ON PRESENT PRODUCTIVE ZONE AND PROPOSED NEW PRODUCTIVE ZONE. GIVE BLOWOUT PREVENTER PROGRAM, IF ANY.

I hereby certify that the information above is true and complete to the best of my knowledge and belief.

Signed Conley P. Smith Title Petroleum Engineer Date September 8, 1965

(This space for State Use)

APPROVED BY Emory O'Connell TITLE Sup Dist. II DATE 9-10-65

CONDITIONS OF APPROVAL, IF ANY:

**NEW MEXICO OIL CONSERVATION COMMISSION
WELL LOCATION AND ACERAGE DEDICATION PLAT**

All distances must be from the outer boundaries of the Section

Operator WORLDWIDE PETROLEUM CORPORATION			Lease SANTA FE		Well No. MX 10
Unit Letter C	Section 19	Township 18 NORTH	Range 10 WEST	County MCKINLEY	
Actual Footage Location of Well: 330 feet from the NORTH line and 2310 feet from the WEST line					
Ground Level Elev. 6552.0	Producing Formation Dakota- Gallup Test		Pool	Dedicated Acreage: 40 Acres	

1. Outline the acreage dedicated to the subject well by colored pencil or hachure marks on the plat below.
2. If more than one lease is dedicated to the well, outline each and identify the ownership thereof (both as to working interest and royalty),
3. If more than one lease of different ownership is dedicated to the well, have the interests of all owners been consolidated by communitization, unitization, force-pooling, etc?

() Yes () No If answer is "yes," type of consolidation

If answer is "no," list the owners and tract descriptions which have actually consolidated. (Use reverse side of this form if necessary.)

No allowable will be assigned to the well until all interests have been consolidated (by communitization, unitization, forced-pooling, or otherwise) or until a non standard unit, eliminating such interests, has been approved by the Commission.

CERTIFICATION

I hereby certify that the information contained herein is true and complete to the best of my knowledge and belief.

Conley A. Smith
 Name
Petroleum Engineer
 Position
Worldwide Petroleum Corporation
 Company
September 9, 1965
 Date

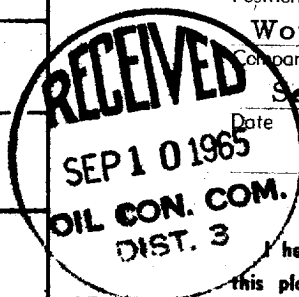
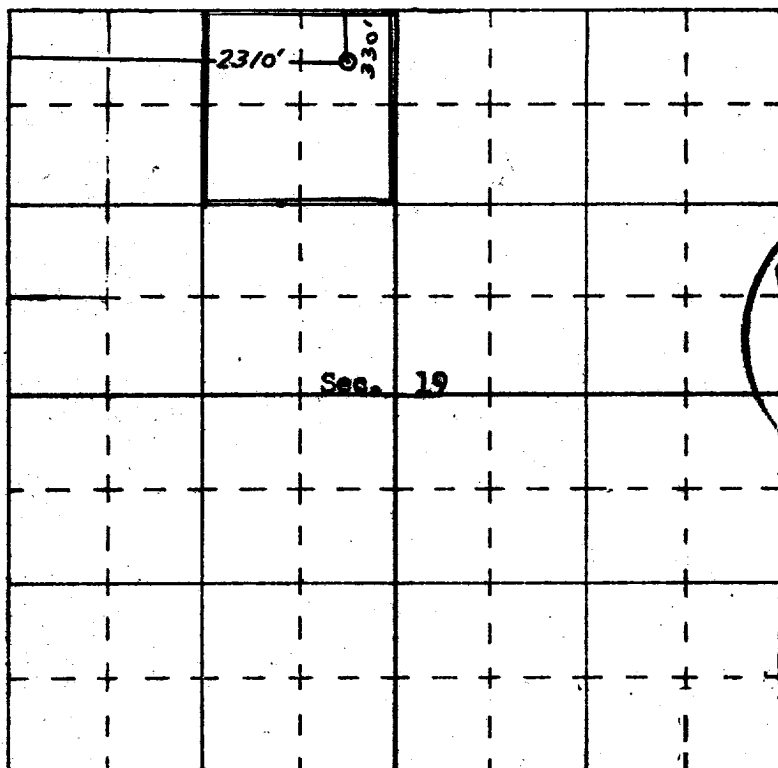

I hereby certify that the well location shown on this plat was plotted from field notes of actual surveys made by me or under my supervision, and that the same is true and correct to the best of my knowledge and belief.

September 1, 1965
 Date Surveyed
[Signature]
 Registered Professional
 and Licensed Surveyor
James H. Lee
 State of New Mexico.
San Diego Engineering Company
 Certificate No. **1145**

