

NO. OF COPIES RECEIVED	6
DISTRIBUTION	
SANTA FE	1
FILE	1 ✓
U.S.G.S.	2
LAND OFFICE	1
OPERATOR	1

NEW MEXICO OIL CONSERVATION COMMISSION

Form C-101
Revised 1-1-65

5A. Indicate Type of Lease STATE <input checked="" type="checkbox"/> FEE <input type="checkbox"/>
5. State Oil & Gas Lease No. K-5548
7. Unit Agreement Name
8. Farm or Lease Name State
9. Well No. ST-7
10. Field and Pool, or Wildcat Wildcat
12. County McKinley
19. Proposed Depth 500'
19A. Formation Point Lookout
20. Rotary or C.T. Rotary
21. Elevations (Show whether DF, RT, etc.) 6514 Ground
21A. Kind & Status Plug. Bond Blanket
21B. Drilling Contractor West Texas Drillers
22. Approx. Date Work will start 11-27-66

APPLICATION FOR PERMIT TO DRILL, DEEPEN, OR PLUG BACK	
1a. Type of Work b. Type of Well DRILL <input checked="" type="checkbox"/> DEEPEN <input type="checkbox"/> PLUG BACK <input type="checkbox"/> OIL WELL <input type="checkbox"/> GAS WELL <input type="checkbox"/> OTHER Strat Test SINGLE ZONE <input type="checkbox"/> MULTIPLE ZONE <input type="checkbox"/>	2. Name of Operator Hughes & Hughes
3. Address of Operator Drawer 669, Beeville, Texas 78102	4. Location of Well UNIT LETTER _____ LOCATED 100 FEET FROM THE South LINE AND 2640 FEET FROM THE West LINE OF SEC. 32 TWP. 19 N RGE. 12 W NMPM
23. PROPOSED CASING AND CEMENT PROGRAM	

SIZE OF HOLE	SIZE OF CASING	WEIGHT PER FOOT	SETTING DEPTH	SACKS OF CEMENT	EST. TOP
4 1/2"	None	--	--	--	--

Propose to drill a 4 1/2" hole to the Point Lookout Formation for geological information only. The hole will be plugged with a cement plug in the top of the Point Lookout and a cement plug at the surface.

THIS WELL IS BEING DRILLED AS A STRATIGRAPHIC TEST-HOLE FOR GEOLOGICAL INFORMATION ONLY AND UNDER NO CIRCUMSTANCES WILL IT BE PRODUCED.

IN ABOVE SPACE DESCRIBE PROPOSED PROGRAM: IF PROPOSAL IS TO DEEPEN OR PLUG BACK, GIVE DATA ON PRESENT PRODUCTIVE ZONE AND PROPOSED NEW PRODUCTIVE ZONE. GIVE BLOWOUT PREVENTER PROGRAM, IF ANY.

I hereby certify that the information above is true and complete to the best of my knowledge and belief.

Signed Thos. H. Conally Title Agent Date 11-18-66

(This space for State Use)

Original Signed by Emery C. Arnold

SUPERVISOR DIST. #3

APPROVED BY _____ TITLE _____ DATE NOV 22 1966

CONDITIONS OF APPROVAL, IF ANY:



**NEW MEXICO OIL CONSERVATION COMMISSION
WELL LOCATION AND ACREAGE DEDICATION PLAT**

Form C-102
Supersedes C-128
Effective 1-1-65

All distances must be from the outer boundaries of the Section.

Operator Hughes & Hughes			Lease Stratigraphic Test		Well No. 7
Unit Letter N	Section 32	Township 19 N	Range 12 W	County Mc Kinley	
Actual Footage Location of Well: 100 feet from the South line and 2640 feet from the West line					
Ground Level Elev. 6514	Producing Formation None		Pool None		Dedicated Acreage: See Below Acres

1. Outline the acreage dedicated to the subject well by colored pencil or hachure marks on the plat below.
2. If more than one lease is dedicated to the well, outline each and identify the ownership thereof (both as to working interest and royalty).
3. If more than one lease of different ownership is dedicated to the well, have the interests of all owners been consolidated by communitization, unitization, force-pooling, etc?

☐ Yes ☐ No If answer is "yes," type of consolidation For Stratigraphic Purposes Only

If answer is "no," list the owners and tract descriptions which have actually been consolidated. (Use reverse side of this form if necessary.) _____

No allowable will be assigned to the well until all interests have been consolidated (by communitization, unitization, forced-pooling, or otherwise) or until a non-standard unit, eliminating such interests, has been approved by the Commission.

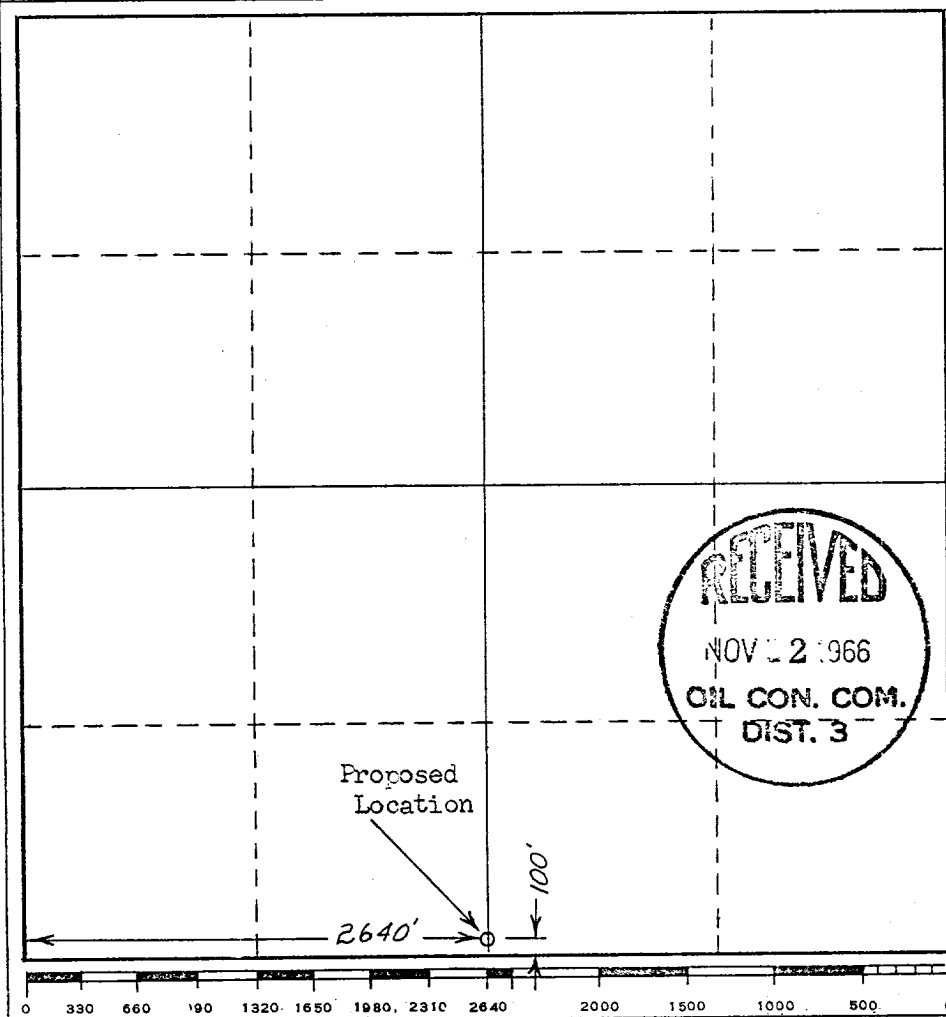

CERTIFICATION

I hereby certify that the information contained herein is true and complete to the best of my knowledge and belief.

Thomas H. Kennedy
Name

Position
Agent

Company
Hughes & Hughes

Date
11-18-66

I hereby certify that the well location shown on this plat was plotted from field notes of actual surveys made by me or under my supervision, and that the same is true and correct to the best of my knowledge and belief.

Date Surveyed
Nov. 12, 1966

Registered Professional Engineer
and/or Land Surveyor

Ernest H. Reed
Certificate No.

N. M. # 3795