

NO. OF COPIES RECEIVED	5
DISTRIBUTION	
SANTA FE	1
FILE	1
U.S.G.S.	2
LAND OFFICE	
OPERATOR	1

NEW MEXICO OIL CONSERVATION COMMISSION

Form C-101
Revised 1-1-65

5A. Indicate Type of Lease	
STATE <input type="checkbox"/>	FEE <input checked="" type="checkbox"/>
5. State Oil & Gas Lease No.	

APPLICATION FOR PERMIT TO DRILL, DEEPEN, OR PLUG BACK

1a. Type of Work		7. Unit Agreement Name	
b. Type of Well DRILL <input checked="" type="checkbox"/> DEEPEN <input type="checkbox"/> PLUG BACK <input type="checkbox"/> OIL WELL <input type="checkbox"/> GAS WELL <input type="checkbox"/> OTHER Water Injection SINGLE ZONE <input type="checkbox"/> MULTIPLE ZONE <input type="checkbox"/>		8. Farm or Lease Name Santa Fe	
2. Name of Operator Worldwide Petroleum Corporation		9. Well No. 1-W	
3. Address of Operator 4150 E. Republic Ave. - Ranch, 80222 406 Mutual Savings Building, Fort Worth, Texas 76102		10. Field and Pool, or Wildcat Seven Lakes Field	
4. Location of Well UNIT LETTER C LOCATED 65 FEET FROM THE North LINE AND 1980 FEET FROM THE West LINE OF SEC. 19 TWP. 18N RGE. 10W NMPM		12. County McKinley	
19. Proposed Depth 500'		19A. Formation Manefee Sand	
20. Rotary or C.T. Rotary		21. Elevations (Show whether DF, RT, etc.) 6549 g.l.	
21A. Kind & Status Plug. Bond \$10,000 blanket bond		21B. Drilling Contractor O. L. Ray Drilling Co.	
22. Approx. Date Work will start Immediately			

PROPOSED CASING AND CEMENT PROGRAM

SIZE OF HOLE	SIZE OF CASING	WEIGHT PER FOOT	SETTING DEPTH	SACKS OF CEMENT	EST. TOP
5/1/8	2-7/8" EUE		500'	40	Surface



IN ABOVE SPACE DESCRIBE PROPOSED PROGRAM: IF PROPOSAL IS TO DEEPEN OR PLUG BACK, GIVE DATA ON PRESENT PRODUCTIVE ZONE AND PROPOSED NEW PRODUCTIVE ZONE. GIVE BLOWOUT PREVENTER PROGRAM, IF ANY.

I hereby certify that the information above is true and complete to the best of my knowledge and belief.

Signed Masha C. Walters Title Asst. Secretary Date January 19, 1965

(This space for State Use)

APPROVED BY Emory Clement TITLE _____ DATE 6-1-65

CONDITIONS OF APPROVAL, IF ANY:

NEW MEXICO OIL CONSERVATION COMMISSION
WELL LOCATION AND ACREAGE DEDICATION PLAT

SECTION A.

DATE January 19, 1965

OPERATOR Worldwide Petroleum Corporation LEASE Santa Fe
WELL NO. 1 - W UNIT LETTER C SECTION 19 TOWNSHIP 18 North RANGE 10 West NMPM
LOCATED 65 FEET FROM North LINE, 1980 FEET FROM West LINE
COUNTY McKinley G. L. ELEVATION 6549 DEDICATED ACREAGE _____ ACRES
NAME OF PRODUCING FORMATION _____ POOL _____

1. IS THE OPERATOR THE ONLY OWNER* IN THE DEDICATED ACREAGE OUTLINED ON THE PLAT BELOW? YES _____ NO _____
2. IF THE ANSWER TO QUESTION ONE IS "NO," HAVE THE INTERESTS OF ALL THE OWNERS BEEN CONSOLIDATED BY COMMUNITIZATION AGREEMENT OR OTHERWISE? YES _____ NO _____ IF ANSWER IS "YES," TYPE OF CONSOLIDATION _____

3. IF THE ANSWER TO QUESTION TWO IS "NO," LIST ALL THE OWNERS AND THEIR RESPECTIVE INTERESTS BELOW:
- | OWNER | LAND DESCRIPTION |
|-------|------------------|
| | |
| | |
| | |
| | |

SECTION B.

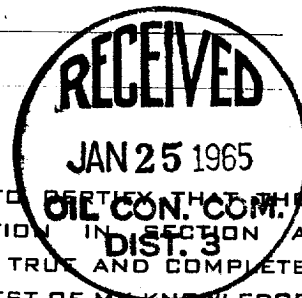
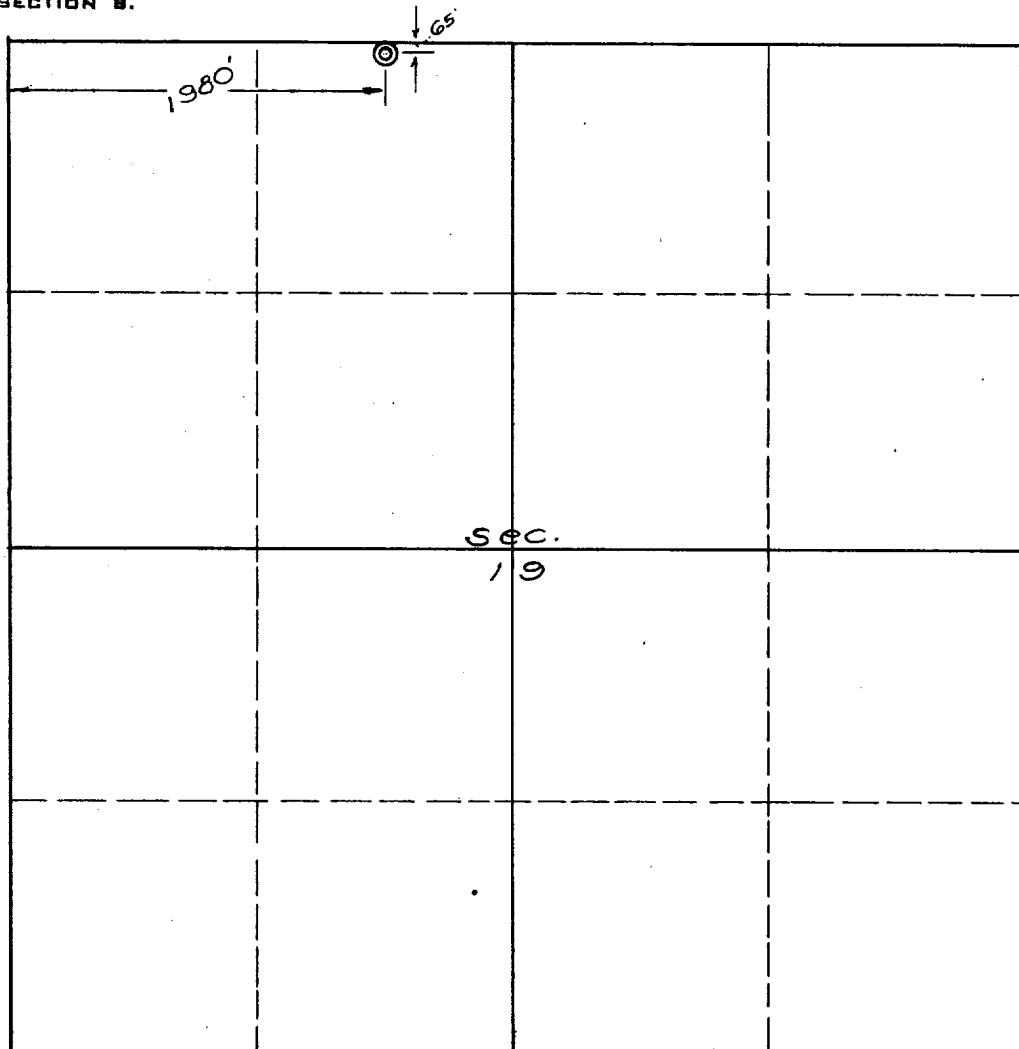

THIS IS TO CERTIFY THAT THE INFORMATION IN SECTION A ABOVE IS TRUE AND COMPLETE TO THE BEST OF MY KNOWLEDGE AND BELIEF.

WORLDWIDE PETROLEUM CORP.

(OPERATOR)

Martha C. Waters
(REPRESENTATIVE)

**406 Mutual Savings Bldg.
Fort Worth, Texas 76102**

(ADDRESS)

THIS IS TO CERTIFY THAT THE WELL LOCATION SHOWN ON THE PLAT IN SECTION B WAS PLOTTED FROM FIELD NOTES OF ACTUAL SURVEYS MADE BY ME OR UNDER MY SUPERVISION AND THAT THE SAME IS TRUE AND CORRECT TO THE BEST OF MY KNOWLEDGE AND BELIEF.

DATE SURVEYED Jan. 2, 1965

**FOUR STATES
ENGINEERING CO.**

FARMINGTON, NEW MEXICO

Carl A. Techow
REGISTERED ENGINEER OR
LAND SURVEYOR

CERTIFICATE NO. 3602