

ALL COPIES RECEIVED

DISTRIBUTION

SANTA FE  
FILE  
U.S.G.S.  
LAND OFFICE  
OPERATOR

NEW MEXICO OIL CONSERVATION COMMISSION

Form  
Revised 1-55

APPLICATION FOR PERMIT TO DRILL, DEEPEN, OR PLUG BACK

a. Type of Work

DRILL ☒

DEEPEN ☐

PLUG BACK ☐

b. Type of Well

GAS ☐

WATER ☒

SINGLE ☒

MULTIPLE ☐

c. Name of Operator

Academy Petroleum Corp.

d. Address of Operator

4150 East Madison Ave. Denver 22, Colorado

e. Location of Well

INITIALS

A

LOCATED 3/4

FEET FROM THE

NORTH

AND

FEET FROM THE

East

LINE OF SEC

19

TWP

18 N

RGE

10 W

RANGE

12. County

Mc Kinley

19. Proposed Depth

500'

19A. Formation

Menefee

20. Name of Operator

notary

21. Elevations (Show whether D.R.T. or not)

5450' well est.

21A. Kind & Status Plug Bond

#10,000 cash in

21B. Drilling Contractor

Crane Drilling Company

22. Approximate Date Work will start

6-15-65

PROPOSED CASING AND CEMENT PROGRAM

SIZE OF HOLE	SIZE OF CASING	WEIGHT PER FOOT	SETTING DEPTH	SACKS OF CEMENT	EST. TOP
5 1/2"	2 1/2"	6.5	500	50	Circulate to Surface

1. Use rotary rig with 0 to 500'. Bitless completion.  
2. Use tubing as production casing. Will pump with hollow rods.  
3. Well will be cemented to the plug method and circulated to surface.

I, the undersigned, certify that the information above is true and correct to the best of my knowledge and belief.

Signature *Wayne Rogers*  
(This space for State Use)

Signature *Emmy Christ*

Signature *Don*

6-8-65

Subject to administrative approval as injection well prior o injection.

## NEW MEXICO OIL CONSERVATION COMMISSION

Well Location and Acreage Dedication Plat

Section A.

Date 6-7-65

Operator WORLDWIDE PETROLEUM CORPORATION Lease Santa Fe  
 Well No. 2 Unit Letter A Section 19 Township 18 NORTH Range 10 WEST, NMPM  
 Located 330 Feet From THE NORTH Line, 990 Feet From THE EAST Line  
 County McKINLEY G. L. Elevation 6537.0 Dedicated Acreage \_\_\_\_\_ Acres  
 Name of Producing Formation San Juan Pool \_\_\_\_\_

1. Is the Operator the only owner in the dedicated acreage outlined on the plat below?

Yes X No \_\_\_\_\_

2. If the answer to question one is "no", have the interests of all the owners been consolidated by communitization agreement or otherwise? Yes \_\_\_\_\_ No \_\_\_\_\_. If answer is "yes", Type of Consolidation.

3. If the answer to question two is "no", list all the owners and their respective interests below:

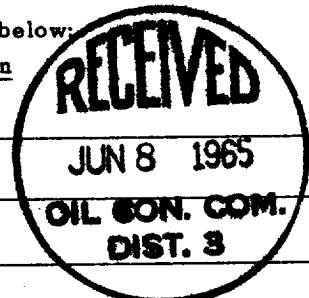
OwnerLand Description

Section B.

This is to certify that the information in Section A above is true and complete to the best of my knowledge and belief.

Worldwide Petroleum Corp.

(Operator)

Clyde Phillips

(Representative)

4230 East Harvard Ave.

(Address)

Denver 22, Colorado

Note: All distances must be from outer boundaries of section.

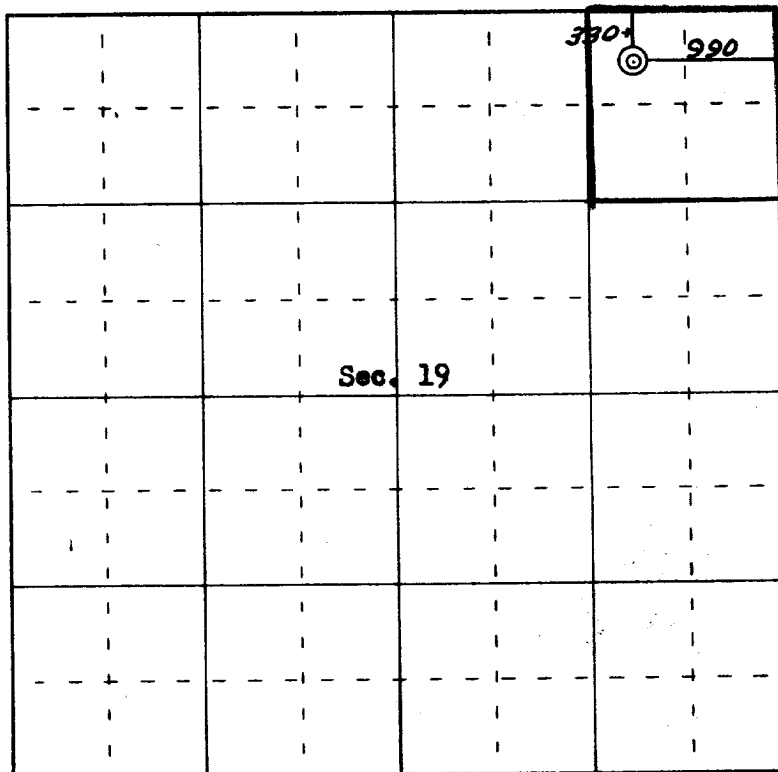

0 330 660 990 1320 1650 1980 2310 2640 2000 1500 1000 500 0

Scale 4 inches equal 1 mile

This is to certify that the above plat was prepared from field notes of actual surveys made by me or under my supervision and that the same are true and correct to the best of my knowledge and belief.

(Seal)

Date Surveyed June 5, 1965

Farmington, New Mexico

James P. Leese  
 Registered Professional Engineer and/or Land Surveyor  
 James P. Leese, N. Mex. Reg. No. 1463  
 San Juan Engineering Company

