

UNITED STATES
DEPARTMENT OF THE INTERIOR
GEOLOGICAL SURVEY

30-834-20020

APPLICATION FOR PERMIT TO DRILL, DEEPEN, OR PLUG BACK

1a. TYPE OF WORK

DRILL ☒

DEEPEN ☐

PLUG BACK ☐

b. TYPE OF WELL

OIL WELL ☐

GAS WELL ☐

OTHER

SINGLE ZONE ☐

MULTIPLE ZONE ☐

2. NAME OF OPERATOR

Tenneco Oil Company

3. ADDRESS OF OPERATOR

P. O. Box 1714, Durango, Colorado 81301

4. LOCATION OF WELL (Report location clearly and in accordance with any State requirements.)*
At surface

2160 FNL, 990 FWL Unit Letter "E".

At proposed prod. zone

14. DISTANCE IN MILES AND DIRECTION FROM NEAREST TOWN OR POST OFFICE*

10. DISTANCE FROM PROPOSED*

LOCATION TO NEAREST PROPERTY OR LEASE LINE, FT. (Also to nearest drlg. unit line, if any)

18. DISTANCE FROM PROPOSED LOCATION* TO NEAREST WELL, DRILLING, COMPLETED, OR APPLIED FOR, ON THIS LEASE, FT.

16. NO. OF ACRES IN LEASE

40

19. PROPOSED DEPTH

1700

17. NO. OF ACRES ASSIGNED TO THIS WELL

40

20. ROTARY OR CABLE TOOLS

Rotary

21. ELEVATIONS (Show whether DF, RT, GR, etc.)

7067 Gr.

22. APPROX. DATE WORK WILL START*

March 20, 1967

23.

PROPOSED CASING AND CEMENTING PROGRAM

SIZE OF HOLE	SIZE OF CASING	WEIGHT PER FOOT	SETTING DEPTH	QUANTITY OF CEMENT
12-1/4	9-5/8	32.4#	90	Cmt to surface.
8-3/4	7	23#	1700	150 sx minimum

We plan to drill to approximate T.D. 1700'. Run GRD & IES logs. Run casing as shown above, complete as an oil well if productive run tubing and conduct potential tests.

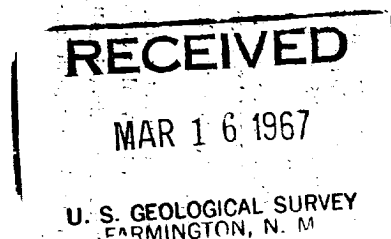

IN ABOVE SPACE DESCRIBE PROPOSED PROGRAM: If proposal is to deepen or plug back, give data on present productive zone and proposed new productive zone. If proposal is to drill or deepen directionally, give pertinent data on subsurface locations and measured and true vertical depths. Give blowout preventer program, if any.

24.

SIGNED

TITLE Senior Production Clerk

DATE March 17, 1967

(This space for Federal or State office use)

PERMIT NO.

APPROVAL DATE

APPROVED BY

TITLE

DATE

CONDITIONS OF APPROVAL, IF ANY:

5 USGS, Farmington

1 File

*See Instructions On Reverse Side

NEW MEXICO OIL CONSERVATION COMMISSION WELL LOCATION AND ACERAGE DEDICATION PLAT

All distances must be from the outer boundaries of the Section

Operator **TENNECO OIL COMPANY** Lease **HOSP AH** Well No. **12**
Unit letter **E** Section **12** Township **17 North** Range **9 West** Meridian **McKinley**
Actual Surface Location of Well **2160** feet from the **North** line **990** feet from the **West** line
Number of Acres **1067** ungraded **So. Hospah Lower Sand** **So. Hospah Lower Sand** **40**
Average

- Outline the acreage dedicated to the subject well by colored pencil or hatchure marks on the plat below.
- If more than one lease is dedicated to the well, outline each and identify the ownership thereof, both as to working interest and royalty.
- If more than one lease of different ownership is dedicated to the well, have the interests of all owners been consolidated by communitization, unitization, forced pooling, or otherwise, or until a non standard unit, eliminating such interests, has been approved by the Commission?
- If answer is "yes," type of consolidation _____
- If answer is "no," list the owners and tract descriptions which have actually consolidated. (Use reverse side of this form if necessary) _____
- No allowable will be assigned to the well until all interests have been consolidated by communitization, unitization, forced pooling, or otherwise, or until a non standard unit, eliminating such interests, has been approved by the Commission.

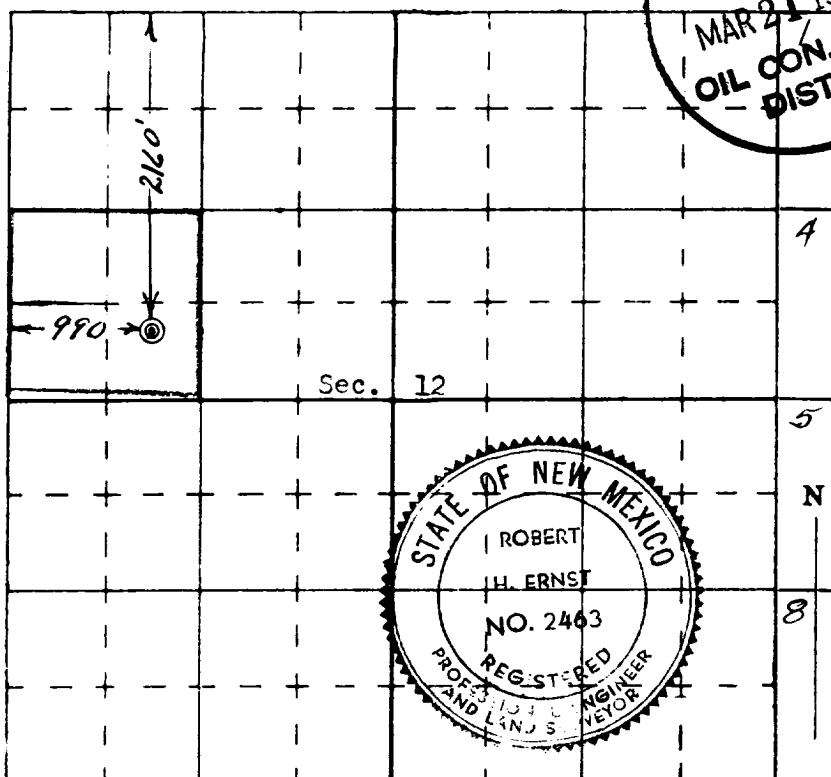

CERTIFICATION

I hereby certify that the information contained herein is true and complete to the best of my knowledge and belief.

Name **G. A. Ford**
Position **Senior Production Clerk**
Company **Tenneco Oil Company**
Date **March 17, 1967**

I hereby certify that the well location shown on this plat was plotted from field notes of actual surveys made by me or under my supervision, and that the same is true and correct to the best of my knowledge and belief.

Date Survey **20 January 1967**
Signature **Robert H. Ernst**
Registered Professional Engineer
and/or Land Surveyor
Robert H. Ernst
N. Mex. PE & LS 2463
Certificate No. _____

6/16/97
Ernst Engineering Co.
Engco, Colorado