

NO. OF COPIES RECEIVED	5
DISTRIBUTION	
SANTA FE	1
FILE	1
U.S.G.S.	2
LAND OFFICE	
OPERATOR	1

# NEW MEXICO OIL CONSERVATION COMMISSION

Form C-101

Revised 1-4-65

031

30-633-20061

5A. Indicate Type of Lease	
STATE <input type="checkbox"/>	FEE <input checked="" type="checkbox"/>
5. State Oil & Gas Lease No.	
7. Unit Agreement Name	
8. Farm or Lease Name	
Santa Fe Pac R R	
9. Well No.	
1	
10. Field and Pool, or Wildcat	
Chaco Wash Mesaverde	
12. County	
McKinley	
19. Proposed Depth	19A. Formation
350'	Menefee
20. Rotary or C.T.	
Rotary	
21. Elevations (Show whether DF, RT, etc.)	22. Approx. Date Work will start
Blanket, on file	November, 1967

APPLICATION FOR PERMIT TO DRILL, DEEPEN, OR PLUG BACK	
1a. Type of Work	
b. Type of Well	
DRILL <input checked="" type="checkbox"/>	DEEPEN <input type="checkbox"/>
OIL WELL <input checked="" type="checkbox"/>	GAS WELL <input type="checkbox"/>
2. Name of Operator	
Henry S. Birdseye	
3. Address of Operator	
P. O. Box 8294, Albuquerque, New Mexico 87108	
4. Location of Well	
UNIT LETTER P	LOCATED 565 FEET FROM THE south LINE
AND 565 FEET FROM THE east LINE OF SEC. 21 TWP. 20N RGE. 9W NMPM	
5. State Oil & Gas Lease No.	
6. Farm or Lease Name	
Santa Fe Pac R R	
7. Unit Agreement Name	
8. Field and Pool, or Wildcat	
Chaco Wash Mesaverde	
9. County	
McKinley	
10. Proposed Depth	
350'	
11. Formation	
Menefee	
12. Rotary or C.T.	
Rotary	
13. Elevations (Show whether DF, RT, etc.)	
Blanket, on file	
14. Drilling Contractor	
Carl Ray	
15. Approx. Date Work will start	
November, 1967	

23.

## PROPOSED CASING AND CEMENT PROGRAM

SIZE OF HOLE	SIZE OF CASING	WEIGHT PER FOOT	SETTING DEPTH	SACKS OF CEMENT	EST. TOP
4-3/4"	2"	3.7	340'	20	100'

This is an oil well, in the new Chaco Wash Mesaverde water flood, unorthodox location authorized under NMOCC Order No. R-3199

APPROVAL VALID  
FOR 90 DAYS UNLESS  
DRILLING COMMENCED,  
EXPIRES Feb. 26, 1968

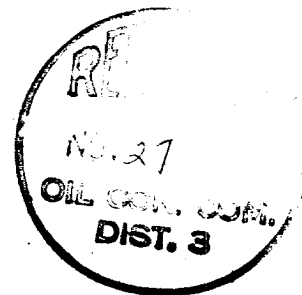

IN ABOVE SPACE DESCRIBE PROPOSED PROGRAM: IF PROPOSAL IS TO DEEPEN OR PLUG BACK, GIVE DATA ON PRESENT PRODUCTIVE ZONE AND PROPOSED NEW PRODUCTIVE ZONE. GIVE BLOWOUT PREVENTER PROGRAM, IF ANY.

I hereby certify that the information above is true and complete to the best of my knowledge and belief.

Signed M. Birdseye Title Operator Date 9-25-67

(This space for State Use)

APPROVED BY A. R. Kendrick PETROLEUM ENGINEER TITLE DATE NOV 27 1967

CONDITIONS OF APPROVAL, IF ANY:

**NEW MEXICO OIL CONSERVATION COMMISSION  
WELL LOCATION AND ACREAGE DEDICATION PLAT**

Form C-102  
Supersedes C-128  
Effective 1-1-65

All distances must be from the outer boundaries of the Section.

Operator <b>HENRY S. BIRDSEYE</b>			Lease <b>SANTA FE R.R. CO</b>		Well No. <b>#1</b>
Unit Letter <b>P</b>	Section <b>21</b>	Township <b>20N</b>	Range <b>9W</b>	County <b>MCKINLEY</b>	
Actual Footage Location of Well: <b>565</b> feet from the <b>SOUTH</b> line and <b>565</b> feet from the <b>EAST</b> line					
Ground Level Elev.  	Producing Formation <b>MESA VERDE</b>		Pool <b>CHACO WASH - MESA VERDE</b>		Dedicated Acreage: <b>JOINT 10</b> Acres

1. Outline the acreage dedicated to the subject well by colored pencil or hachure marks on the plat below.
2. If more than one lease is dedicated to the well, outline each and identify the ownership thereof (both as to working interest and royalty).
3. If more than one lease of different ownership is dedicated to the well, have the interests of all owners been consolidated by communitization, unitization, force-pooling, etc?

☐ Yes    ☐ No    If answer is "yes," type of consolidation \_\_\_\_\_

If answer is "no," list the owners and tract descriptions which have actually been consolidated. (Use reverse side of this form if necessary.) \_\_\_\_\_

No allowable will be assigned to the well until all interests have been consolidated (by communitization, unitization, forced-pooling, or otherwise) or until a non-standard unit, eliminating such interests, has been approved by the Commission.

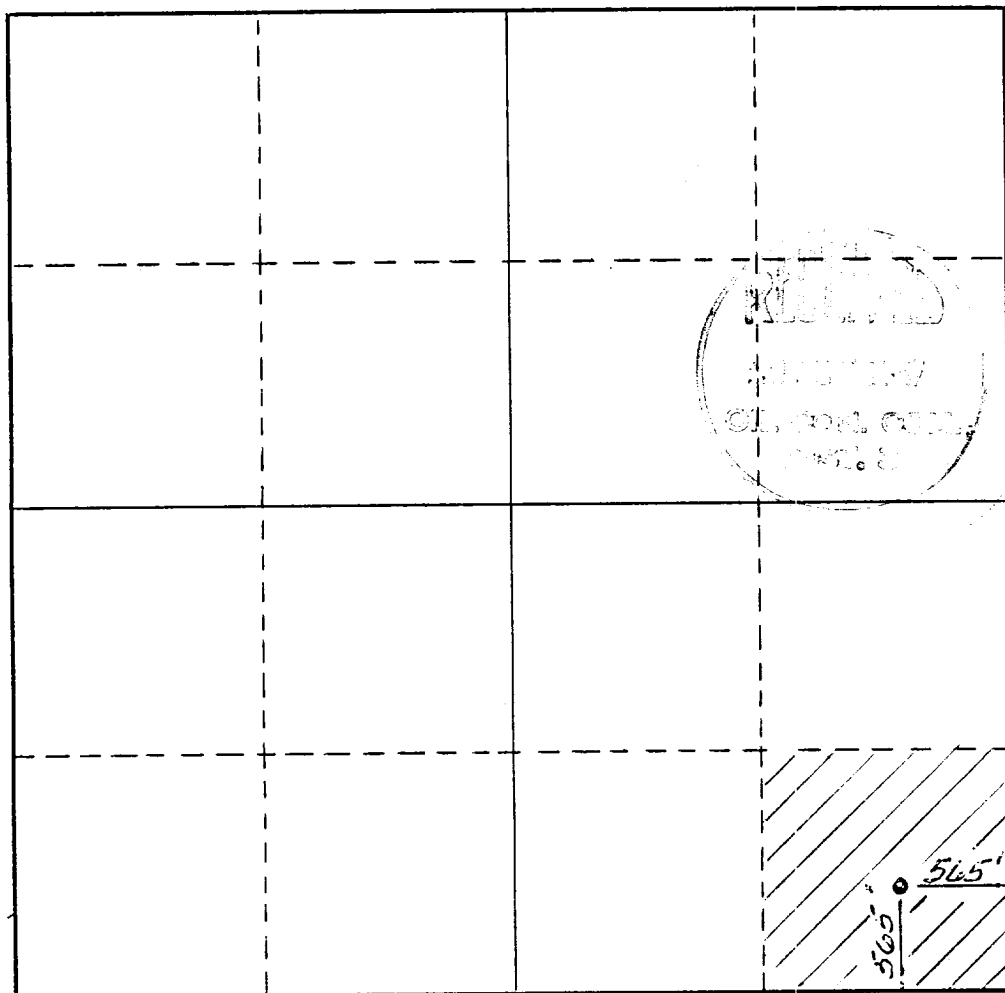

**CERTIFICATION**

I hereby certify that the information contained herein is true and complete to the best of my knowledge and belief.

Name **H. S. Birdseye**  
 Position \_\_\_\_\_  
 Owner \_\_\_\_\_  
 Company \_\_\_\_\_  
**Henry S. Birdseye**  
 Date **9-25-67**

I hereby certify that the well location shown on this plat was plotted from field notes of actual surveys made by me or under my supervision, and that the same is true and correct to the best of my knowledge and belief.

**SEPTEMBER 25, 1967**  
 Date Surveyed \_\_\_\_\_  
**R. J. Acuña**  
 Registered Professional Engineer  
 and/or Land Surveyor

**N. M. # 1457**  
 Certificate No.

0 330 660 990 1320 1650 1980 2310 2640 2970 3300 3630 3960 4290 4620 4950 5280 5610 5940 6270 6600