

30-553-20107

NO. OF COPIES RECEIVED	5
DISTRIBUTION	
SANTA FE	1
FILE	1
U.S.G.S.	2
LAND OFFICE	
OPERATOR	1

# NEW MEXICO OIL CONSERVATION COMMISSION

Form O-101  
Revised 12-65

1A. Indicate Type of Lease	
STATE <input type="checkbox"/>	FEE <input checked="" type="checkbox"/>
1. State Oil & Gas Lease No.	

## APPLICATION FOR PERMIT TO DRILL, DEEPEN, OR PLUG BACK

1a. Type of Work		7. Unit Agreement Name	
b. Type of Well OIL WELL <input checked="" type="checkbox"/> GAS WELL <input type="checkbox"/> OTHER <input type="checkbox"/>		8. Name of Lessee Name	
DEEPEN <input type="checkbox"/> PLUG BACK <input type="checkbox"/>		Santa Fe	
SINGLE ZONE <input checked="" type="checkbox"/> MULTIPLE ZONE <input type="checkbox"/>		9. Well No.	
2. Name of Operator Tesoro Petroleum Corporation		56	
3. Address of Operator 533 Busby Drive, San Antonio, Texas 78209		10. Field and Loc., or Wellcat Undesignated	
4. Location of Well UNIT LETTER <u>G</u> LOCATED <u>1520</u> FEET FROM THE <u>North</u> LINE AND <u>2450</u> FEET FROM THE <u>East</u> LINE OF SEC. <u>1</u> TWP. <u>17N</u> RGE. <u>9W</u> NMPM		11. County McKinley	
19. Proposed Depth 2700'		19A. Formation Dakota	
21. Elevations (Show whether DP, RT, etc.) GR 6923		21A. Kind & Status Plug. Bond Blanket	
21B. Drilling Contractor Whigham		22. Approx. Date Work will start May 10, 1969	

### 23. PROPOSED CASING AND CEMENT PROGRAM

SIZE OF HOLE	SIZE OF CASING	WEIGHT PER FOOT	SETTING DEPTH	SACKS OF CEMENT	EST. TOP
12-1/4"	8-5/8"	24#	120	100	Circulate
7-7/8"	5-1/2"	15-1/2#	2700	120	1800'

Propose to drill 12-1/4 hole to 120' and set 120' of 8-5/8" surface casing. Cement with 100 sacks cement. Drill out from under surface with 7-7/8" hole to 2700'. Will core any potentially productive zone in the Dakota series.

If productive, will run 5-1/2" casing to total depth and cement with 120 sacks cement. Will perforate for production.

Will use blowout preventers below 120'.

APPROVAL VALID  
FOR 90 DAYS UNLESS  
DRILLING COMMENCED,

EXPIRES Aug 7, 1969



IN ABOVE SPACE DESCRIBE PROPOSED PROGRAM: IF PROPOSAL IS TO DEEPEN OR PLUG BACK, GIVE DATA ON PRESENT PRODUCTIVE ZONE AND PROPOSED NEW PRODUCTIVE ZONE. GIVE BLOWOUT PREVENTER PROGRAM, IF ANY.

I hereby certify that the information above is true and complete to the best of my knowledge and belief.

Signed J. H. Zimmerman Title Petroleum Engineer Date May 7, 1969

(This space for State Use)

APPROVED BY Emory Church TITLE Sup Dist III DATE 5-9-69

CONDITIONS OF APPROVAL, IF ANY:

**NEW MEXICO OIL CONSERVATION COMMISSION  
WELL LOCATION AND ACREAGE DEDICATION PLAT**

Form C-102  
Supersedes C-128  
Effective 1-1-65

All distances must be from the outer boundaries of the Section.

Operator <b>TESORO PETROLEUM CORPORATION</b>			Lease <b>Santa Fe Hospan</b>		Well No. <b>56</b>
Unit Letter <b>G</b>	Section <b>1</b>	Township <b>17 North</b>	Range <b>9 West</b>	County <b>McKinley</b>	
Actual Footage Location of Well: <b>1520</b> feet from the <b>North</b> line and <b>2450</b> feet from the <b>East</b> line					
Ground Level Elev. <b>6923</b>	Producing Formation <b>Dakota</b>		Pool <b>Undesignated</b>		Dedicated Acreage: <b>40</b> Acres

1. Outline the acreage dedicated to the subject well by colored pencil or hachure marks on the plat below.
2. If more than one lease is dedicated to the well, outline each and identify the ownership thereof (both as to working interest and royalty).
3. If more than one lease of different ownership is dedicated to the well, have the interests of all owners been consolidated by communitization, unitization, force-pooling, etc?

☐ Yes ☐ No If answer is "yes" type of consolidation \_\_\_\_\_

If answer is "no," list the owners and tract descriptions which have actually been consolidated. (Use reverse side of this form if necessary.) \_\_\_\_\_

No allowable will be assigned to the well until all interests have been consolidated (by communitization, unitization, forced-pooling, or otherwise) or until a non-standard unit, eliminating such interests, has been approved by the Commission.

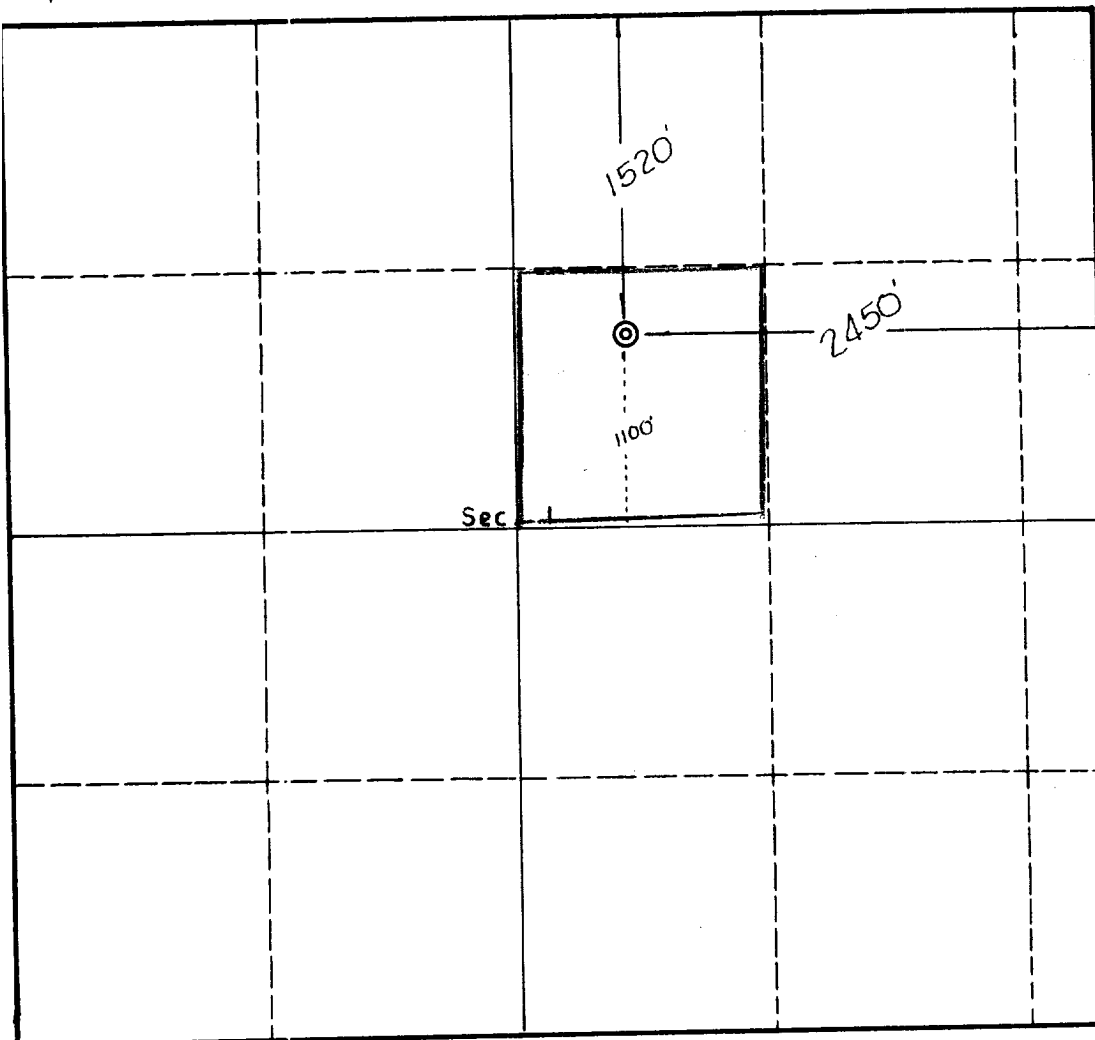

**CERTIFICATION**

I hereby certify that the information contained herein is true and complete to the best of my knowledge and belief.

*R. H. Denman*

Name  
**R. H. Denman**  
Position  
**Petroleum Engineer**

Company  
**Tesoro Petroleum Corporation**

Date  
**May 7, 1969**

I hereby certify that the well location shown on this plat is in the same field as the well shown on the plat of the same field and under my supervision and that the same is true and correct to the best of my knowledge and belief.

**RECEIVED  
MAY 9 1969  
OIL CON. COM.  
DIST. 2**

April 8, 1969

*E. V. Cantor*  
3602

23

