

NO. OF COPIES RECEIVED	3
DISTRIBUTION	
SANTA FE	/
FILE	/
U.S.G.S.	/
LAND OFFICE	
OPERATOR	/

NEW MEXICO OIL CONSERVATION COMMISSION

Form C-101
Revised 1-1-65 30-031-20129

5A. Indicate Type of Lease
STATE ☐ FEE ☒

5. State Oil & Gas Lease No.

APPLICATION FOR PERMIT TO DRILL, DEEPEN, OR PLUG BACK

1a. Type of Work b. Type of Well OIL WELL <input checked="" type="checkbox"/> GAS WELL <input type="checkbox"/> OTHER <input type="checkbox"/> DRILL <input checked="" type="checkbox"/> DEEPEN <input type="checkbox"/> PLUG BACK <input type="checkbox"/> SINGLE ZONE <input type="checkbox"/> MULTIPLE ZONE <input type="checkbox"/>			7. Unit Agreement Name
2. Name of Operator Tenneco Oil Company			8. Farm or Lease Name Whigham
3. Address of Operator Suite 1200 Lincoln Tower Bldg, Denver, Colorado			9. Well No. 3
4. Location of Well UNIT LETTER <u>H</u> LOCATED <u>2300</u> FEET FROM THE <u>North</u> LINE AND <u>350'</u> FEET FROM THE <u>East</u> LINE OF SEC. <u>11</u> TWP. <u>17-N</u> RGE. <u>9-W</u> NMPM			10. Field and Pool, or Wildcat Undesignated Dakota
			12. County McKinley
19. Proposed Depth 3000			19A. Formation Dakota
20. Rotary or C.T. Rotary			
21. Elevations (Show whether DF, RT, etc.) 7096 GR	21A. Kind & Status Plug. Bond	21B. Drilling Contractor	22. Approx. Date Work will start Upon Approval

23.

PROPOSED CASING AND CEMENT PROGRAM

SIZE OF HOLE	SIZE OF CASING	WEIGHT PER FOOT	SETTING DEPTH	SACKS OF CEMENT	EST. TOP
12-3/4"	9-5/8	32.3	60	Sufficient to	circulate
8-3/4	7	20	3000	Sufficient cement to cover	
				500' above upper Hospah Sand	

We plan to drill to approximate T.D. of 3000', log and run casing as shown above. Perforate and treat well as necessary to establish commercial production. Run tubing and conduct potential test.

APPROVAL VALID
FOR 90 DAYS UNLESS
DRILLING COMMENCED,
EXPIRES Jan 29, 1970

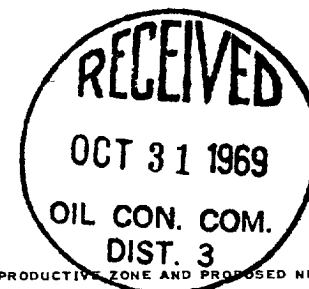

IN ABOVE SPACE DESCRIBE PROPOSED PROGRAM: IF PROPOSAL IS TO DEEPEN OR PLUG BACK, GIVE DATA ON PRESENT PRODUCTIVE ZONE AND PROPOSED NEW PRODUCTIVE ZONE. GIVE BLOWOUT PREVENTER PROGRAM, IF ANY.

I hereby certify that the information above is true and complete to the best of my knowledge and belief.

Signed S. A. Ford Title Sr. Production Clerk Date 10/28/69

(This space for State Use)

APPROVED BY Ernest Cherry TITLE Sup Dist III DATE 10-31-69

CONDITIONS OF APPROVAL, IF ANY:

NSL for gas

Two copies mailed direct to USGS.

NEW MEXICO OIL CONSERVATION COMMISSION

WELL LOCATION AND ACERAGE DEDICATION PLAT

All distances must be from the outer boundaries of the Section

Operator TENNECO OIL COMPANY			Lease WHIGHAM		Well No. 3
Unit Letter H	Section 11	Township 17 North	Range 9 West	County McKinley	
Actual Footage Location of Well: <div style="display: flex; justify-content: space-between;"> 2300 feet from the North line and 350 feet from the East line </div>					
Ground Level Elev. 7096' ungraded		Producing Formation Dakota	Pool Undesignated Dakota	Dedicated Acreage 40	

1. Outline the acreage dedicated to the subject well by colored pencil or hatchure marks on the plat below.
2. If more than one lease is dedicated to the well, outline each and identify the ownership thereof both as to working interest and royalty.
3. If more than one lease of different ownership is dedicated to the well, have the interests of all owners be consolidated by communitization, unitization, force-pooling, etc?

Yes ☐ No ☐ If answer is "yes," type of consolidation _____

If answer is "no," list the owners and tract descriptions which have actually consolidated. (Use reverse side of this form if necessary) _____

No allowable will be assigned to the well until all interests have been consolidated (by communitization, unitization, force-pooling, or otherwise) or until a non standard unit, eliminating such interests, has been approved by the Commission.



CERTIFICATION

I hereby certify that the information contained herein is true and complete to the best of my knowledge and belief.

Name
G. A. Ford
Position
Sr. Production Clerk
Company
Tenneco Oil Company
Date
10/28/69

I hereby certify that the well location shown on this plat was plotted from field notes of actual surveys made by me or under my supervision, and that the same is true and correct to the best of my knowledge and belief.

Date Surveyed
24 October 1969

Registered Professional Engineer
and/or Land Surveyor
Robert H. Ernst
N. Mex. Reg. No. **LP 2463**

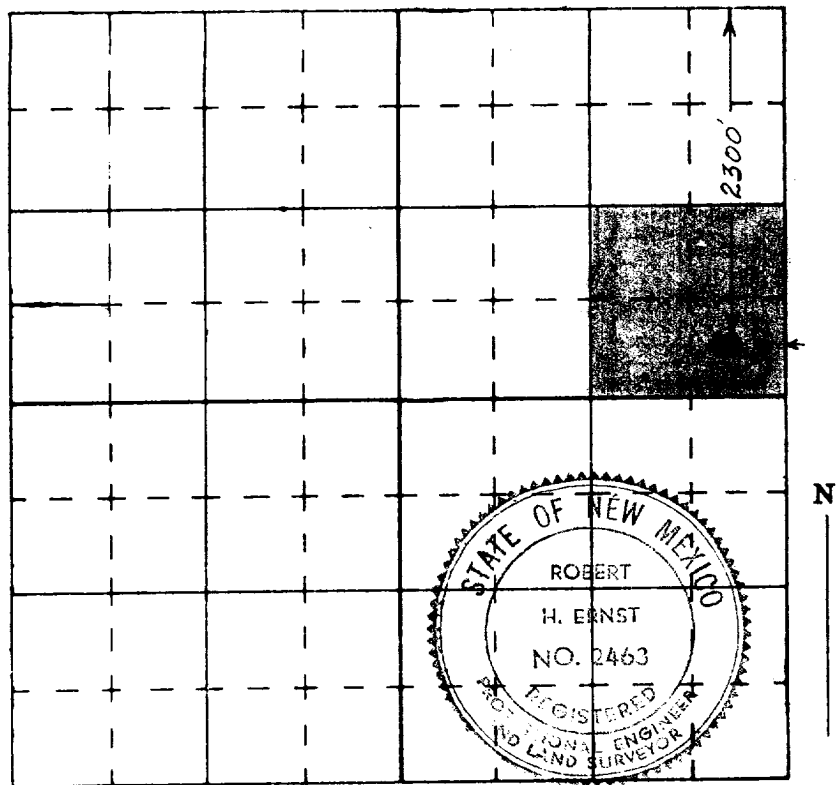

Ernst Engineering Co.
Durango, Colorado

Certificate No. _____