

UNITED STATES
DEPARTMENT OF THE INTERIOR
GEOLOGICAL SURVEY

APPLICATION FOR PERMIT TO DRILL, DEEPEN, OR PLUG BACK

1a. TYPE OF WORK

DRILL ☒

DEEPEN ☐

PLUG BACK ☐

b. TYPE OF WELL

OIL
WELL ☐

GAS
WELL ☐

OTHER Water Injection SINGLE
ZONE ☒

MULTIPLE
ZONE ☐

2. NAME OF OPERATOR

Tesoro Petroleum Corporation

3. ADDRESS OF OPERATOR

8520 Crownhill, San Antonio, Texas 78209

4. LOCATION OF WELL (Report location clearly and in accordance with any State requirements.*)

At surface Unit Letter K
1335' from the South line and 2635' from the West line
At proposed prod. zone
Same

14. DISTANCE IN MILES AND DIRECTION FROM NEAREST TOWN OR POST OFFICE*

15. DISTANCE FROM PROPOSED*

LOCATION TO NEAREST
PROPERTY OR LEASE LINE, FT.
(Also to nearest drlg. unit line, if any) 1335'

16. NO. OF ACRES IN LEASE

551.94

18. DISTANCE FROM PROPOSED LOCATION*

TO NEAREST WELL, DRILLING, COMPLETED,
OR APPLIED FOR, ON THIS LEASE, FT. 1800'

19. PROPOSED DEPTH

1530'

21. ELEVATIONS (Show whether DF, RT, GR, etc.)

6876' GL-Subject to revision

23.

PROPOSED CASING AND CEMENTING PROGRAM

SIZE OF HOLE	SIZE OF CASING	WEIGHT PER FOOT	SETTING DEPTH	QUANTITY OF CEMENT
9-7/8"	7"	23# J-55(used)	60'	40 sacks
6-1/4"	4-1/2"	9.5# H-40	1530'	65 sacks

Propose to drill through Upper Hospah Sand at location shown. Propose setting 7" surface pipe as shown and 4-1/2" long string through producing sand. Will perforate for injection completion.

APR 28 1970



IN ABOVE SPACE DESCRIBE PROPOSED PROGRAM: If proposal is to deepen or plug back, give data on present productive zone and proposed new productive zone. If proposal is to drill or deepen directionally, give pertinent data on subsurface locations and measured and true vertical depths. Give blowout preventer program, if any.

24.

SIGNED

A. H. Denman

TITLE

Petroleum Engineer

DATE

April 28, 1970

(This space for Federal or State office use)

PERMIT NO.

APPROVAL DATE

APPROVED BY

Henry C. Alford

TITLE

Sup. Dist. III

DATE

5-4-70

CONDITIONS OF APPROVAL, IF ANY:

**NEW MEXICO OIL CONSERVATION COMMISSION
WELL LOCATION AND ACREAGE DEDICATION PLAT**

Form C-102
Supersedes C-128
Effective 1-1-65

All distances must be from the outer boundaries of the Section.

Operator Tesoro Petroleum Corporation			Lease Hanson		Well No. 21
Unit Letter K	Section 6	Township 17 North	Range 8 West	County McKinley	
Actual Footage Location of Wells					
1335 feet from the South		2635 feet from the West			
Ground Level Elev. 6876	Producing Formation Upper Hospah-Injection	Pool South Hospah-Upper Sand		Dedicated Acreage: --- Acres	

1. Outline the acreage dedicated to the subject well by colored pencil or hachure marks on the plat below.
2. If more than one lease is dedicated to the well, outline each and identify the ownership thereof (both as to working interest and royalty).
3. If more than one lease of different ownership is dedicated to the well, have the interests of all owners been consolidated by communitization, unitization, force-pooling, etc?

☐ Yes ☐ No If answer is "yes," type of consolidation _____

If answer is "no," list the owners and tract descriptions which have actually been consolidated: (Use reverse side of this form if necessary.) _____

No allowable will be assigned to the well until all interests have been consolidated (by communitization, unitization, forced-pooling, or otherwise) or until a non-standard unit, eliminating such interests, has been approved by the Commission.

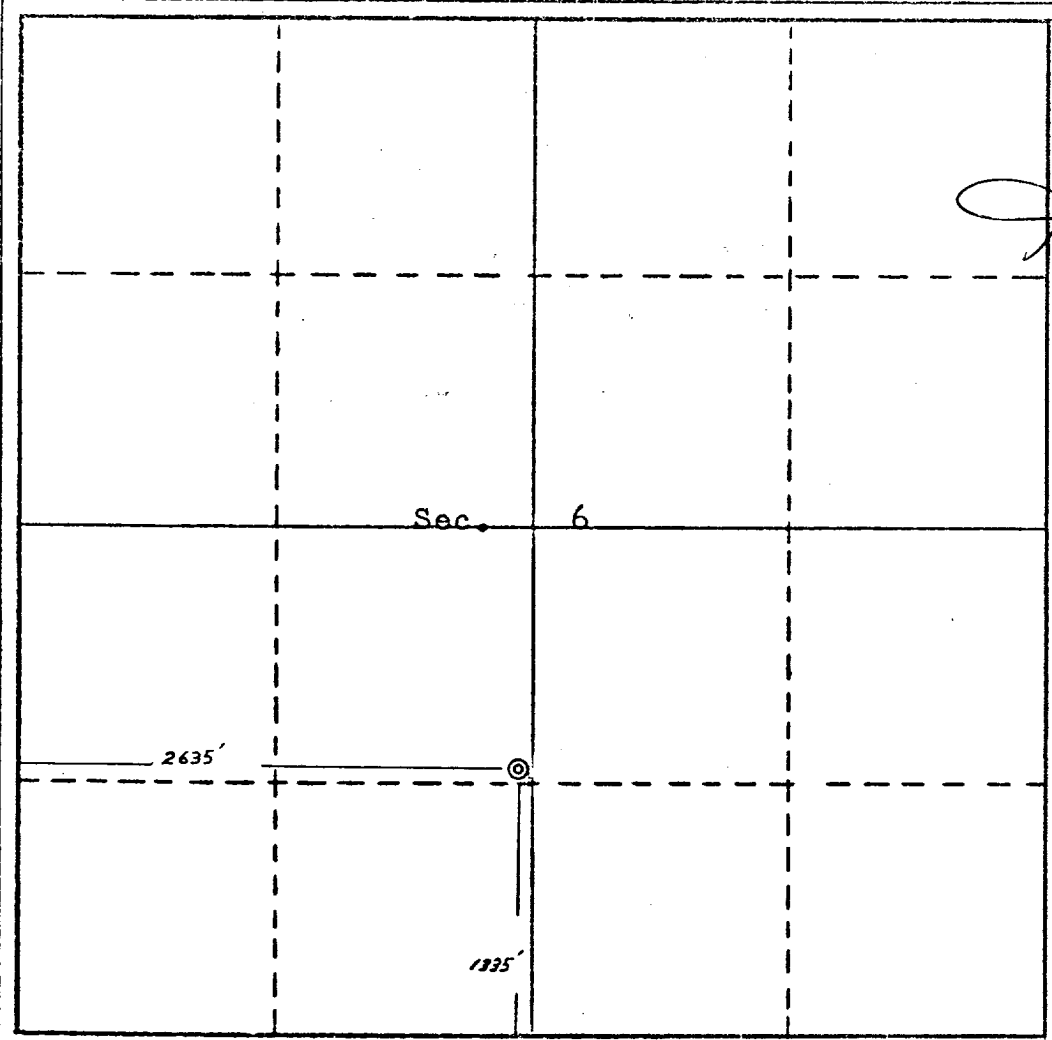
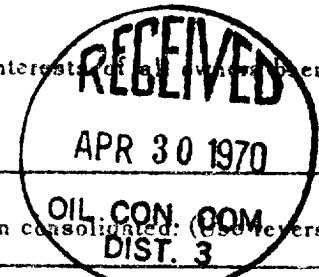

CERTIFICATION

I hereby certify that the information contained herein is true and complete to the best of my knowledge and belief.

Harold Vagtborg, Jr.
Name

Harold Vagtborg, Jr.

Position

Vice President

Company

Tesoro Petroleum Corp.

Date

April 28, 1970

I hereby certify that the well location shown on this plat was plotted from field notes of actual surveys made by me or under my supervision, and that the same is true and correct to the best of my knowledge and belief.

Date Surveyed

April 18, 1970

Registered Professional Engineer
and/or Land Surveyor

E. J. Echobank

Certificate No.

3602

