

UNITED STATES
DEPARTMENT OF THE INTERIOR
GEOLOGICAL SURVEY30-031-20179
5. LEASE DESIGNATION AND SERIAL NO.

APPLICATION FOR PERMIT TO DRILL, DEEPEN, OR PLUG BACK

6. IF INDIAN, ALLOTTEE OR TRIBE NAME
14-30-0003-7276
IND-NGO-6-14-20-2007

7. UNIT AGREEMENT NAME

8. FARM OR LEASE NAME

CHAVEZ

9. WELL NO.

10. FIELD AND POOL, OR WILDCAT

Undesignated Dakota

11. SEC., T., R., M., OR BLK.
AND SURVEY OR AREA

Sec. 20, T-17-N, R-8-W

12. COUNTY OR PARISH 13. STATE

McKinley New Mexico

12. TYPE OF WORK

DRILL ☒DEEPEN ☐PLUG BACK ☐

b. TYPE OF WELL

OIL
WELL ☒GAS
WELL ☐

OTHER

SINGLE
ZONE ☒MULTIPLE
ZONE ☐

2. NAME OF OPERATOR

Tenneco Oil Company

3. ADDRESS OF OPERATOR

Suite 1200 Lincoln Tower Bldg. - Denver, Colorado 80203

4. LOCATION OF WELL (Report location clearly and in accordance with any State requirements.)*

At surface

660' F/WL and 660' F/NL

At proposed prod. zone

14. DISTANCE IN MILES AND DIRECTION FROM NEAREST TOWN OR POST OFFICE*

15. DISTANCE FROM PROPOSED*

LOCATION TO NEAREST
PROPERTY OR LEASE LINE, FT.
(Also to nearest drlg. unit line, if any)

16. NO. OF ACRES IN LEASE

160

17. NO. OF ACRES ASSIGNED
TO THIS WELL

40

18. DISTANCE FROM PROPOSED LOCATION*
TO NEAREST WELL, DRILLING, COMPLETED,
OR APPLIED FOR, ON THIS LEASE, FT.

19. PROPOSED DEPTH

2900'

20. ROTARY OR CABLE TOOLS

Rotary

21. ELEVATIONS (Show whether DF, RT, GR, etc.)

6888 GR

22. APPROX. DATE WORK WILL START*

23.

PROPOSED CASING AND CEMENTING PROGRAM

SIZE OF HOLE	SIZE OF CASING	WEIGHT PER FOOT	SETTING DEPTH	QUANTITY OF CEMENT
12-1/4"	8-5/8"	24	60	Suff to Circulate
7-7/8"	5-1/2"	15.5	2900'	Suff to fill 500' above upper Hospah Sand

Above well to be a 2900' Undesignated Dakota development well. Well will be logged and if commercial production is indicated, casing will be run to T.D., perforated and formation treated as necessary to establish commercial production.

B.O.P. will be tested each 24 hours.

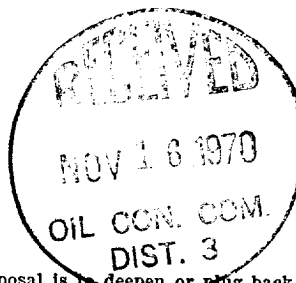

CONFIDENTIAL

For 90 days after
Completion

IN ABOVE SPACE DESCRIBE PROPOSED PROGRAM: If proposal is to deepen or plug back, give data on present productive zone and proposed new productive zone. If proposal is to drill or deepen directionally, give pertinent data on subsurface locations and measured and true vertical depths. Give blowout preventer program, if any.

24.

SIGNED

TITLE Sr. Production Clerk

DATE 11/11/70

(This space for Federal or State office use)

PERMIT NO.

APPROVAL DATE

APPROVED BY

TITLE

CONDITIONS OF APPROVAL, IF ANY:

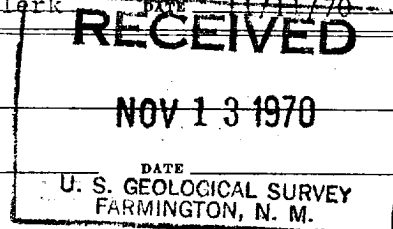

**NEW MEXICO OIL CONSERVATION COMMISSION
WELL LOCATION AND ACERAGE DEDICATION PLAT**

All distances must be from the outer boundaries of the Section

Owner: **TENNECO OIL COMPANY** **CHAVEZ** **1**
 Direction: **D** **20** **17 NORTH** **8 WEST** **MC KINLEY**
 Section: **660** **NORTH** **660** **WEST**
 Acres: **6888.0** **Dakota** **Undesignated** **40**

Distance from center of well to the subject well to be colored in pencil or black ink on the plat below

1. If more than one well is located to the well outline each well must be shown with its acreage, interest, and ownership interest in the well.

2. If more than one well is located to the well, the well must be shown with its acreage, interest, and ownership interest in the well.

3. If more than one well is located to the well, the well must be shown with its acreage, interest, and ownership interest in the well.

4. If more than one well is located to the well, the well must be shown with its acreage, interest, and ownership interest in the well.

5. If more than one well is located to the well, the well must be shown with its acreage, interest, and ownership interest in the well.

CERTIFICATION

I hereby certify that the information contained herein is true and complete to the best of my knowledge and belief.

G. A. Ford

G. A. Ford

Sr. Production Clerk

Tenneco Oil Company

11/11/70

I hereby certify that the well location shown on this plat was plotted from field notes of actual surveys made by me or under my supervision, and that the same is true and correct to the best of my knowledge and belief.

6 November, 1970

James P. Leese
 Professional Engineer
 Land Surveyor

JAMES P. LEESE

1463

Plate No.

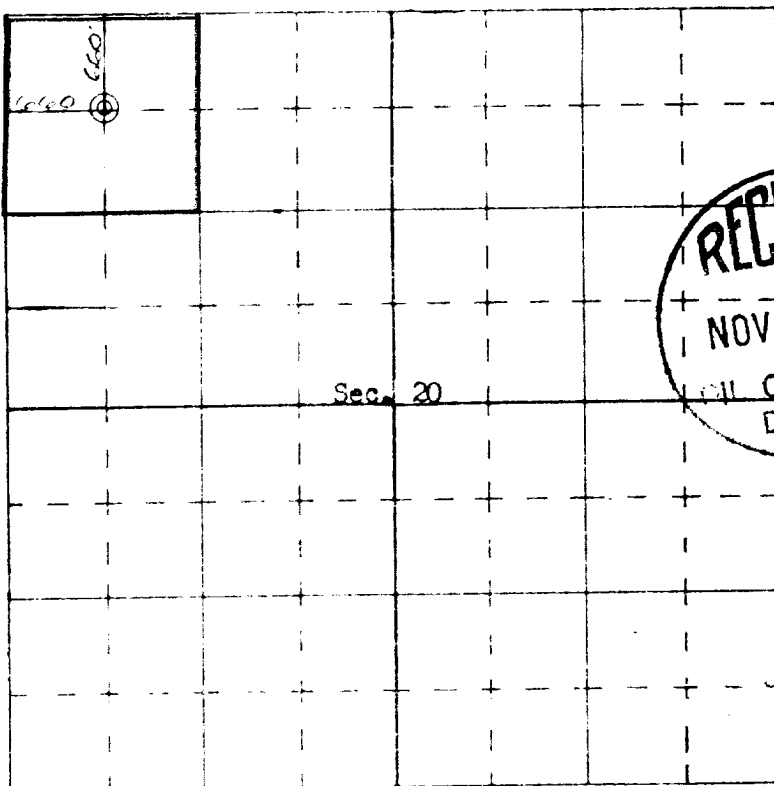

SCALE—4 INCHES EQUALS 1 MILE