

30-031-20180

| | |
|------------------------|-----|
| NO. OF COPIES RECEIVED | 5 |
| DISTRIBUTION | |
| SANTA FE | 1 |
| FILE | 1 ✓ |
| U.S.G.S. | 2 |
| LAND OFFICE | |
| OPERATOR | 1/1 |

NEW MEXICO OIL CONSERVATION COMMISSION

Form C-101
Revised 1-1-65 ~~30-031-20172~~

| |
|------------------------------------------------------------------------------------------------------|
| 5A. Indicate Type of Lease STATE <input type="checkbox"/> FEE <input checked="" type="checkbox"/> |
| 5. State Oil & Gas Lease No. |
| 7. Unit Agreement Name |
| 8. Farm or Lease Name SFP - RR |
| 9. Well No. 7 |
| 10. Field and Pool, or Wildcat Undesignated Dakota |
| 12. County McKinley |
| 19. Proposed Depth 3000 |
| 19A. Formation Dakota |
| 20. Rotary or C.T. Rotary |
| 21. Elevations (Show whether DF, RT, etc.) 6989 GR |
| 21A. Kind & Status Plug. Bond |
| 21B. Drilling Contractor Young Drillin |
| 22. Approx. Date Work will start Upon Approval |

APPLICATION FOR PERMIT TO DRILL, DEEPEN, OR PLUG BACK

| | |
|------------------------------------------------------------------------------------------------------------------------------------------------------------------------------------------------------|--------------------------------------------------------------------------------------------------------------|
| 1a. Type of Work | DRILL <input checked="" type="checkbox"/> DEEPEN <input type="checkbox"/> PLUG BACK <input type="checkbox"/> |
| b. Type of Well OIL WELL <input checked="" type="checkbox"/> GAS WELL <input type="checkbox"/> OTHER <input type="checkbox"/> | SINGLE ZONE <input checked="" type="checkbox"/> MULTIPLE ZONE <input type="checkbox"/> |
| 2. Name of Operator Tenneco Oil Company | |
| 3. Address of Operator Suite 1200 Lincoln Tower Bldg - Denver, Colorado 80203 | |
| 4. Location of Well UNIT LETTER <u>N</u> LOCATED <u>1980</u> FEET FROM THE <u>West</u> LINE AND <u>660</u> FEET FROM THE <u>South</u> LINE OF SEC. <u>13</u> TWP. <u>17</u> RGE. <u>9</u> NMPM | |
| 21. Elevations (Show whether DF, RT, etc.) 6989 GR | 21A. Kind & Status Plug. Bond |
| 21B. Drilling Contractor Young Drillin | 22. Approx. Date Work will start Upon Approval |

PROPOSED CASING AND CEMENT PROGRAM

| SIZE OF HOLE | SIZE OF CASING | WEIGHT PER FOOT | SETTING DEPTH | SACKS OF CEMENT | EST. TOP |
|--------------|----------------|-----------------|---------------|---------------------------|------------|
| 12-1/4 | 8-5/8 | 24 | 60 | Suff. to Circulate | |
| 7-7/8 | 5-1/2 | 15.5 | 3000 | Suff. to fill Hospah Sand | 500' above |

Above well to be a 3000' Undesignated Dakota Well. Well will be logged and if commercial production is indicated, casing will be run to T.D., perforated, and formation treated as necessary to establish commercial production.

B.O. P. to be tested each 24 hours.



APPROVAL VALID
FOR 90 DAYS UNLESS
DRILLING COMMENCED,
EXPIRES 2-23-71

IN ABOVE SPACE DESCRIBE PROPOSED PROGRAM: IF PROPOSAL IS TO DEEPEN OR PLUG BACK, GIVE DATA ON PRESENT PRODUCTIVE ZONE AND PROPOSED NEW PRODUCTIVE ZONE. GIVE BLOWOUT PREVENTER PROGRAM, IF ANY.

I hereby certify that the information above is true and complete to the best of my knowledge and belief.

Signed G. G. Fox Title Sr. Production Clerk Date 11/23/70

(This space for State Use)

APPROVED BY Ernest Chum TITLE SUPERVISOR DIST. #3 DATE NOV 25 1970
CONDITIONS OF APPROVAL, IF ANY:

**NEW MEXICO OIL CONSERVATION COMMISSION
WELL LOCATION AND ACERAGE DEDICATION PLAT**

All distances must be from the outer boundaries of the Section

| | | | | |
|------------------------------------------------------------------------------------------------------------------------------------------------------------------------------------------------------------------------------------------------------|----------------------|-------------------------------------------|------------------------|---------------------------|
| Operator TENNECO OIL COMPANY | | Lease SANTA FE PACIFIC RAILROAD | | Well No. 7 |
| Unit Letter N | Section 13 | Township 17 North | Range 9 West | County McKinley |
| Actual Footage Location of Well: 660 feet from the South line and 1980 feet from the West line Ground Level Elevation: 6989' ungraded Producing Formation: Dakota Dedicated Acreage: 40 Acres | | | | |

1. Outline the acreage dedicated to the subject well by colored pencil or hatchure marks on the plat below.
2. If more than one lease is dedicated to the well, outline each and identify the ownership thereof (both as to working interest and royalty).
3. If more than one lease of different ownership is dedicated to the well, have the interests of all owners been consolidated by communitization, unitization, force-pooling, etc?
 () Yes () No If answer is "yes," type of consolidation: _____

If answer is "no," list the owners and tract descriptions which have actually consolidated (Use reverse side of this form if necessary.) _____

No allowable will be assigned to the well until all interests have been consolidated (by communitization, unitization, forced-pooling, or otherwise) or until a non standard unit, eliminating such interests, has been approved by the Commission.

CERTIFICATION

I hereby certify that the information contained herein is true and complete to the best of my knowledge and belief.

Name *G. A. Ford*
 Position **G. A. Ford**
Sr. Production Clerk
 Company **Tenneco Oil Company**
 Date **November 23, 1970**

I hereby certify that the well location shown on this plat was plotted from field notes of actual surveys made by me or under my supervision, and that the same is true and correct to the best of my knowledge and belief.

19 November 1970
 Date Surveyed

Robert H. Ernst
 Registered Professional Engineer
 and/or Land Surveyor
Robert H. Ernst

New Mexico PE &LS 2463
 Certificate No.

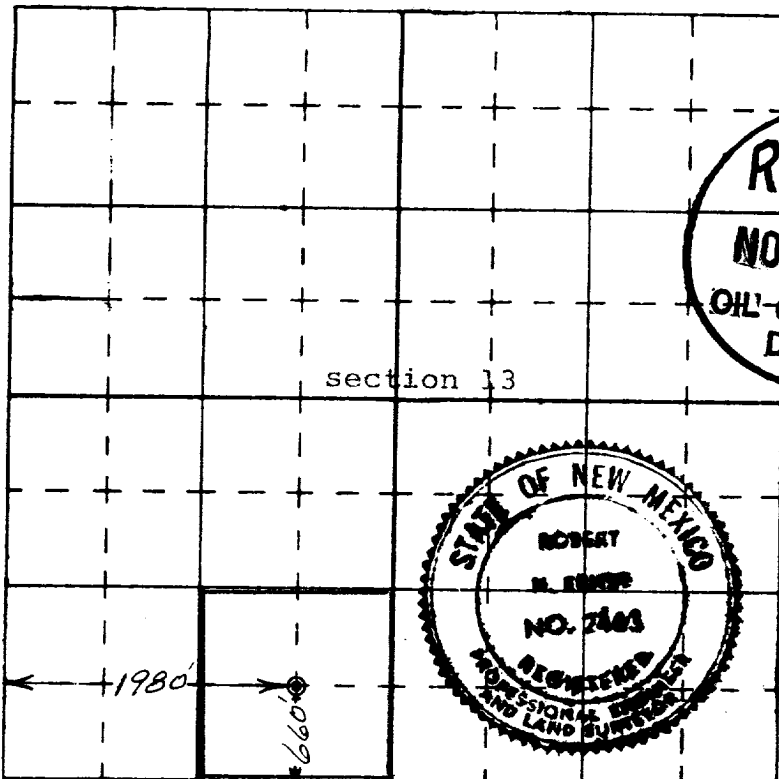

**ERNST ENGINEERING CO.
DURANGO, COLORADO**

